

## LIGHT MY BRICKS 2.0

**COMPONENT HANDLING**

# CONTENTS



Package Overview 3

---

Component Handling 4-6

---

- Astro Lights 4
- Belts 5
- Intergrate with LEGO 6

FX Spectrum 7-8

---

- Connecting 7
- Effect Cycling 8



# PACKAGING OVERVIEW

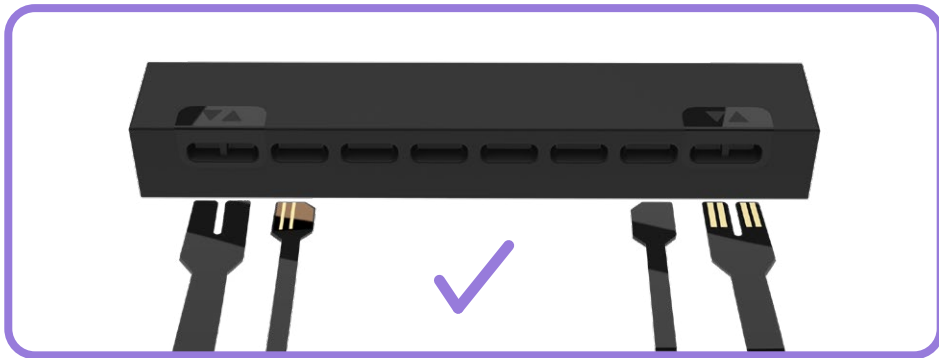
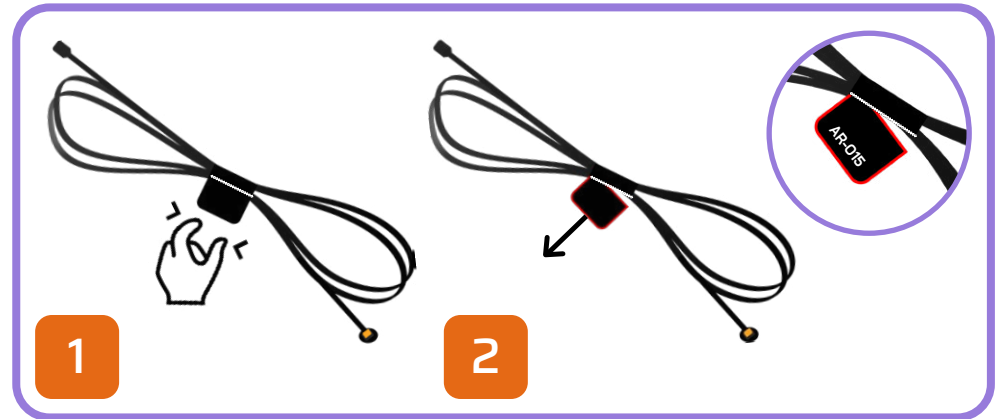
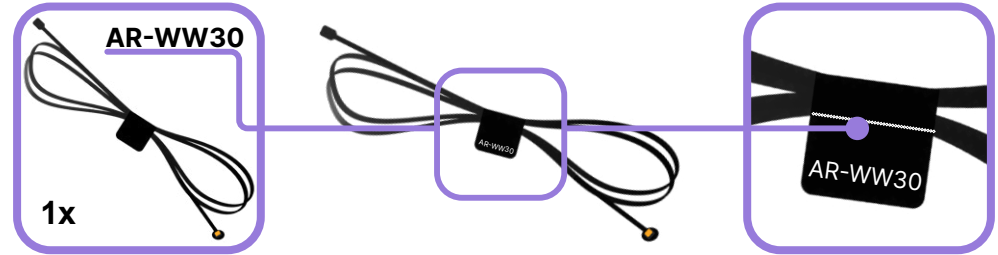
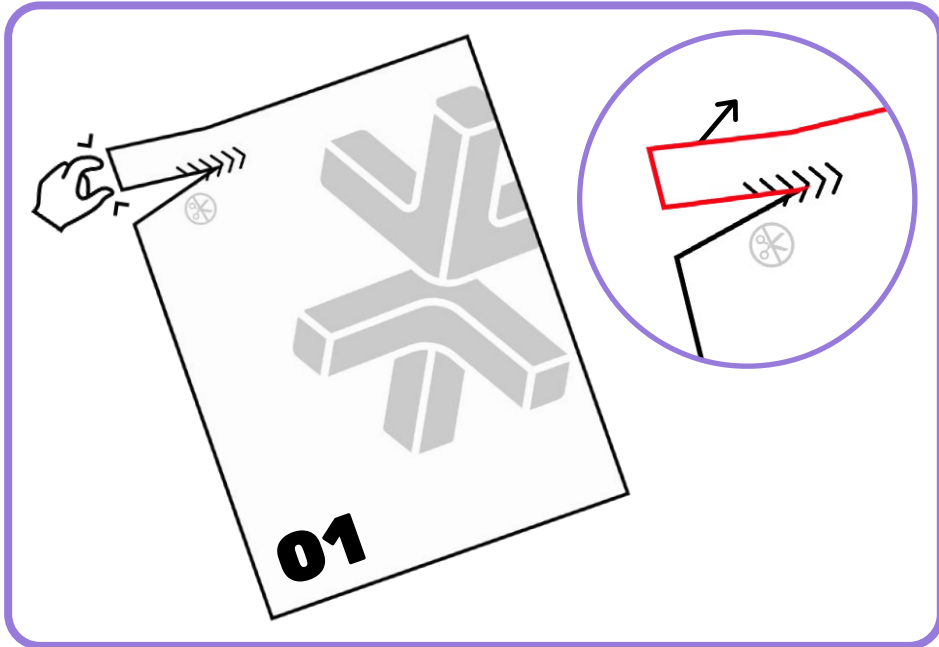

# ASTRO LIGHT HANDLING

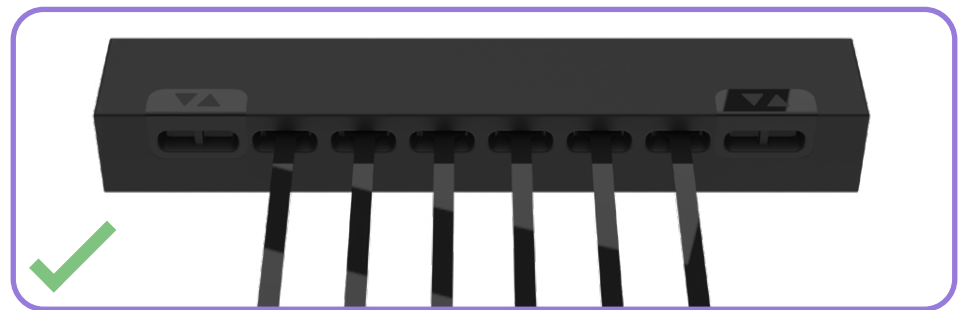
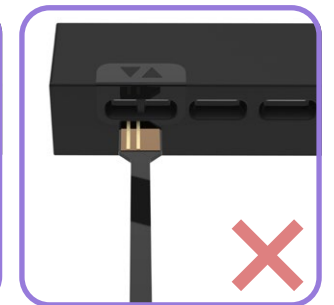
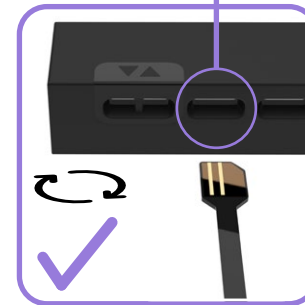
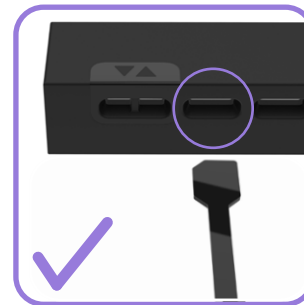
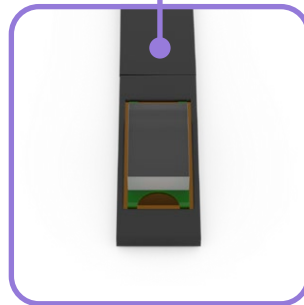
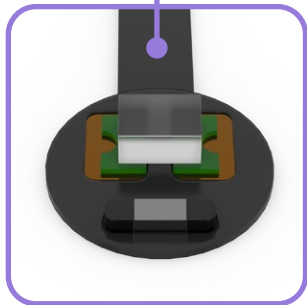
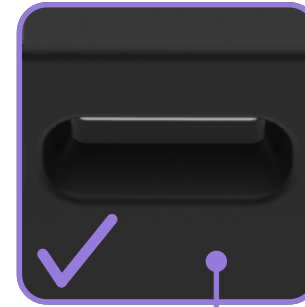
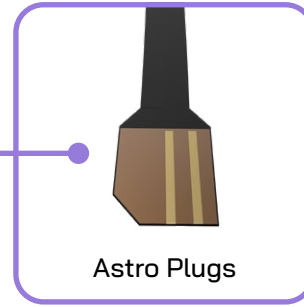

# BELT HANDLING



Flux Touch Plate (A)



Flux Touch Plate (B)



Flux Belt



Belts



Belt Plugs

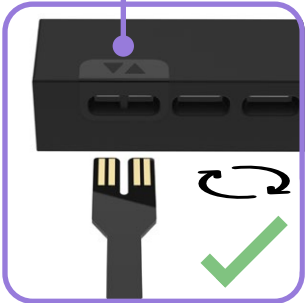
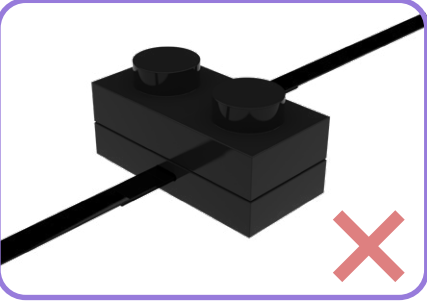
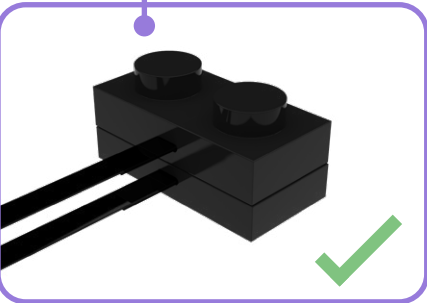

# CORRECT INTEGRATION

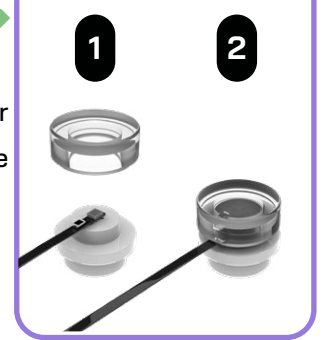
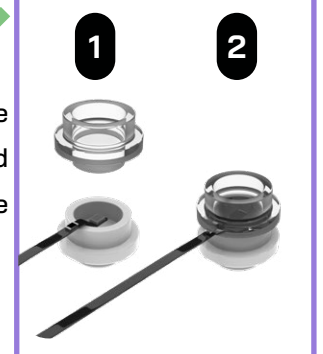
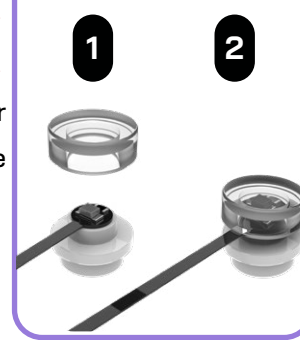
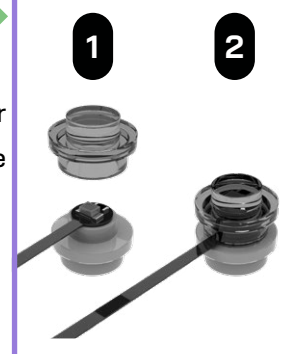
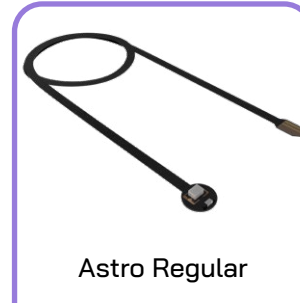
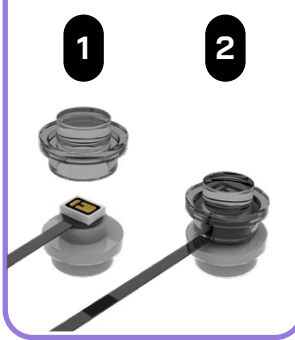
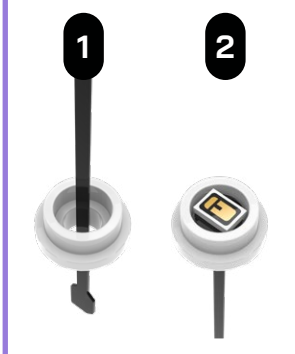
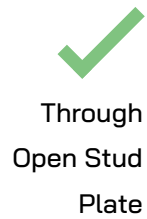
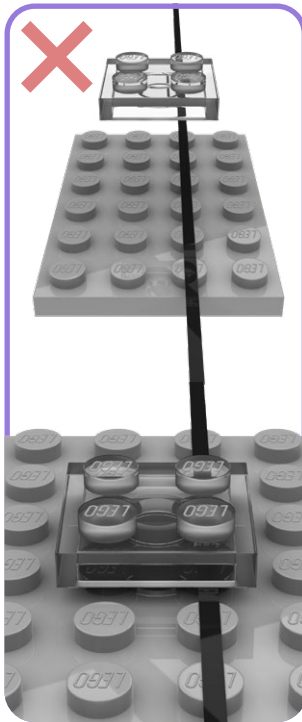
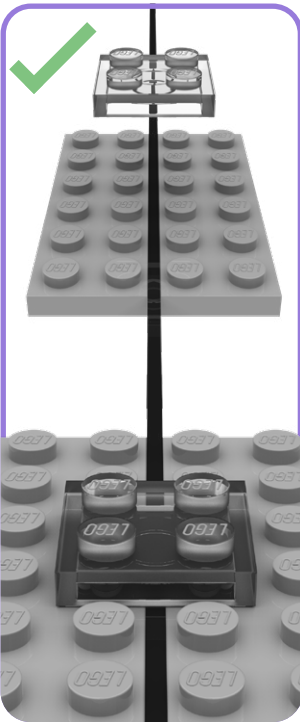
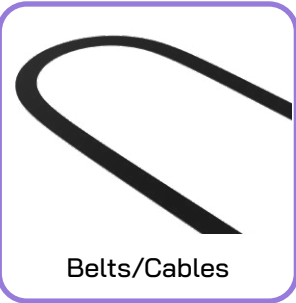

# FX SPECTRUM CONNECTING



- 1 • Power IN
- 2 • Power OUT with NO lighting effect.
- 3 • Light Effects OUT Astro Port
- 4 • Light Effects OUT Belt Ports / Dock Expansion

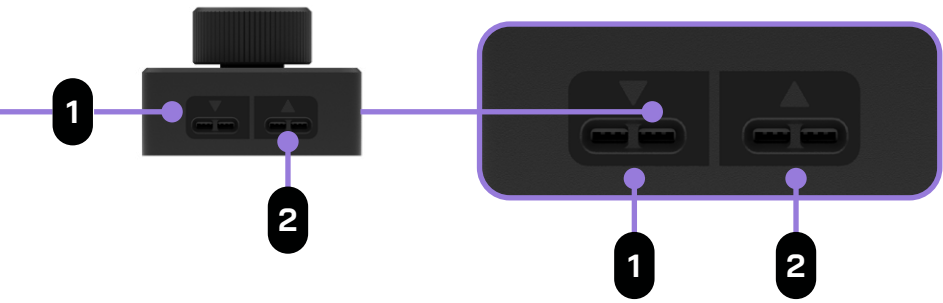
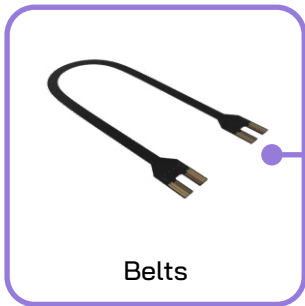
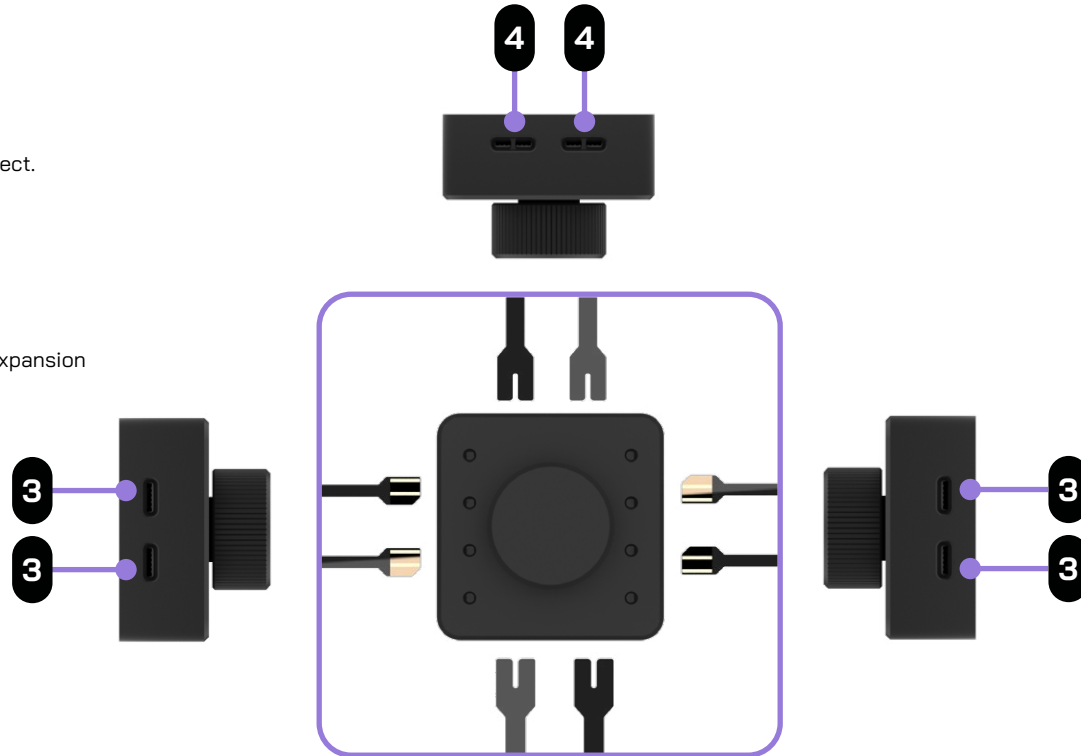

# FX SPECTRUM - EFFECT CYCLING



FX-S

1



**TWIST**  
Cycle Effects



- |          |   |           |
|----------|---|-----------|
| Glitter  | ● | Elements  |
| Traffic  | ● | Emergency |
| Sequence | ● | Gun       |
| Spooky   | ● | Pulse     |

STATIC



2



**PRESS**  
Sub-Effect Mode



- |   |   |  |
|---|---|--|
| Glitter   | ● | Elements   |
| Upside Down   | ● | Fire, Water  |
| Traffic   | ● | Emergency  |
| USA/AU, EU  | ● | Slow, Medium, Fast Flash   |
| Sequence  | ● | Gun  |
| Knight Rider, Knight Rider fast, Circus 1, Circus 2, Pattern 1, Pattern 2 | ● | Cannon, Machine Gun, Laser Cannon                                  |
| Spooky  | ● | Pulse  |
| Low flicker, High flicker   | ● | Slow breath, Fast breath, Slow pulse, Extra Fast pulse, Warp pulse |

FLASH



**TWIST**  
Cycle Sub Effects

3



**PRESS**  
To Confirm Sub-Effect





# CONTACT US

Click below for customer support, or general inquiries.

Contact Us



Cliquez ci-dessous pour accéder au support client ou aux renseignements généraux.

Contactez-nous



Clicca qui sotto per l'assistenza clienti o per richieste generali.

Contattaci



Klicken sie unten für kundensupport oder allgemeine anfragen.

Kontaktieren sie uns



Haga clic a continuación para atención al cliente o consultas generales.

Contáctanos



点击下方获取客户支持或一般咨询。

联系我们





# LIGHTMYBRICKS

[lightmybricks.com](http://lightmybricks.com)



LEGO® is a trademark of the LEGO Group of companies, which does not sponsor, authorize or endorse this product. All LEGO® sets featured in images are sold separately. This is not a LEGO® product. The LEGO Group is not liable for any loss, injury or damage arising from the use or misuse of this product. ©2024 Light My Bricks Pty Ltd. All rights reserved. [www.lightmybricks.com](http://www.lightmybricks.com)

Our components are designed and packaged in Australia by Light My Bricks Pty Ltd. Components are manufactured in China. 3fl bldg C, Shuanghuan Quanxin Technology Information Industry Park Baolong Street, Longgang District, Shenzhen, China. Imported in Australia by Light My Bricks Pty Ltd, 5/26 Rushdale St, Knoxfield, VIC, 3180, Australia.

WARNING: CHOKING HAZARD - Small parts. Not for children under 3 years.

AVERTISSEMENT : RISQUE D'ÉTOUFFEMENT - Petites pièces. Ne convient pas aux enfants de moins de 3 ans.

ATTENZIONE: PERICOLO DI SOFFOCAMENTO - Piccole parti. Non adatto a bambini di età inferiore a 3 anni.

WARNUNG: ERSTICKUNGSGEFAHR - Kleine Teile. Nicht für Kinder unter 3 Jahren geeignet.

ADVERTENCIA: PELIGRO DE ASFIXIA - Piezas pequeñas. No son apto para niños menores de 3 años.

警告：窒息危险 - 小零件。不适合3岁以下儿童。