



**LIGHT^{MY}
BRICKS**



**LEGO® R2-D2™
#75308 LIGHT KIT & SOUND KIT
INSTALLATION GUIDE**

Light My Bricks



LEGO® R2-D2™ #75308 LIGHT & SOUND KIT INSTALLATION GUIDE

Hi There!

We're here to help you get started on the LEGO®
R2-D2™ (75308) Light & Sound Kit.

This PDF details the instructions for the LED light & sound
kit only. If you are wishing to purchase this product, please
[click here to view the product page](#).

If you run into any issues, please refer to the troubleshoot-
ing section towards the end of this guide.

Have fun and enjoy!



PACKAGE CONTENTS:



- 1 x Red to Blue 15cm Bit Light
- 1 x Green to Orange 15cm Bit Light
- 10 x Cool White 30cm Bit Lights*



- 1 x 12-Port Expansion Board
- 1 x 2-Port Expansion Board (Not required for the Remote Control & Sound version)



- 2 x Sparkle Effects Board
- 3 x Adhesive Squares



- 3 x 5cm Connecting Cables*
- 1 x 50cm Connecting Cable



- 1 x USB Power Cable
(Power Source not Included)

LEGO PIECES:



- 2 x Trans Clear 1x1 Round Plate
- 2 x Trans Clear 2x2 Plate w/ Rounded Bottom
- 2 x Trans Light Blue 1x1 Plate

EXTRA COMPONENTS INCLUDED WITH THE LIGHT & SOUND KIT:



- 1 x Remote Control & Sound Board
- 1 x Remote Control
- 1 x IR Receiver w/ 30cm Cable
- 1 x Audio Speaker w/ 15cm Cable
- 1 x Micro SD Memory Card (128MB)
- 1 x Micro USB Cable (to transfer audio files from PC)
- 1 x Adhesive Square

Asterisks * indicates 1 extra component has been included just in case!

Contents

Before You Begin	5
Instructions	8
Final Product	34
Troubleshooting	35
Contact	40

Before You Begin

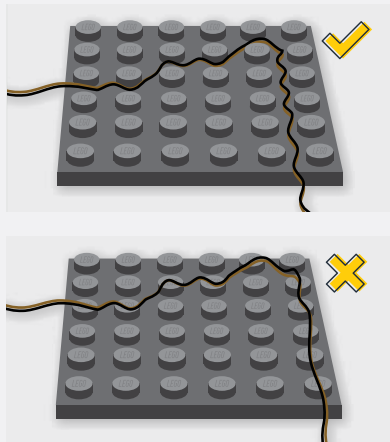

Laying cables in between and underneath bricks

Cables can fit in between and underneath LEGO® bricks, plates, and tiles providing they are laid correctly between the LEGO® studs. Do NOT forcefully join LEGO® together around cables; instead ensure they are laying comfortably in between each stud.

CAUTION: Forcing LEGO® to connect over a cable can result in damaging the cable and light.



Connecting Cable Connectors To Expansion Boards

Take extra care when inserting connectors to ports of Expansion Boards. Connectors can be inserted only one way. With the expansion board facing up, look for the soldered “=” symbol on the left side of the port. The connector side with the wires exposed should be facing toward the soldered “=” symbol as you insert into the port. If a plug won’t fit easily into a port connector, do not force it.

Incorrectly inserting the connector can result in bent pins inside the port or possible overheating of the expansion board when connected.

Before You Begin



Connecting Cable Connectors To Strip Lights

Take extra care when inserting connectors to ports on the Strip Lights. Connectors can be inserted only one way. With the Strip Light facing up, ensure the side of the connector with the wires exposed is facing down. If a plug won't fit easily into a port connector, don't force it. Doing so will damage the plug and the connector.



Connecting Micro Cable Connectors To Micro Expansion Board Ports

Take extra care when inserting the micro connectors to micro ports of Micro Expansion Boards. Connecting Micro Bit Lights to Micro Expansion Boards is similar to connecting lights and cables to Strip Lights. With the expansion board facing up, ensure the side of the connector with the wires exposed is facing down. If a plug won't fit easily into a port connector, do not force it. Use your fingernail to push the plastic part of the connector to the micro port.

Before You Begin

Installing Bit Lights Under Lego® Bricks And Plates

When installing Bit Lights under LEGO® pieces, ensure they are placed the correct way up (Yellow LED component exposed). You can either place them directly on top of LEGO® studs or in between.

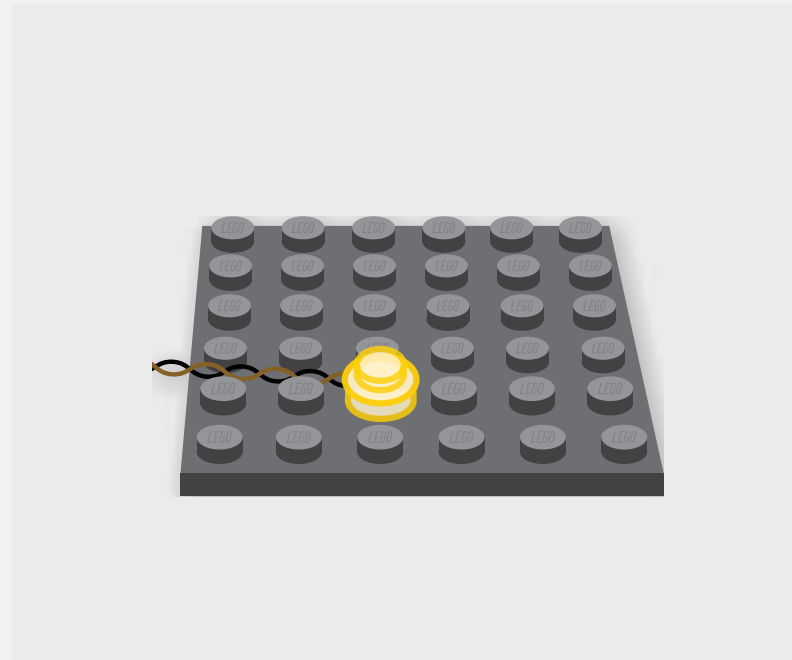



INSTRUCTIONS

To ensure a smooth installation of your light kit, please read and follow each step carefully. If you run into any issues, please refer to the online troubleshooting guide.

1

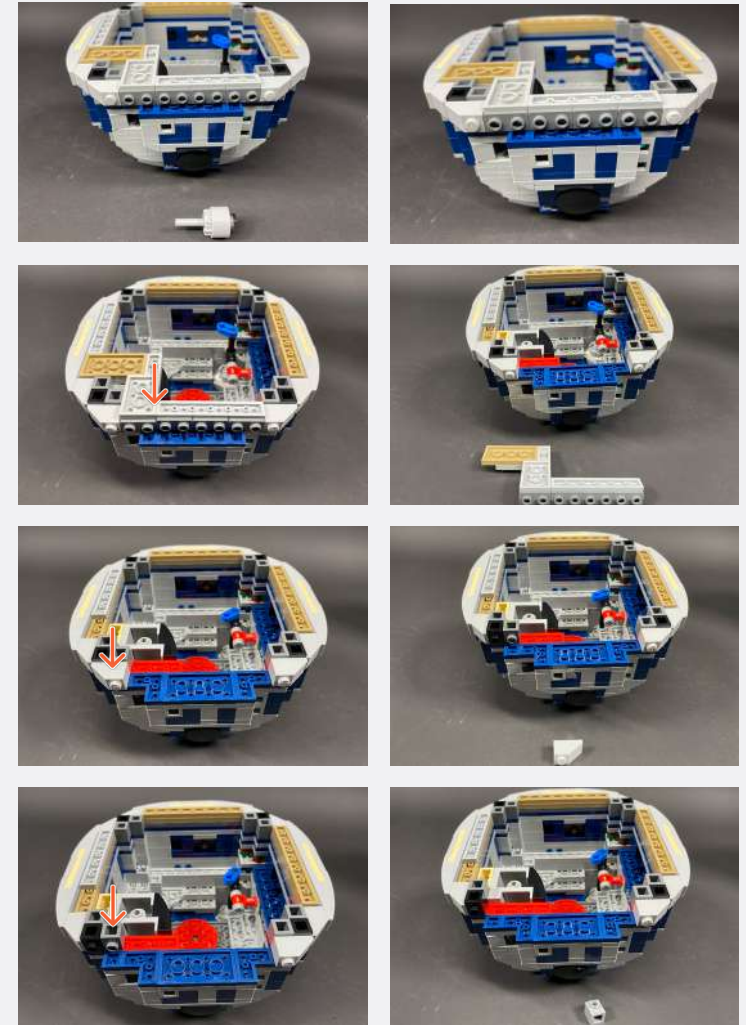
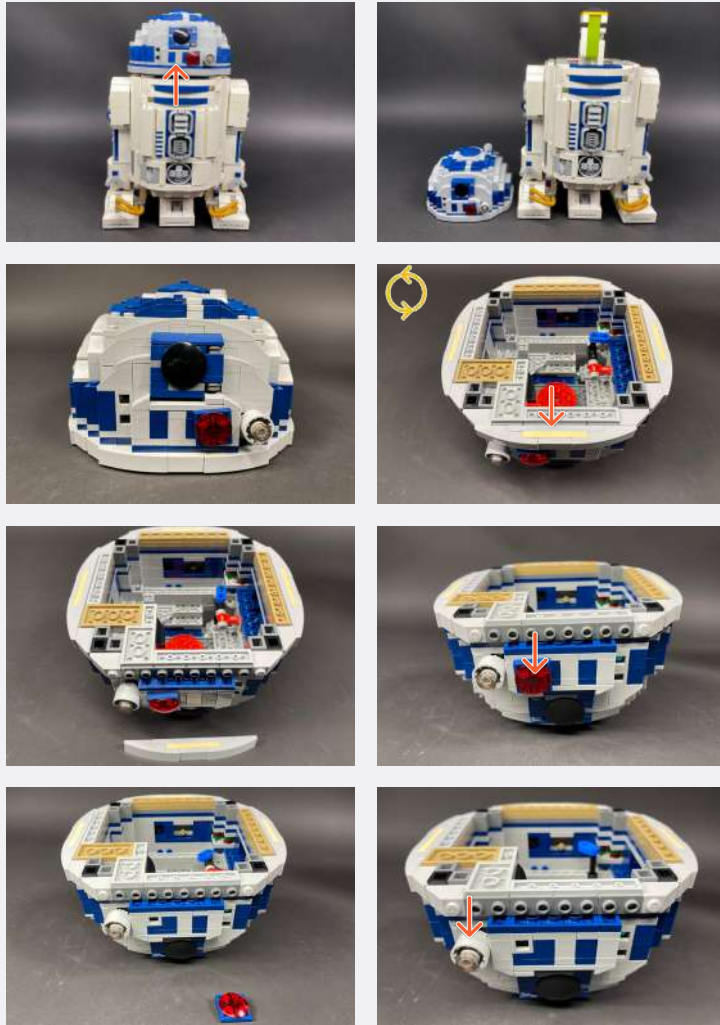

Legend → DISCONNECT → CONNECT / RECONNECT ↻ TURN / FLIP → DIRECTIONAL ↻ TWIST / BRAID ✨ POWER ON TEST 📝 NOTE ICON

2

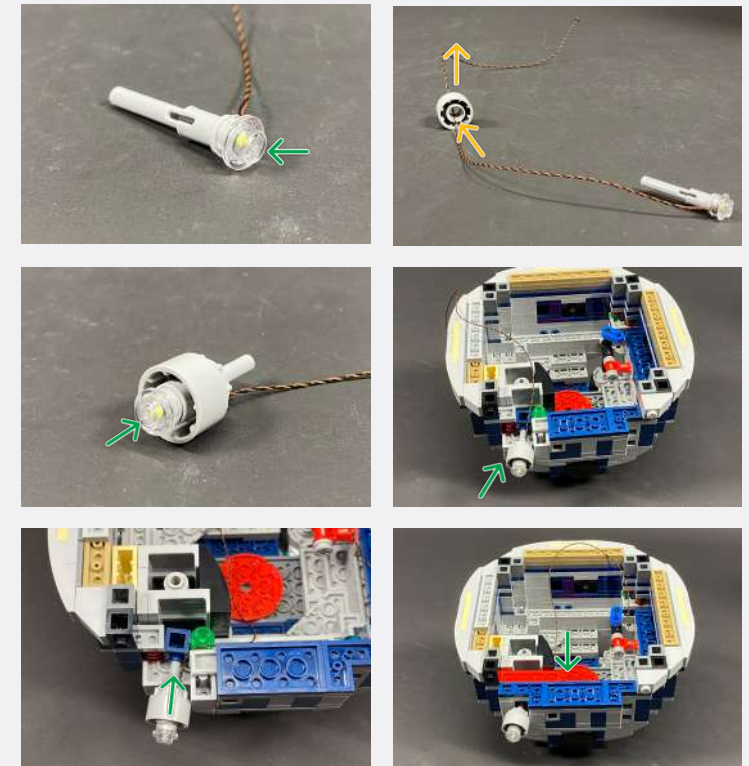

Legend → DISCONNECT → CONNECT / RECONNECT ↻ TURN / FLIP → DIRECTIONAL ↻ TWIST / BRAID ✨ POWER ON TEST 📝 NOTE ICON

3

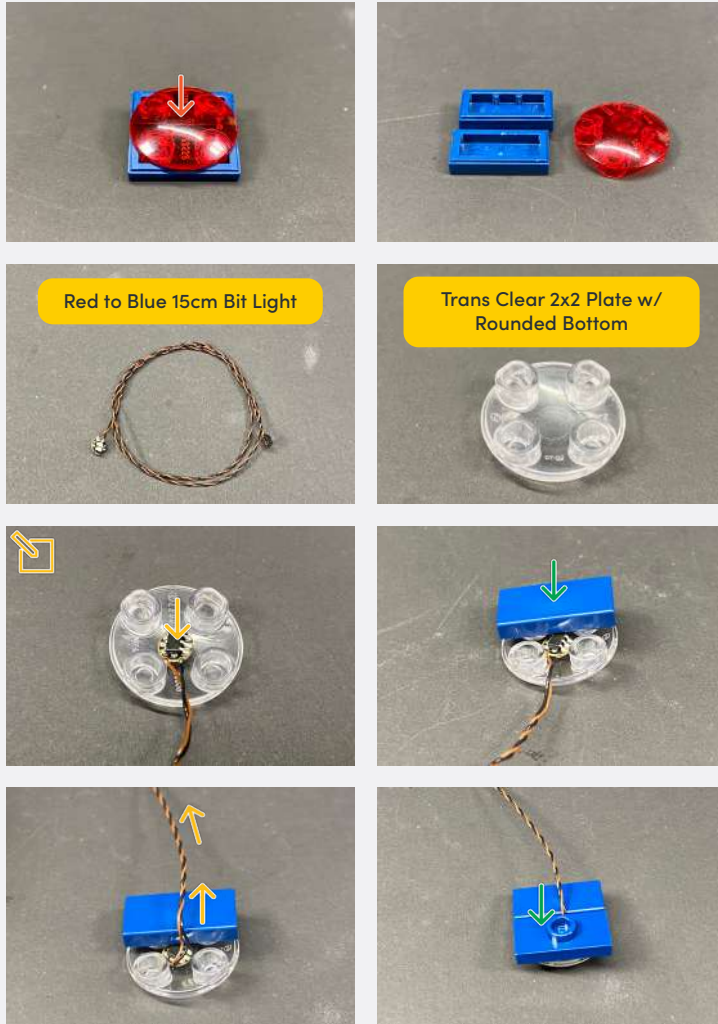

Red to Blue 15cm Bit Light

Trans Clear 2x2 Plate w/ Rounded Bottom

Ensure the LED is facing down

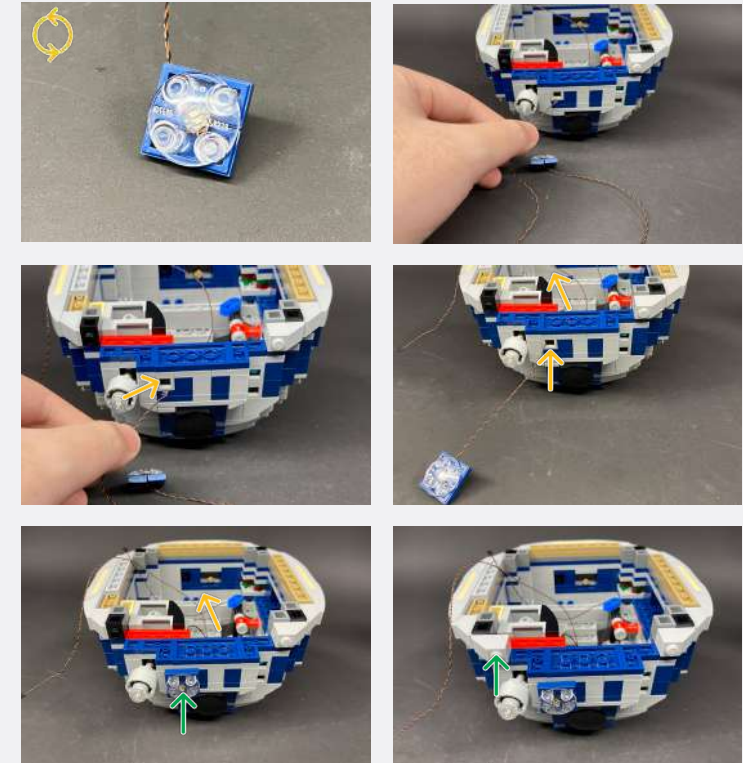

Legend → DISCONNECT → CONNECT / RECONNECT ↻ TURN / FLIP → DIRECTIONAL ↻ TWIST / BRAID * POWER ON TEST 📝 NOTE ICON

4

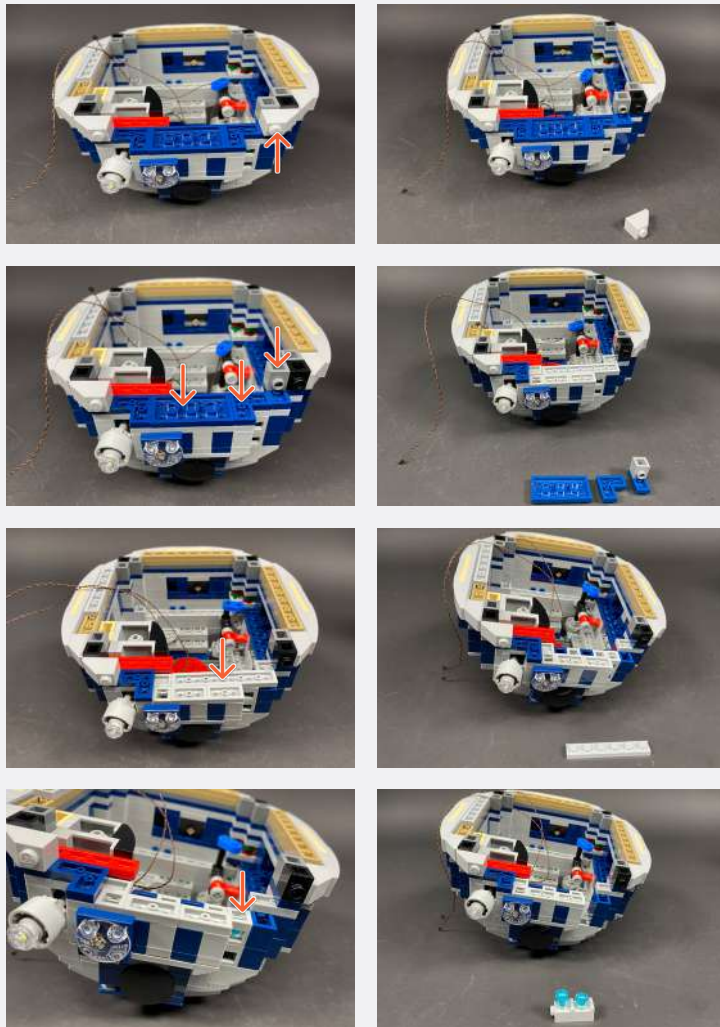

5

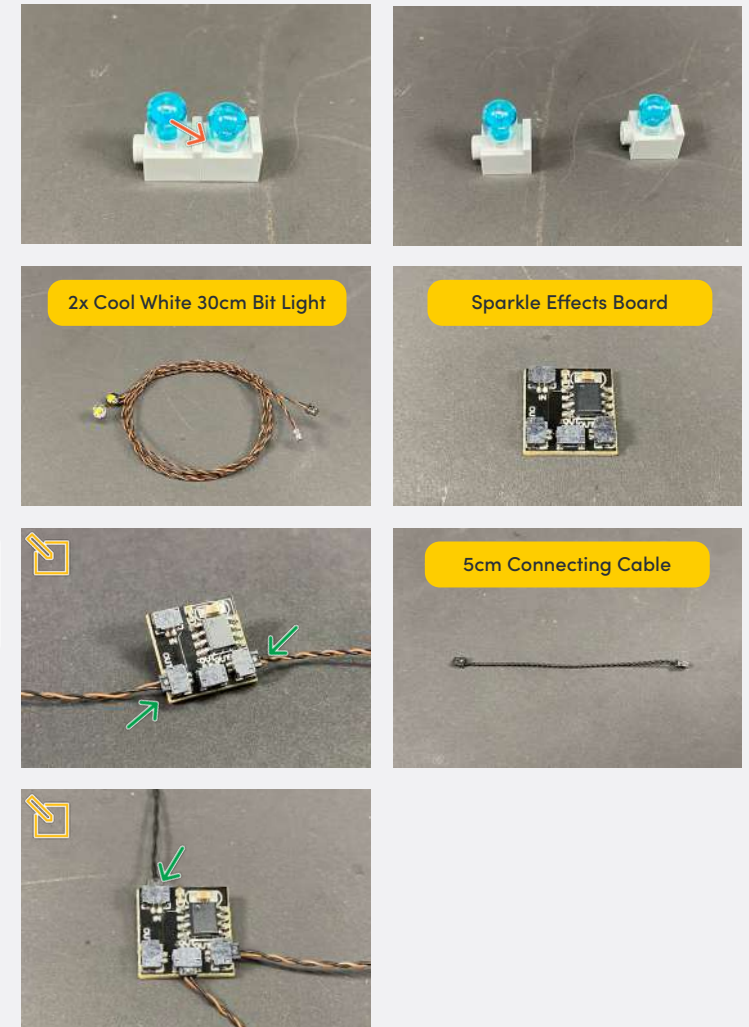

2x Cool White 30cm Bit Light

Sparkle Effects Board

✂ Connect 2x Cool White 30cm Bit Lights to the exact OUT ports as shown

✂ Connect the 5cm Connecting Cable to the IN port

5cm Connecting Cable

Legend → DISCONNECT → CONNECT / RECONNECT ↻ TURN / FLIP → DIRECTIONAL ↻ TWIST / BRAID * POWER ON TEST ✂ NOTE ICON

📌 If you experience any issues with the lights not working and suspect an issue with a component, please try a different port on the expansion board to verify where the fault lies (with the light or expansion board). To correct any issues with expansion board ports, please view the section addressing expansion board issues in our troubleshooting section.

6

📌 Ensure the LED is facing the back of the brick as shown

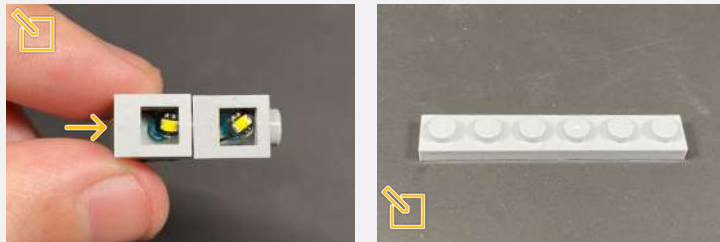
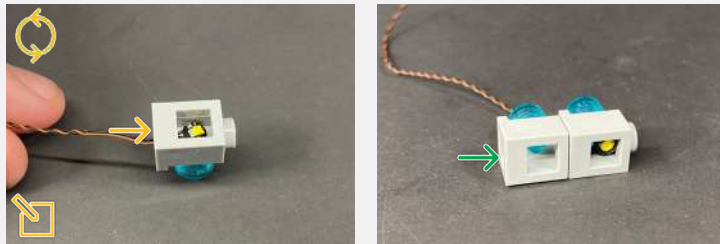

📌 Secure the second Bit Light with the 1x6 Plate from Step 4

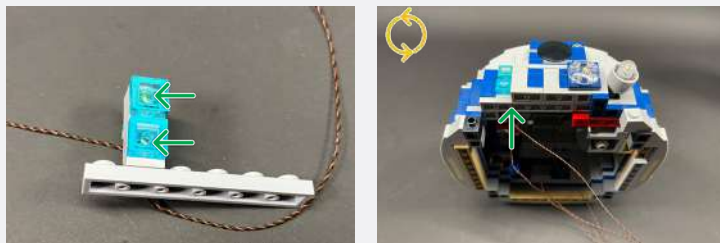
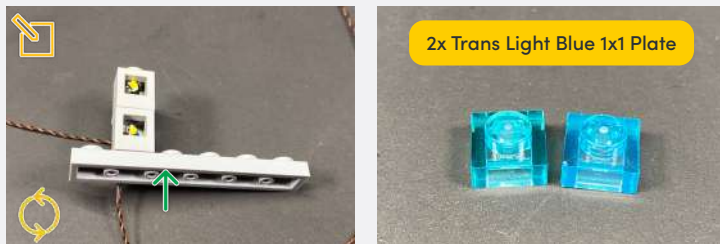

📌 Connect the two Bit Lights from step 2 and 3 as well as the 5cm Connecting Cable to the 12-Port Expansion Board

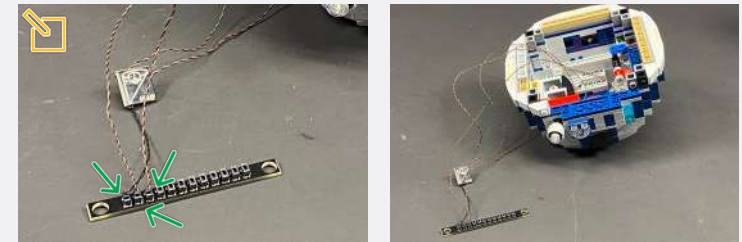
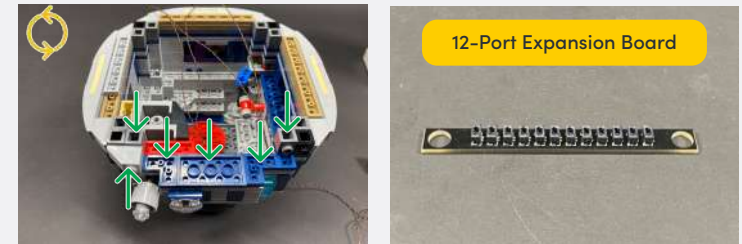

7

📌 Connect to a USB Power Bank, USB to AA Battery Pack or USB Wall Adaptor (each sold separately)

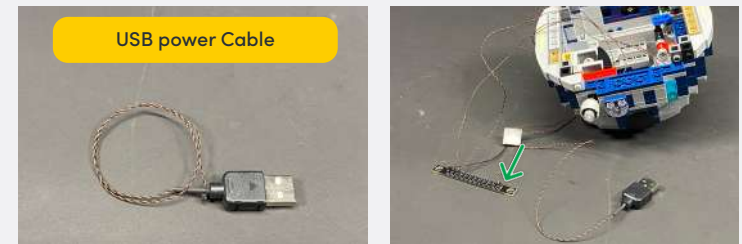

Legend

- DISCONNECT
- CONNECT / RECONNECT
- ↻ TURN / FLIP
- DIRECTIONAL
- ↻ TWIST / BRAID
- ☀️ POWER ON TEST
- 📌 NOTE ICON

8

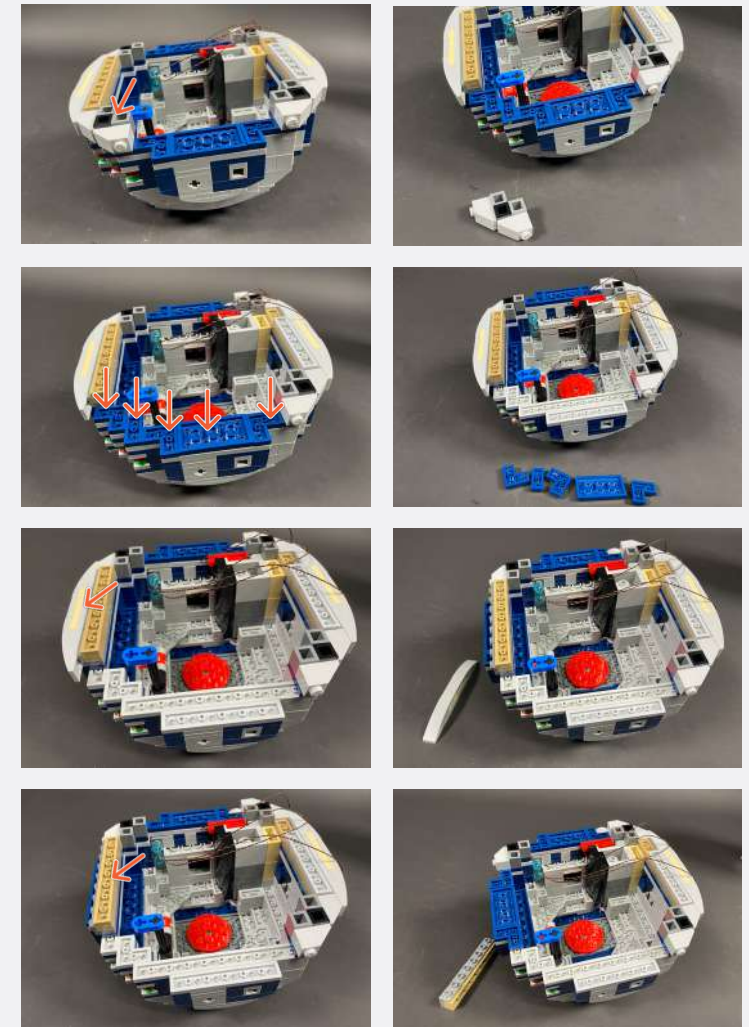
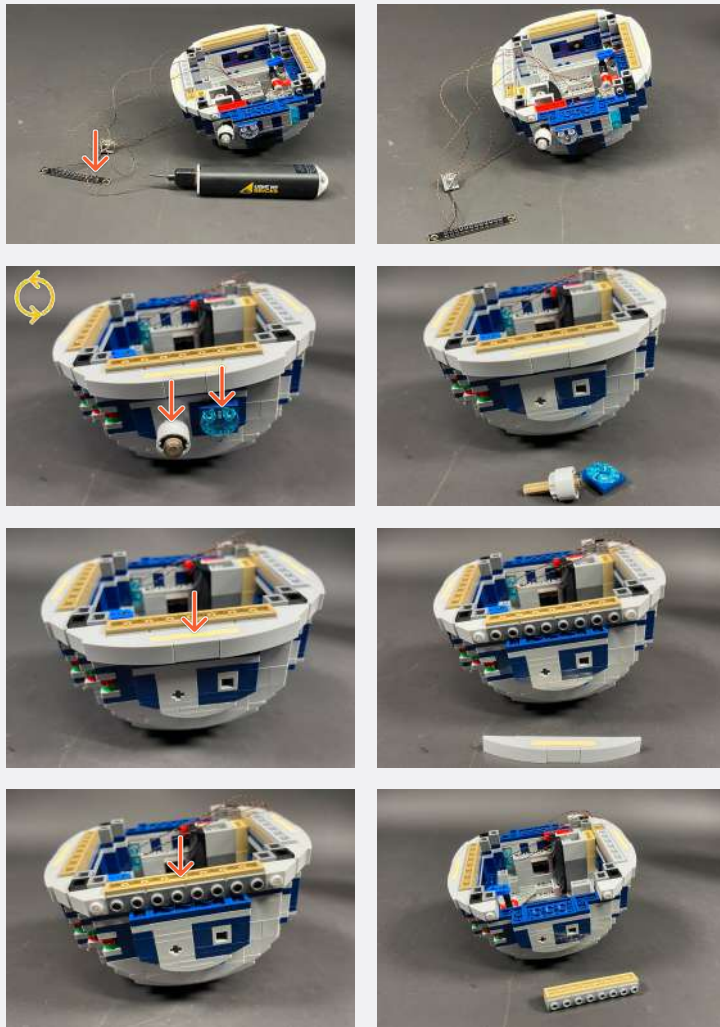

Legend → DISCONNECT → CONNECT / RECONNECT ↻ TURN / FLIP → DIRECTIONAL ↻ TWIST / BRAID ✨ POWER ON TEST 📝 NOTE ICON

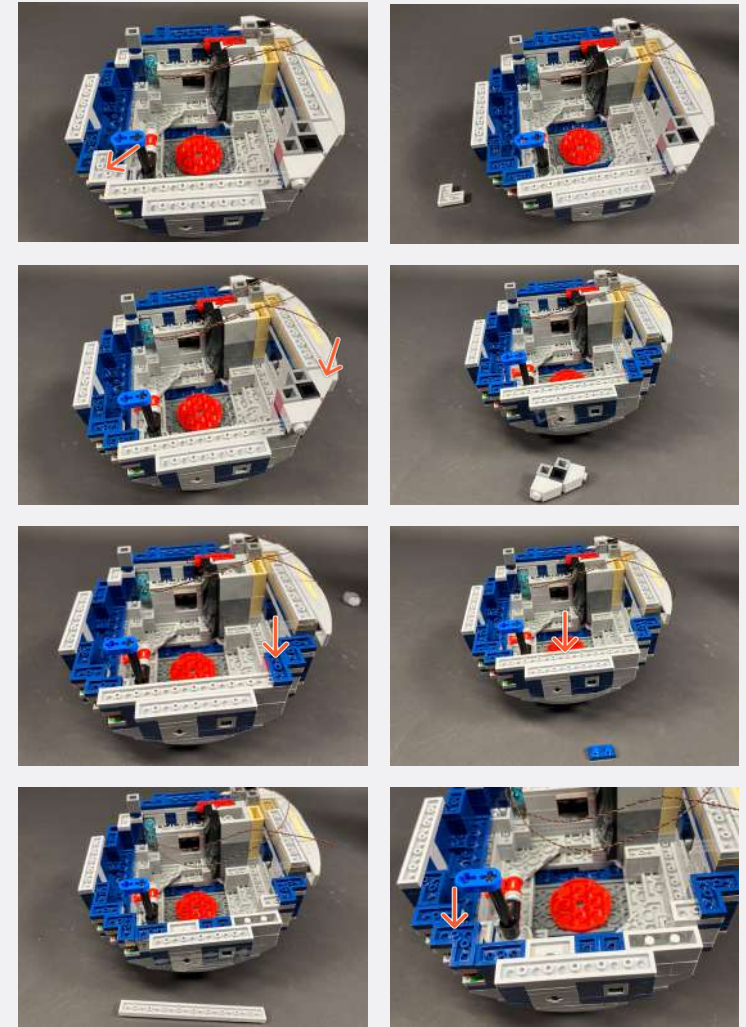
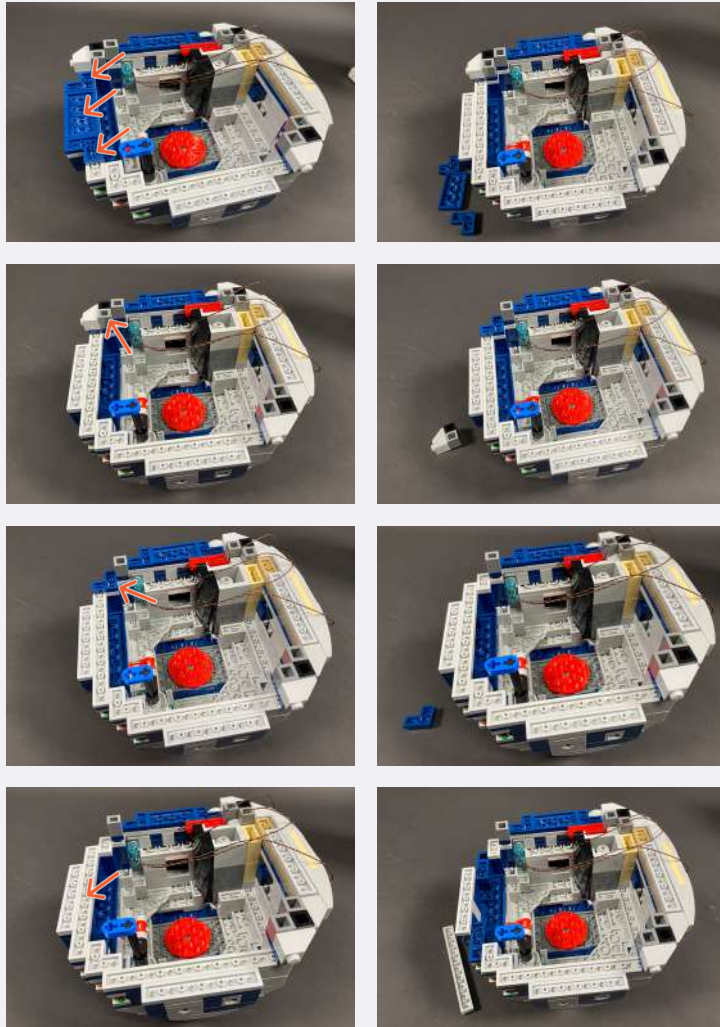

Legend

- DISCONNECT
- CONNECT / RECONNECT
- TURN / FLIP
- DIRECTIONAL
- TWIST / BRAID
- POWER ON TEST
- NOTE ICON

9

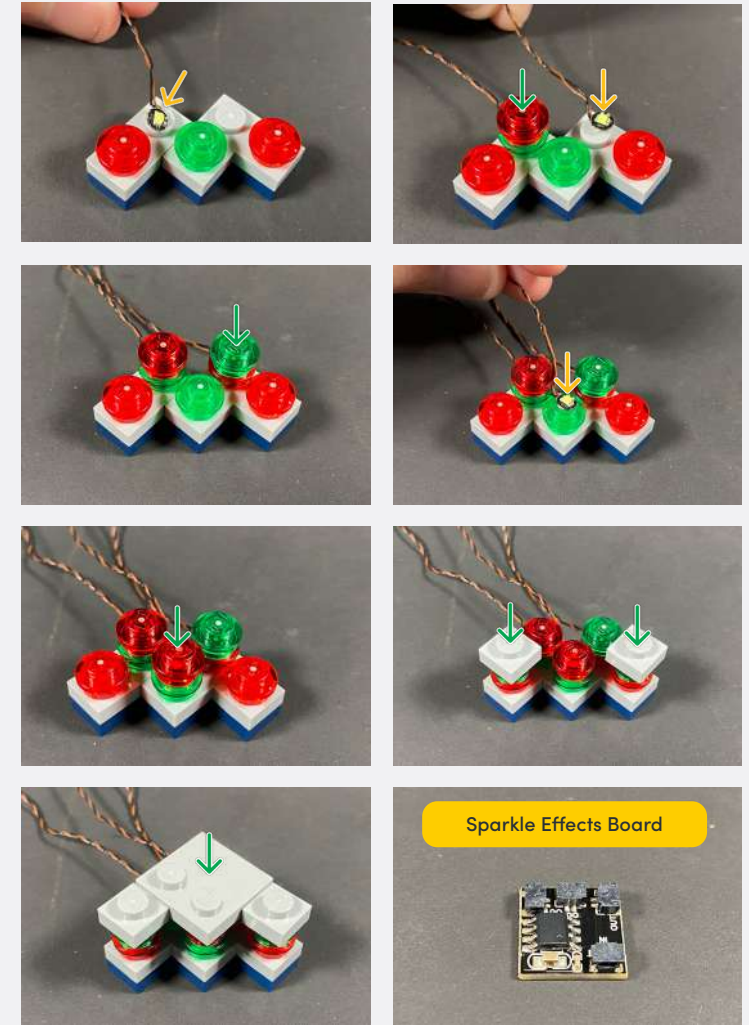
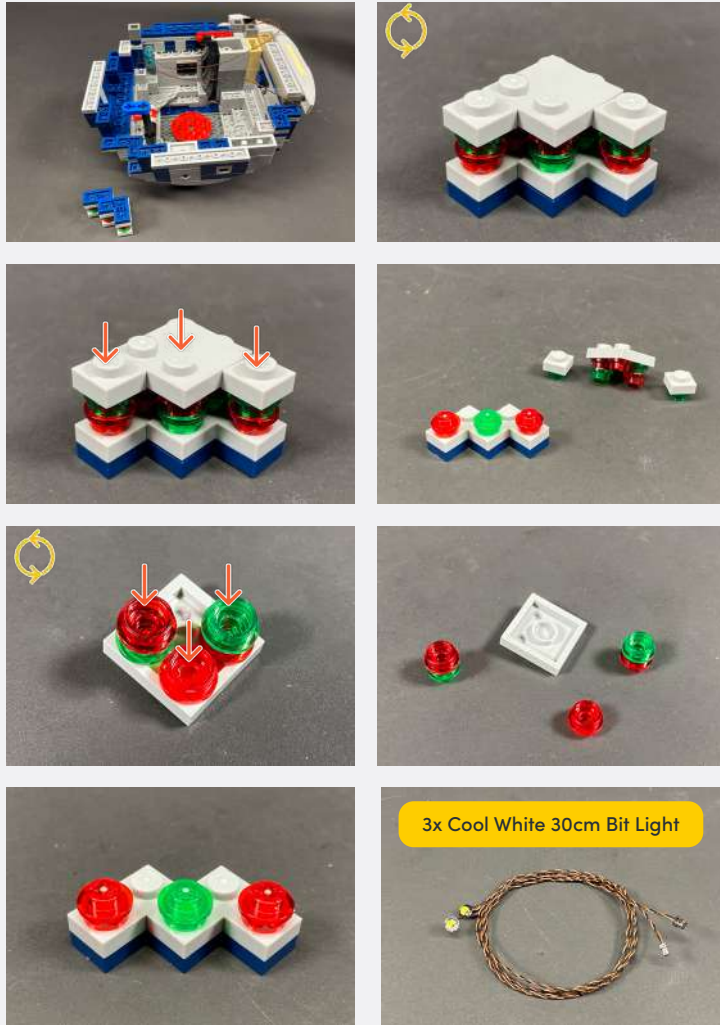

Legend → DISCONNECT → CONNECT / RECONNECT ↻ TURN / FLIP → DIRECTIONAL ↻ TWIST / BRAID ✨ POWER ON TEST 📝 NOTE ICON

✍️ Connect the three Bit Lights to the OUT ports of the Sparkle Effects Board

10



11

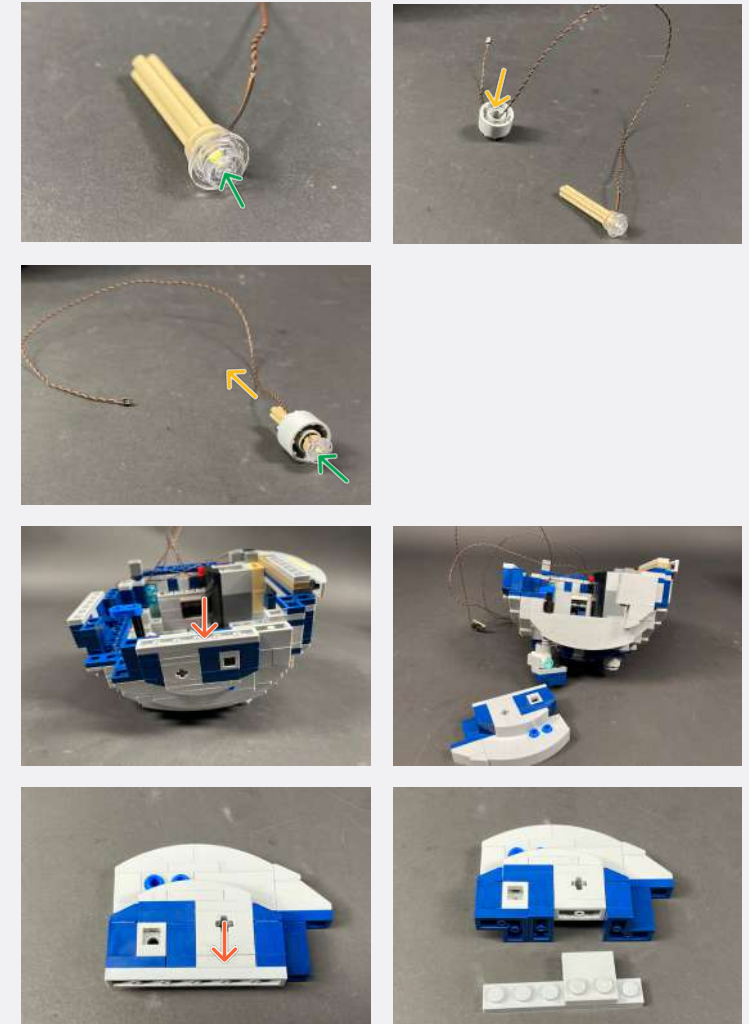

Legend

- DISCONNECT
- CONNECT / RECONNECT
- ↻ TURN / FLIP
- DIRECTIONAL
- ↻↻ TWIST / BRAID
- ✳️ POWER ON TEST
- ✍️ NOTE ICON

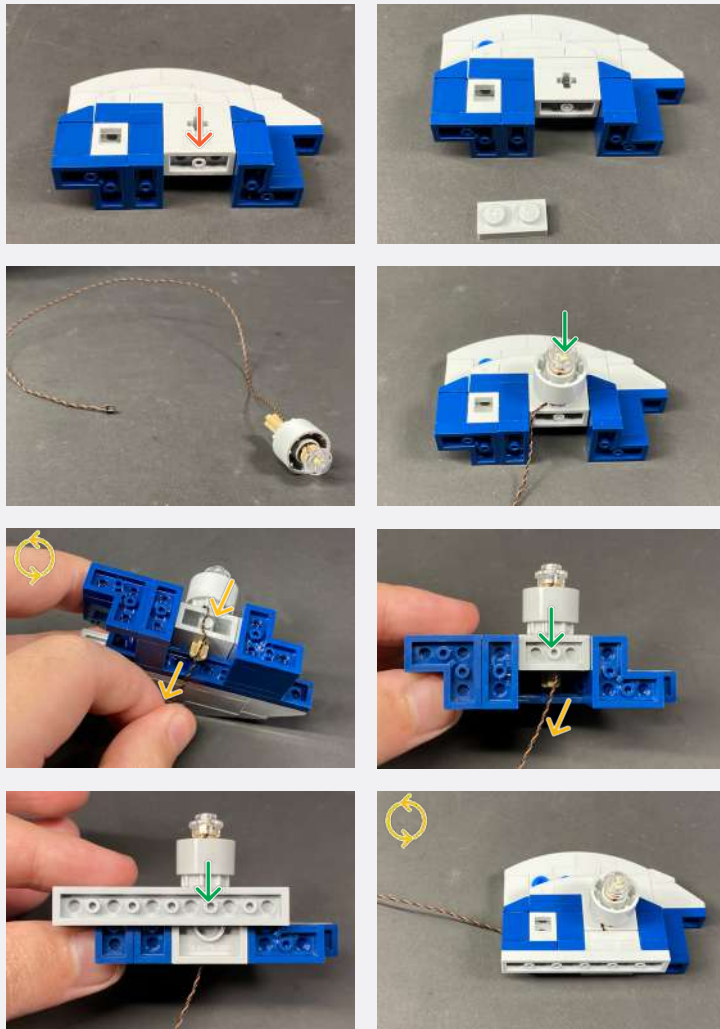

12

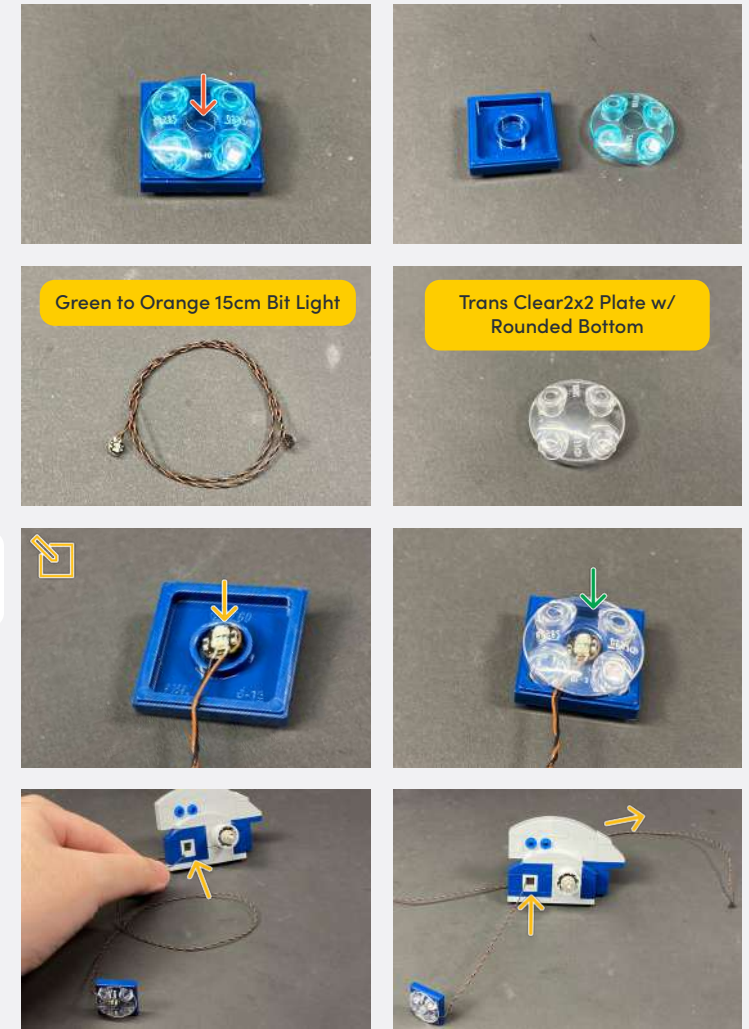

Legend

- DISCONNECT
- CONNECT / RECONNECT
- ↻ TURN / FLIP
- DIRECTIONAL
- ↻↻ TWIST / BRAID
- ✳ POWER ON TEST
- 📌 NOTE ICON

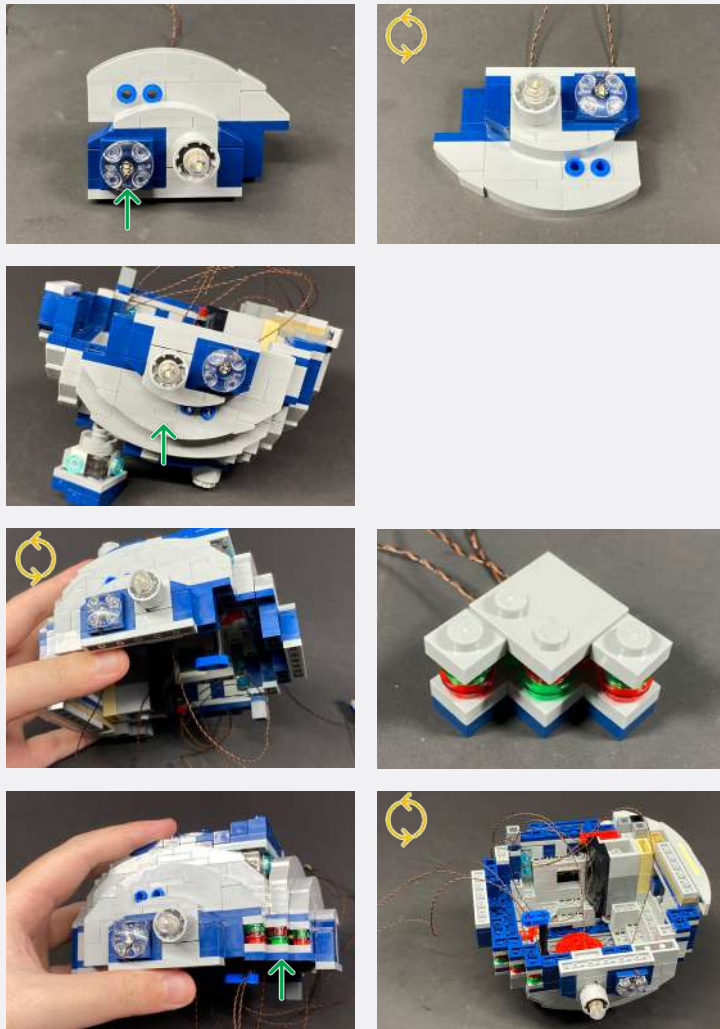

13

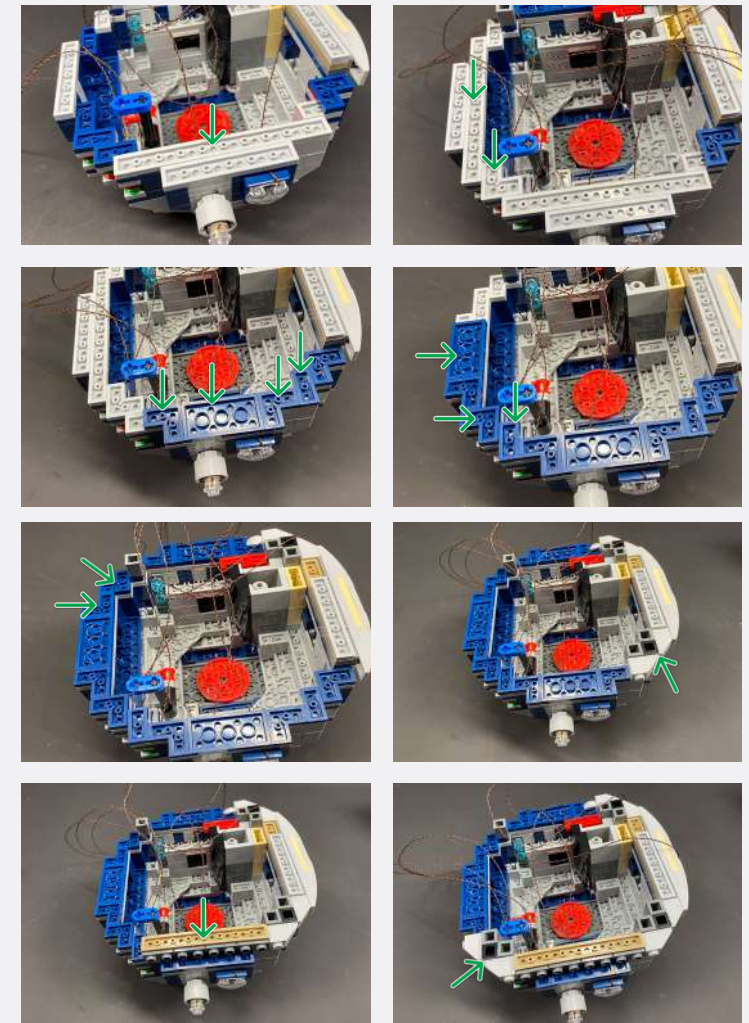

Legend

- DISCONNECT
- CONNECT / RECONNECT
- ↻ TURN / FLIP
- DIRECTIONAL
- ↔ TWIST / BRAID
- ✳ POWER ON TEST
- 📝 NOTE ICON

📌 Reconnect the 'Z' shape LEGO pieces from step 1

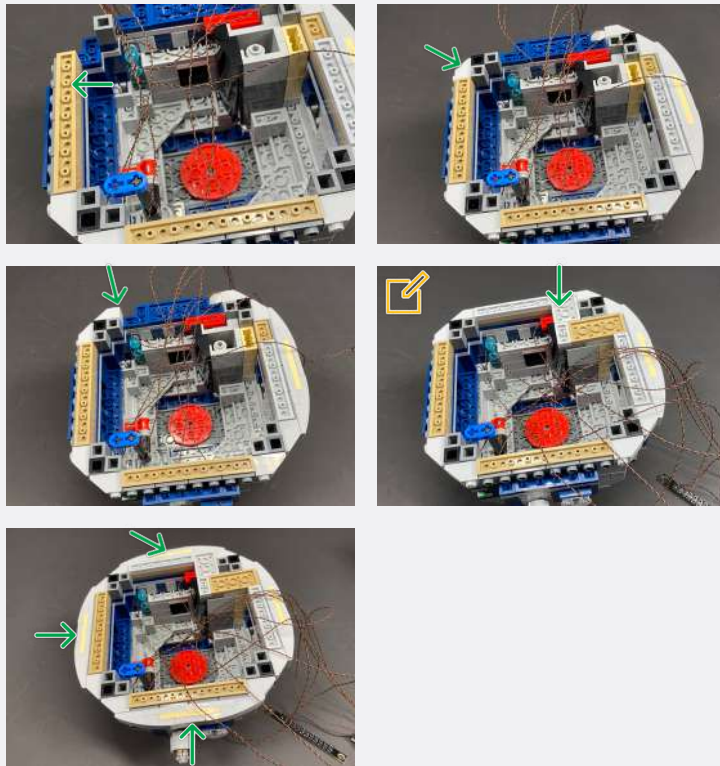

14

📌 Connect the two Bit Lights from step 11 and 12 to the 12-Port Expansion Board

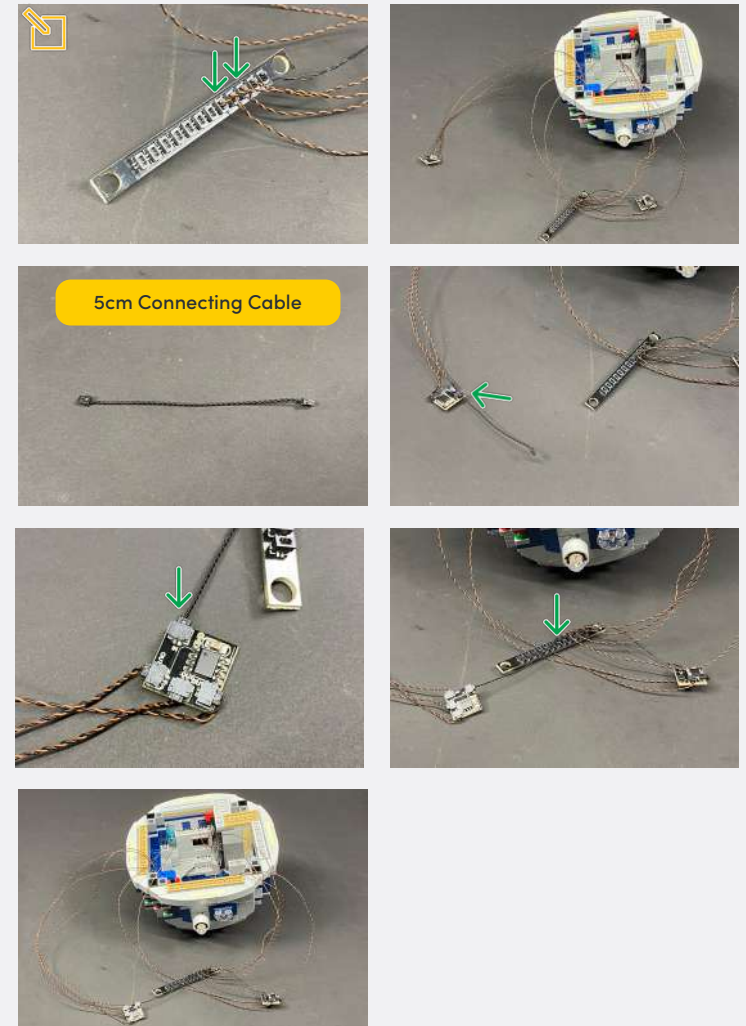

5cm Connecting Cable

Legend

- DISCONNECT
- CONNECT / RECONNECT
- ↻ TURN / FLIP
- DIRECTIONAL
- ↻↻ TWIST / BRAID
- ✳ POWER ON TEST
- 📌 NOTE ICON

If you experience any issues with the lights not working and suspect an issue with a component, please try a different port on the expansion board to verify where the fault lies (with the light or expansion board). To correct any issues with expansion board ports, please view the section addressing expansion board issues in our troubleshooting section.

15

Reconnect the USB Power Cable

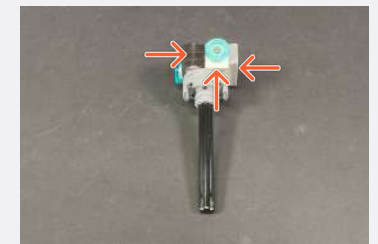
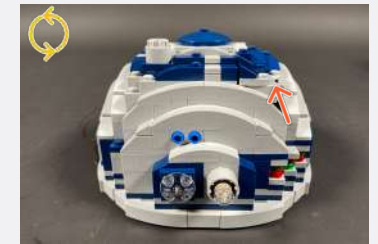
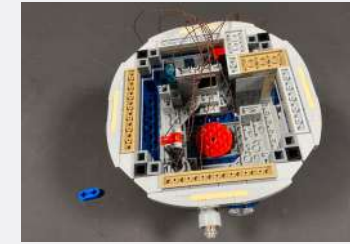
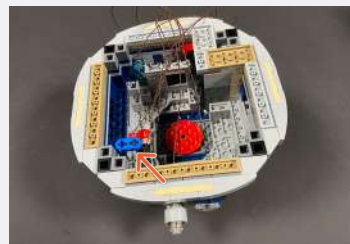
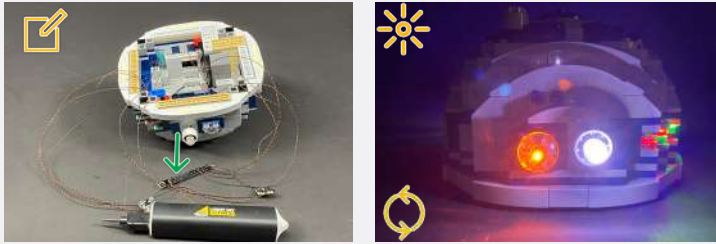

16

Legend

- DISCONNECT
- CONNECT / RECONNECT
- TURN / FLIP
- DIRECTIONAL
- TWIST / BRAID
- POWER ON TEST
- NOTE ICON

✍ The Bit Light should be placed inside the white brick and LED facing toward the trans light blue round tile

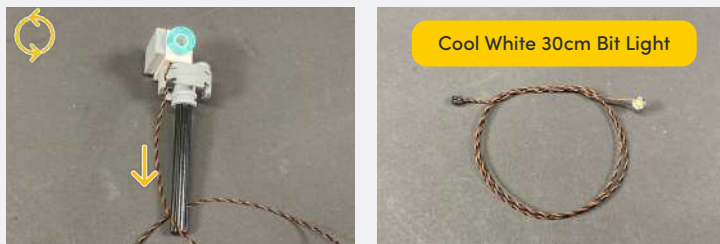
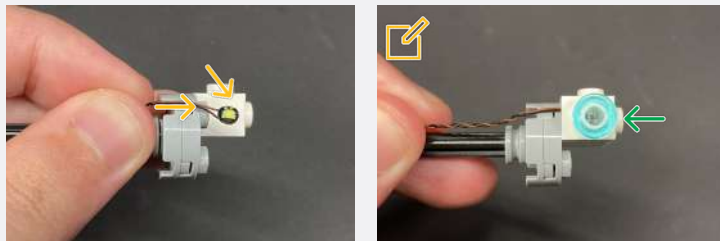
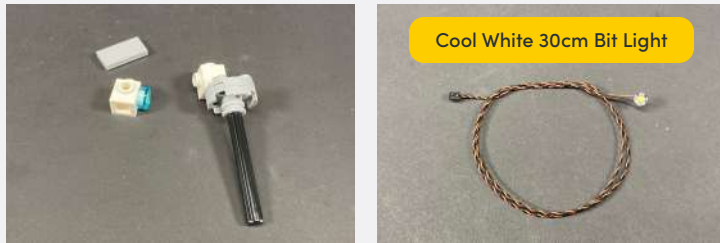

✍ The Bit Light should be placed inside the white brick and LED facing toward the trans light blue round tile

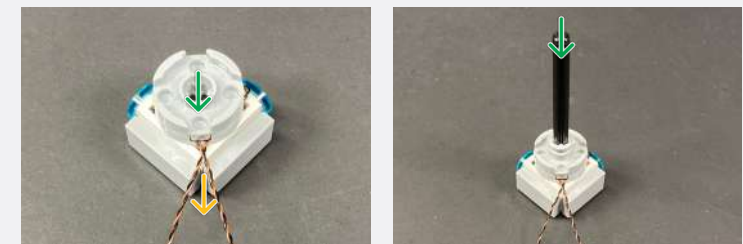
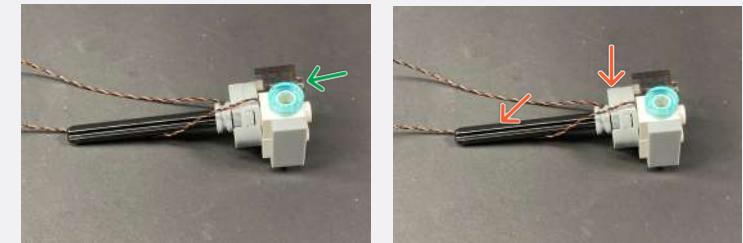
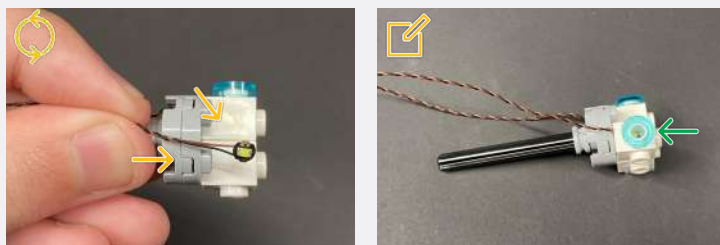

Legend → DISCONNECT → CONNECT / RECONNECT ↻ TURN / FLIP → DIRECTIONAL ↻ TWIST / BRAID ✨ POWER ON TEST ✍ NOTE ICON

📌 If you experience any issues with the lights not working and suspect an issue with a component, please try a different port on the expansion board to verify where the fault lies (with the light or expansion board). To correct any issues with expansion board ports, please view the section addressing expansion board issues in our troubleshooting section.

17

📌 Thread the cables through the pin hole before re-inserting the LEGO piece

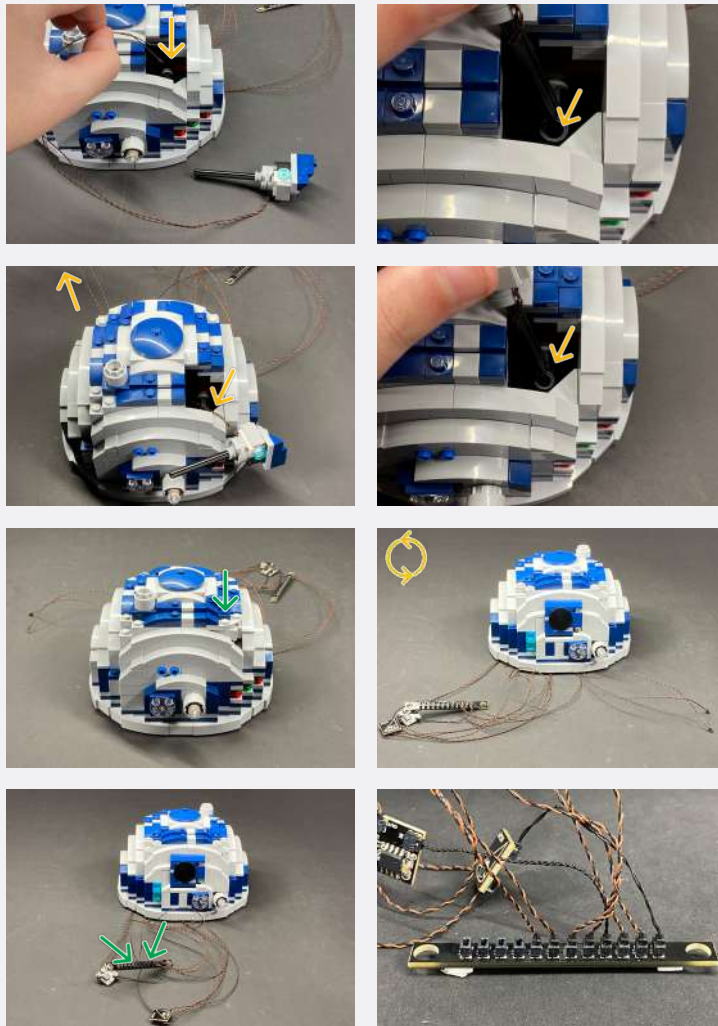

18

📌 Reconnect the USB Power Cable

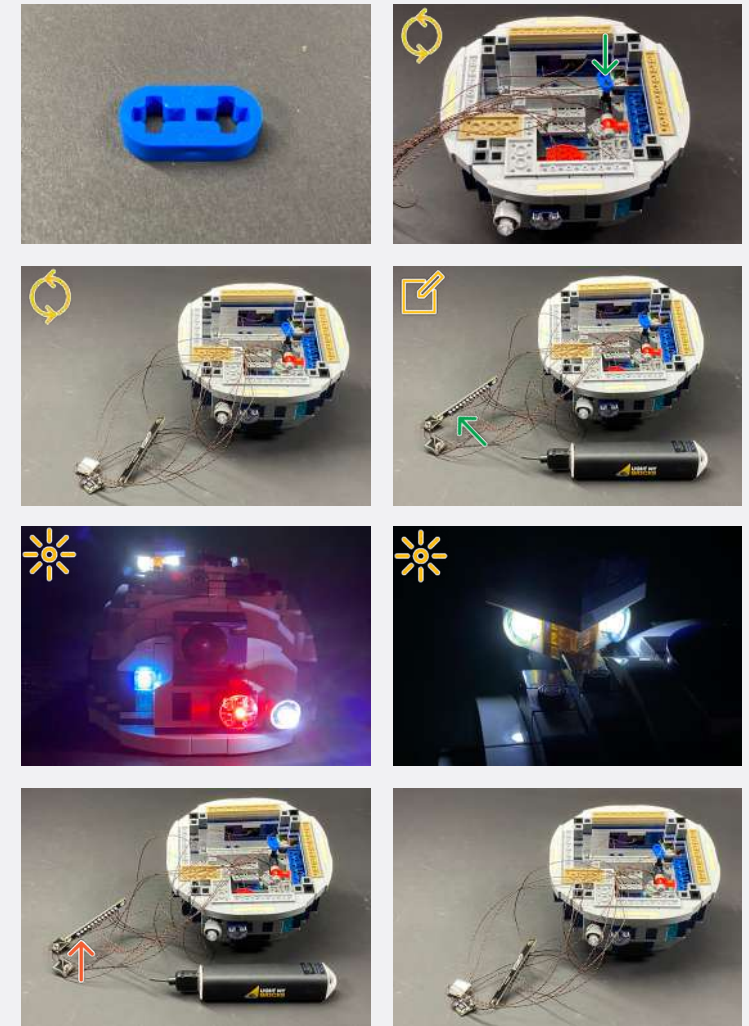

Legend

- DISCONNECT
- CONNECT / RECONNECT
- TURN / FLIP
- DIRECTIONAL
- TWIST / BRAID
- POWER ON TEST
- NOTE ICON

19

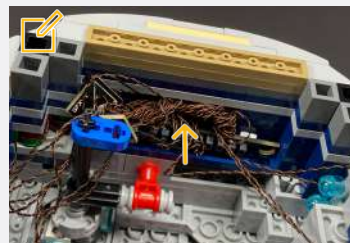
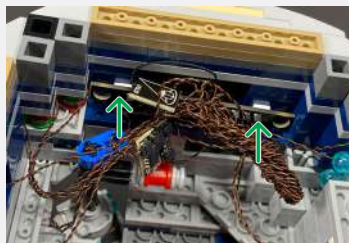
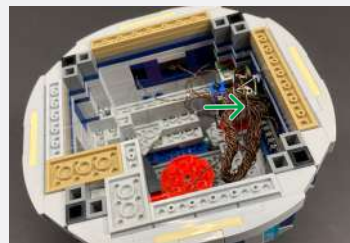
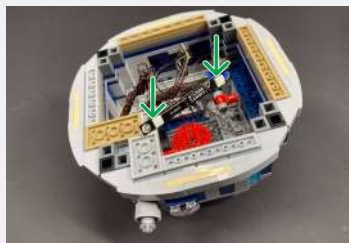
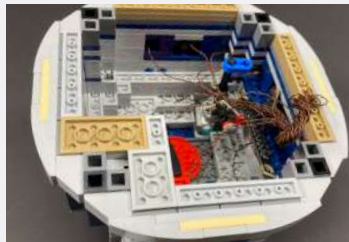
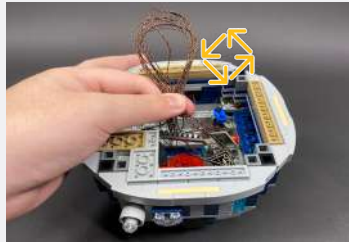

Push excess cable into the gap as shown to neatly secure the cables.

This will ensure they do not get tangled and caught when spinning R2D2's head

20

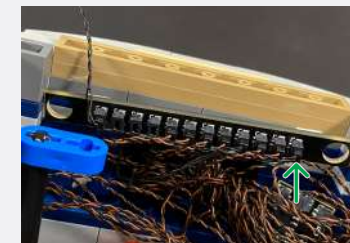

Thread the 50cm Connecting Cable down R2D2's body and then pull it out from the bottom



Legend

- DISCONNECT
- CONNECT / RECONNECT
- TURN / FLIP
- DIRECTIONAL
- TWIST / BRAID
- POWER ON TEST
- NOTE ICON

REMOTE CONTROL & SOUND KIT ADD-ON



If you have purchased the **R2-D2 Light & Sound Kit** please skip to step RC1 (Page 27).



If you have purchased the **R2-D2 Light Kit** (lights only) please continue on to the next step (Page 26).

21

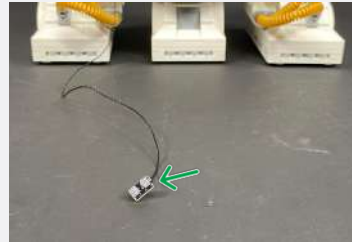
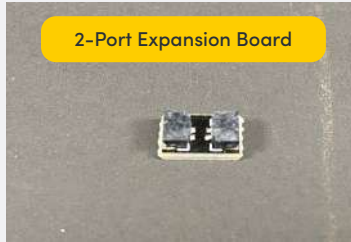

✂ Push the excess cable back up inside R2-D2's body.

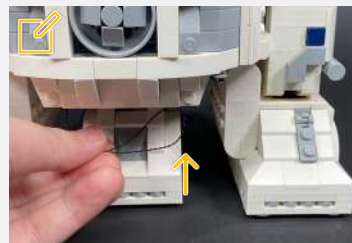
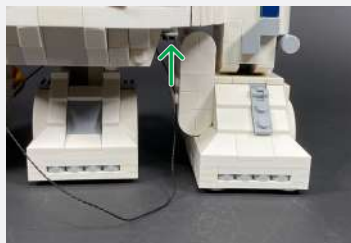

22



Legend

- DISCONNECT
- CONNECT / RECONNECT
- TURN / FLIP
- DIRECTIONAL
- TWIST / BRAID
- POWER ON TEST
- NOTE ICON

REMOTE CONTROL & SOUND KIT ADD-ON



If you have purchased the **Light R2-D2 Light & Sound Kit** please continue to the next page.

RC1



Remote Control & Sound Board
IR Receiver w/ 30cm Cable

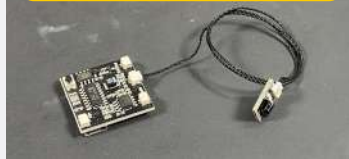

Connect the 50cm Connecting Cable to the 'OUT' port on the Remote Control/Sound Board

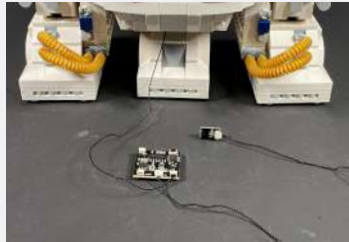
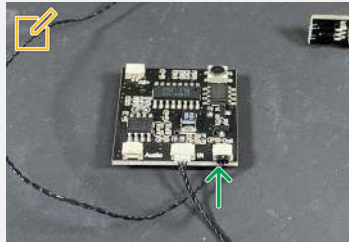

Connect the Audio Speaker Cable to the 'AUDIO' port on the Remote Control/Sound Board

Audio Speaker w/ 15cm Cable

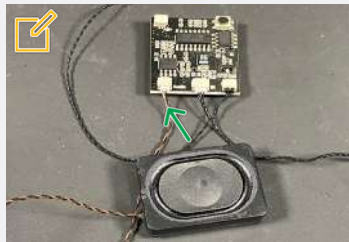
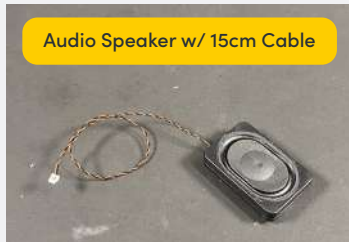

Connect the USB Power Cable to the '+5V' port on the Remote Control/Sound Board

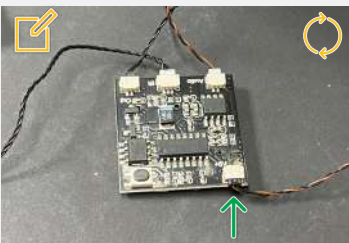

RC2

Remove the plastic tag



To test the remote, lights and sound - point the remote at the IR Receiver and press 'ON'. Once powered on, press the play button to test the sound is working



LED LIGHT BRIGHTNESS ADJUST

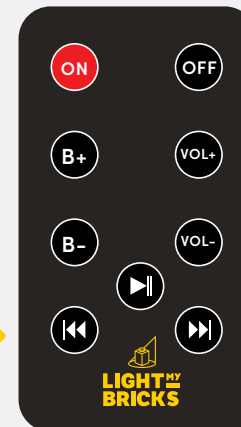

VOLUME INCREASE / DECREASE



AUDIO TRACK PREVIOUS



AUDIO TRACK NEXT



Click here for instructions on how to load your desired MP3 files onto the provided Micro SD Card.

Legend

- DISCONNECT
- CONNECT / RECONNECT
- TURN / FLIP
- DIRECTIONAL
- TWIST / BRAID
- POWER ON TEST
- NOTE ICON

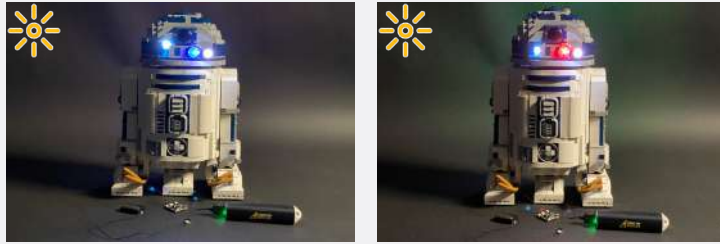

Temporarily turn off the power



RC3

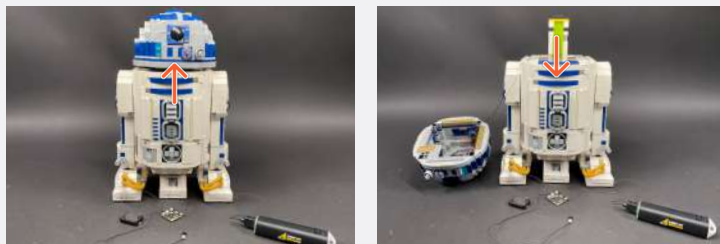

RC4

Place the Sound Board in the position as shown, where it is secured in place behind the Red Technic Pin w Tow Ball

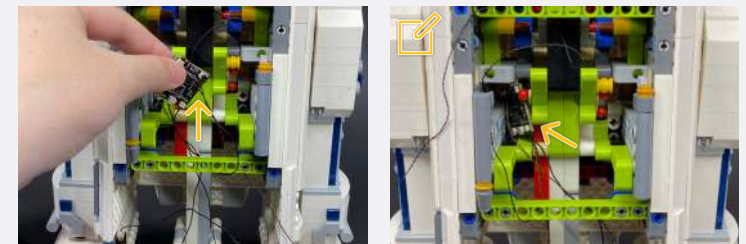
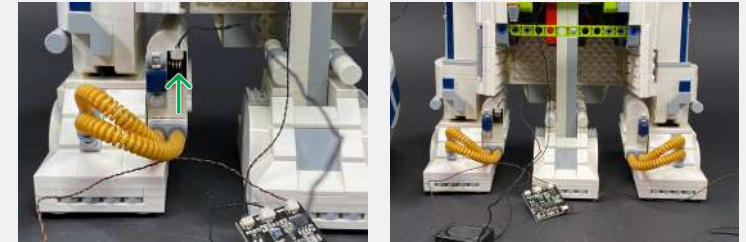

Legend

- DISCONNECT
- CONNECT / RECONNECT
- TURN / FLIP
- DIRECTIONAL
- TWIST / BRAID
- POWER ON TEST
- NOTE ICON

RC5

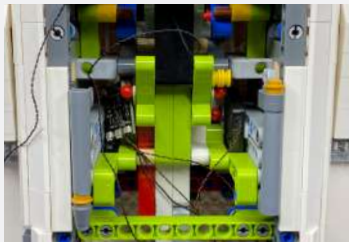
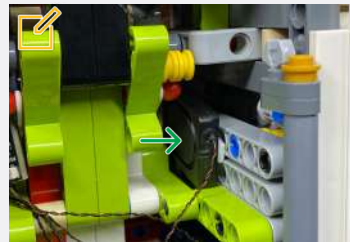
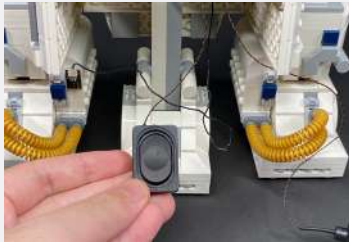
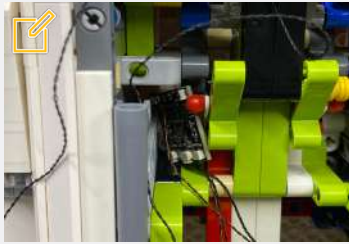

Place the speaker on the opposite side against the inside of the right panel

RC6

Push the USB Power Bank back behind R2-D2

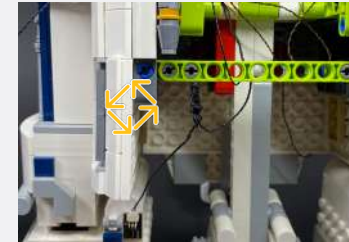
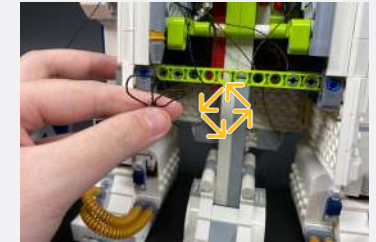
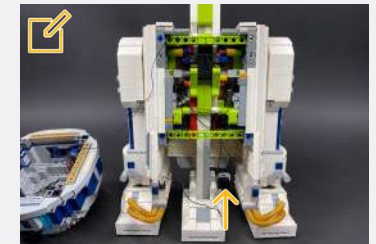
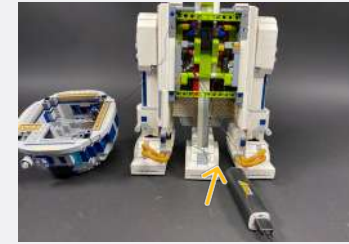

Legend

- DISCONNECT
- CONNECT / RECONNECT
- TURN / FLIP
- DIRECTIONAL
- TWIST / BRAID
- POWER ON TEST
- NOTE ICON

RC7

Using the Technic Pins w Friction Ridges, Lengthwise and Pinhole pieces that you previously removed in step RC3, reconnect them in place as shown

CAUTION: Ensure you hold the LEGO Technic Liftarm (green piece) forward when reconnecting the Technic Pins

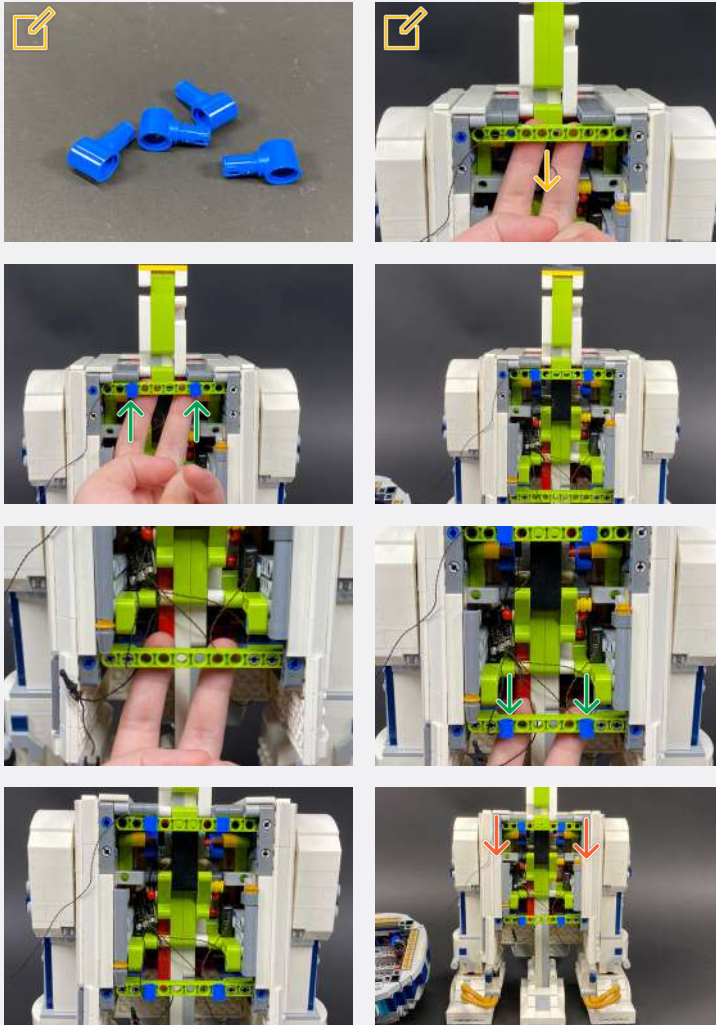

RC8

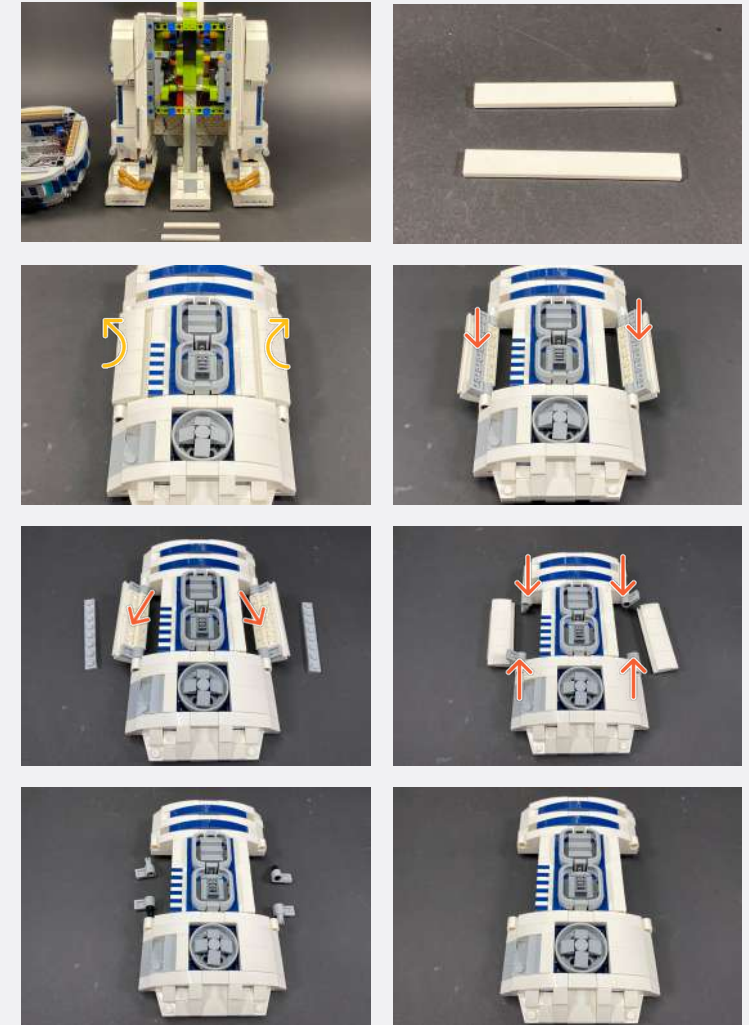

Legend



DISCONNECT



CONNECT / RECONNECT



TURN / FLIP



DIRECTIONAL



TWIST / BRAID



POWER ON TEST



NOTE ICON

RC9

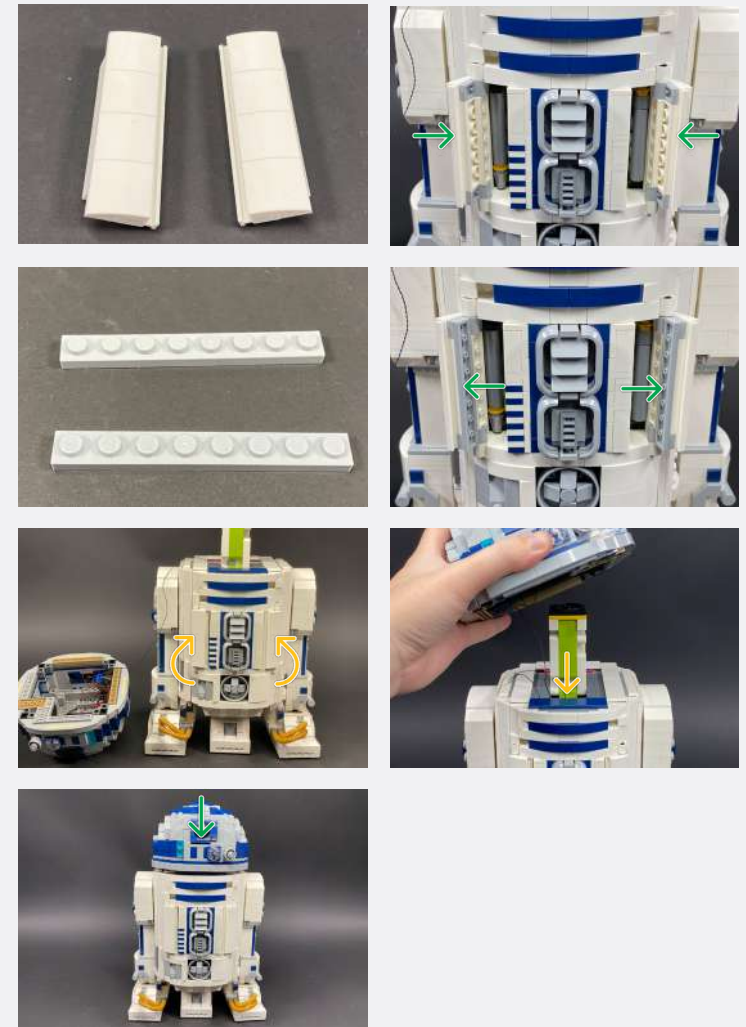
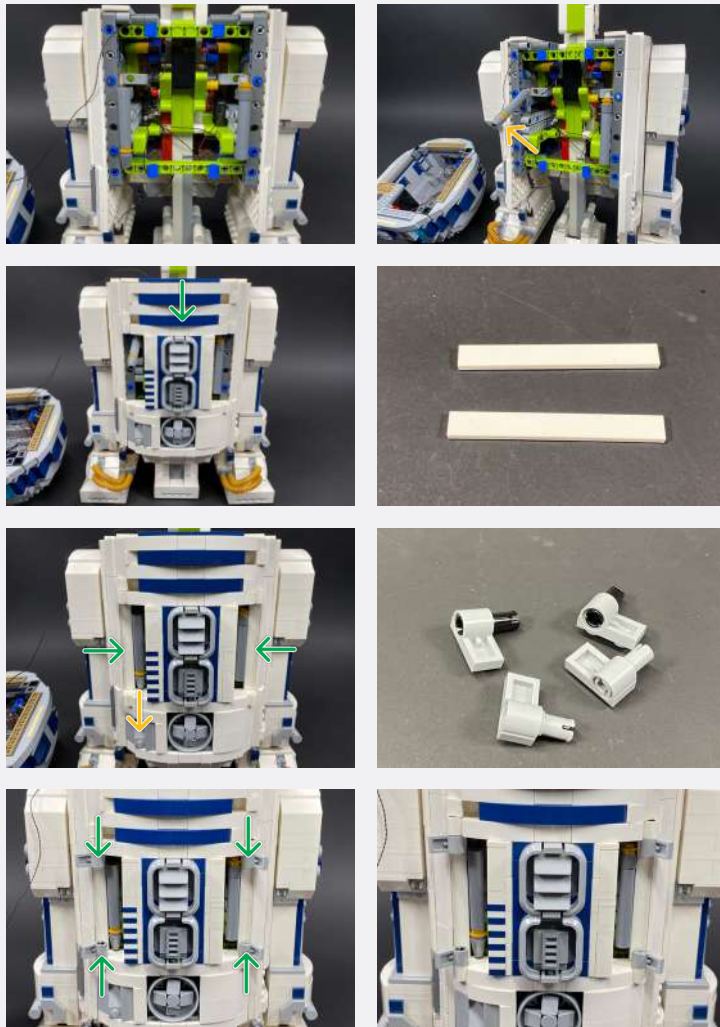

Legend

- DISCONNECT
- CONNECT / RECONNECT
- ↻ TURN / FLIP
- DIRECTIONAL
- ↻↻ TWIST / BRAID
- ✳ POWER ON TEST
- 📝 NOTE ICON

RC10

✍ Ensure the power source is turned on before powering ON the lights with the Remote Control

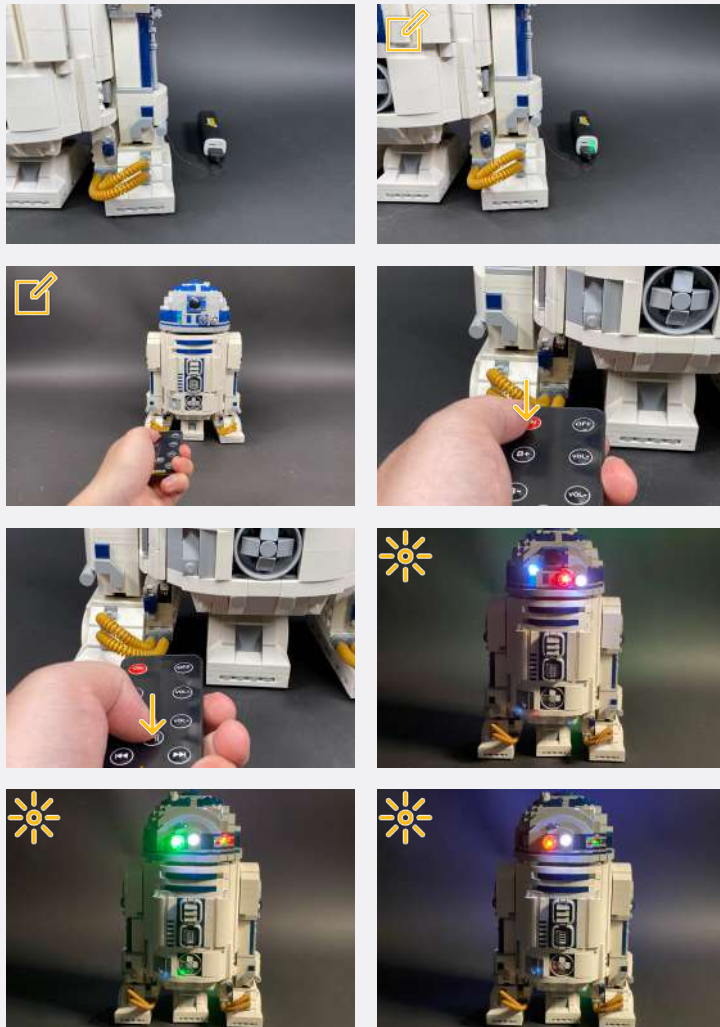

Legend → DISCONNECT → CONNECT / RECONNECT ↻ TURN / FLIP → DIRECTIONAL ↻ TWIST / BRAID ✨ POWER ON TEST ✍ NOTE ICON

FINAL PRODUCT

This finally completes installation of the Light My Bricks R2-D2 75308 Light & Sound Kit.





TROUBLESHOOTING

Light My Bricks lighting kits contain individual components that are very small and can be easily damaged if not handled correctly.

To prevent unnecessary damage to components, we highly recommend that the User Guide section, **“Important things to note”** is read carefully. Follow the handling procedures in the User Guide to help prevent faults and damages to your Light My Bricks components.

If you are experiencing issues with your Light My Bricks set, watch our troubleshooting video [here](#) or read on for a list of common causes to help you troubleshoot.

Troubleshooting

Firstly, ensure that the batteries have power using a battery charge gauge.

If the batteries have no power, replace the batteries.

If the batteries still have power, check to see if the batteries have been inserted correctly into the battery pack.

Check For CR2032 Batteries Using The Flat Battery Pack

Inside the battery pack is a symbol indicating which side the (round) CR2032 battery should be inserted. Check that the “+” side of the battery pack has the battery with the “+” symbol facing downwards.

On the opposite side, the “-” side of the battery pack should have the battery flipped upside down, that is the “+” symbol facing upwards.

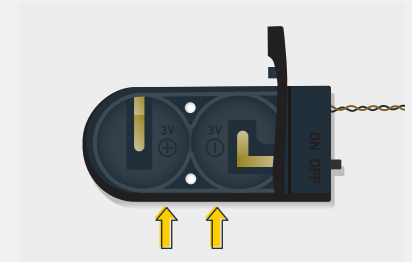

Troubleshooting

Check For Cr2032 Batteries Using The Round Battery Pack

Inside the battery pack is a symbol indicating which side the (round) CR2032 battery should be inserted. In this case, for the stacked battery pack, ensure that BOTH batteries have the “+” symbol facing upwards.

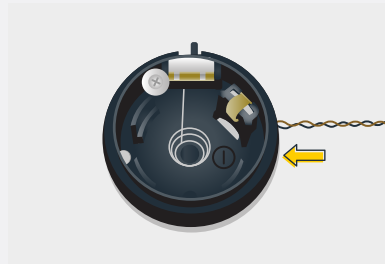

Check for AA batteries using the AA battery pack

Inside the battery pack are symbols indicating which direction the AA battery should be inserted. The flat side of the battery should be paired with the spring side of the battery pack.

If the batteries have been installed correctly and your kit still isn't operating correctly, the next step is to check the wiring.

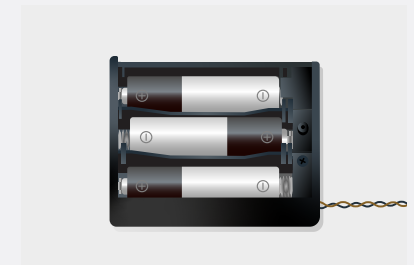
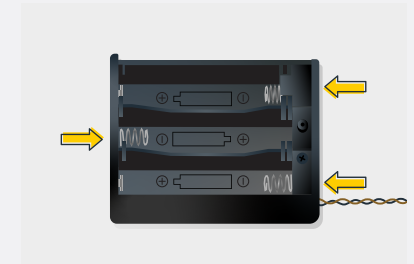

Troubleshooting

Check Your Wires

In order for Light My Bricks components to fit in between and underneath LEGO® bricks, the components need to be very small. Due to this nature, Light My Bricks components can be easily damaged when not handled correctly.

Be careful when removing unpacked components out of the packaging and ensure not to forcibly pull at the wires as this can damage the soldering that attach the wires to the LEDs.

If the wiring is detached from the LED itself, the light will not operate.

When connecting lights to your LEGO set, check that there are no pinched wires underneath or in between bricks and plates. When the wires are pinched and the exposed wires are touching each other, this can cause a crosswire and the lights to not function correctly.

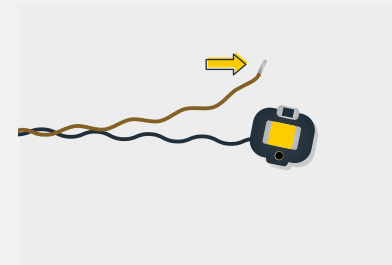
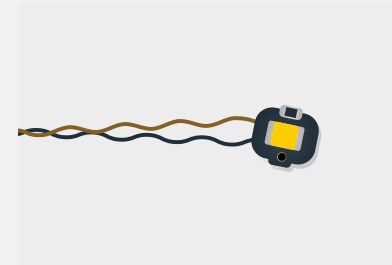

Troubleshooting

Check Your Expansion Board Ports/ Strip Light Ports / Effects Board Ports

It is important to note that connectors can only be inserted to the expansion board, strip light, or effects board ports in one direction.

Forcibly inserting connectors in the incorrect direction will result in damaging the pins inside each of the ports on your component board.

Not only will a light connected to the damaged port not work, but if the pins inside the port are bent to a point they are touching each other, this can result in all other lights in the system to stop working. This is a short circuit.

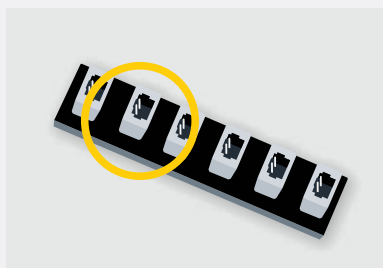

A short circuit can also result in overheating of the board, cable or batteries. If you suspect a short circuit, **DISCONNECT POWER IMMEDIATELY**. Batteries can fail, catch fire, or even explode if left connected to a short circuit for too long.

If you suspect you have a faulty component due to a bent pin, try the following steps:

If you look carefully inside each of the ports, each port contains 2 small pins that should be straight. You will be able to identify a faulty port if it has any bent pins.

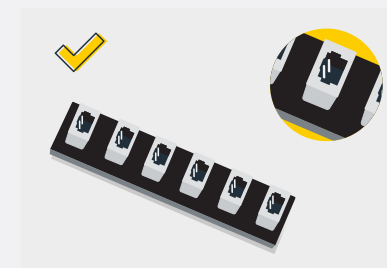
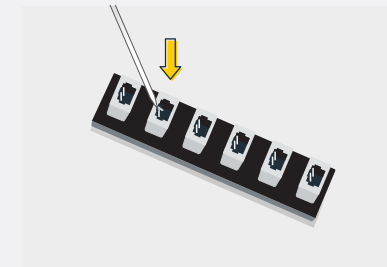



CONTACT US

If you have an enquiry regarding the online shop, our products or a general enquiry please refer to our Frequently Asked Questions webpage here.

Alternatively, you can contact our Customer Services team by visiting our online support portal here.

support.lightmybricks.com

We thank you for purchasing this product and hope you enjoy!



lightmybricks.com