



**LIGHT<sup>MY</sup>  
BRICKS**



**LEGO<sup>®</sup> HOGWARTS EXPRESS  
COLLECTORS' EDITION #76405  
LIGHT KIT  
INSTALLATION GUIDE**

# Light My Bricks



## LEGO® HOGWARTS EXPRESS - COLLECTORS' EDITION 76405 INSTALLATION GUIDE

Hi There!

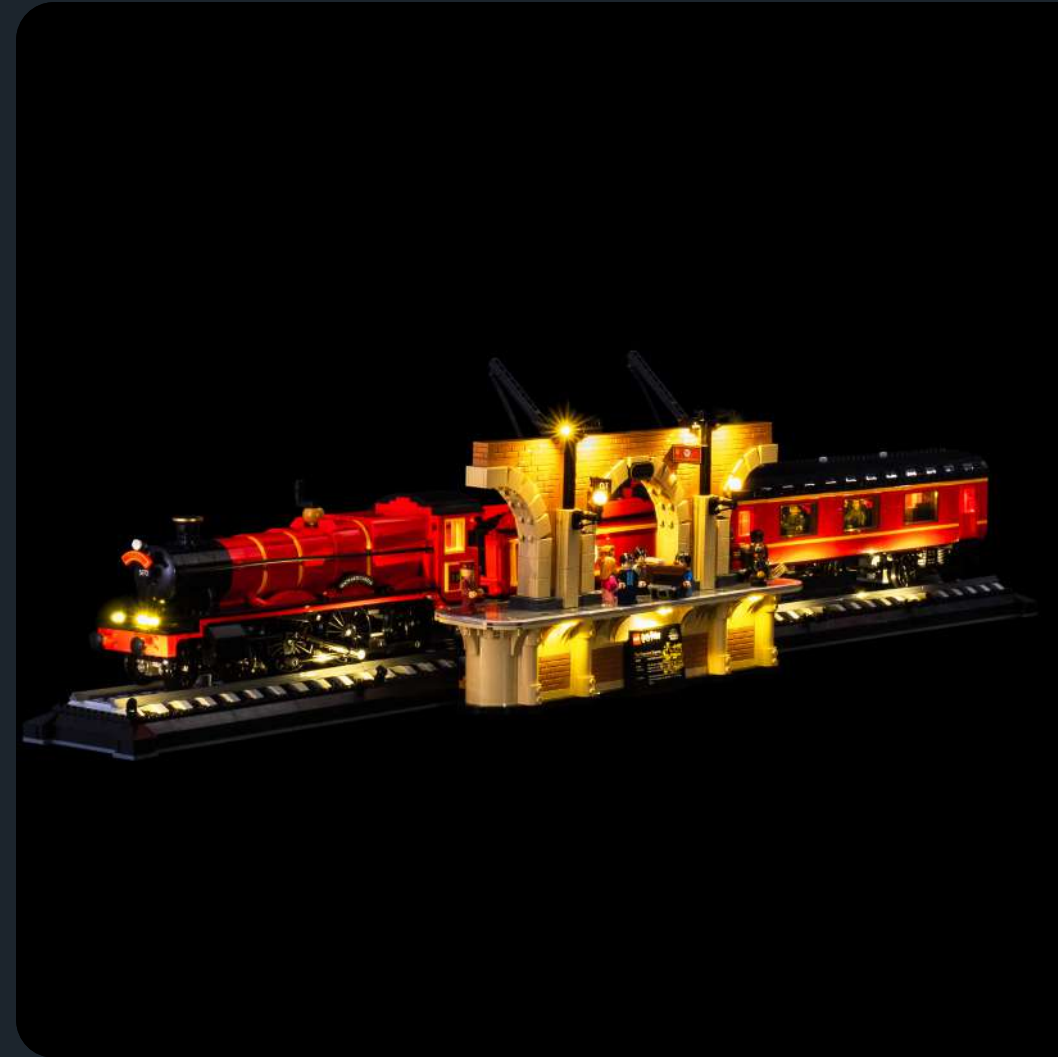
We're here to help you get started on the LEGO®

Hogwarts Express - Collectors' Edition 76405 Light Kit.

This PDF details the instructions for the LED light kit only. If you are wishing to purchase this product, please [click here](#) to view the product page.

If you run into any issues, please refer to the troubleshooting section towards the end of this guide.

Have fun and enjoy!





## PACKAGE CONTENTS:



15 x White 30cm Bit Light\*  
 2 x Red 30cm Bit Light  
 16 x Warm White 30cm Large Bit Light\*



2 x 2-Port Expansion Board  
 5 x 6-Port Expansion Board  
 5 x 8-Port Expansion Board\*



2 x 15cm Connecting Cable  
 3 x 30cm Connecting Cable  
 6 x 50cm Connecting Cable\*



1x USB Power Cable  
 (Power Source not Included)

+ 12 x Adhesive Square

## ASSORTED BRICKS:

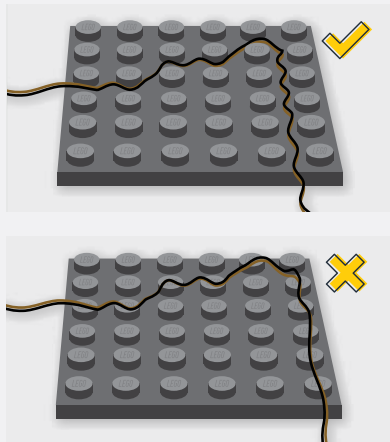
- 6 x Plate 2x2 W Rounded Bottom - Trans Clear
- 1 x Round Plate 1x1 - Trans Yellow
- 15 x Round Plate 1x1 w/ Open Stud - Black
- 17 x Mod Plate 1x1 w/ Handle - Black
- 8 x Arm Skeleton, Bent with Clips (Horizontal Grip) - Black
- 1 x Tile 1x1 W Clip Round Edges - Black
- 2 x Tile 1x2 - Black

\* Indicates components which include spares

## Contents

Before You Begin	5
Blueprint	10
Instructions	12
Final Product	81
Troubleshooting	82
Contact	86

## Before You Begin



### Laying cables in between and underneath bricks

Cables can fit in between and underneath LEGO® bricks, plates, and tiles providing they are laid correctly between the LEGO® studs. Do NOT forcefully join LEGO® together around cables; instead ensure they are laying comfortably in between each stud.

*CAUTION: Forcing LEGO® to connect over a cable can result in damaging the cable and light.*



### Connecting Cable Connectors To Expansion Boards

Take extra care when inserting connectors to ports of Expansion Boards. Connectors can be inserted only one way. With the expansion board facing up, look for the soldered "=" symbol on the left side of the port. The connector side with the wires exposed should be facing toward the soldered "=" symbol as you insert into the port. If a plug won't fit easily into a port connector, do not force it.

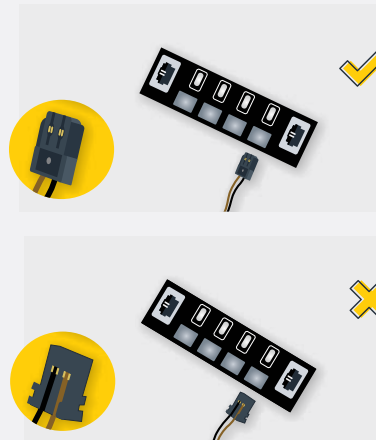
*Incorrectly inserting the connector can result in bent pins inside the port or possible overheating of the expansion board when connected.*

## Before You Begin



### Connecting Cable Connectors To Strip Lights

Take extra care when inserting connectors to ports on the Strip Lights. Connectors can be inserted only one way. With the Strip Light facing up, ensure the side of the connector with the wires exposed is facing down. If a plug won't fit easily into a port connector, don't force it. Doing so will damage the plug and the connector.



### Connecting Micro Cable Connectors To Micro Expansion Board Ports

Take extra care when inserting the micro connectors to micro ports of Micro Expansion Boards. Connecting Micro Bit Lights to Micro Expansion Boards is similar to connecting lights and cables to Strip Lights. With the expansion board facing up, ensure the side of the connector with the wires exposed is facing down. If a plug won't fit easily into a port connector, do not force it. Use your fingernail to push the plastic part of the connector to the micro port.

## Before You Begin

### Installing Bit Lights Under Lego® Bricks And Plates

When installing Bit Lights under LEGO® pieces, ensure they are placed the correct way up (Yellow LED component exposed). You can either place them directly on top of LEGO® studs or in between.



# Before You Begin

## The Symbols Used In This Guide

When going through the following guide you will come across symbols and formats that will assist with the installation of your light kit. Take notice of them as each has a specific purpose.

### Light Kit Component

This is the most important image format as it indicates which part to use from the Light Kit. Make sure you pay close attention to which part is shown.



### Connect

Used when you need to connect a LEGO piece or LMB component.



### Disconnect

Used when you need to remove a LEGO piece/ section or LMB component.



### Directional

Used to show where to route cables, place components, or move them.



### Bend/Pivot

Used when a component needs to be bent, or part folded or pivoted.



### Turn/ Flip

Will be found in the top left corner when the set needs to be rotated or flipped.



### Twist/ Braid

Seen when a set of cables need to be grouped and twisted together.



### Power On Test

Found at the end of a major step to test the lights. Will be located in the top left corner.



### Note

Notes will be found alongside the instruction photos and explain what to do.





# Before You Begin

## Repeat Step

Repeat the previous step eg. Make a spotlight, then make a second spotlight.



## Connect Focus

Used to highlight a hard to see area where a component is being connected.



## Disconnect Focus

Used to highlight a hard to see area where a component is being disconnected.



## General Focus

Used to highlight a hard to see area where a component needs to be acted on.



## General Note


This is a sample note that is used anywhere in this guide. It will explain a difficult section where photos are hard to illustrate or easily confused.

## Connect Note

The green coloured note is used when the topic focuses on a component being connected, like the shown Power Bank.

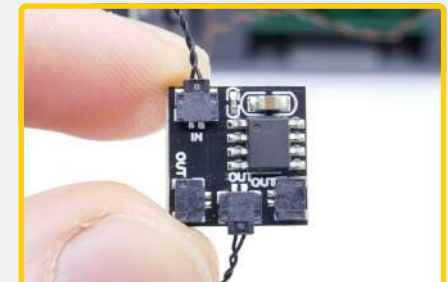
## Disconnect Note


The red coloured note is used when the topic focuses on a component being disconnected or like here, the removed pieces.



**NOTE**

Take the 5cm Connecting Cable from the 4-Port Micro Expansion Board and route it into the "IN" port of the Flicker Effects Board






**NOTE**

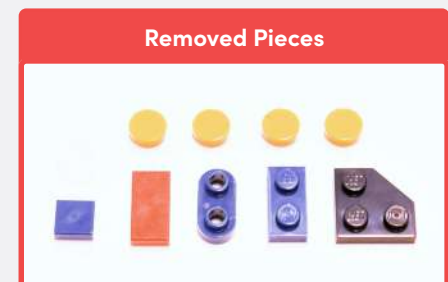
Connect to a 5V USB Power Bank, 5V USB Wall Adaptor, or USB to AA Battery Pack (sold separately)





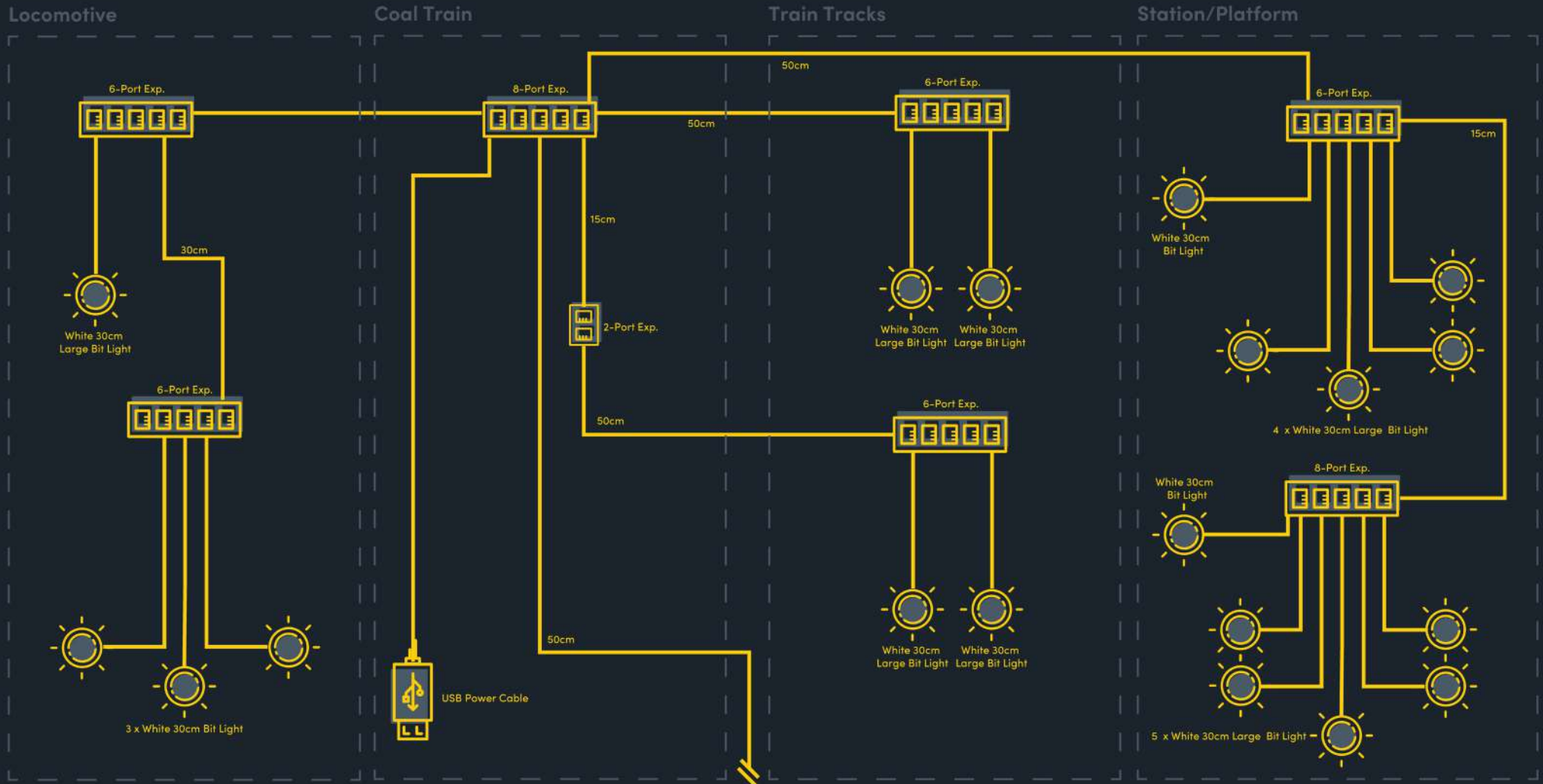
**NOTE**

You should have these parts left over that were removed from the LEGO set



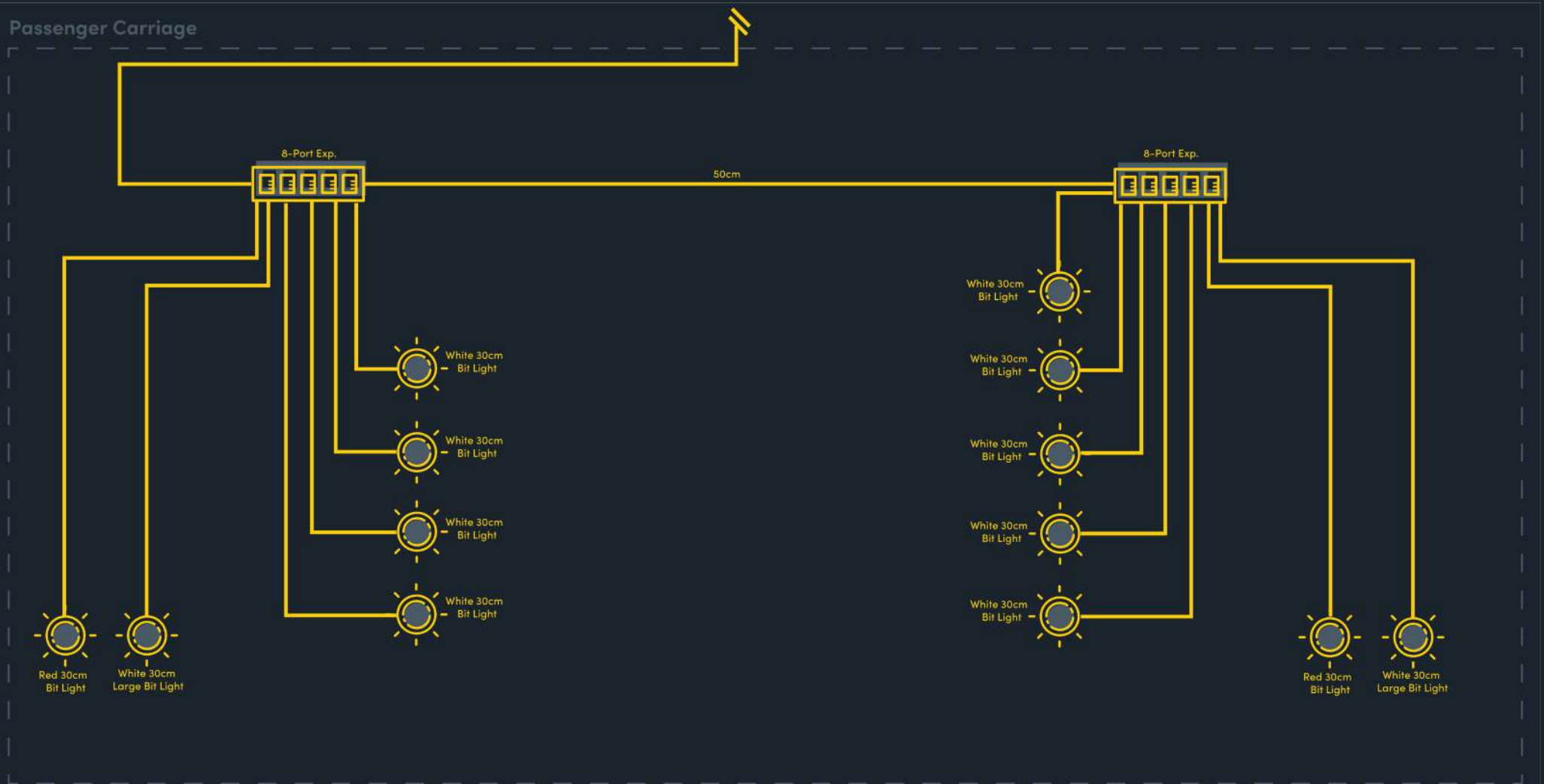


# BLUEPRINT





# BLUEPRINT

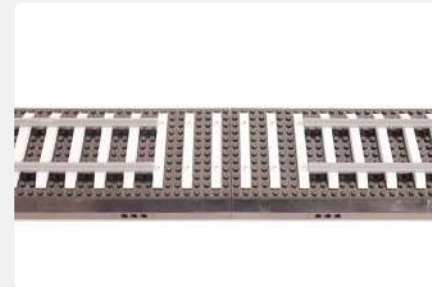
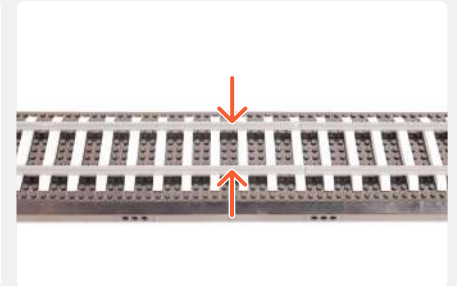
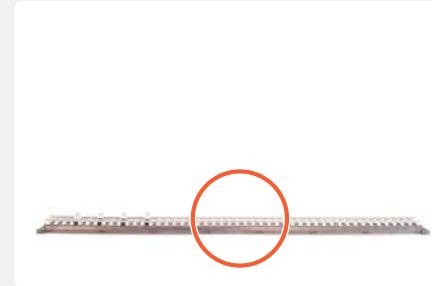




## INSTRUCTIONS

To ensure a smooth installation of your light kit, please read and follow each step carefully. If you run into any issues, please refer to the online troubleshooting guide.

1

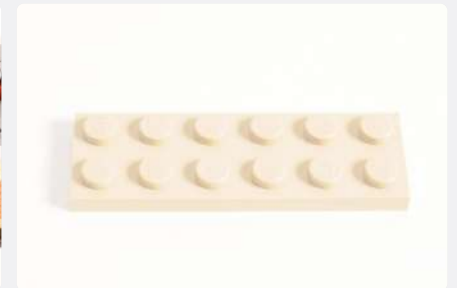


2



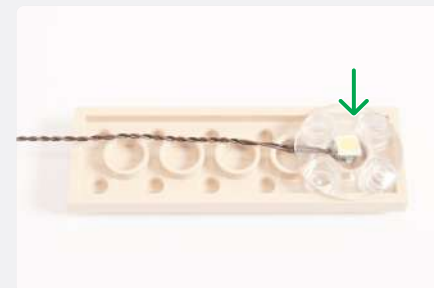
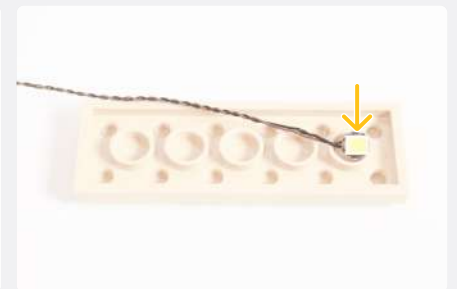
**NOTE**

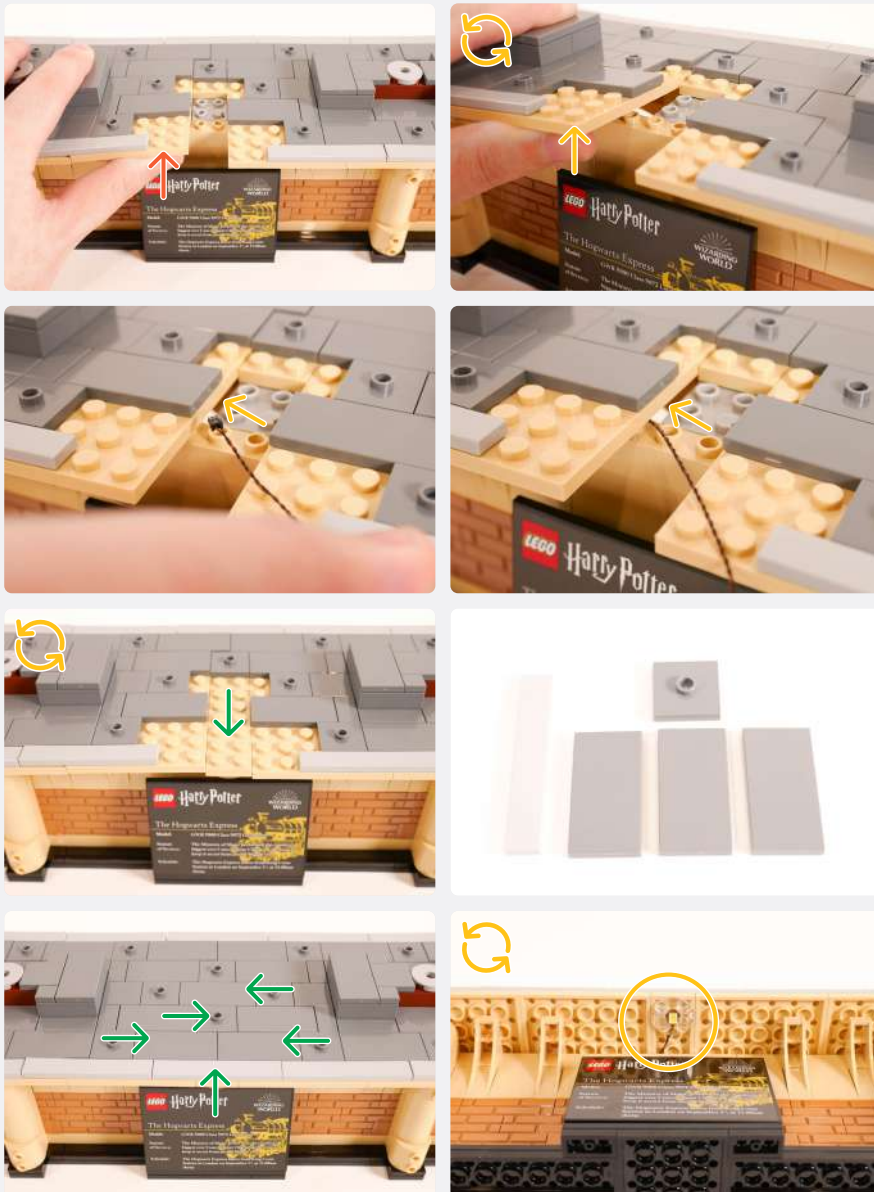
Use the LEGO Removal Tool to assist in disconnecting pieces



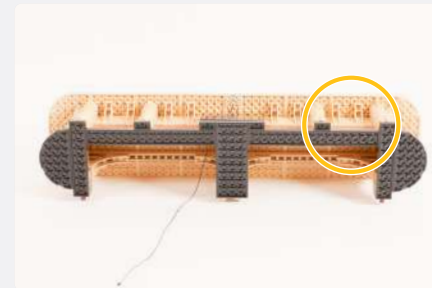
**Warm White 30cm Large Bit Light**

**Plate 2x2 W/ Rounded Bottom - Trans Clear**



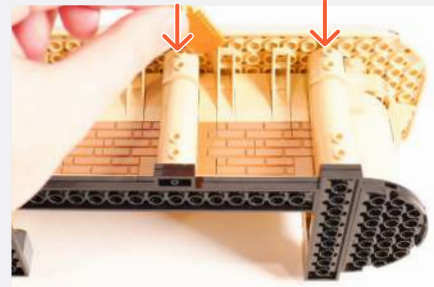


3

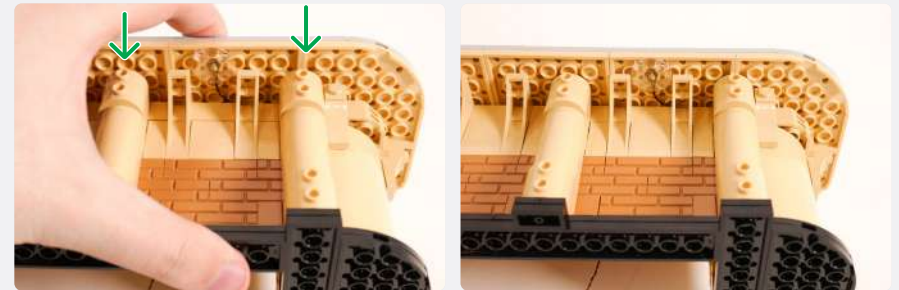
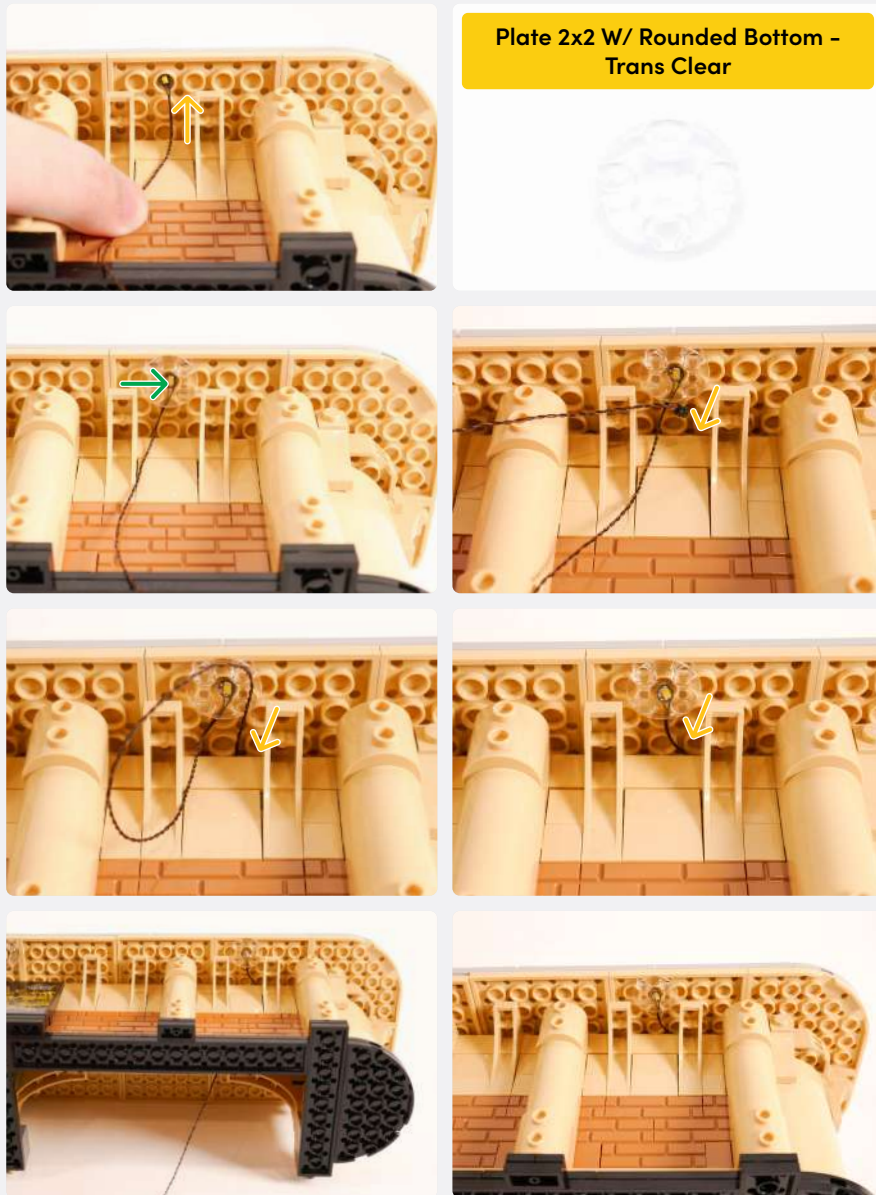


**NOTE**

Use the LEGO Removal Tool to assist in slightly disconnecting the floor so there is a small gap.



**White 30cm Bit Light**



4



**NOTE**  
Use the LEGO Removal Tool to assist in slightly disconnecting the floor so there is a small gap.





White 30cm Bit Light

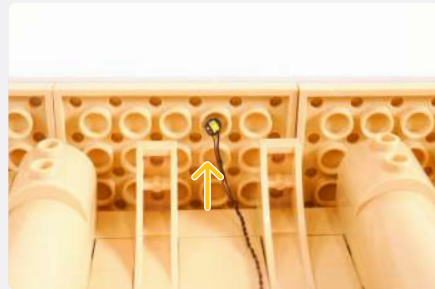
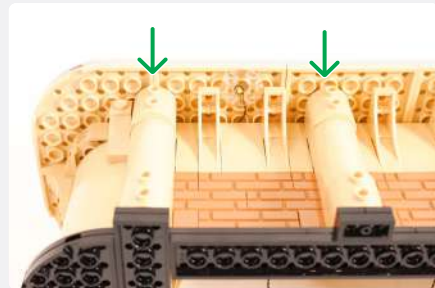
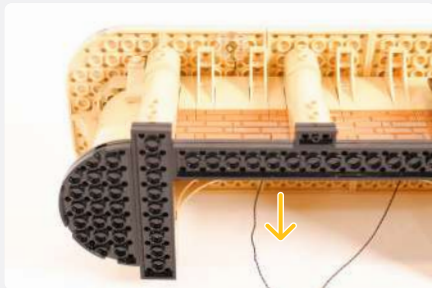
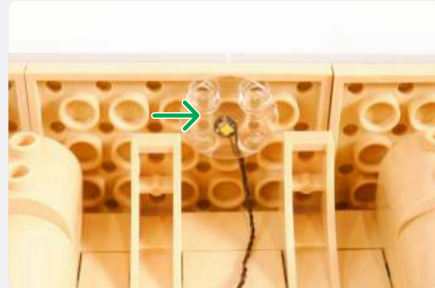
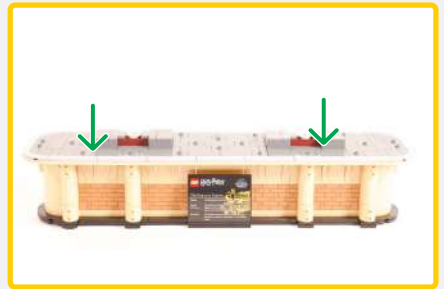


Plate 2x2 W/ Rounded Bottom - Trans Clear



NOTE

Ensure all the studs are reconnected in a secure manner.



5



6-Port Expansion Board

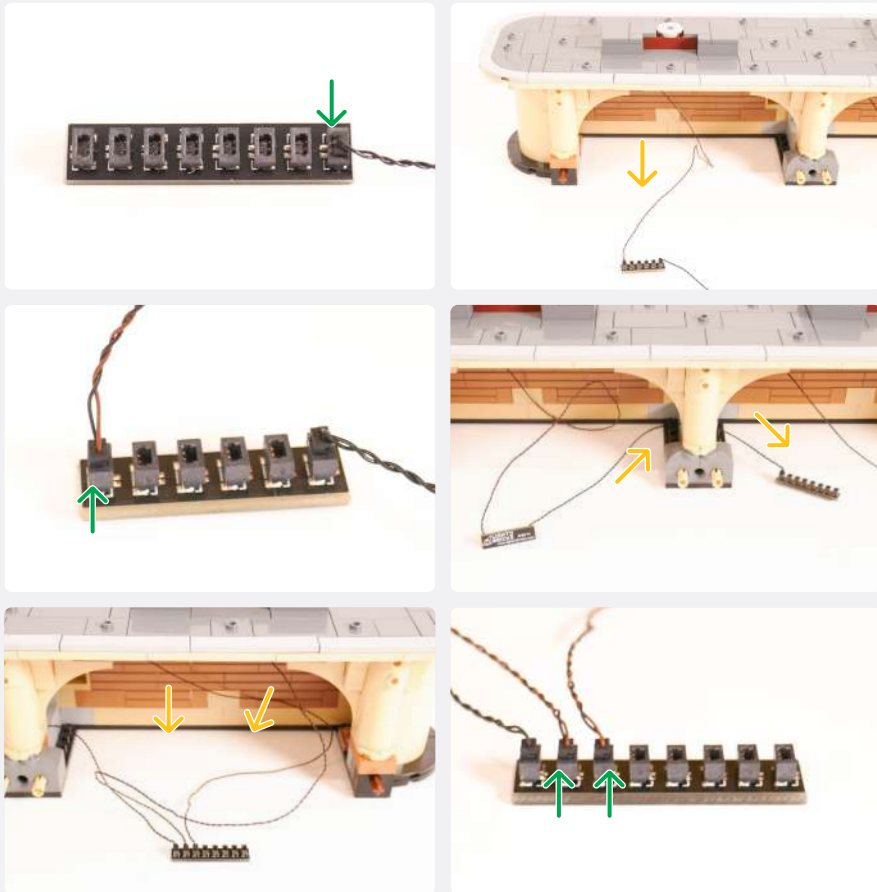


15cm Connecting Cable

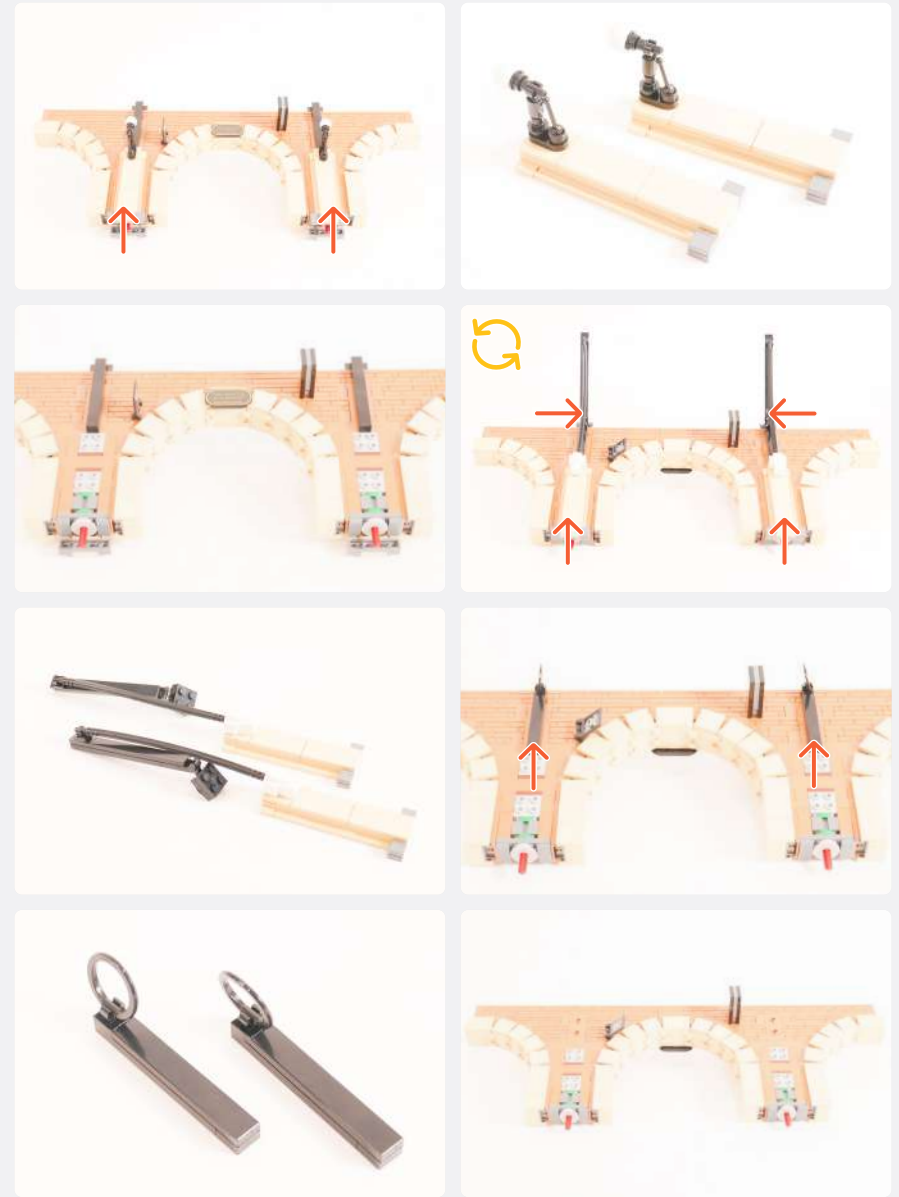


8-Port Expansion Board

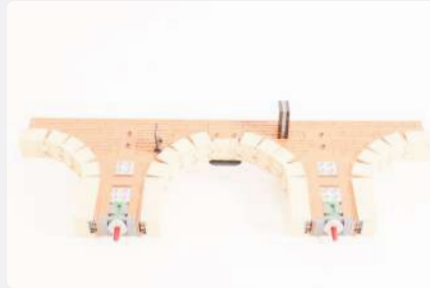




**6**



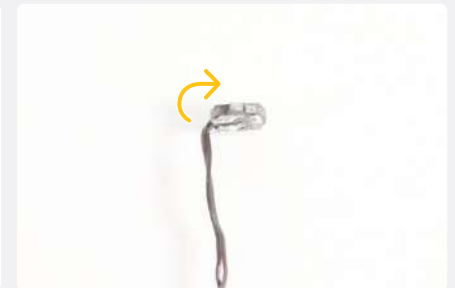
**7**

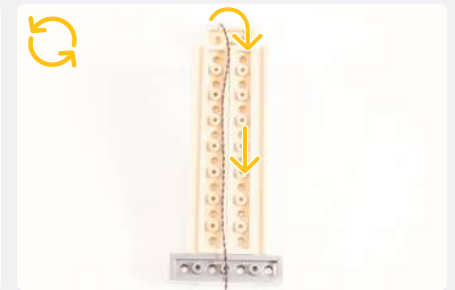
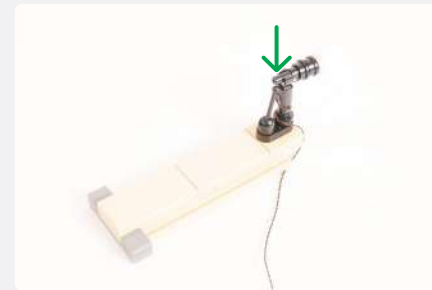


Round Plate 1x1 Open Stud - Black



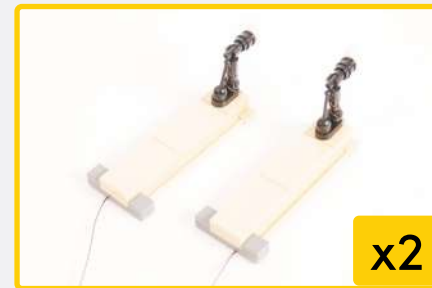
Warm White 30cm Large Bit Light



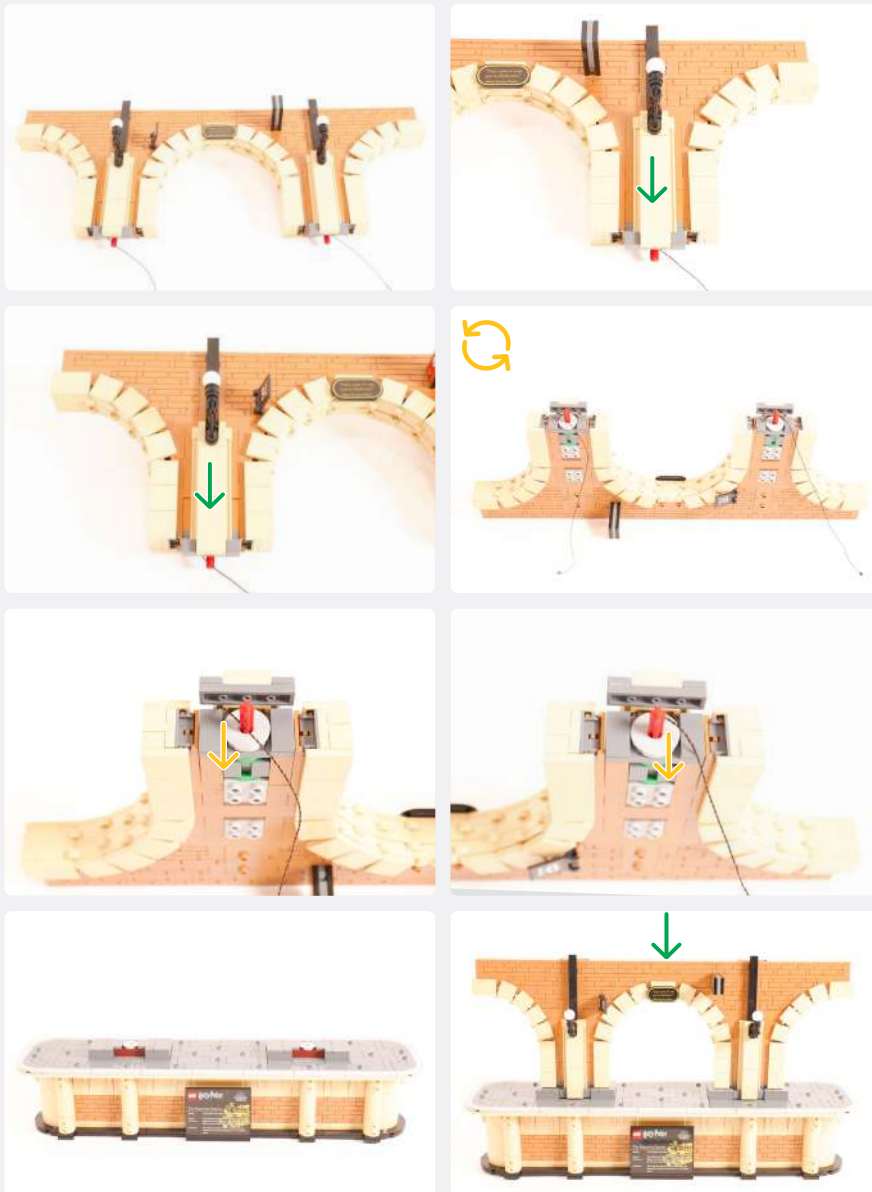


**NOTE**

Repeat Step 7.



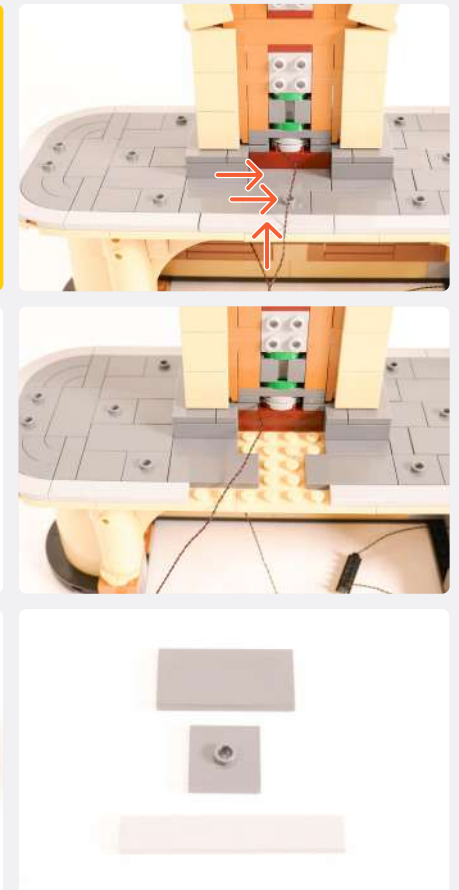
8



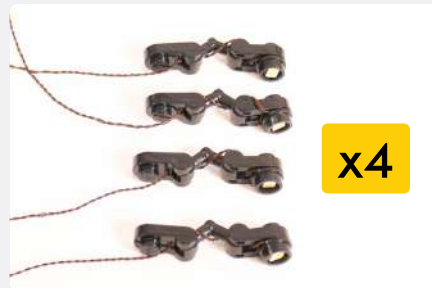
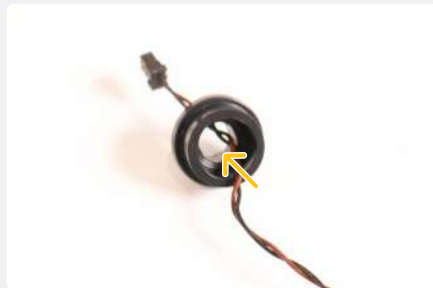
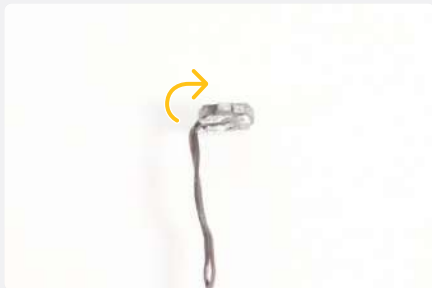
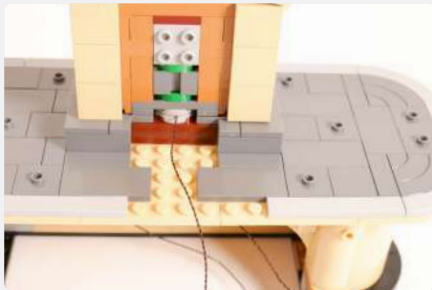
9



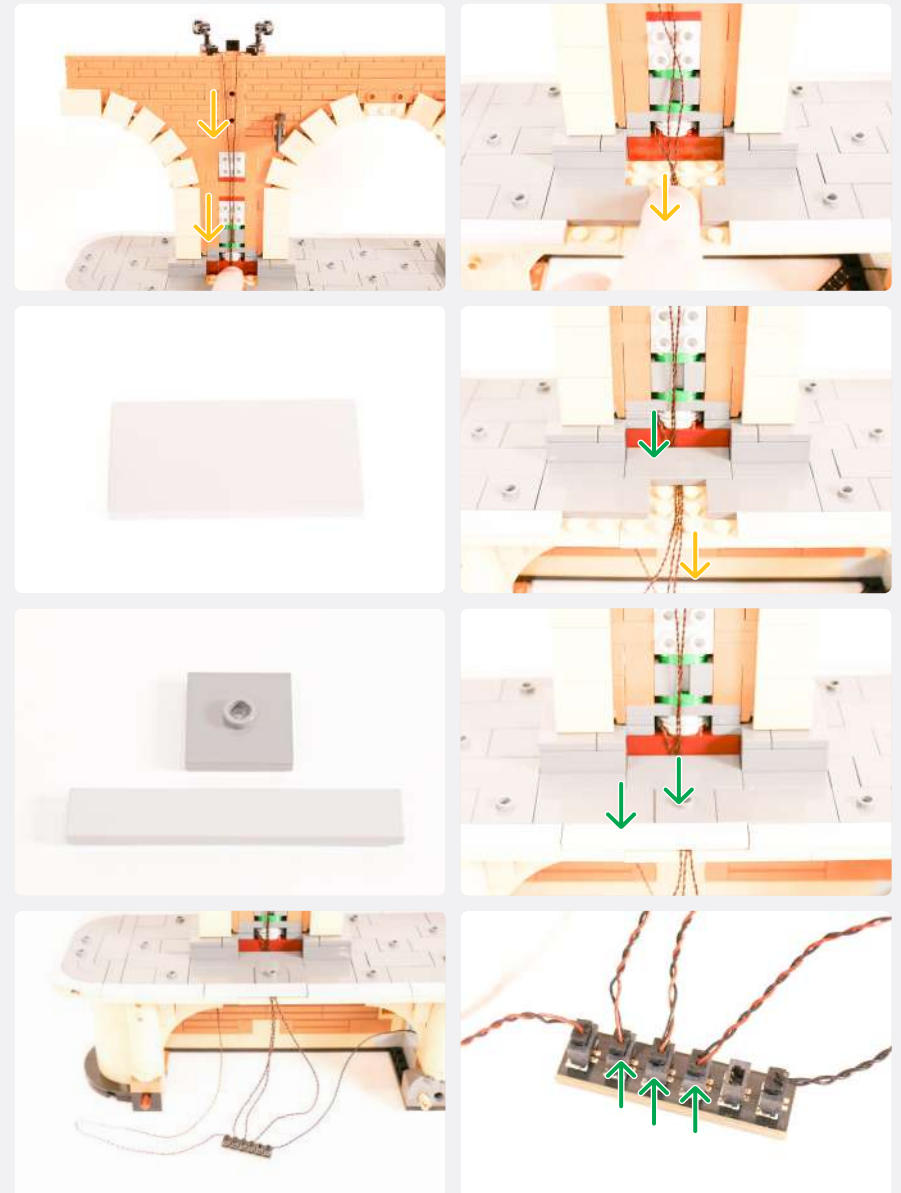
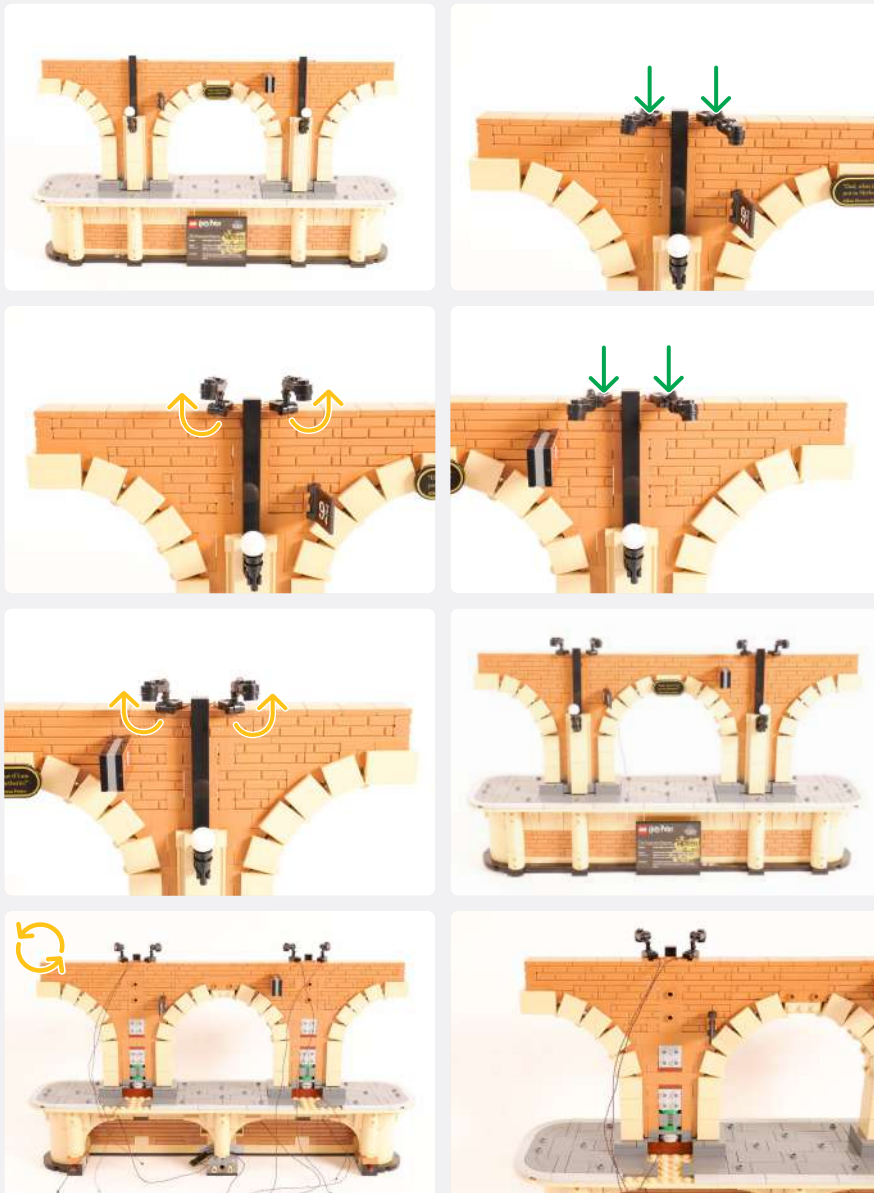
**NOTE**  
Use the LEGO Removal Tool to assist in disconnecting pieces



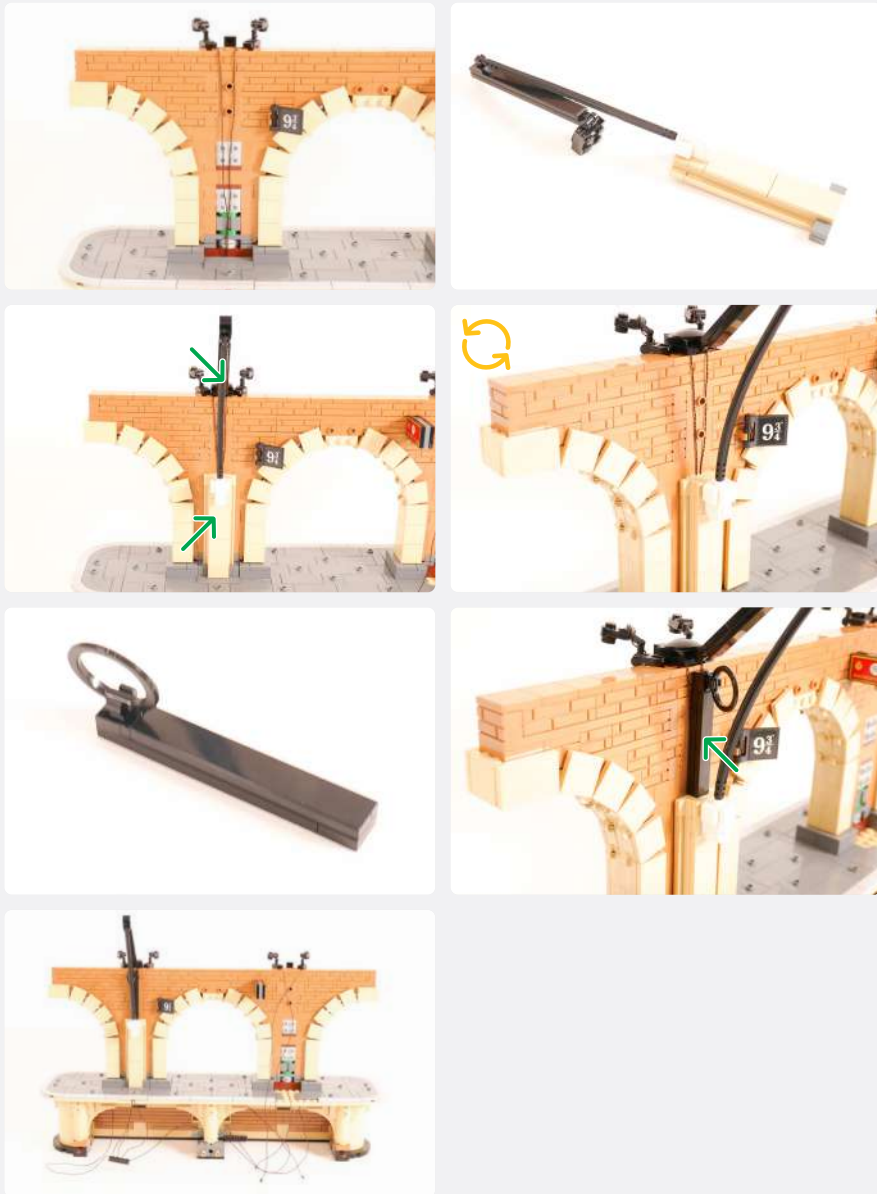
10



**11**



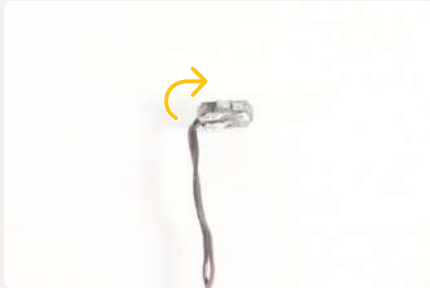
**12**



Round Plate 1x1 Open Stud - Black



Warm White 30cm Large Bit Light



Tile 1x1 W/ Clip Round Edges - Black

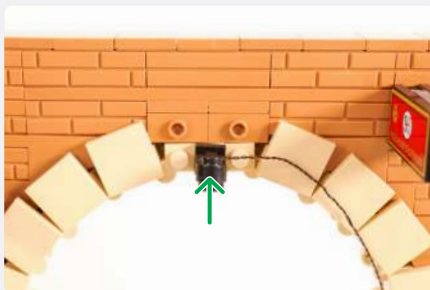
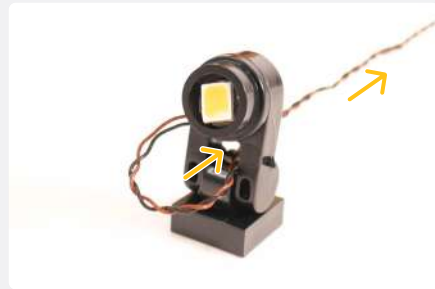


Plate 1x1 Mod Rounded W/ Handle - Black

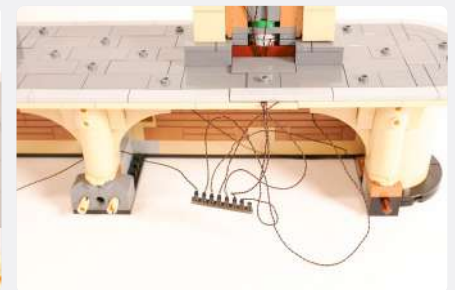
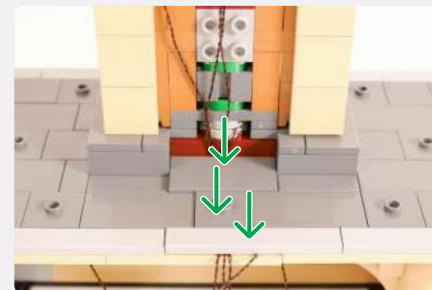
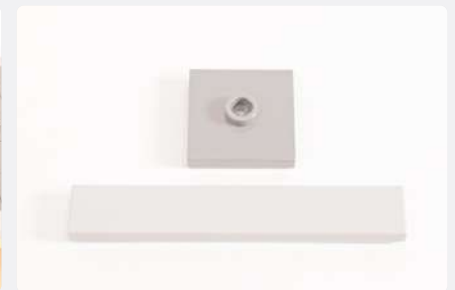
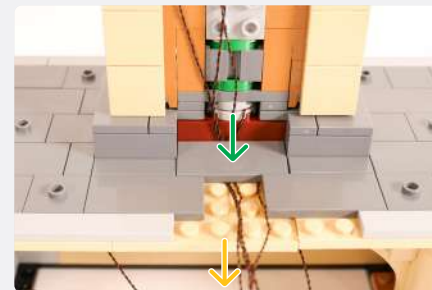
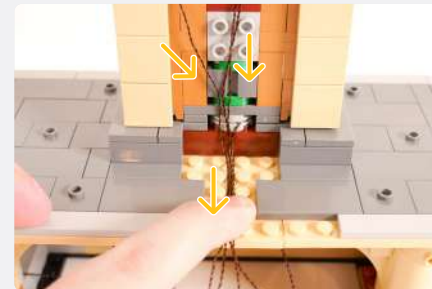
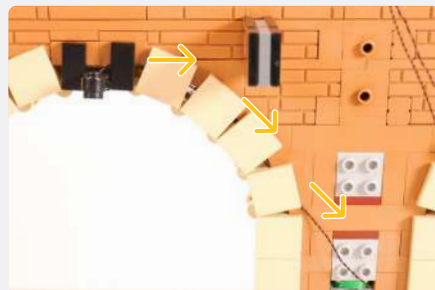


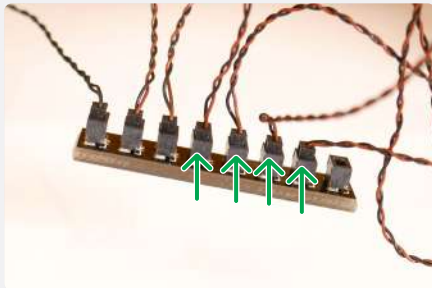


**13**

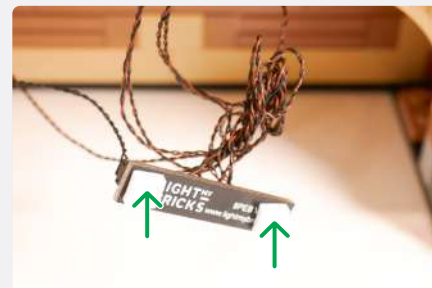
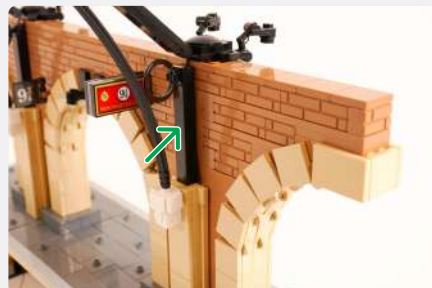
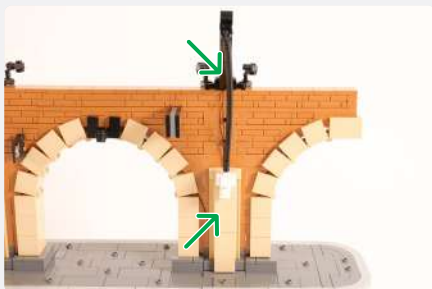
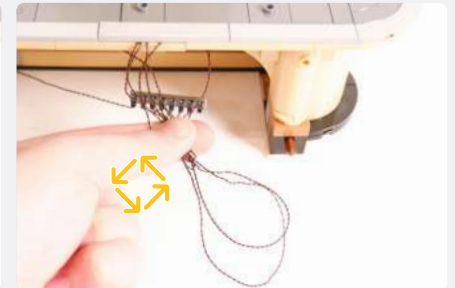


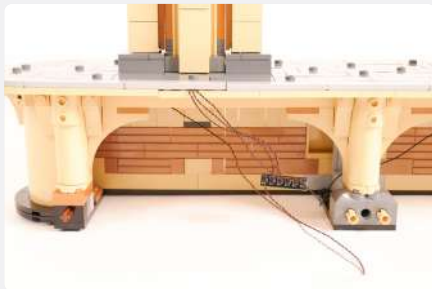
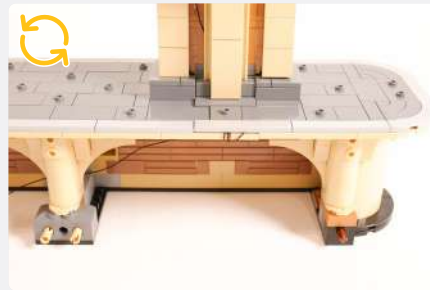
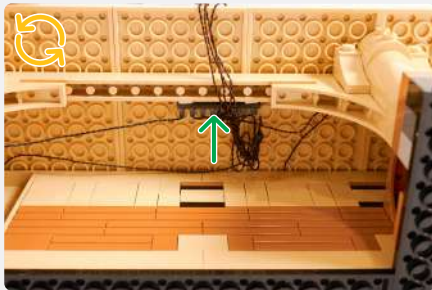
**2 x Tile 1x2 - Black**





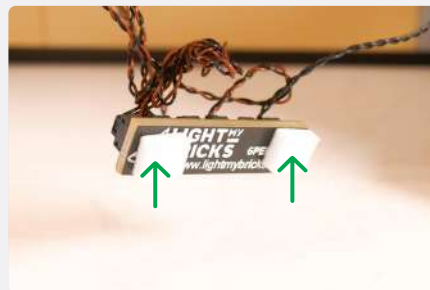
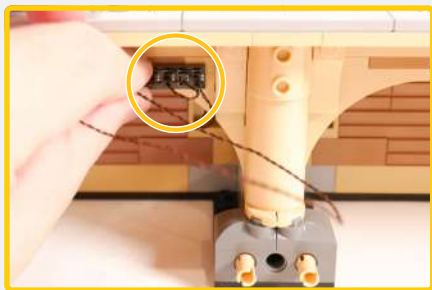
**14**



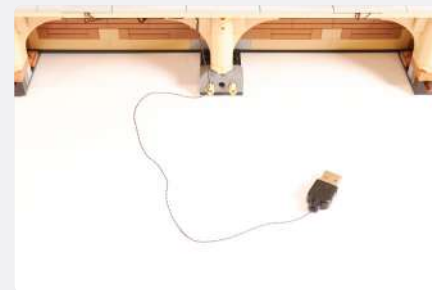
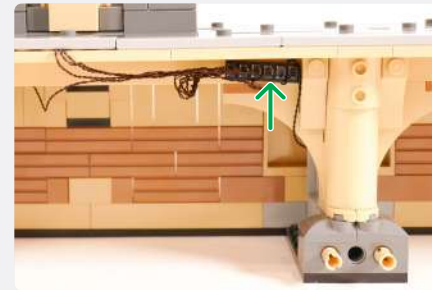


**NOTE**

Hold the 6-Port Expansion Board in the following position while twisting the cables. This will allow enough slack for the Expansion Board to be positioned momentarily.



**15**



**NOTE**

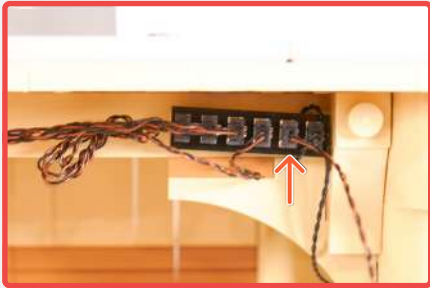
Connect to a 5V USB Power Bank, 5V USB Wall Adaptor, or USB to AA Battery Pack (sold separately)



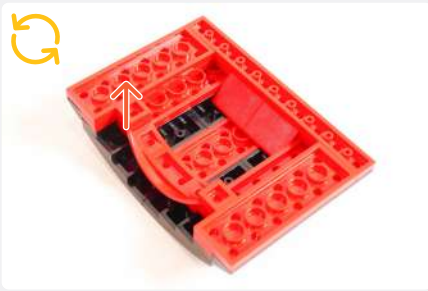
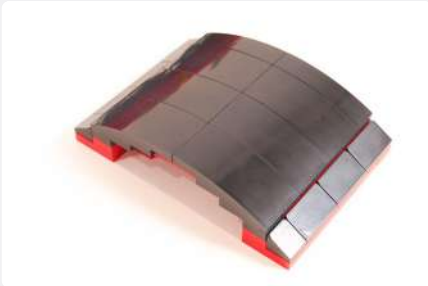
**!** If you experience any issues with the lights not working and suspect an issue with a component, please try a different port on the expansion board to verify where the fault lies (with the light or expansion board). To correct any issues with expansion board ports, please view the section addressing expansion board issues in our troubleshooting section.



**NOTE**  
Disconnect the USB Power Cable (w/ Power Source).

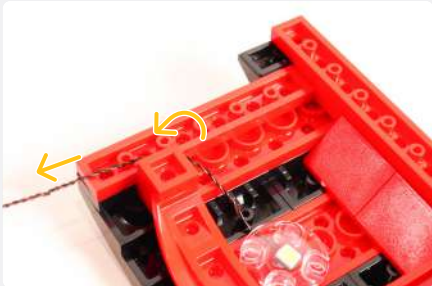
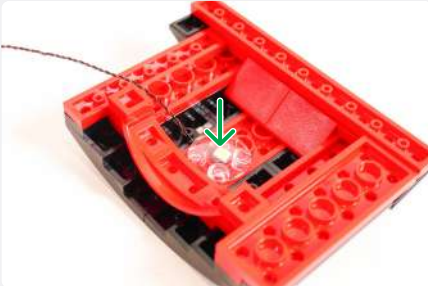
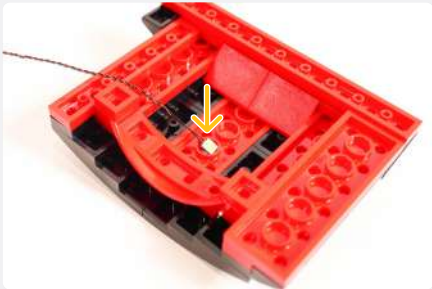


**16**

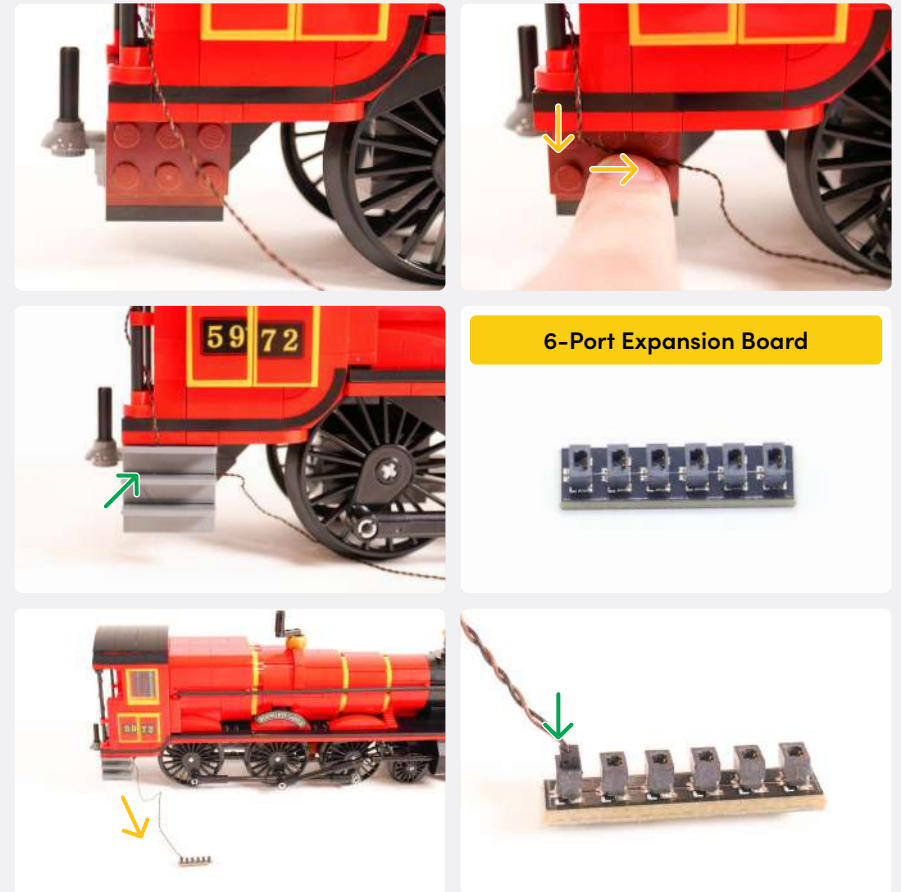


**Warm White 30cm Large Bit Light**

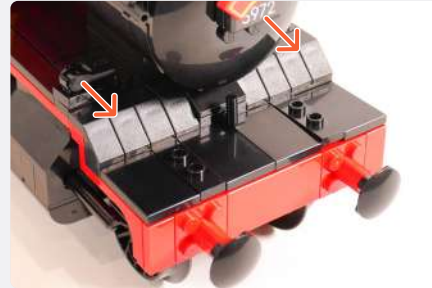
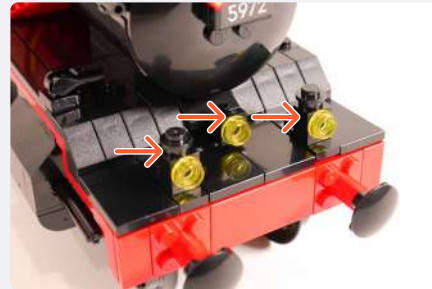
**Plate 2x2 W/ Rounded Bottom - Trans Clear**



17



**18**

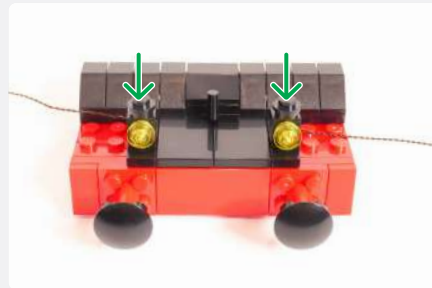
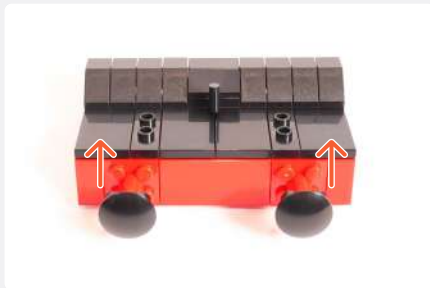
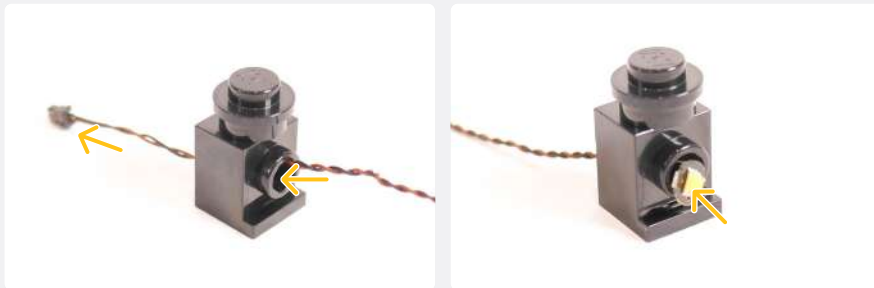


**19**

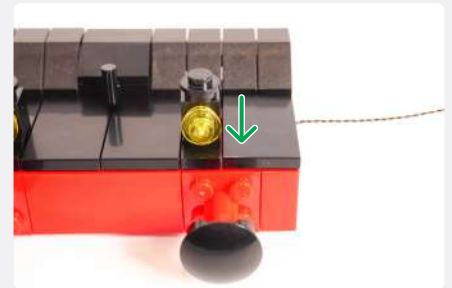
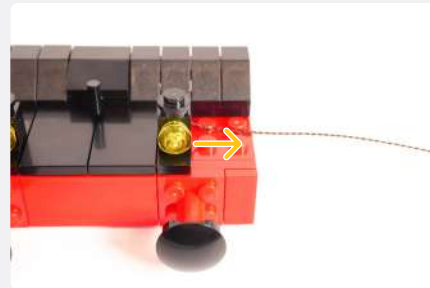
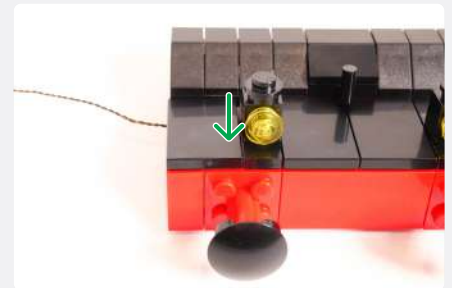


**White 30cm Bit Light**





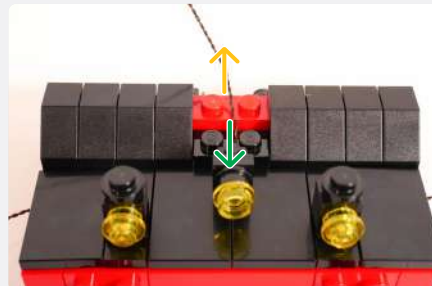
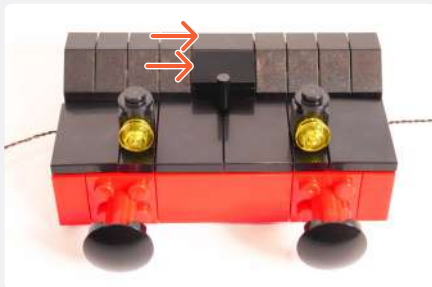
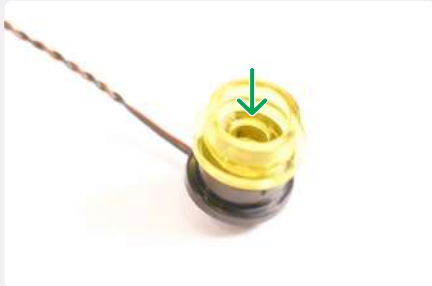
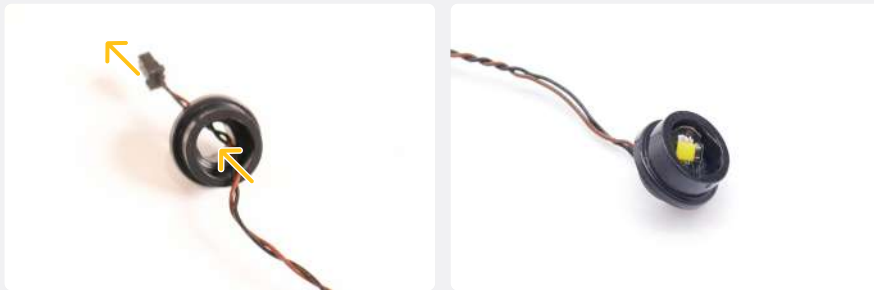
**20**



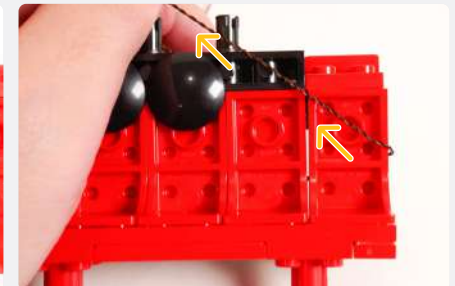
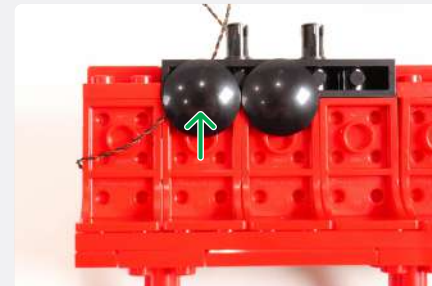
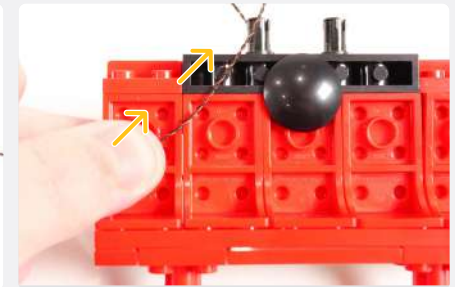
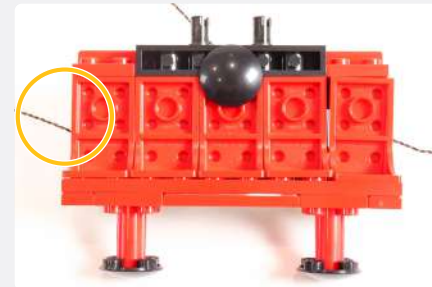
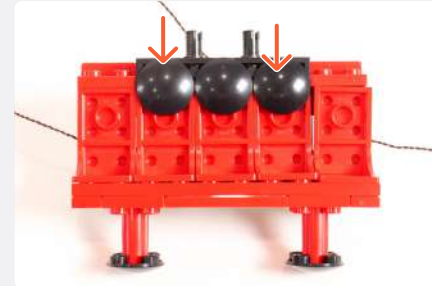
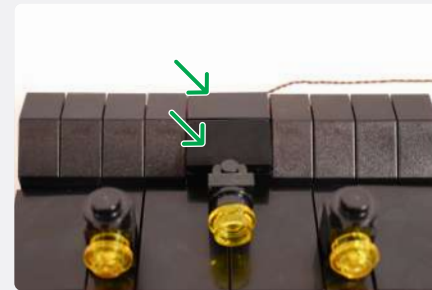
White 30cm Bit Light

Round Plate 1x2 Open Stud - Black



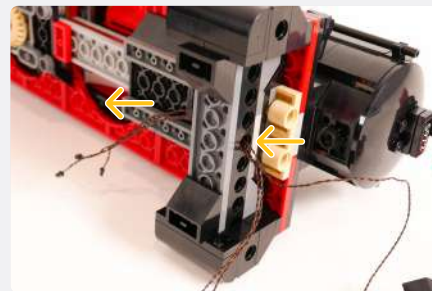
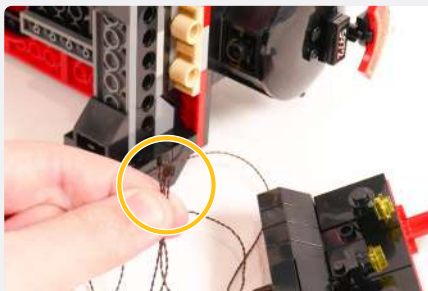
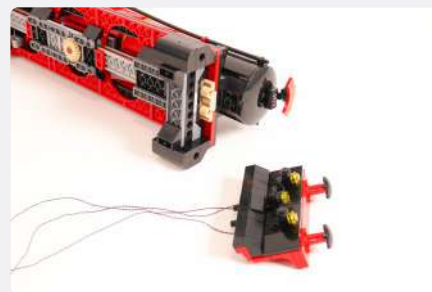
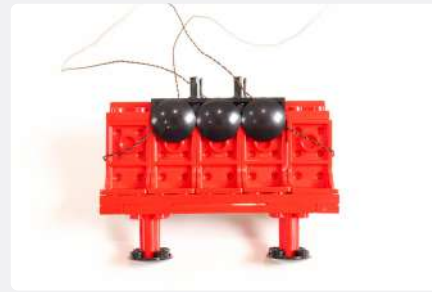
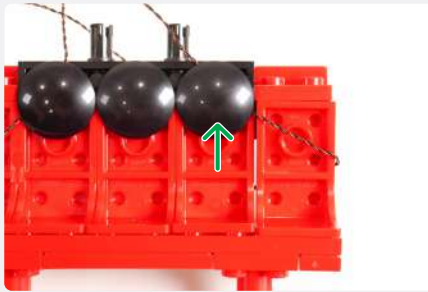


**21**

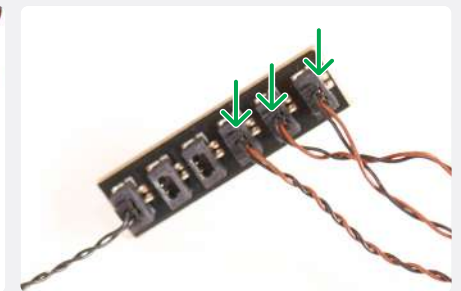
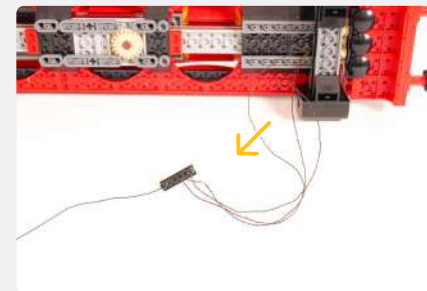
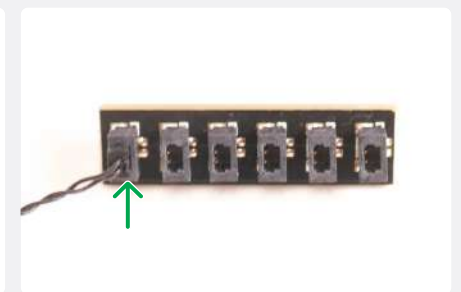
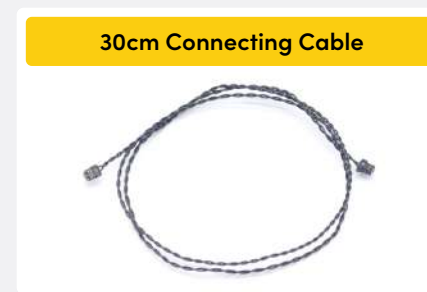
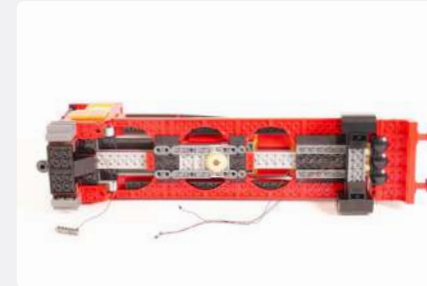
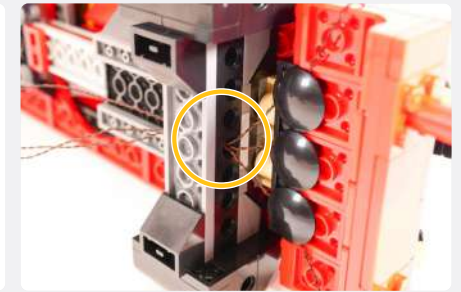
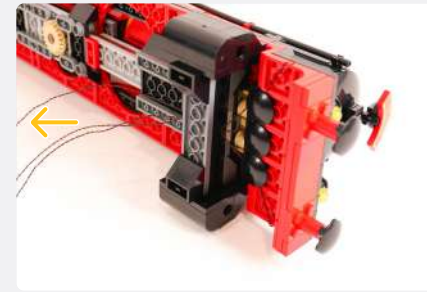




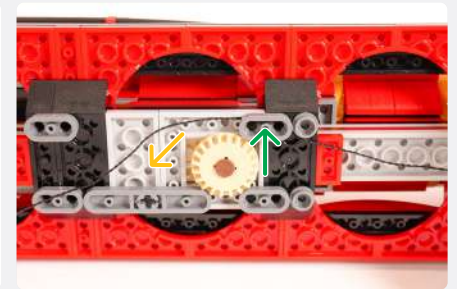
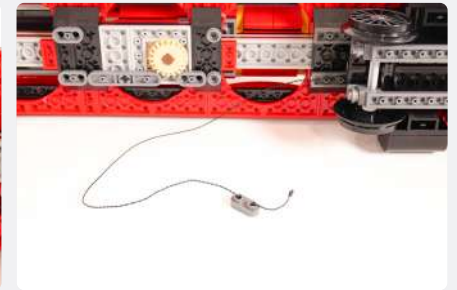
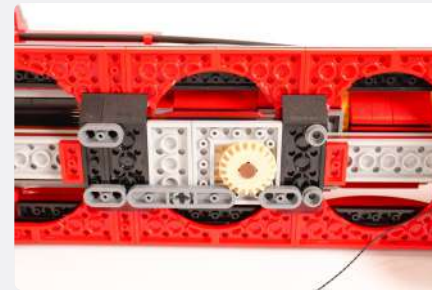
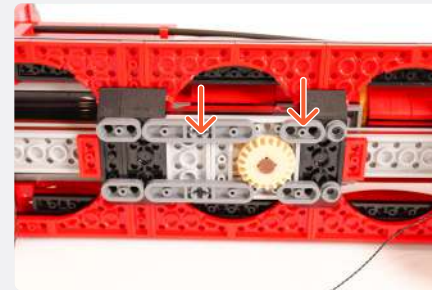
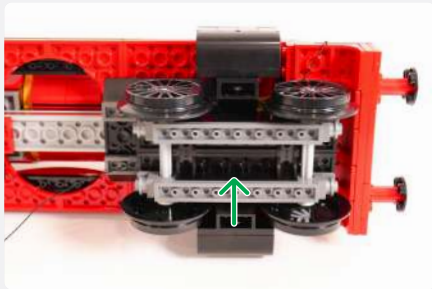
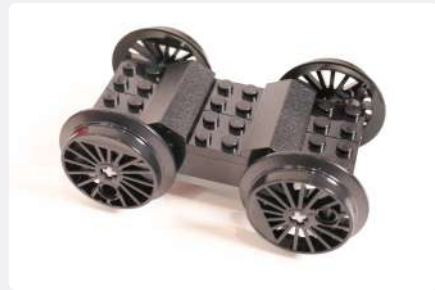
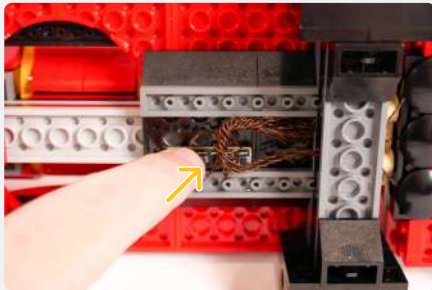
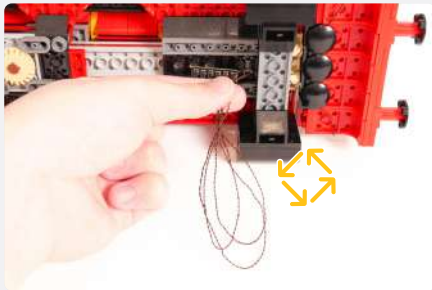
22

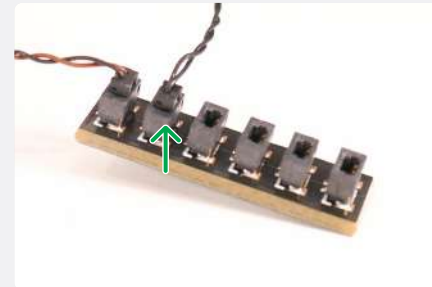
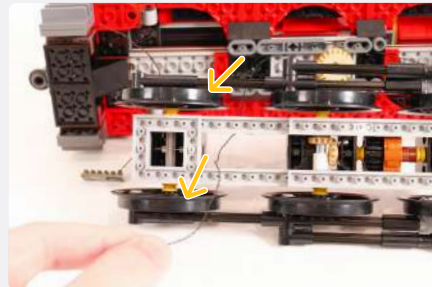
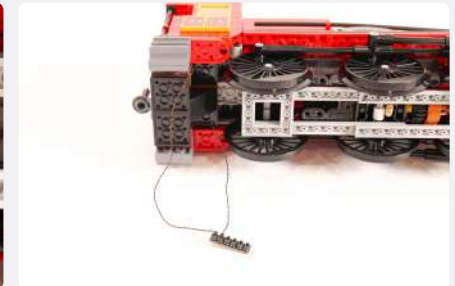
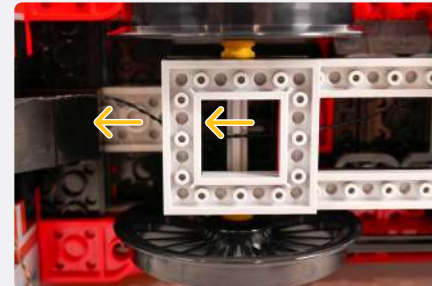
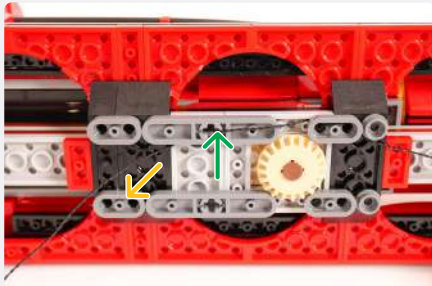


23



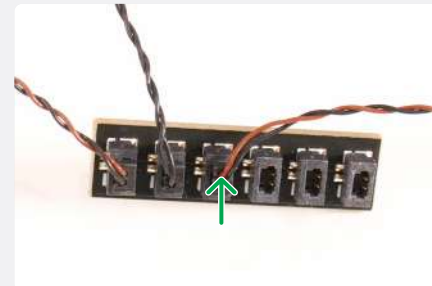
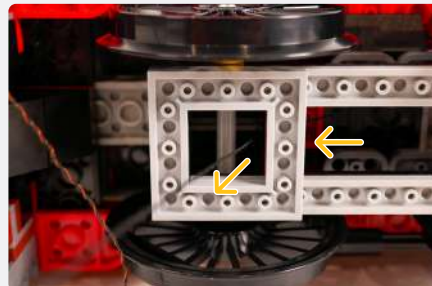
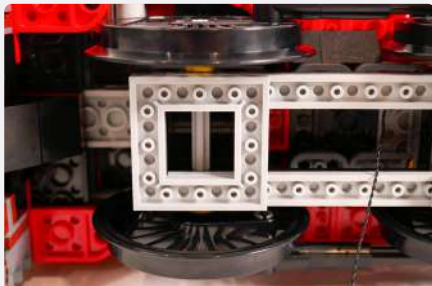
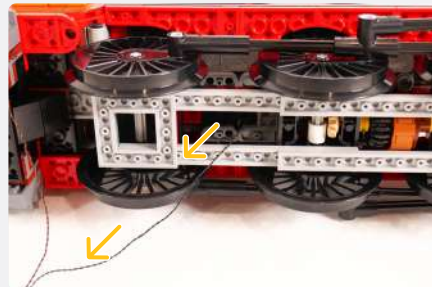
**24**

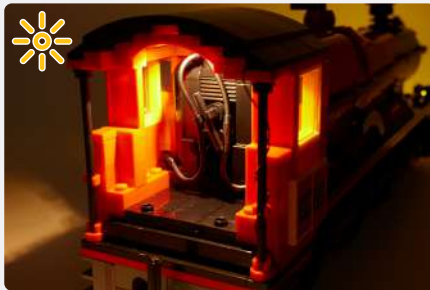




**NOTE**

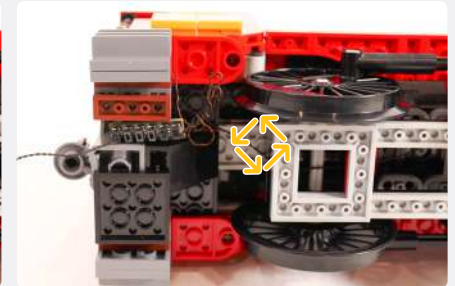
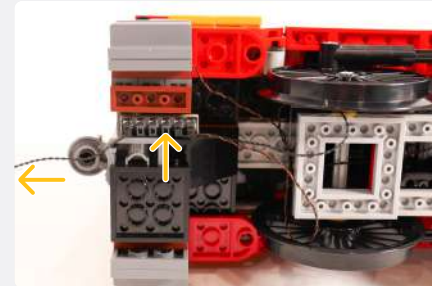
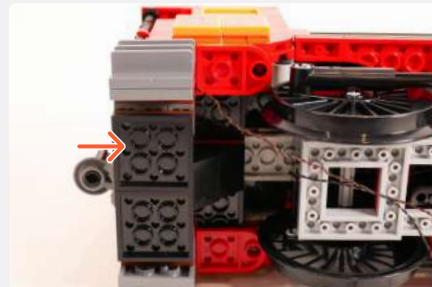
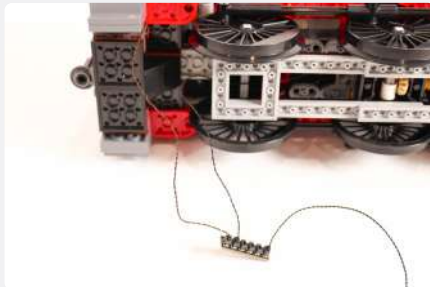
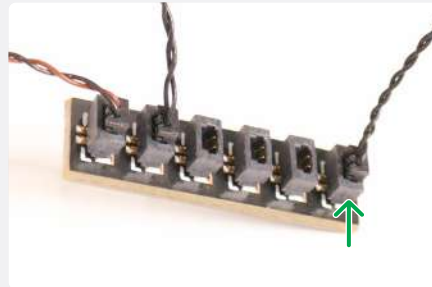
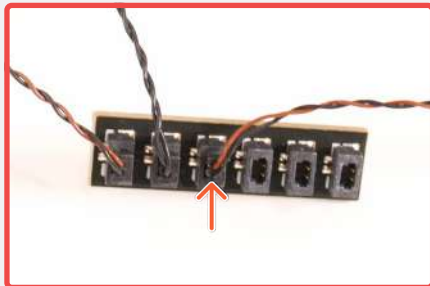
Connect to a 5V USB Power Bank, 5V USB Wall Adaptor, or USB to AA Battery Pack (sold separately)





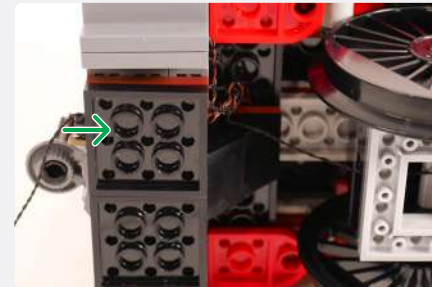
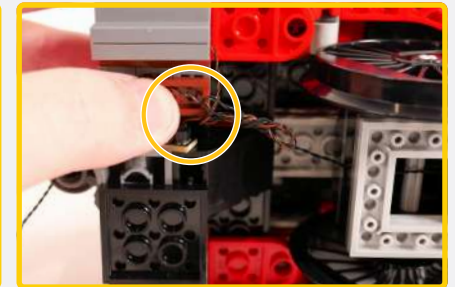
**NOTE**

Disconnect the USB Power Cable (w/ Power Source).



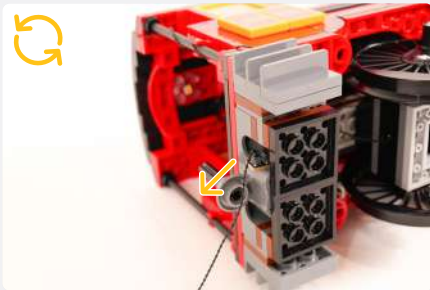
**NOTE**

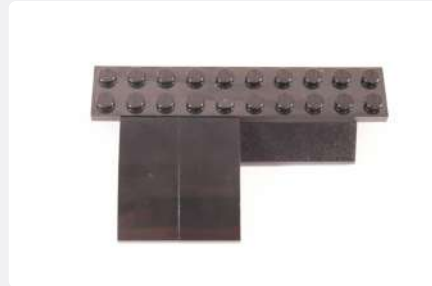
Hold any cable on the right side in the following position before securing it down with the Plate 3x3 - Black.

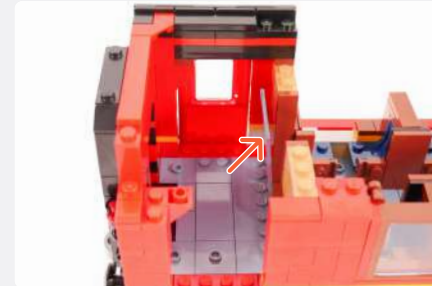
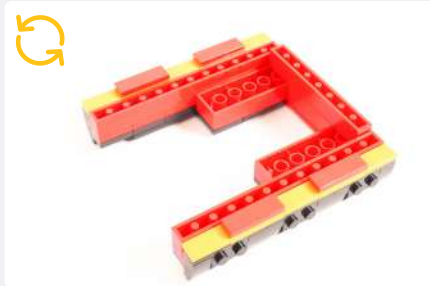
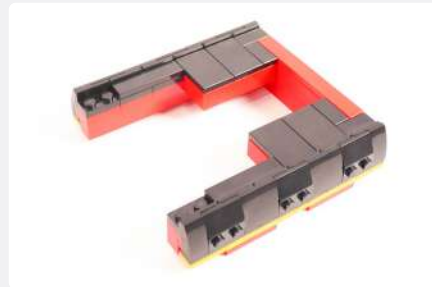


25

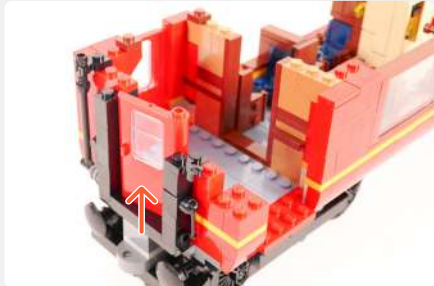
26



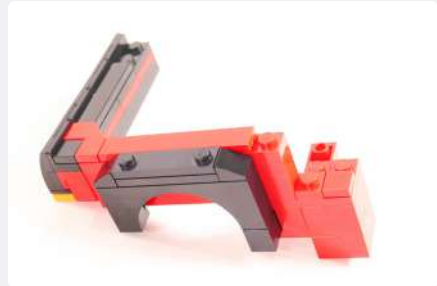
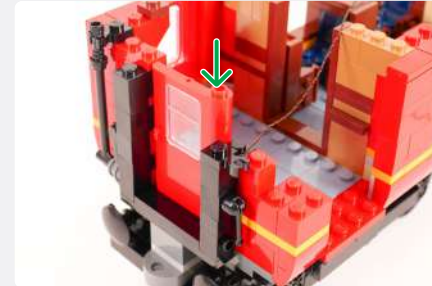
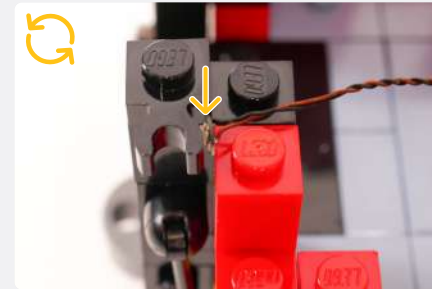
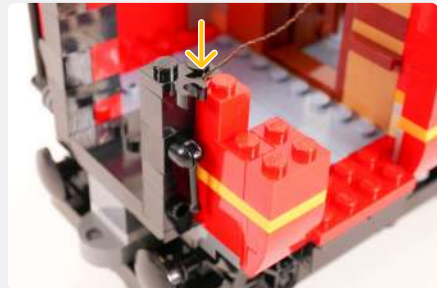
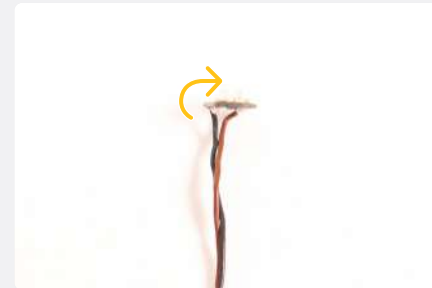




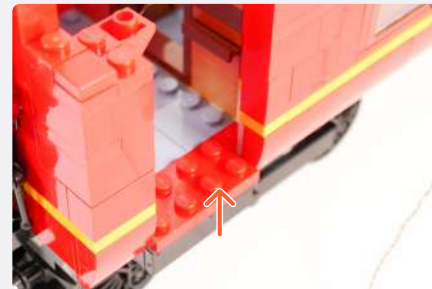
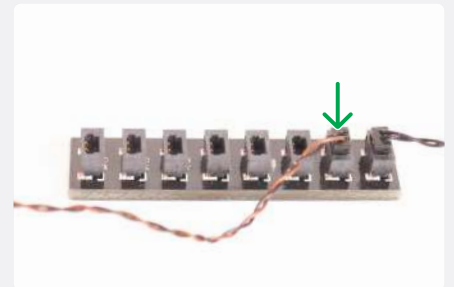
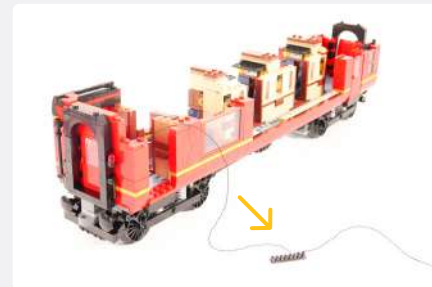
27



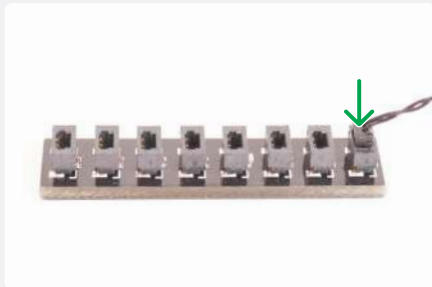
Red 30cm Bit Light





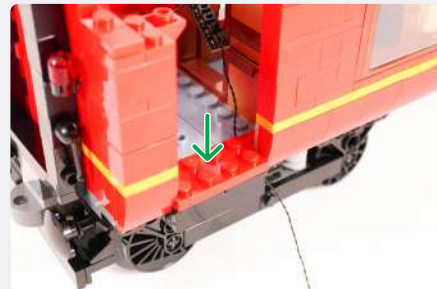
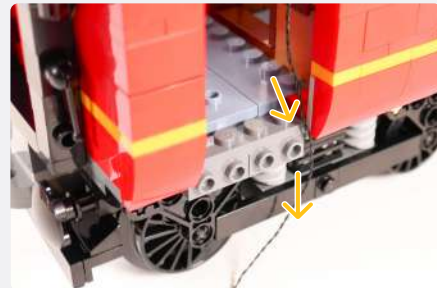
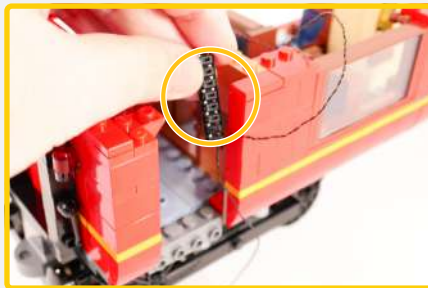


28



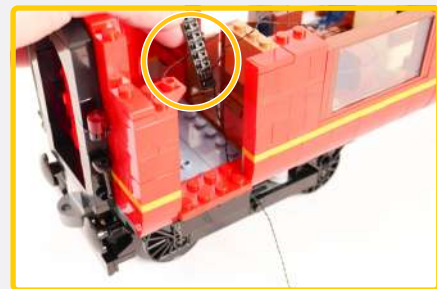
**NOTE**

Hold the Expansion Board in the following position. This will allow cable slack on the 50cm Connecting Cable.

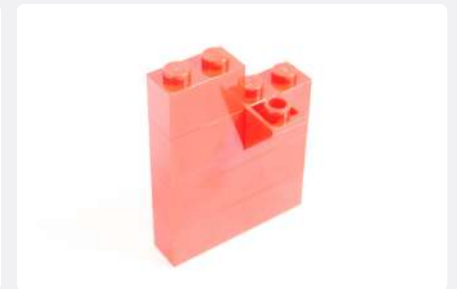


**NOTE**

Ensure the Expansion Board can still be held in the following position.



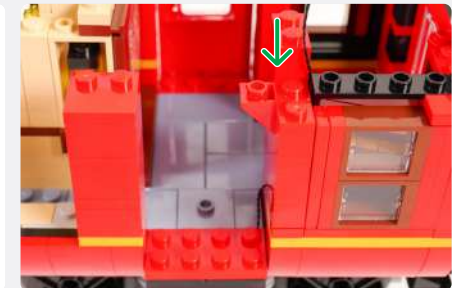
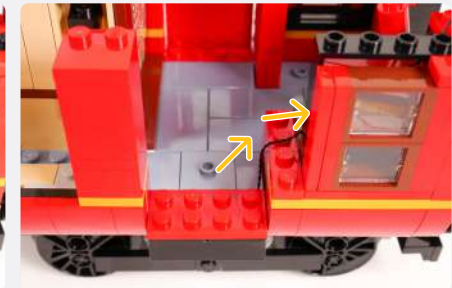
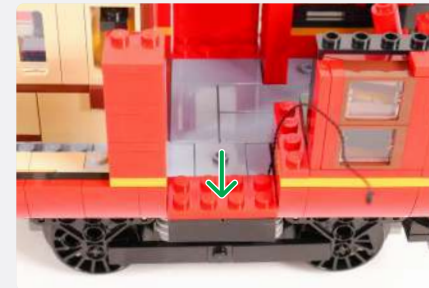
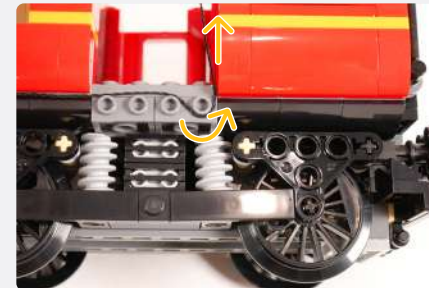
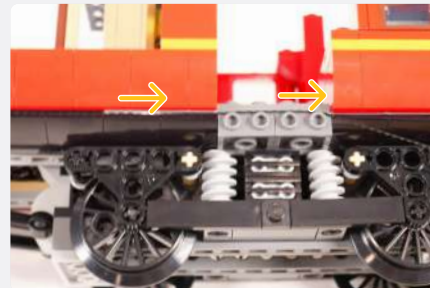
**29**





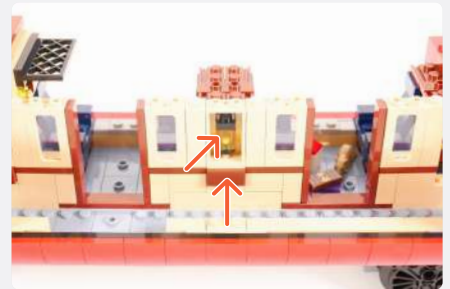
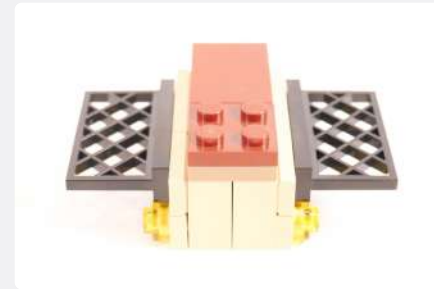
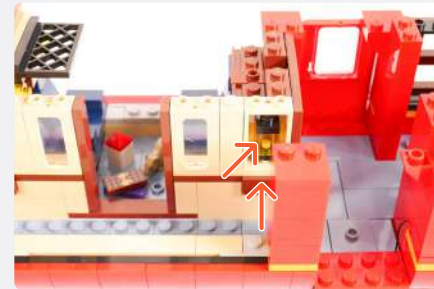
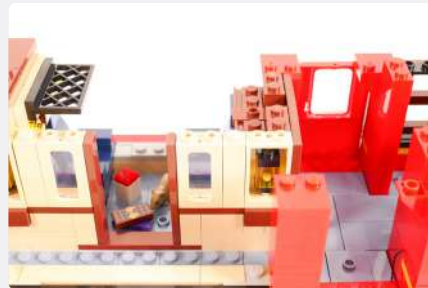
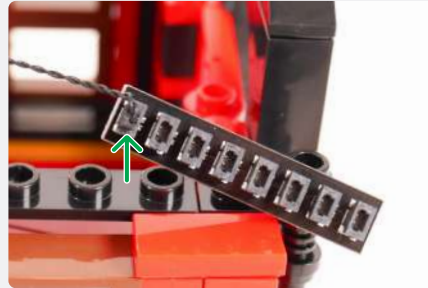
**NOTE**

Run the 50cm Connecting Cable from the left side of the carriage to the right side - ensuring the cable goes inbetween the black and red tiles.



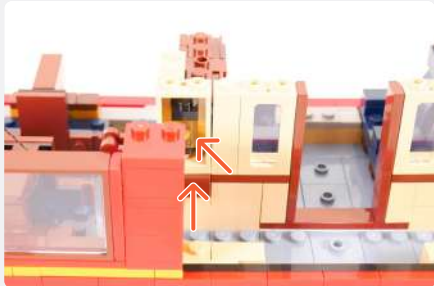


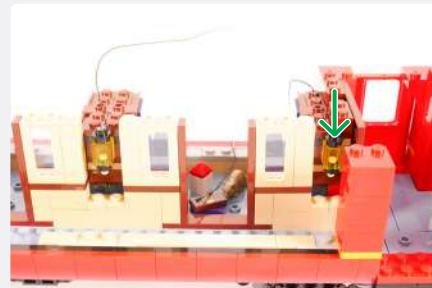
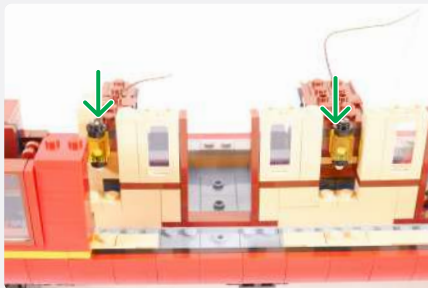
8-Port Expansion Board




30

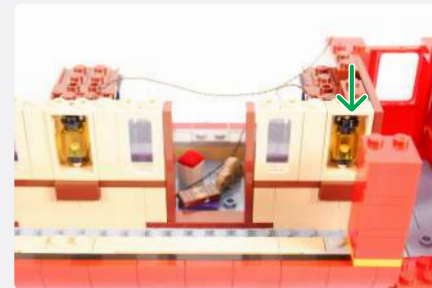
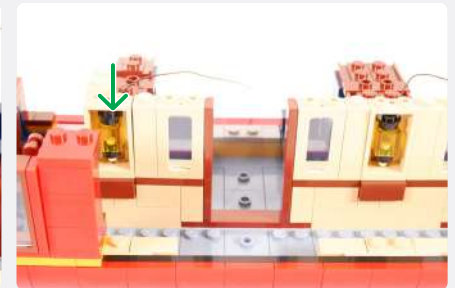
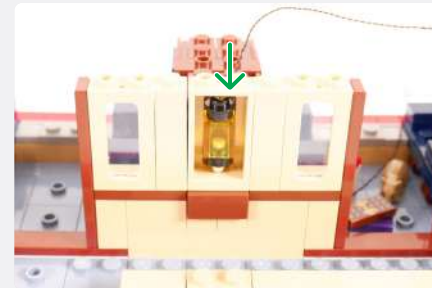
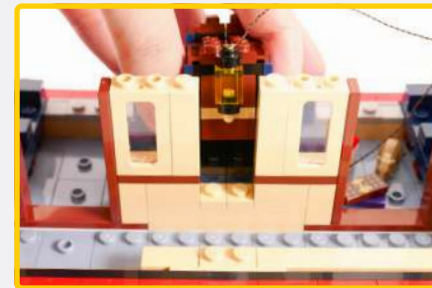
**31**



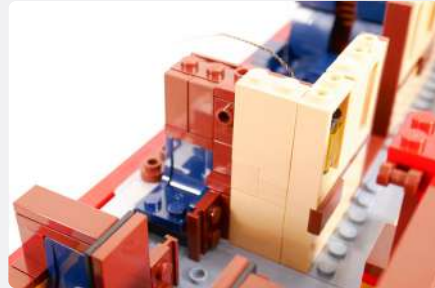
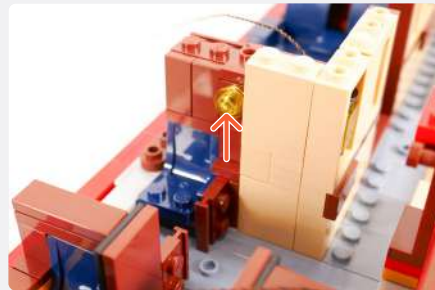


 **NOTE**

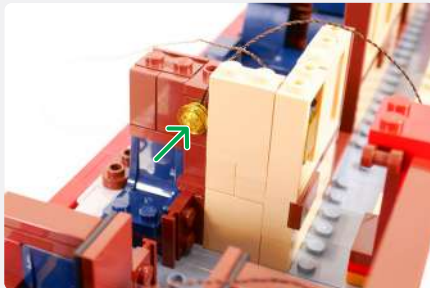
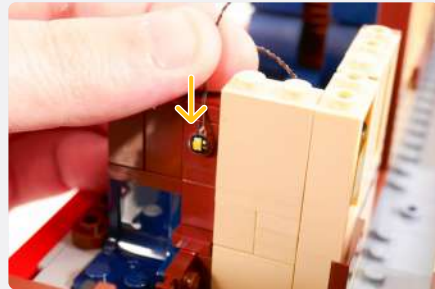
To reconnect the window pieces, you may need to push the wall slightly back.



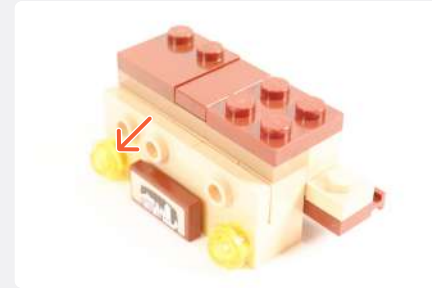
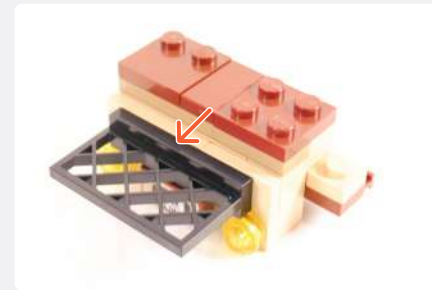
32



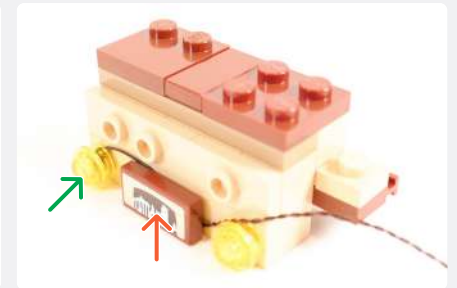
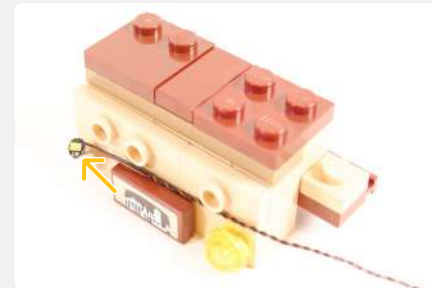
White 30cm Bit Light



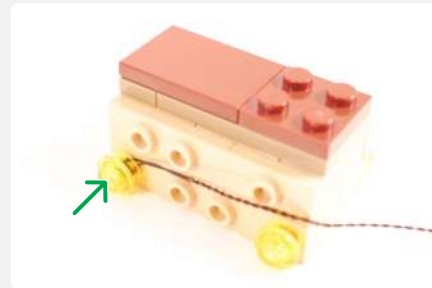
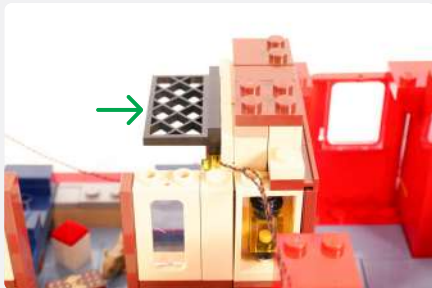
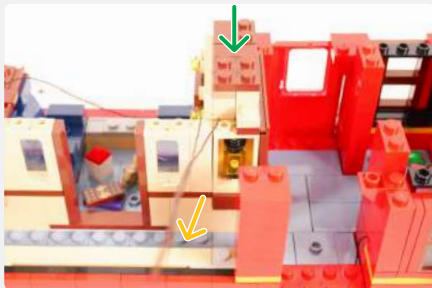
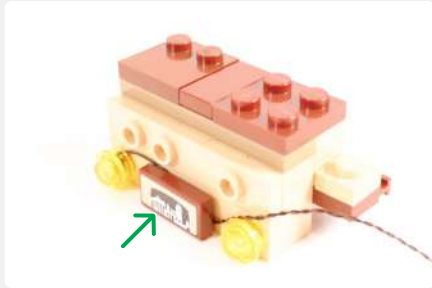
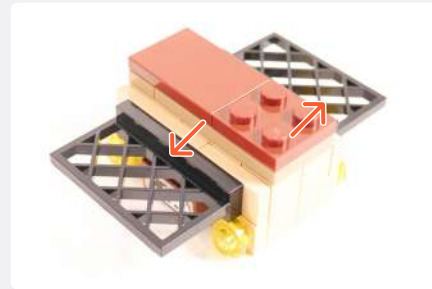
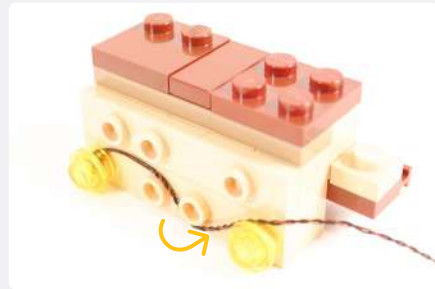
33



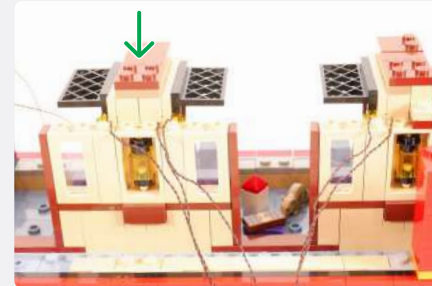
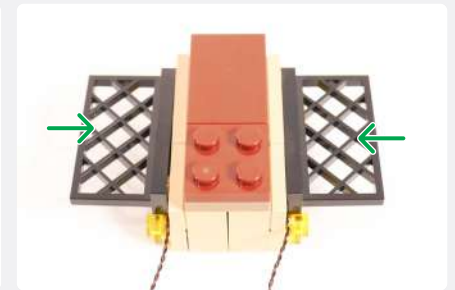
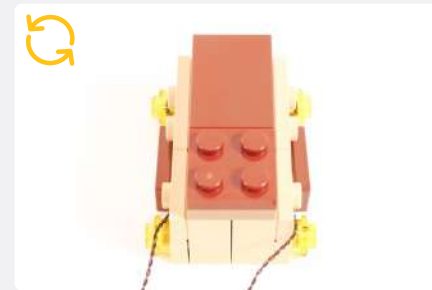
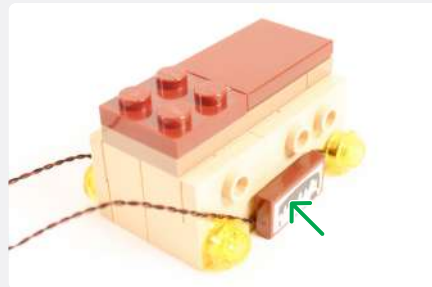
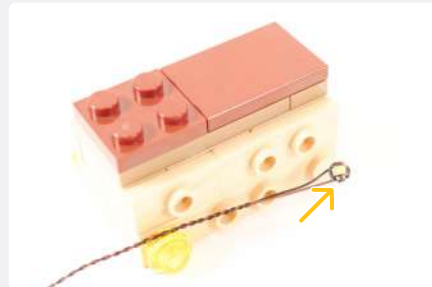
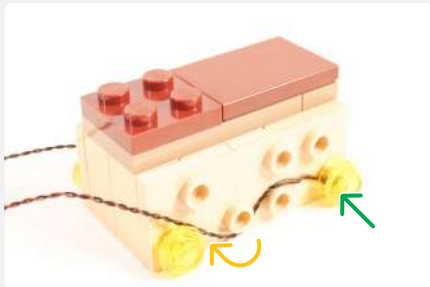
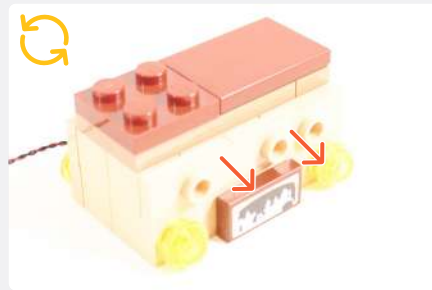
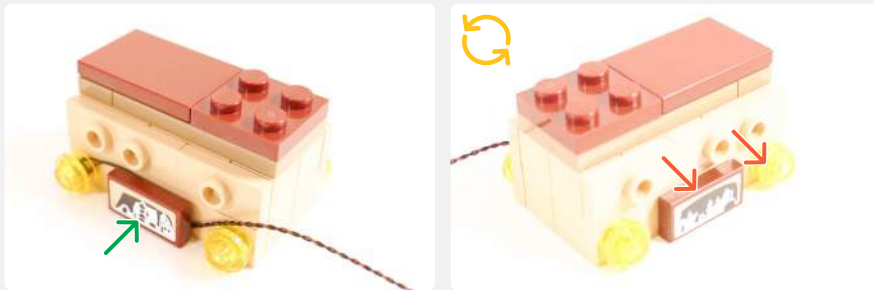
White 30cm Bit Light



**34**







**35**



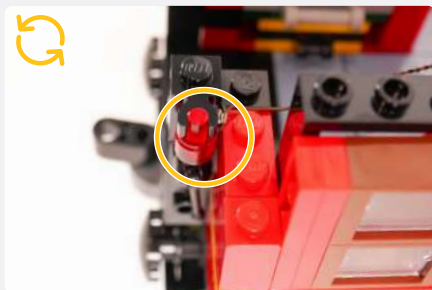
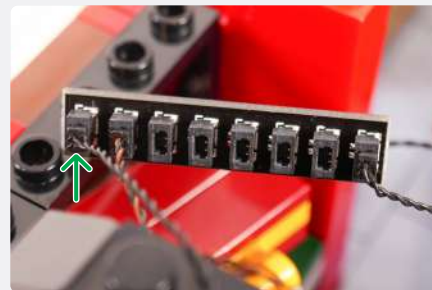
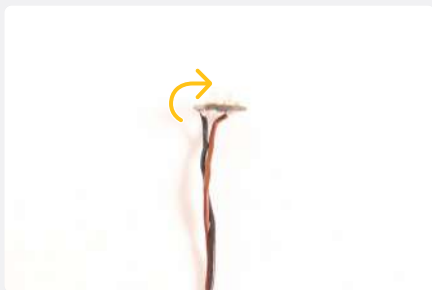
Red 30cm Bit Light




30cm Connecting Cable

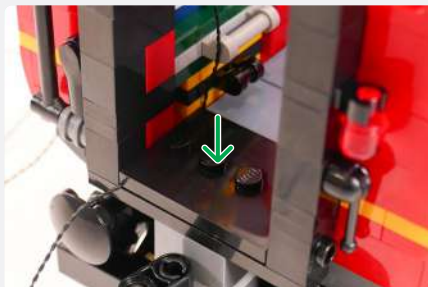
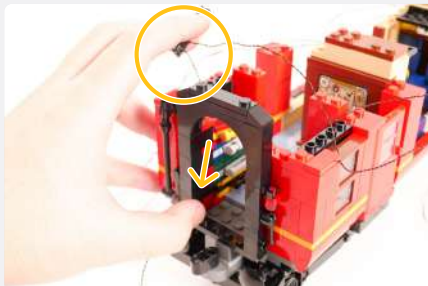



**36**



 **NOTE**

Hold the Expansion Board in the following position. This will allow 30cm Connecting Cable slack.

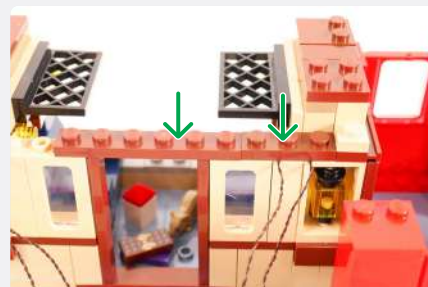
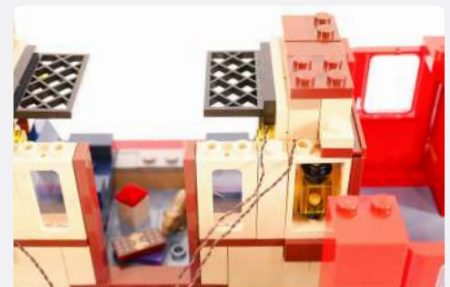
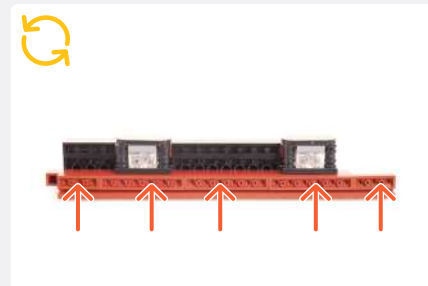


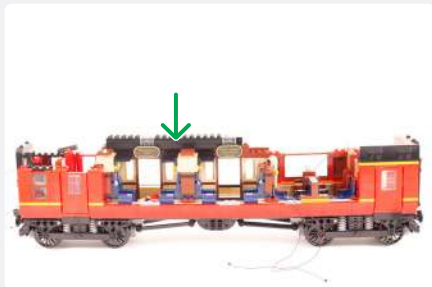
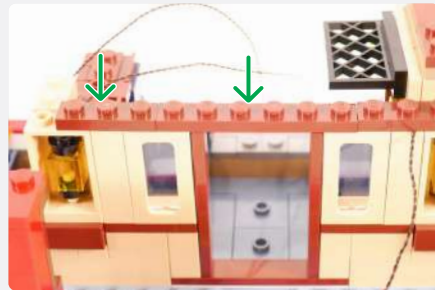
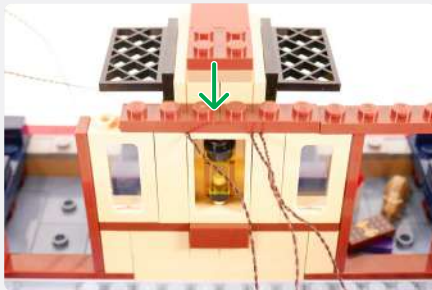
 **NOTE**

Ensure the Expansion Board can still be held in the following position.

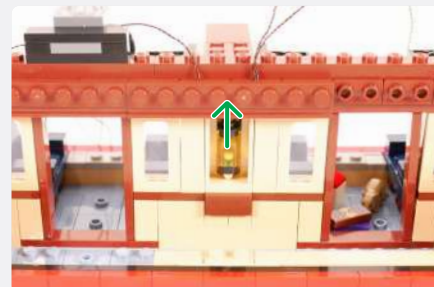
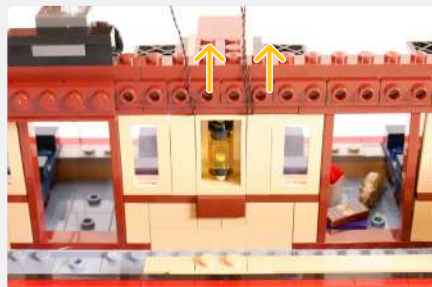
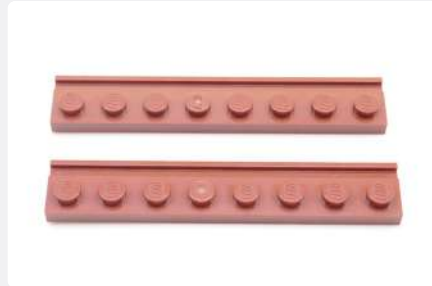


**37**





**38**

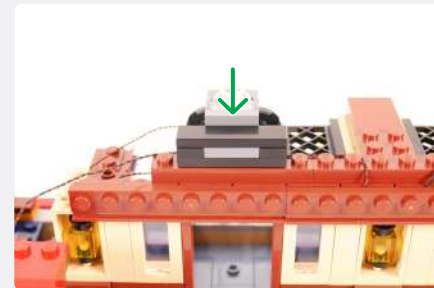
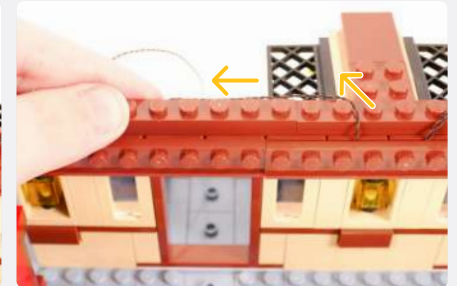
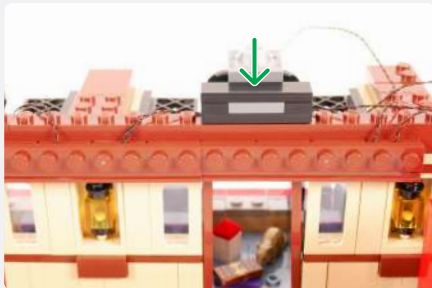


39

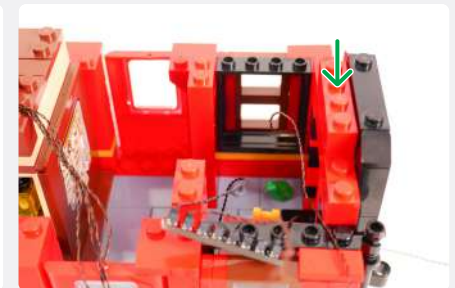
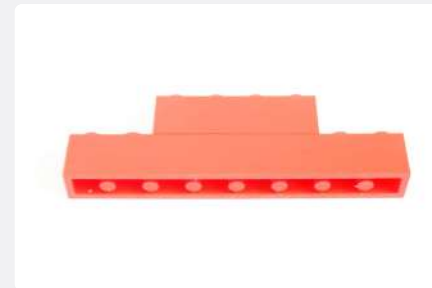
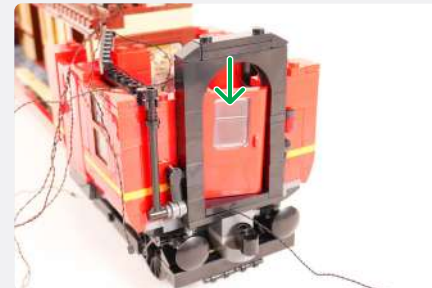
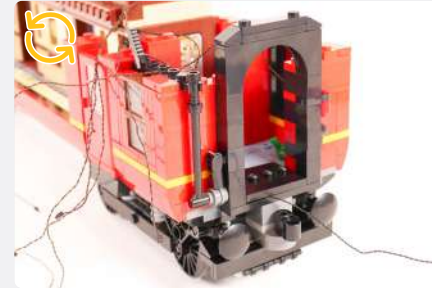
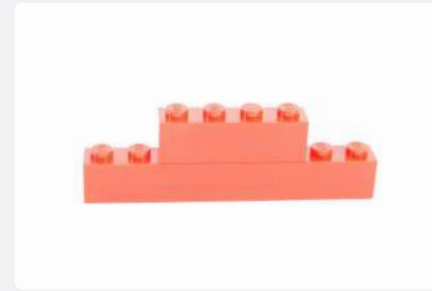
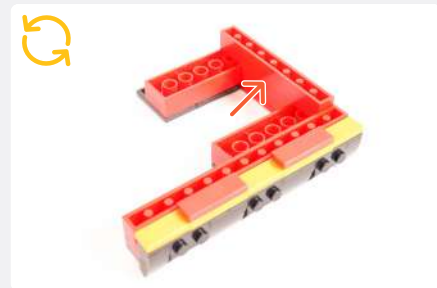
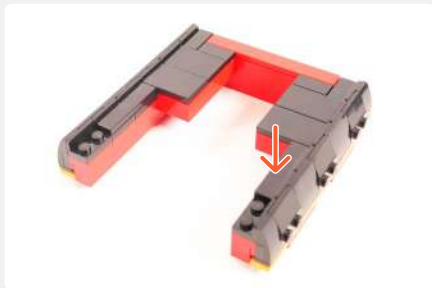
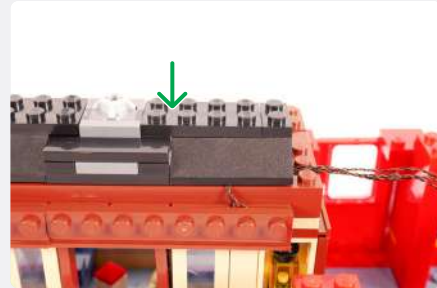
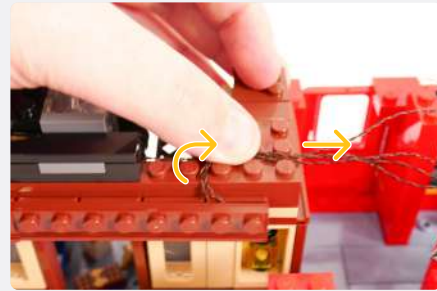


**NOTE**

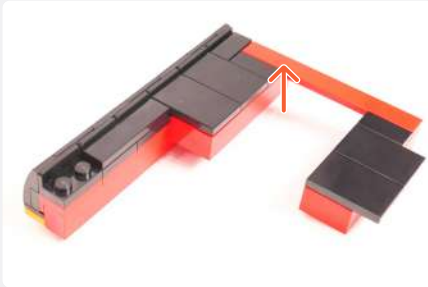
Take the two cables from the middle.



40

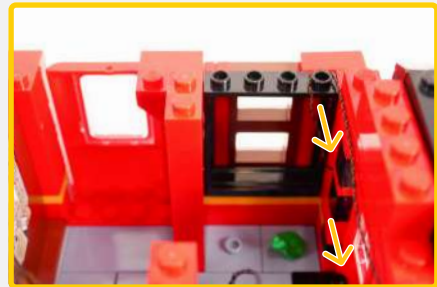
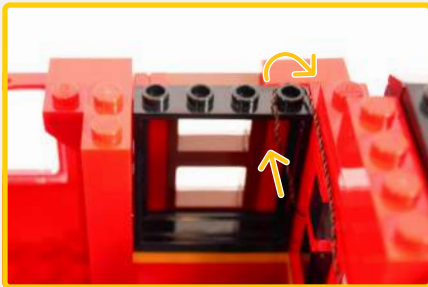


41



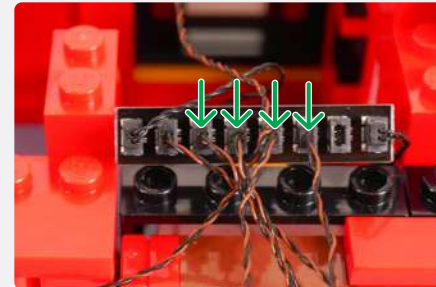
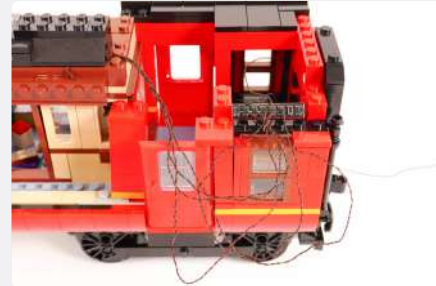
**NOTE**

Pull the Red 30cm Bit Light around the following stud.



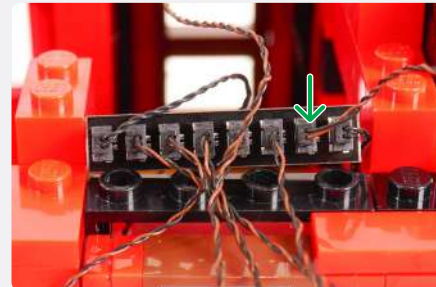
**NOTE**

Twist the circled section of the bundled cables.



**NOTE**

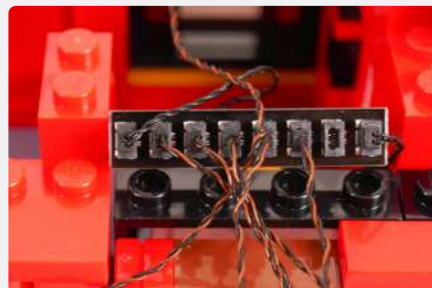
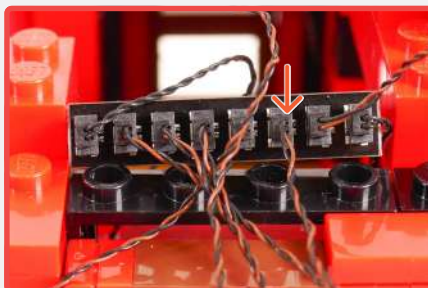
Connect to a 5V USB Power Bank, 5V USB Wall Adaptor, or USB to AA Battery Pack (sold separately)





**NOTE**

Disconnect the USB Power Cable (w/ Power Source).



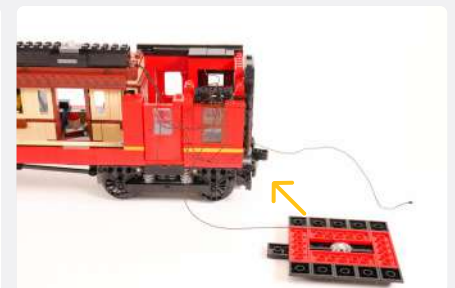
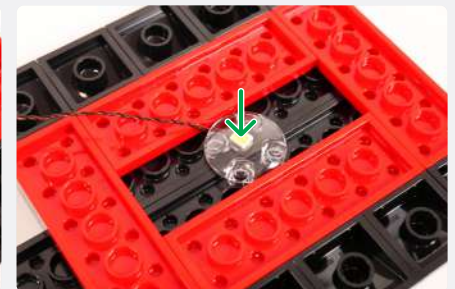
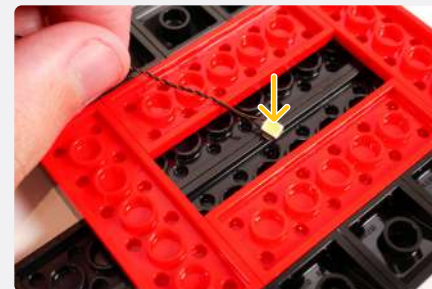
**42**



Warm White 30cm Large Bit Light

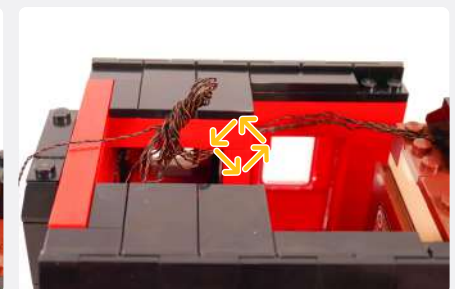
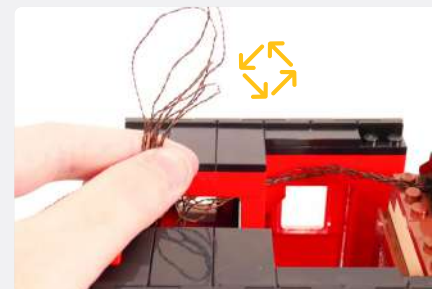
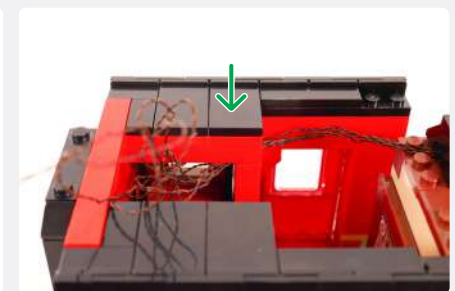
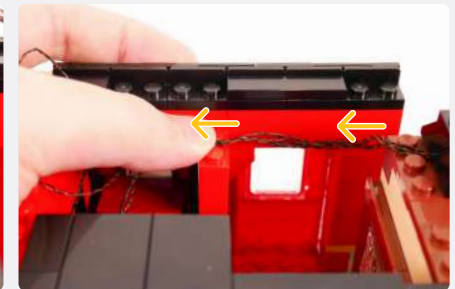
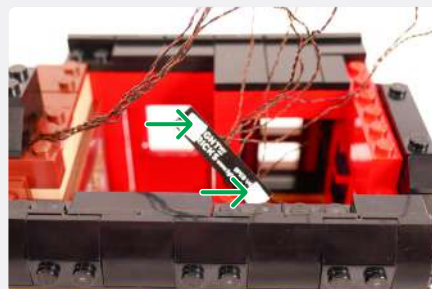
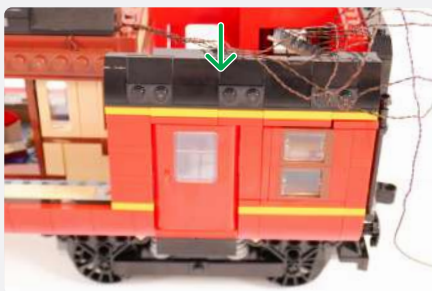
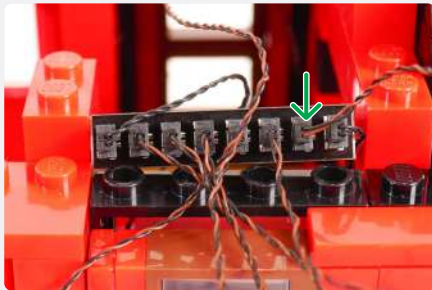


Plate 2x2 W/ Rounded Bottom - Trans Clear



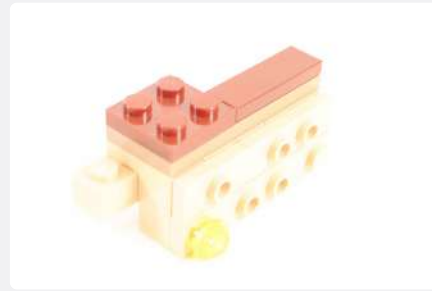
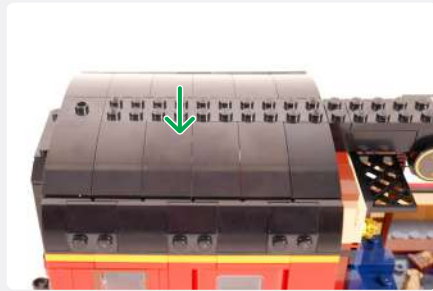
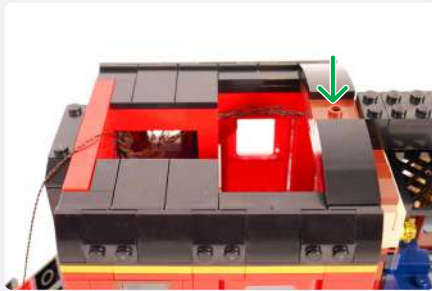
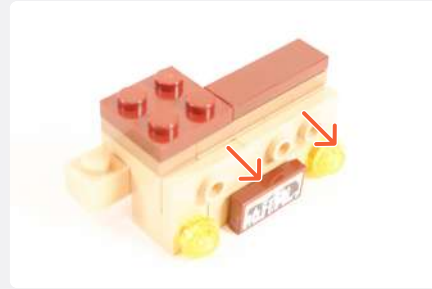
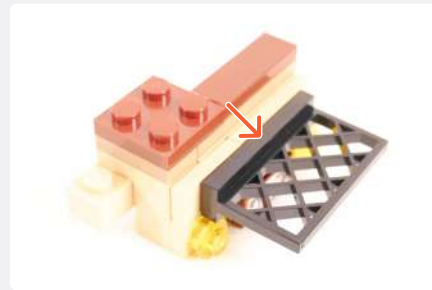


43





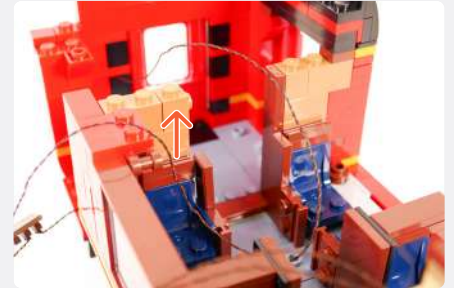
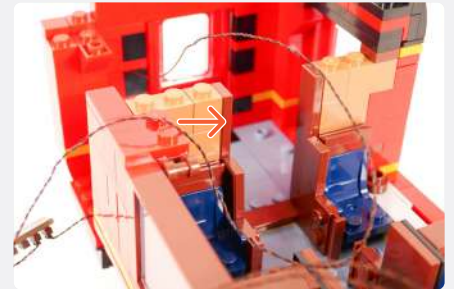
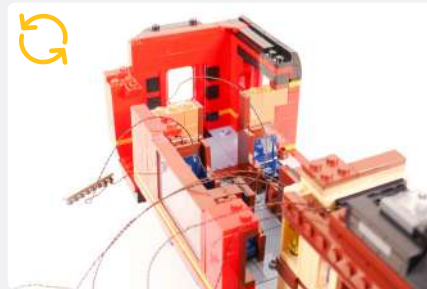
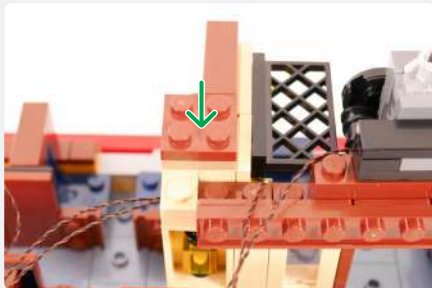
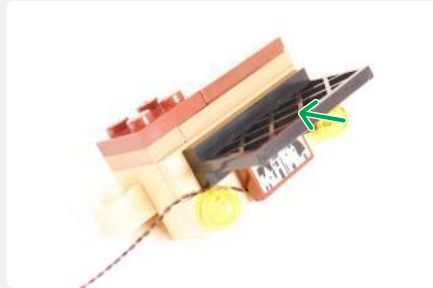
**44**



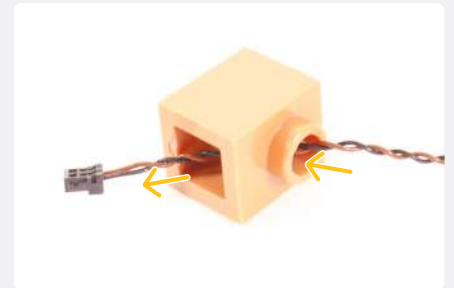
**White 30cm Bit Light**

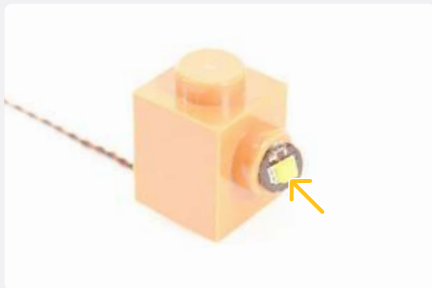


**45**

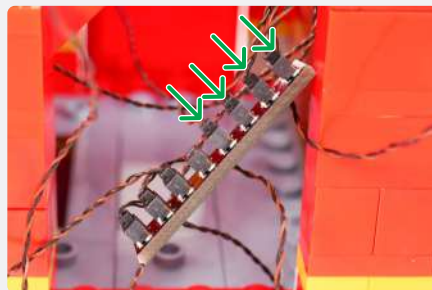
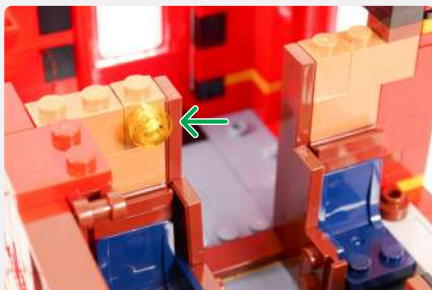
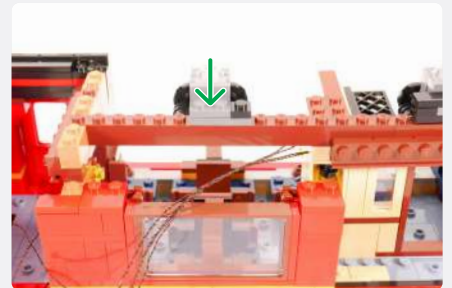
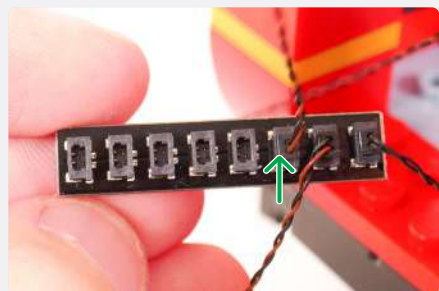


**White 30cm Bit Light**





46

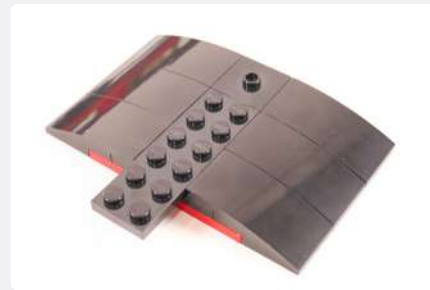


**NOTE**

Connect to a 5V USB Power Bank, 5V USB Wall Adaptor, or USB to AA Battery Pack (sold separately)



47



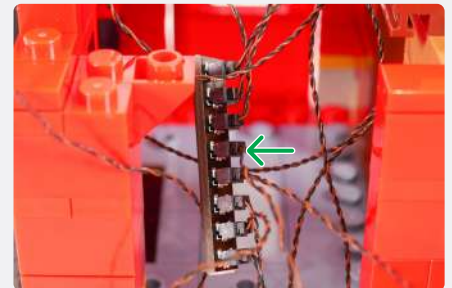
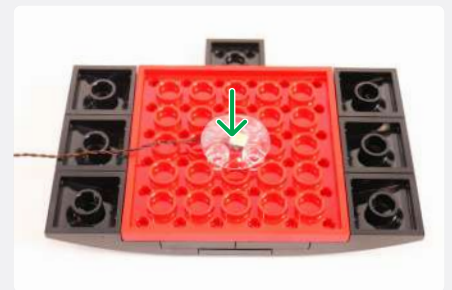
Warm White 30cm Large Bit Light

Plate 2x2 W/ Rounded Bottom - Trans Clear



**NOTE**

Disconnect the USB Power Cable (w/ Power Source).

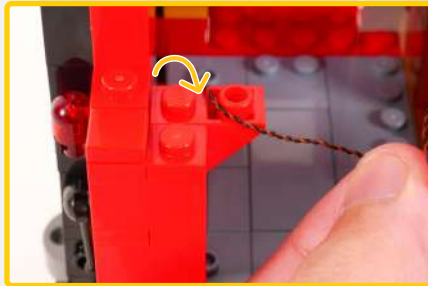
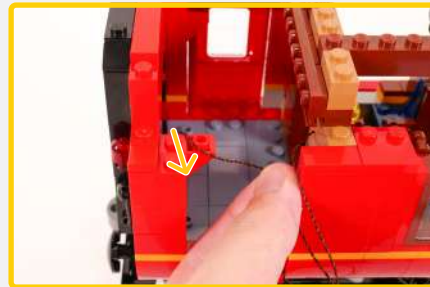


48

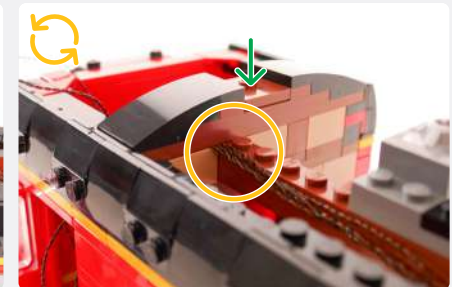
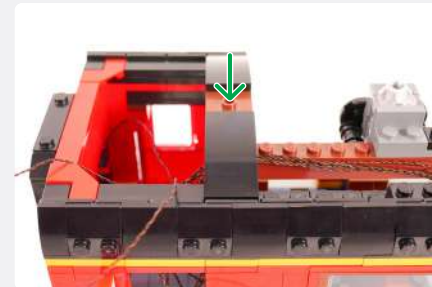
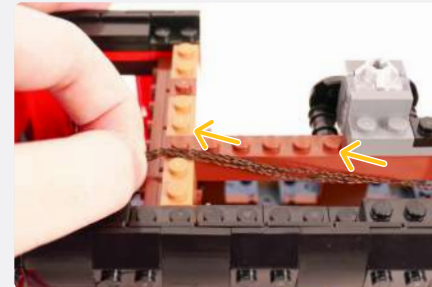
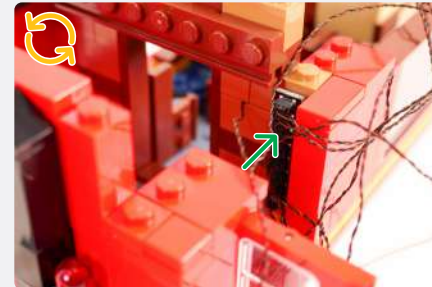
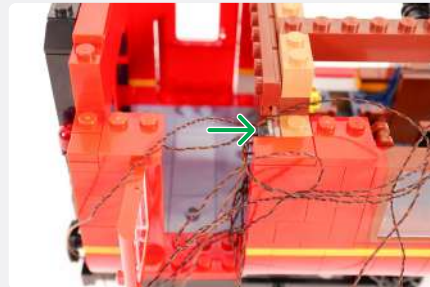
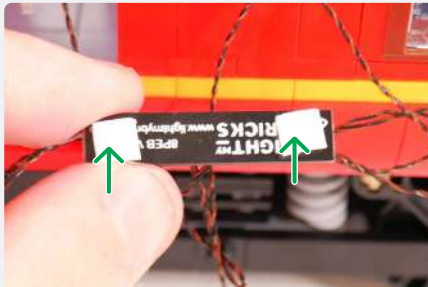
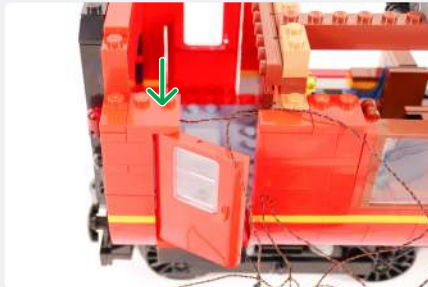


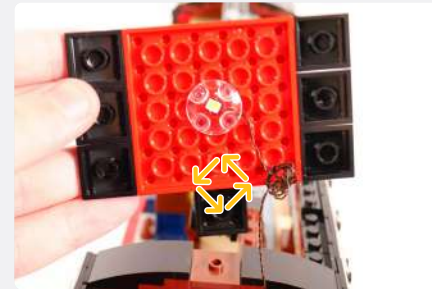
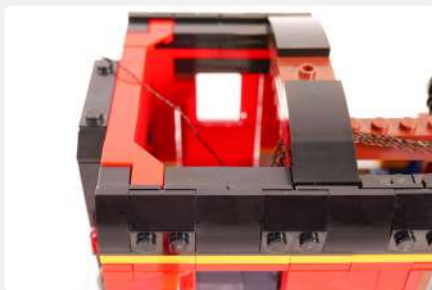
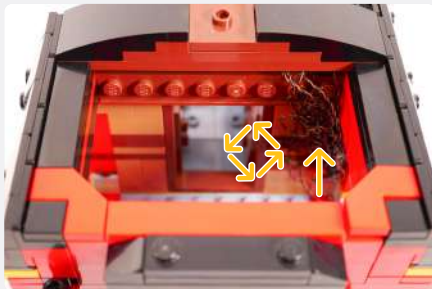
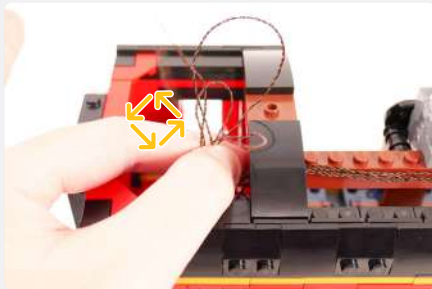
NOTE

Pull the Red 30cm Bit Light around the following stud.



2x Adhesive Square



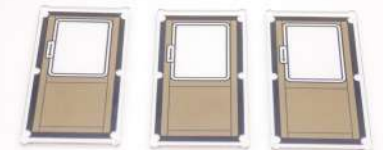


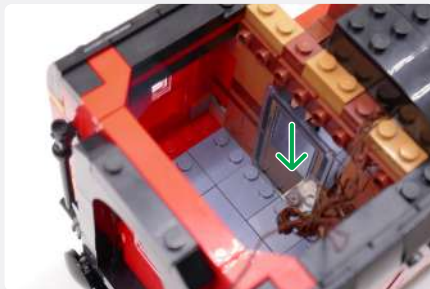
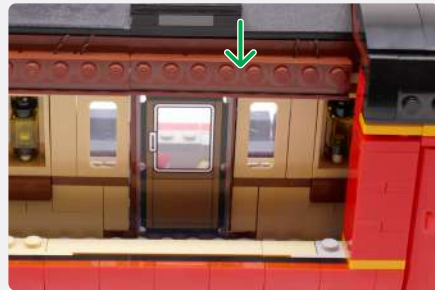
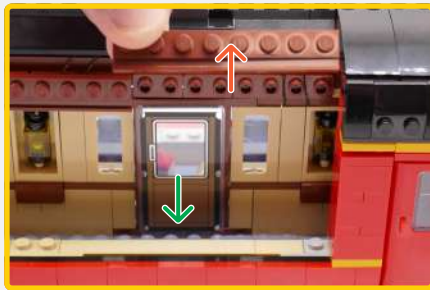
49



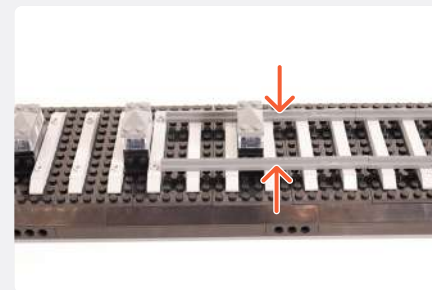
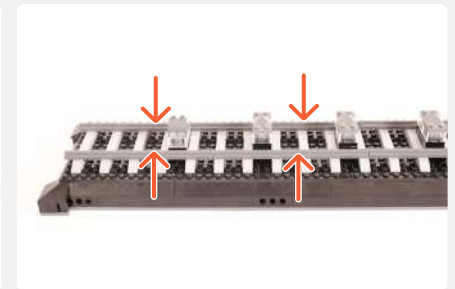
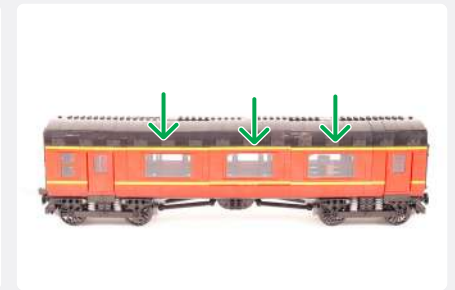
NOTE

Return all three sliding doors by removing the Brown 1x8 Plates as shown.

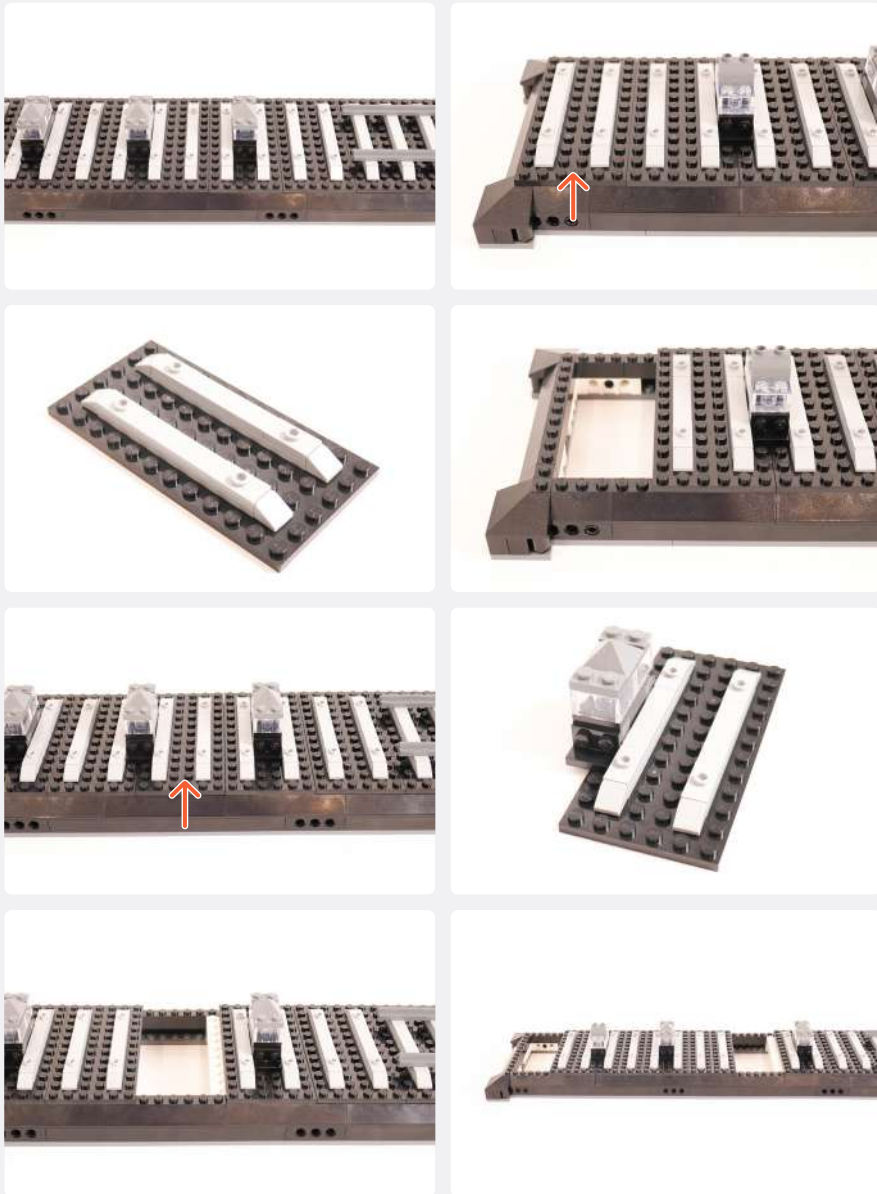




50





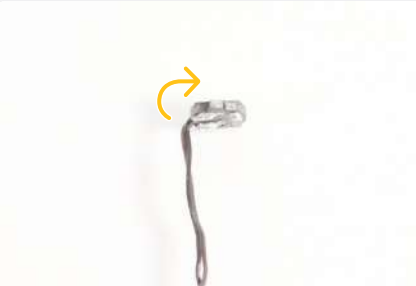


**51**

Round Plate 1x1 Open Stud - Black



Warm White 30cm Large Bit Light

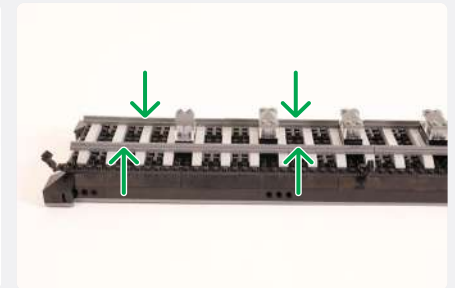
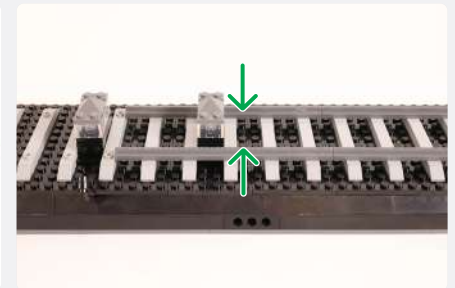
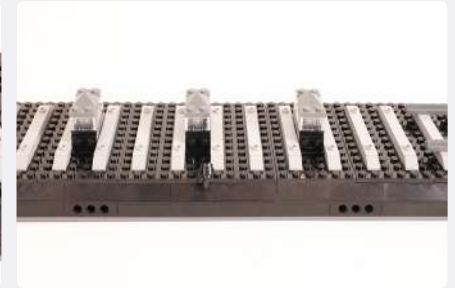
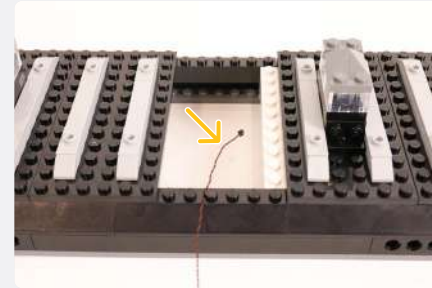
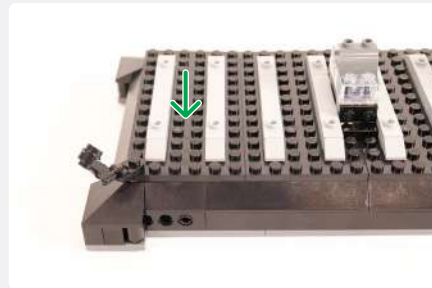
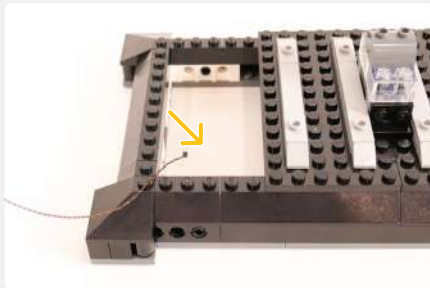


Arm Skeleton, Bent W/ Clips Horizontal Grip - Black



2 x Plate 1x1 Mod Rounded W/ Handle - Black



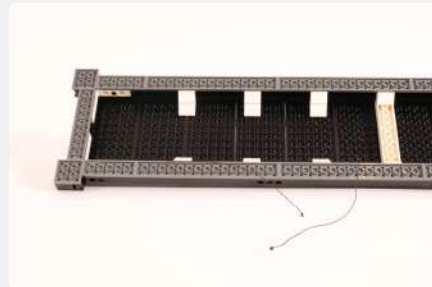


52

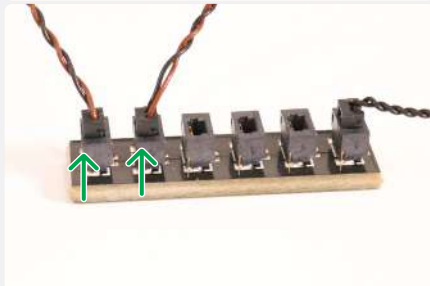
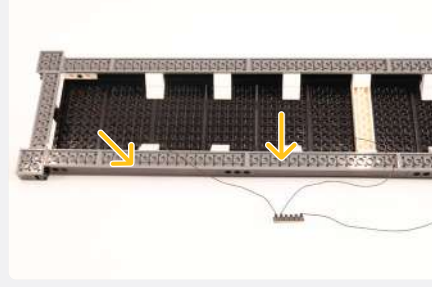
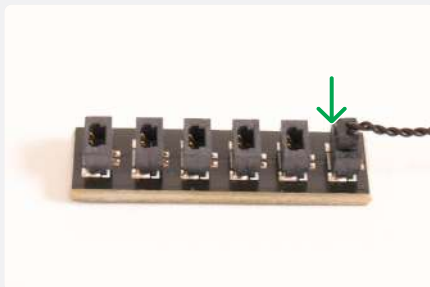
53



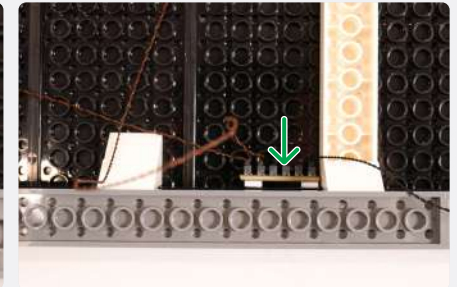
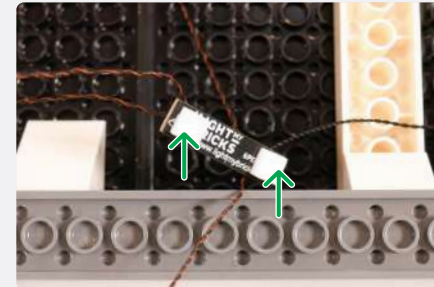
6-Port Expansion Board



50cm Connecting Cable

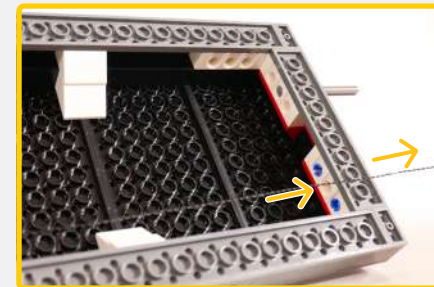
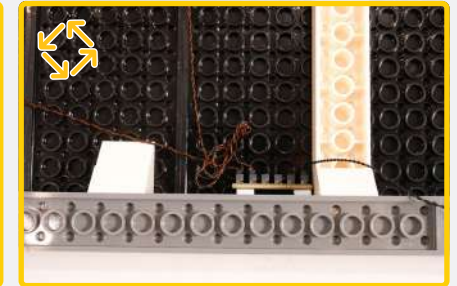


2x Adhesive Square

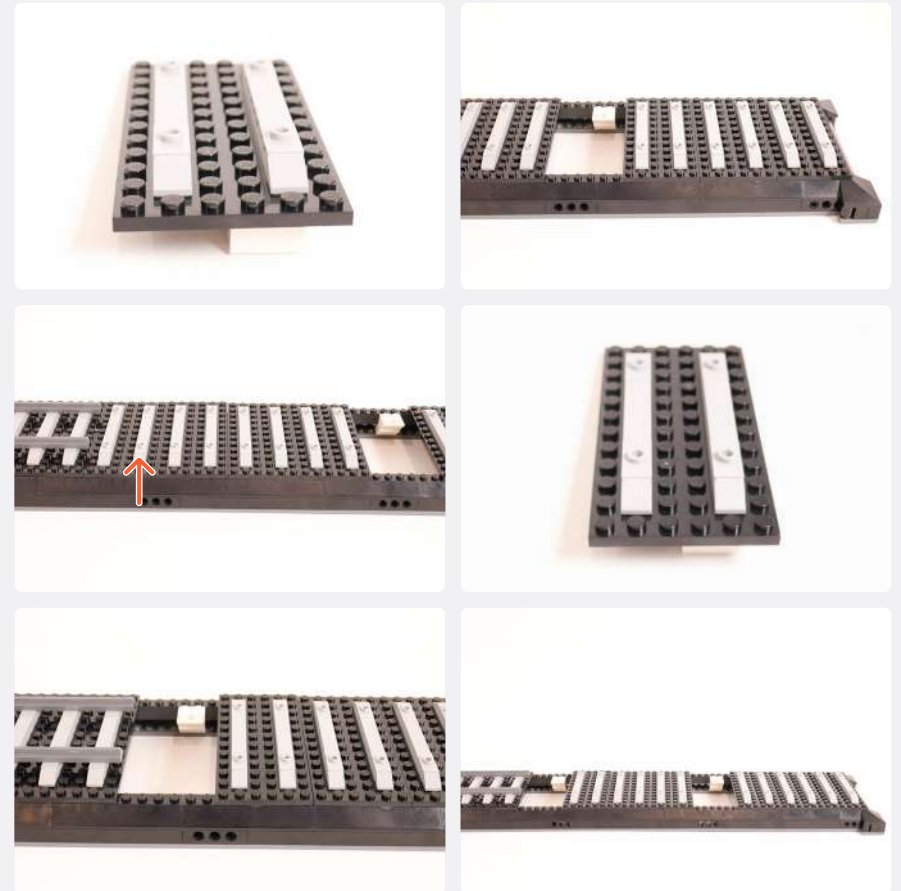
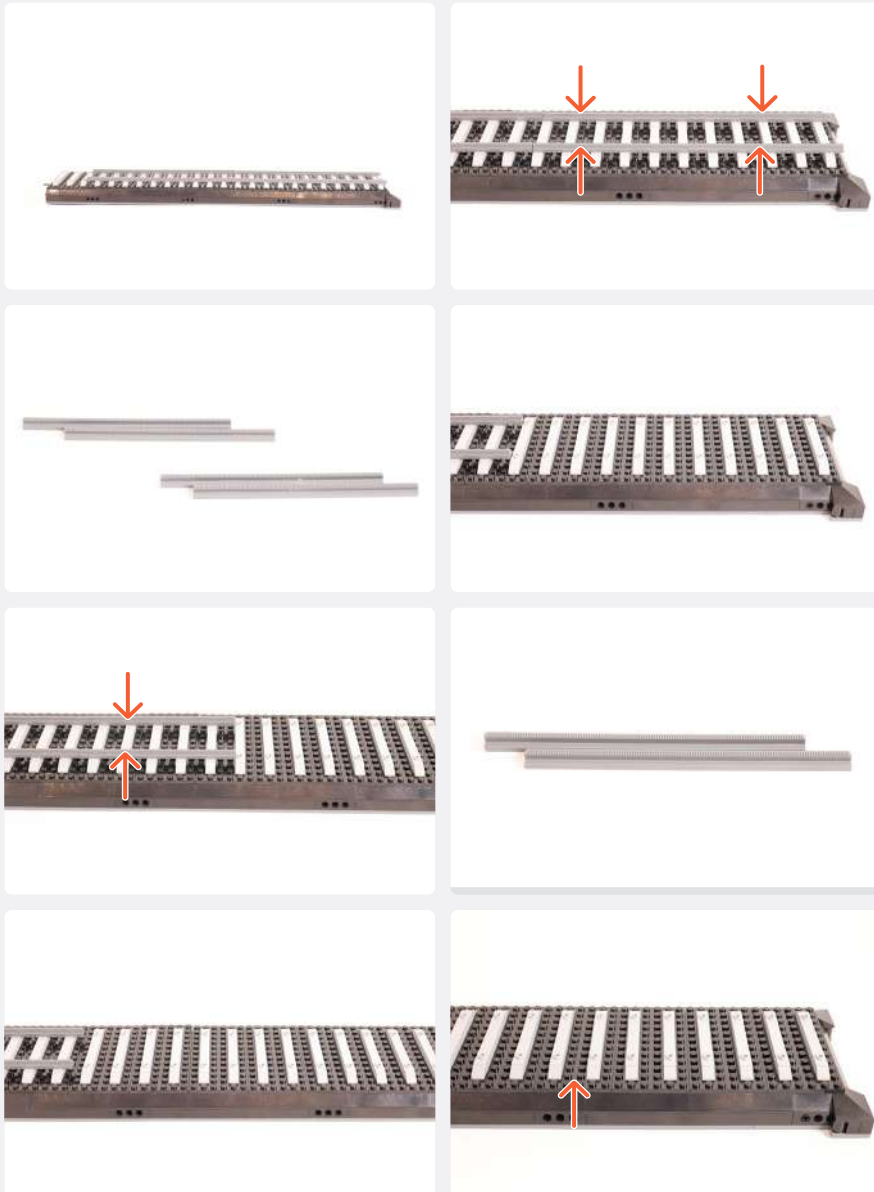


NOTE

Exclude the 50cm Connecting Cable from the twisting but instead, thread the cable through the Technic hole on the right side.



54



**55**

Round Plate 1x1 Open Stud - Black



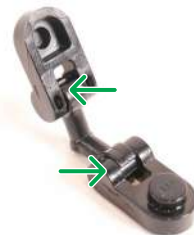
Warm White 30cm Large Bit Light



Arm Skeleton, Bent W/ Clips Horizontal Grip - Black



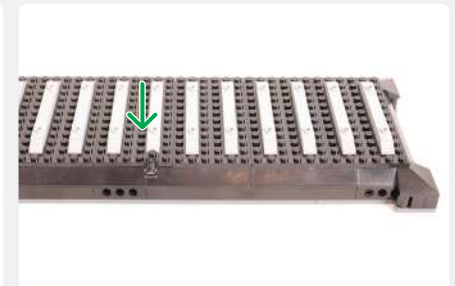
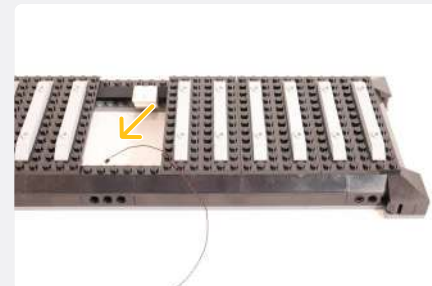
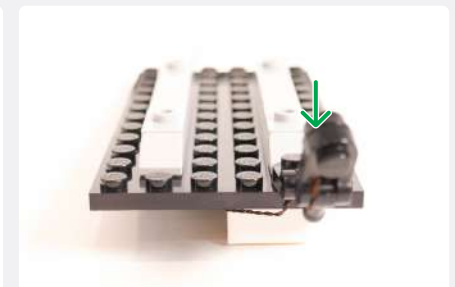
2 x Plate 1x1 Mod Rounded W/ Handle - Black



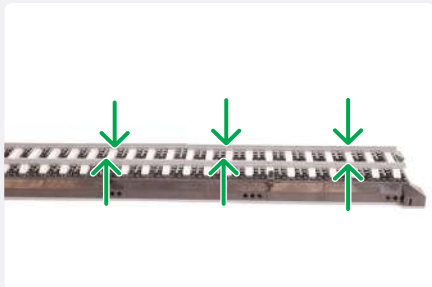
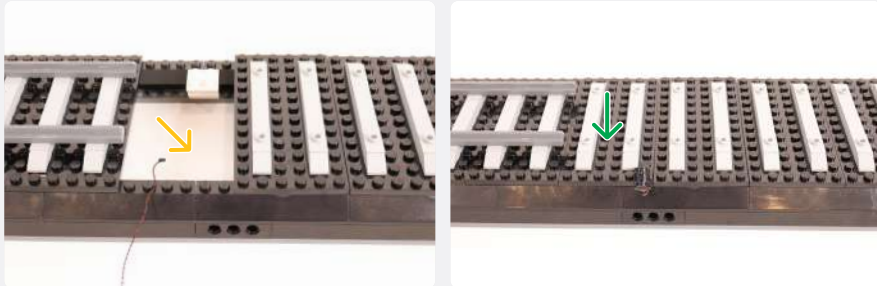
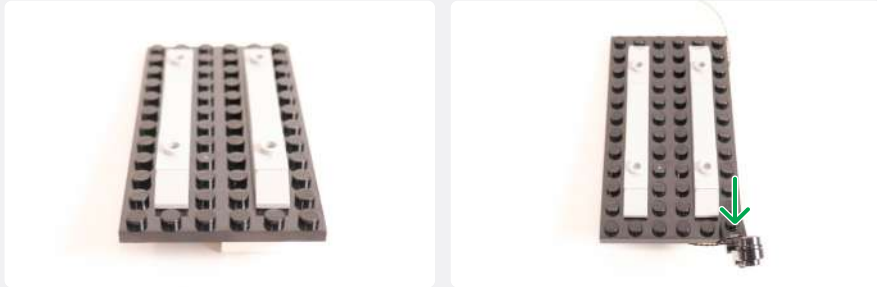
**56**



x2



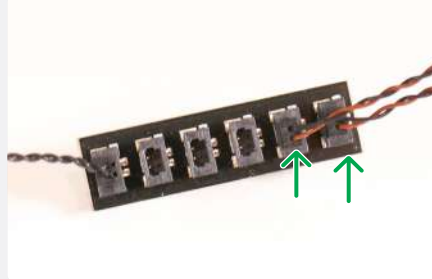
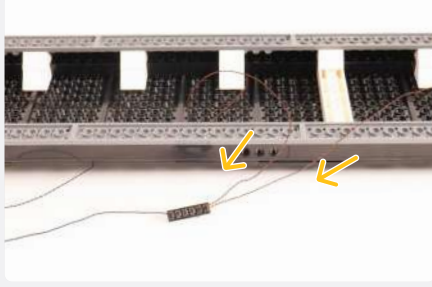
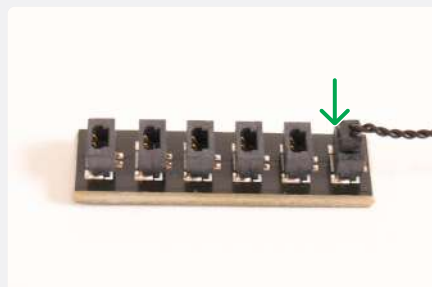
**57**



**6-Port Expansion Board**

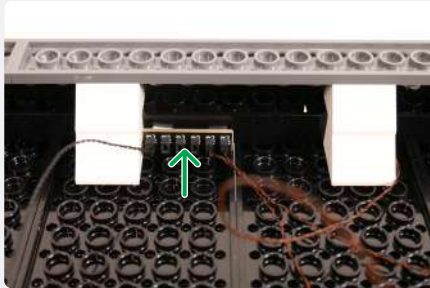
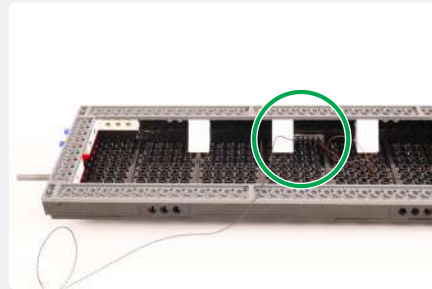
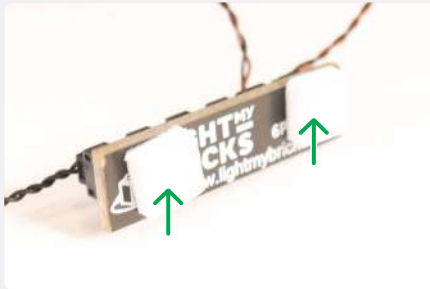



**50cm Connecting Cable**



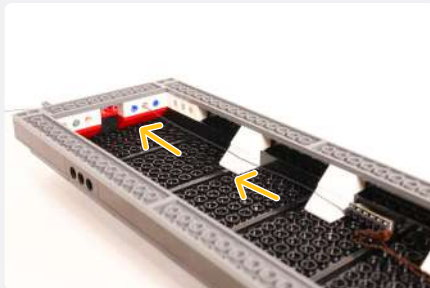
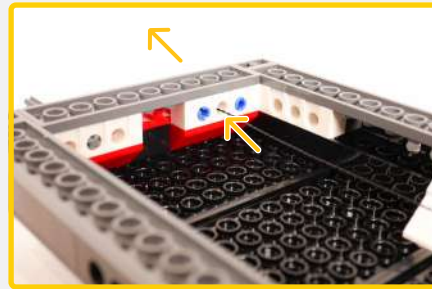
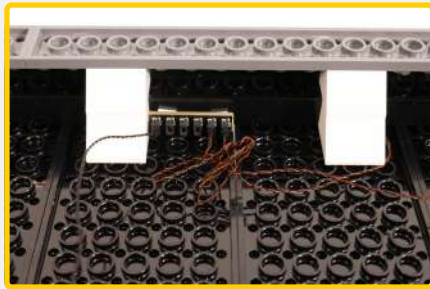
**2x Adhesive Square**



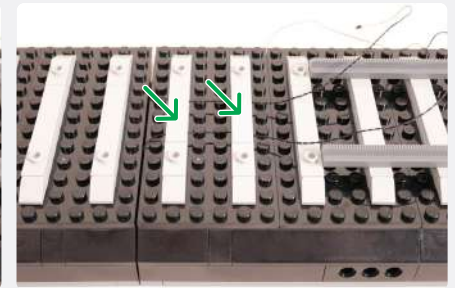
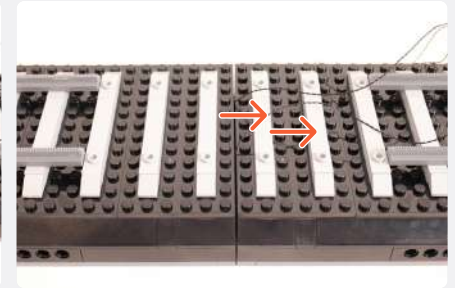
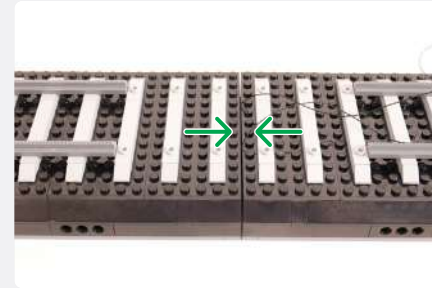
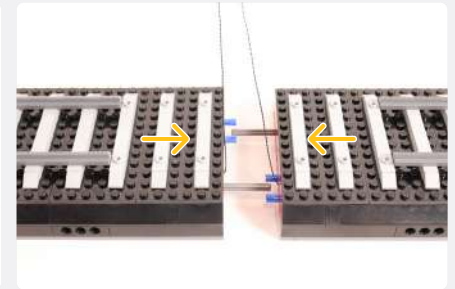


 **NOTE**

Exclude the 50cm Connecting Cable from the twisting but instead, thread the cable through the Technic hole on the left side.



**58**





2-Port Expansion Board

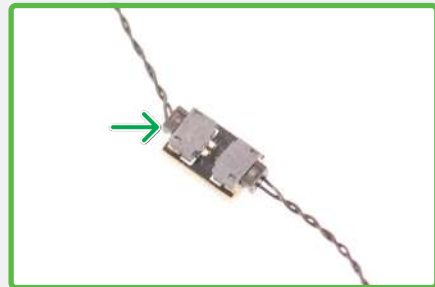
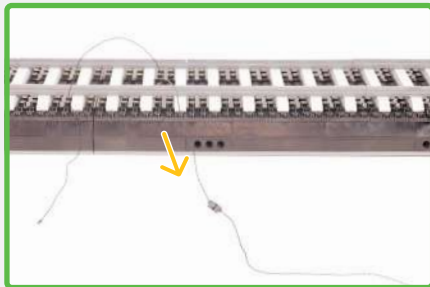
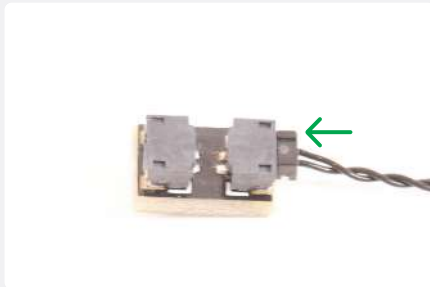


15cm Connecting Cable

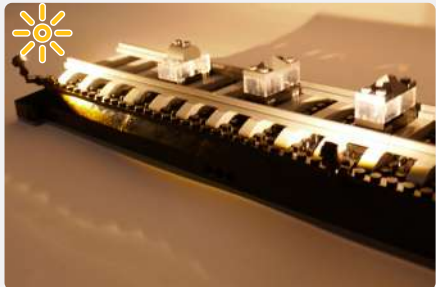
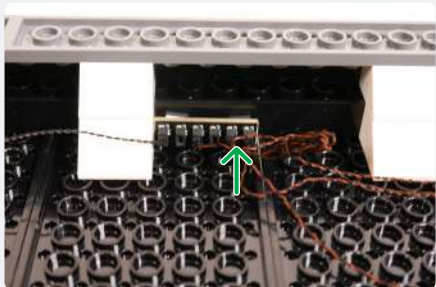


59

**NOTE**  
Connect the shorter Connecting Cable from the middle of the track to the 2-Port Expansion Board



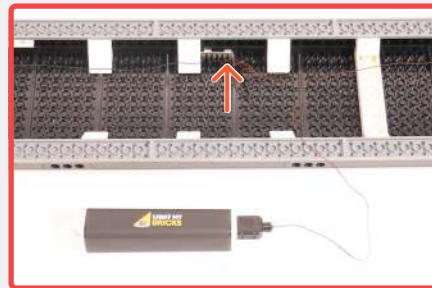
**NOTE**  
Connect the USB Power Cable to both 6-Port Expansion Boards individually beneath the track to test the lights.



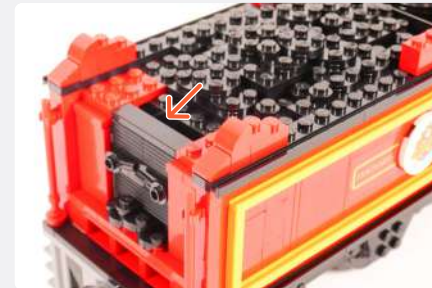
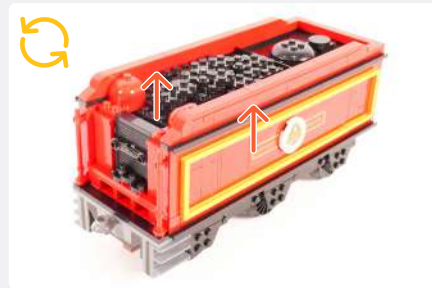


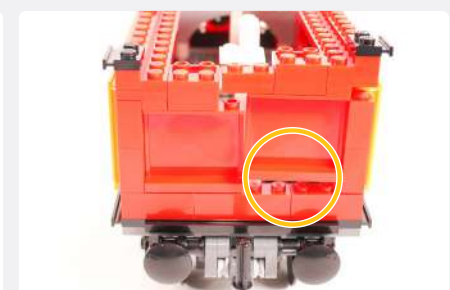
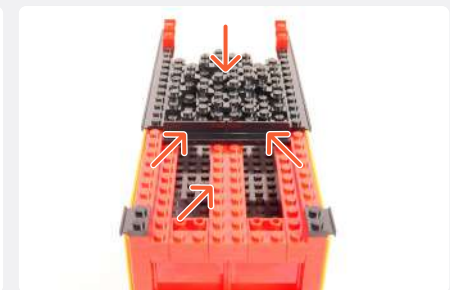
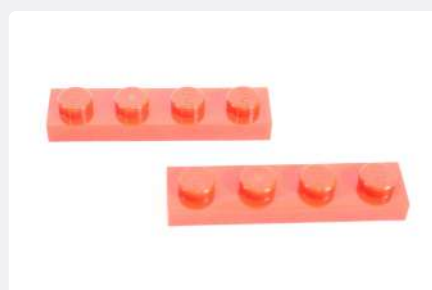
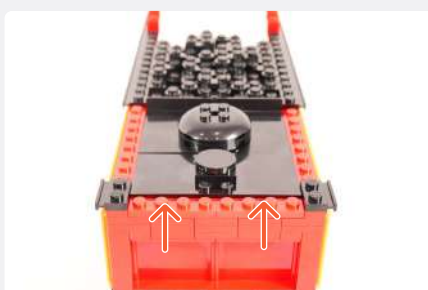
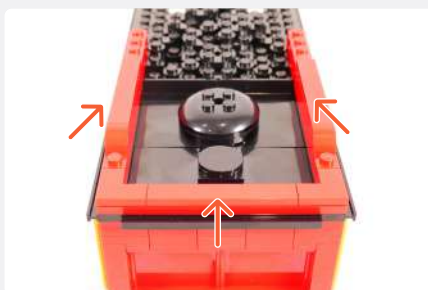
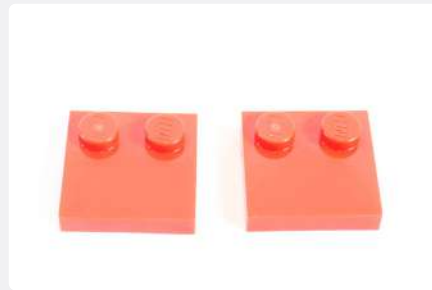
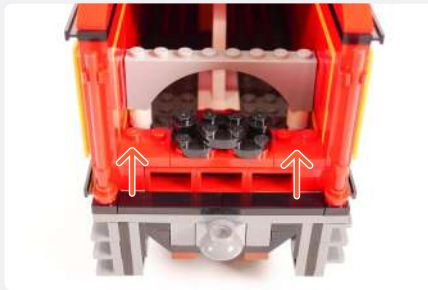
**NOTE**

Disconnect the USB Power Cable (w/ Power Source).



60

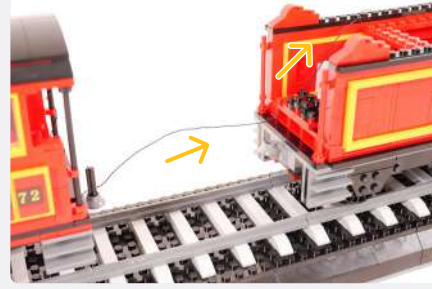
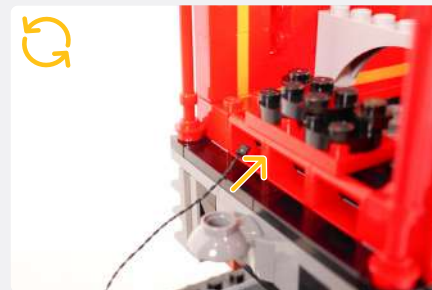
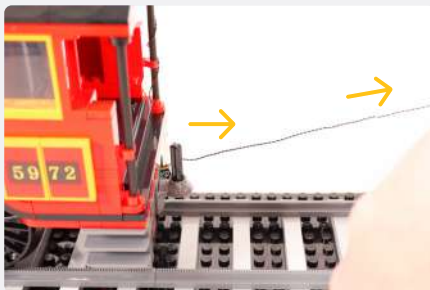
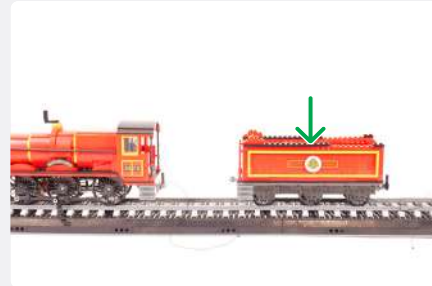
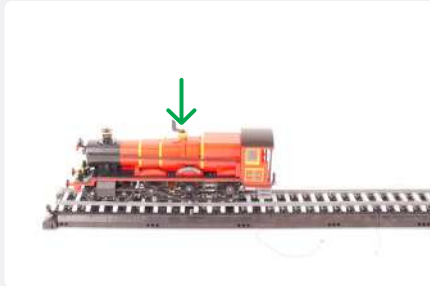
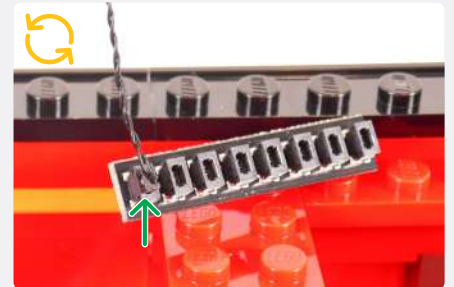
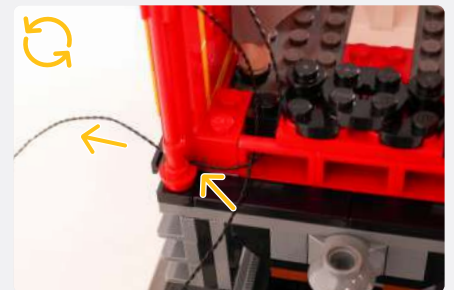
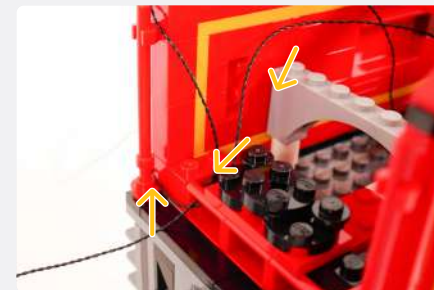
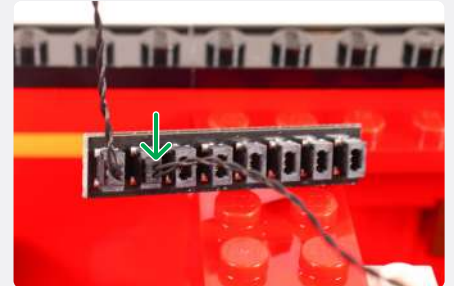




**61**

**NOTE**

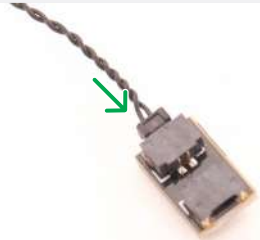
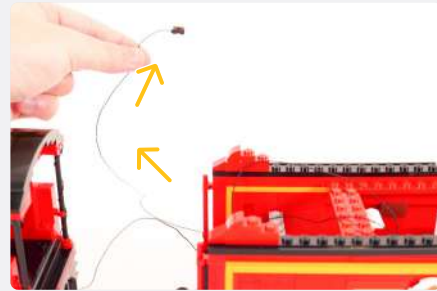
Before reconnecting all the sections, it may be ideal to place the train track in your preferred displayable location.


**62**
**8-Port Expansion Board**

**50cm Connecting Cable**

**NOTE**

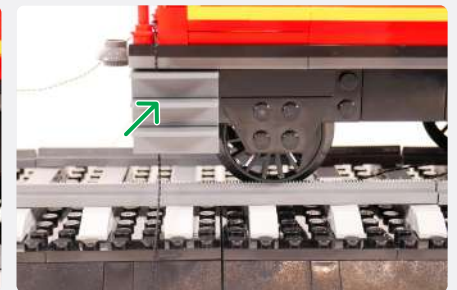
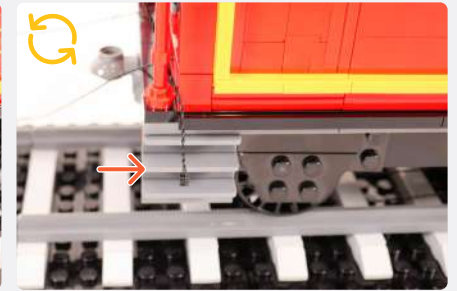
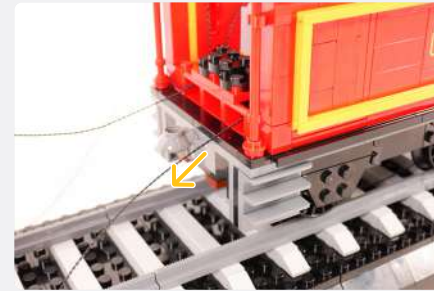
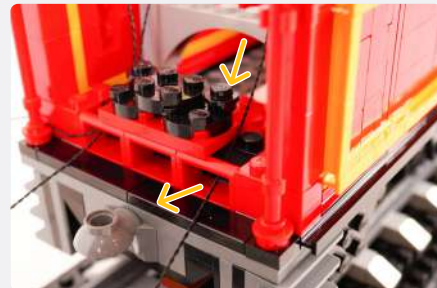
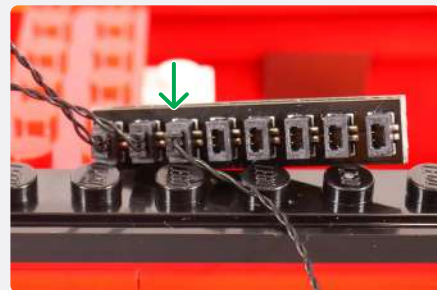
Keep the 8-Port Expansion Board positioned in the middle of the coal carriage while pulling through the 50cm Connecting Cable.



2-Port Expansion Board



50cm Connecting Cable

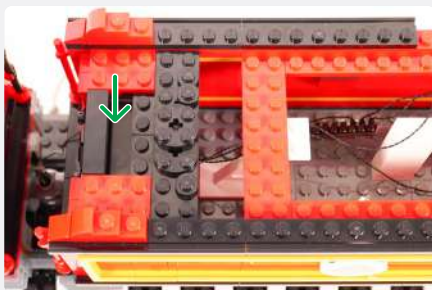
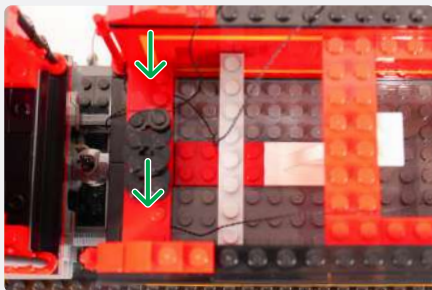
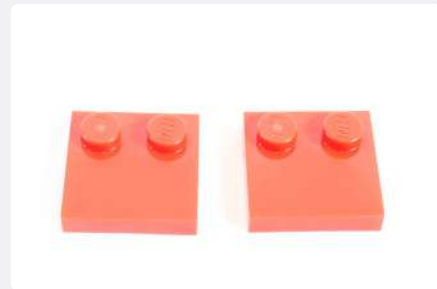
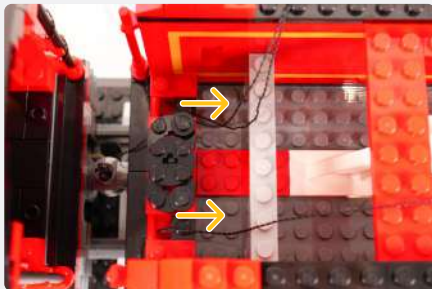
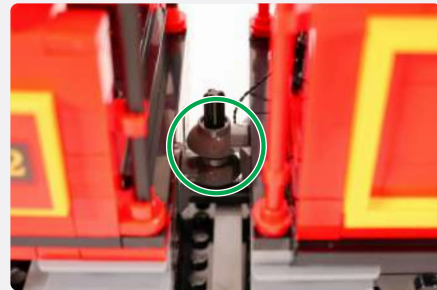


NOTE

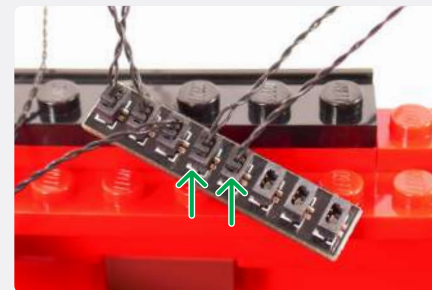
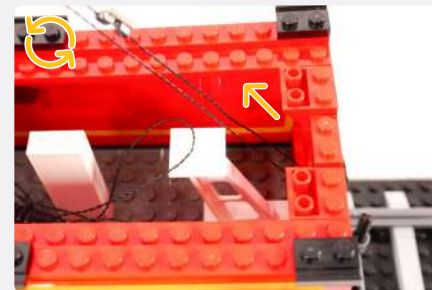
Ensure the 8-Port Expansion Board is still positioned towards the middle of the carriage.



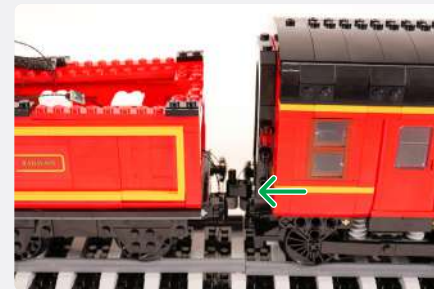
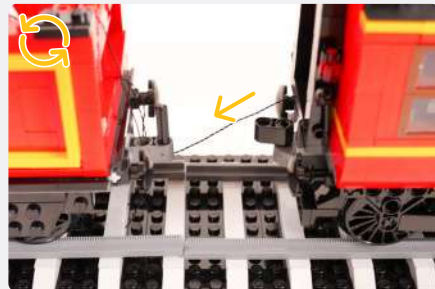
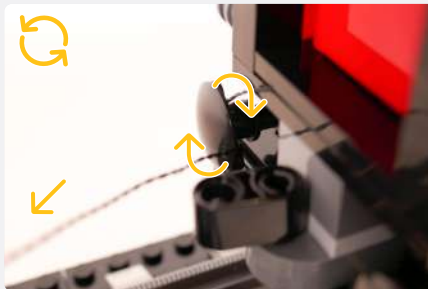
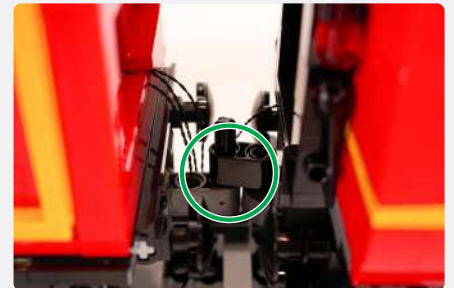
64



65

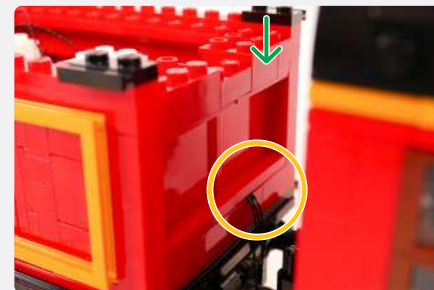
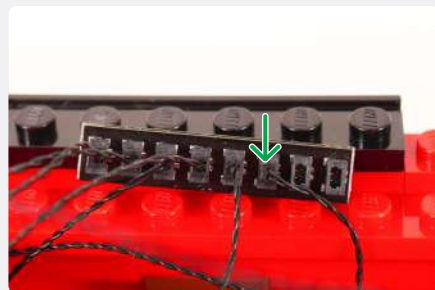
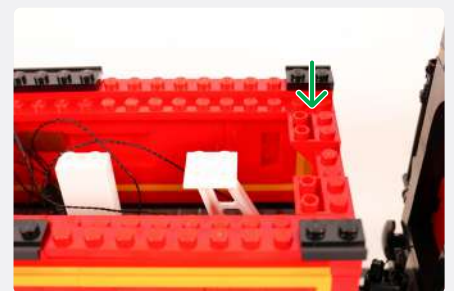
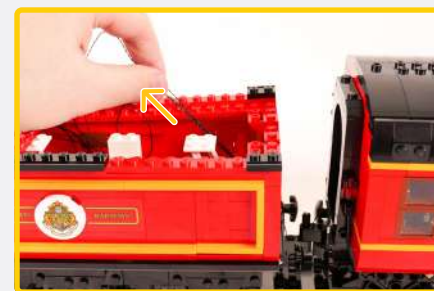
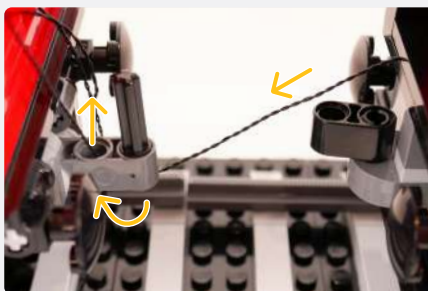


66

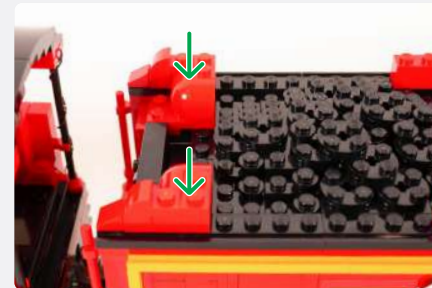
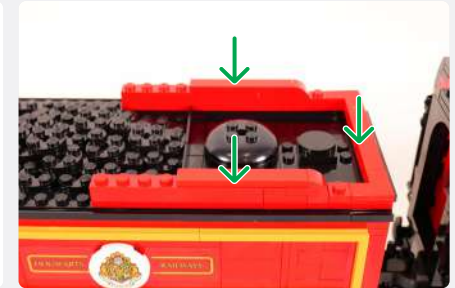
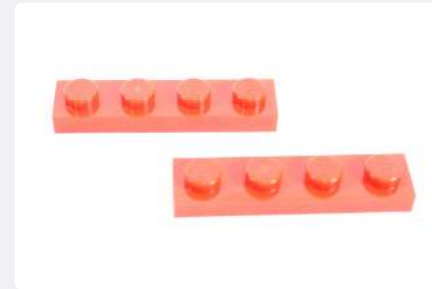
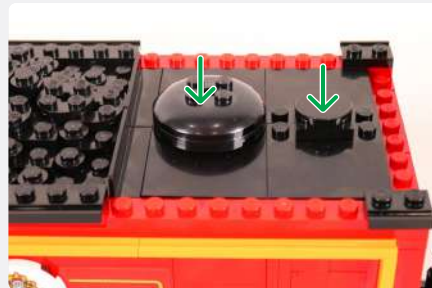
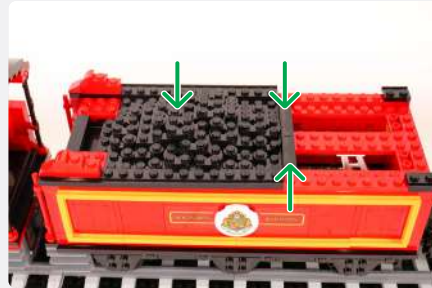


**NOTE**

Pull all the cables tightly towards the Expansion Board.



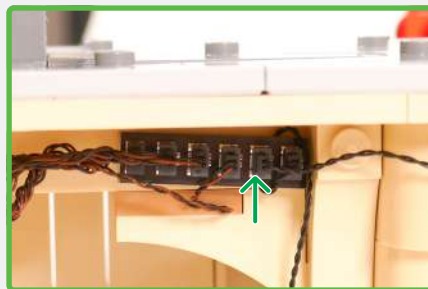
67



**68**

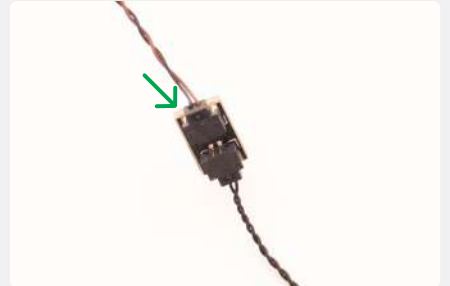

**NOTE**

Connect the 50cm Connecting Cable to the 6-Port Expansion Board on the Station Platform.


**69**

**NOTE**

Connect the USB Power Cable to the 2-Port Expansion Board behind the train



**NOTE**

You should have these parts left over that were removed from the LEGO set

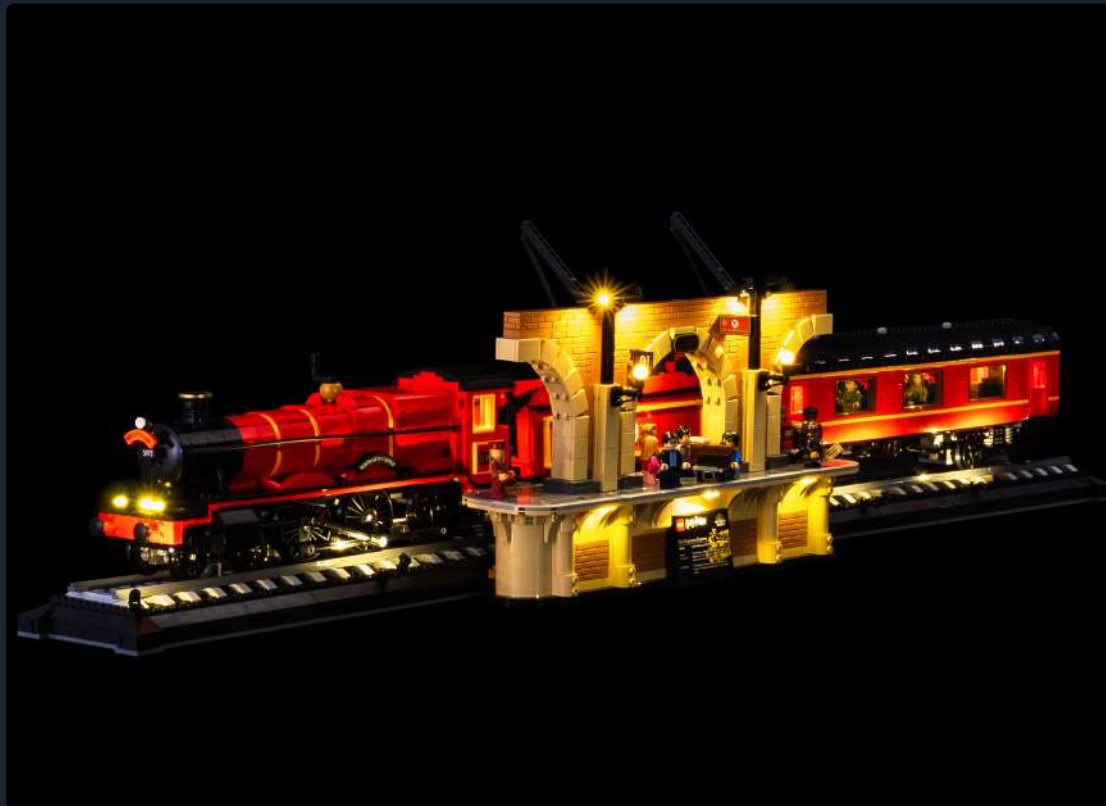
**Removed Pieces**



## FINAL PRODUCT

This finally completes installation of the Light My Bricks

LEGO® Hogwarts Express - Collectors' Edition 76405 Light Kit.





## TROUBLESHOOTING

Light My Bricks lighting kits contain individual components that are very small and can be easily damaged if not handled correctly.

To prevent unnecessary damage to components, we highly recommend that the User Guide section, **“Important things to note”** is read carefully. Follow the handling procedures in the User Guide to help prevent faults and damages to your Light My Bricks components.

If you are experiencing issues with your Light My Bricks set, watch our troubleshooting video [here](#) or read on for a list of common causes to help you troubleshoot.

## Troubleshooting

**Firstly, ensure that the batteries have power using a battery charge gauge.**

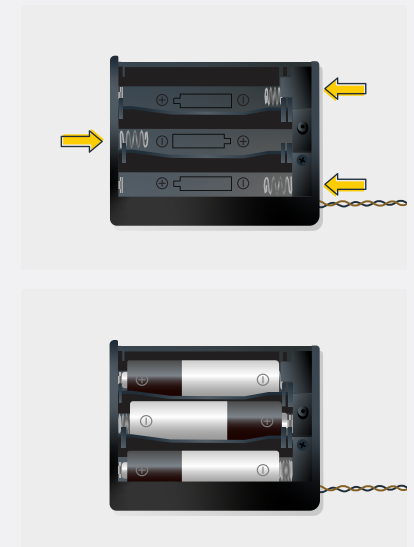
**If the batteries have no power, replace the batteries.**

**If the batteries still have power, check to see if the batteries have been inserted correctly into the battery pack.**

### Check for AA batteries using the AA battery pack

Inside the battery pack are symbols indicating which direction the AA battery should be inserted. The flat side of the battery should be paired with the spring side of the battery pack.

If the batteries have been installed correctly and your kit still isn't operating correctly, the next step is to check the wiring.



## Troubleshooting

### Check Your Wires

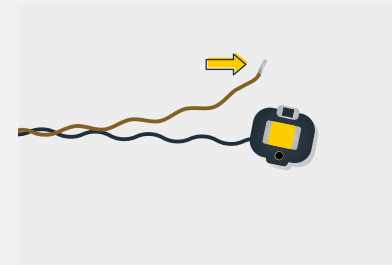
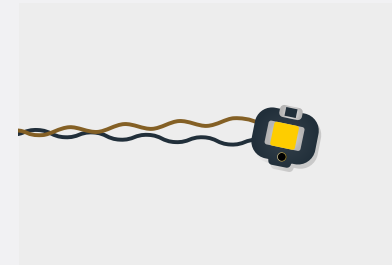
In order for Light My Bricks components to fit in between and underneath LEGO® bricks, the components need to be very small. Due to this nature, Light My Bricks components can be easily damaged when not handled correctly.

Be careful when removing unpacked components out of the packaging and ensure not to forcibly pull at the wires as this can damage the soldering that attach the wires to the LEDs.

If the wiring is detached from the LED itself, the light will not operate.

When connecting lights to your LEGO® set, check that there are no pinched wires underneath or in between bricks and plates.

When the wires are pinched and the exposed wires are touching each other, this can cause a crosswire and the lights to not function correctly.



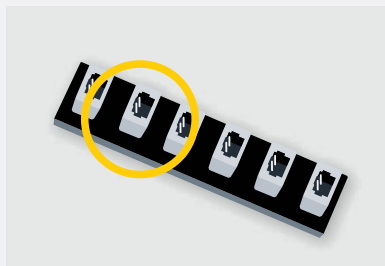
## Troubleshooting

### Check Your Expansion Board Ports / Strip Light Ports / Effects Board Ports

It is important to note that connectors can only be inserted to the expansion board, strip light, or effects board ports in one direction.

Forcibly inserting connectors in the incorrect direction will result in damaging the pins inside each of the ports on your component board.

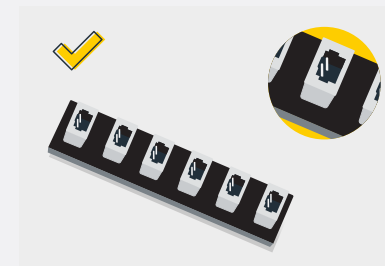
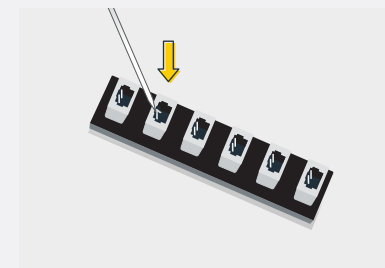
Not only will a light connected to the damaged port not work, but if the pins inside the port are bent to a point they are touching each other, this can result in all other lights in the system to stop working. This is a short circuit.



A short circuit can also result in overheating of the board, cable or batteries. If you suspect a short circuit, **DISCONNECT POWER IMMEDIATELY**. Batteries can fail, catch fire, or even explode if left connected to a short circuit for too long.

If you suspect you have a faulty component due to a bent pin, try the following steps:

If you look carefully inside each of the ports, each port contains 2 small pins that should be straight. You will be able to identify a faulty port if it has any bent pins.





## CONTACT US

If you have an enquiry regarding the online shop, our products or a general enquiry please refer to our Frequently Asked Questions webpage here.

Alternatively, you can contact our Customer Services team by visiting our online support portal here.

[support.lightmybricks.com](https://support.lightmybricks.com)

We thank you for purchasing this product and hope you enjoy!



[lightmybricks.com](https://lightmybricks.com)