



**LIGHT<sup>MY</sup>  
BRICKS**



**LEGO® SPRING LANTERN FESTIVAL  
#80107 LIGHT KIT  
INSTALLATION GUIDE**

# Light My Bricks



## LEGO® SPRING LANTERN FESTIVAL #80107 LIGHT KIT INSTALLATION GUIDE

Hi There!

We're here to help you get started on the LEGO®  
Spring Lantern Festival (80107) Light Kit.

This PDF details the instructions for the LED light kit only. If you are wishing to purchase this product, please [click here](#) to view the product page.

If you run into any issues, please refer to the troubleshooting section towards the end of this guide.

Have fun and enjoy!

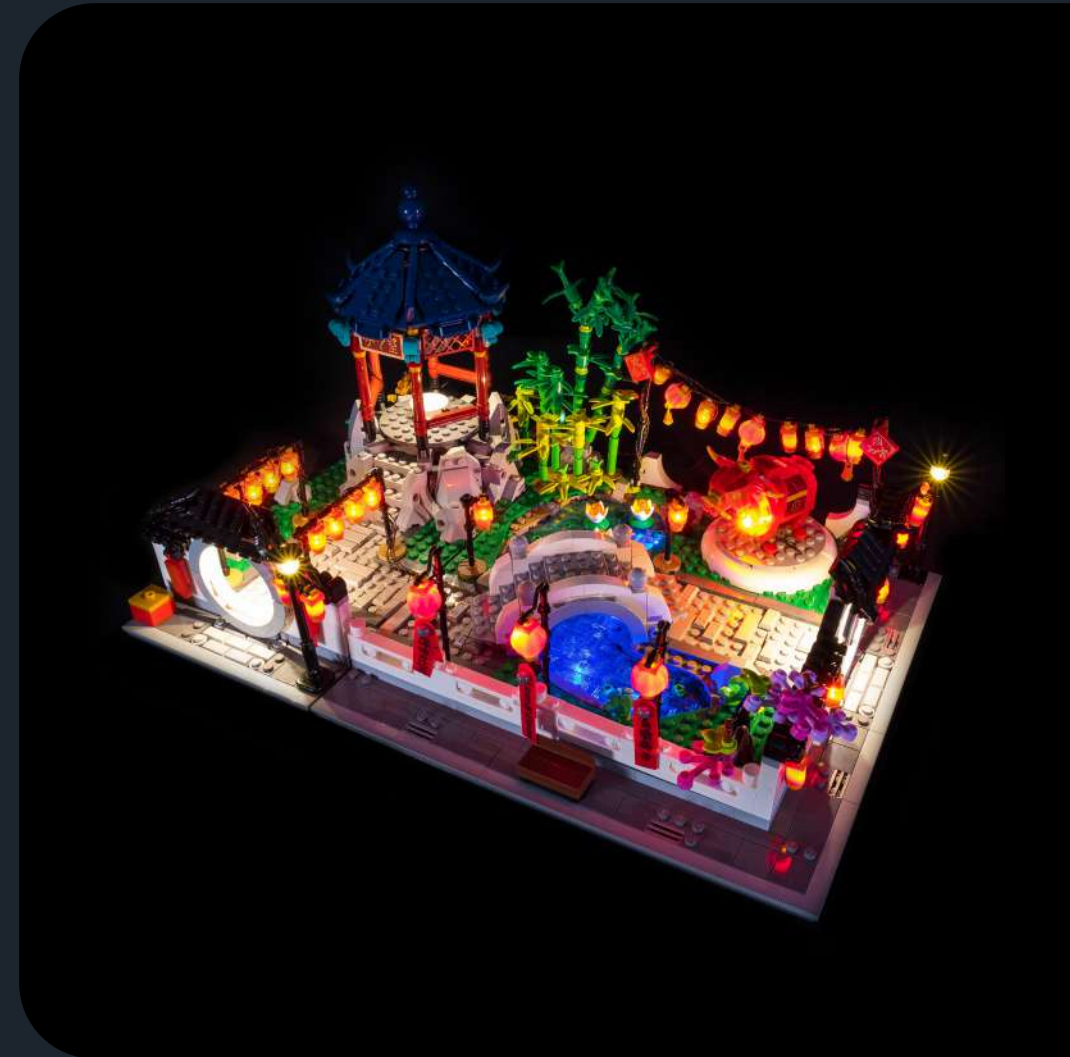

## PACKAGE CONTENTS:



- 7 x White 15cm Bit Light
- 18 x White 30cm Bit Light \*
- 3 x Blue 30cm Bit Light
- 8 x Warm White 30cm Large Bit Light
- 2 x Black Lamp Post (No Heads)
- 3 x Warm White Strip Light



- 1 x 6-Port Expansion Board
- 4 x 8-Port Expansion Board \*
- 3 x 12-Port Expansion Board\*



- 2 x 5cm Connecting Cable
- 3 x 15cm Connecting Cable
- 3 x 30cm Connecting Cable \*
- 1 x 50cm Connecting Cable



- 1 x USB Power Cable  
(Power Source not Included)

## LEGO PIECES:



- 2 x Brick 1x2 - Black
- 1 x Tile 1x1 W Clip Round Edges - Black
- 1 x Plate 1x1 Mod Rounded w/ Handle - Black
- 1 x Round Plate 1x1 w/ Open Stud - Black
- 1 x Trans Clear Plate 2x2 w/ Rounded Bottom

Indicates 1 extra component has been included just in case!

## Contents

Before You Begin	5
Blueprint	8
Instructions	9
Final Product	49
Troubleshooting	50
Contact	55

## Before You Begin

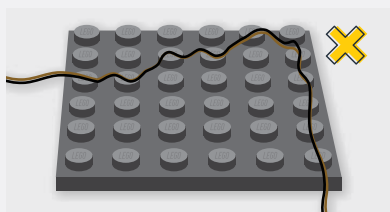

### Laying cables in between and underneath bricks

Cables can fit in between and underneath LEGO® bricks, plates, and tiles providing they are laid correctly between the LEGO® studs. Do NOT forcefully join LEGO® together around cables; instead ensure they are laying comfortably in between each stud.

*CAUTION: Forcing LEGO® to connect over a cable can result in damaging the cable and light.*

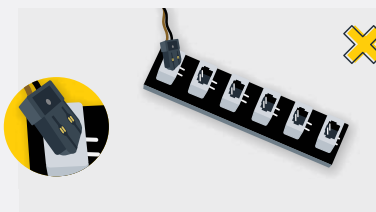

### Connecting Cable Connectors To Expansion Boards

Take extra care when inserting connectors to ports of Expansion Boards. Connectors can be inserted only one way. With the expansion board facing up, look for the soldered “=” symbol on the left side of the port. The connector side with the wires exposed should be facing toward the soldered “=” symbol as you insert into the port. If a plug won’t fit easily into a port connector, do not force it.

*Incorrectly inserting the connector can result in bent pins inside the port or possible overheating of the expansion board when connected.*

## Before You Begin



### Connecting Cable Connectors To Strip Lights

Take extra care when inserting connectors to ports on the Strip Lights. Connectors can be inserted only one way. With the Strip Light facing up, ensure the side of the connector with the wires exposed is facing down. If a plug won't fit easily into a port connector, don't force it. Doing so will damage the plug and the connector.



### Connecting Micro Cable Connectors To Micro Expansion Board Ports

Take extra care when inserting the micro connectors to micro ports of Micro Expansion Boards. Connecting Micro Bit Lights to Micro Expansion Boards is similar to connecting lights and cables to Strip Lights. With the expansion board facing up, ensure the side of the connector with the wires exposed is facing down. If a plug won't fit easily into a port connector, do not force it. Use your fingernail to push the plastic part of the connector to the micro port.

## Before You Begin

### Installing Bit Lights Under Lego® Bricks And Plates

When installing Bit Lights under LEGO® pieces, ensure they are placed the correct way up (Yellow LED component exposed). You can either place them directly on top of LEGO® studs or in between.





# BLUEPRINT

Steps 1-22

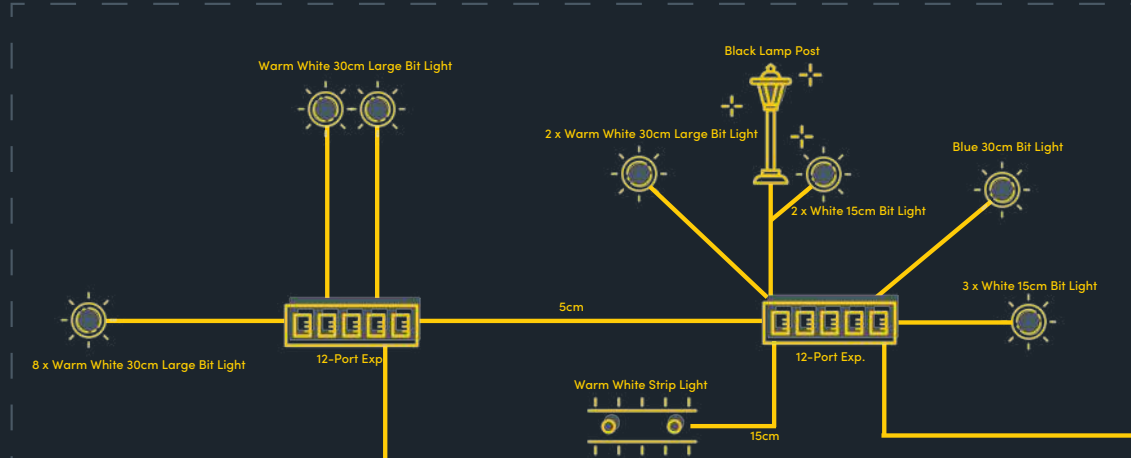

Steps 33-44

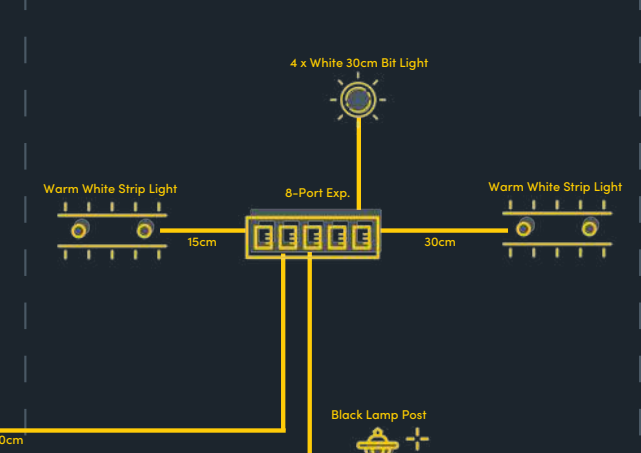

Steps 23-32

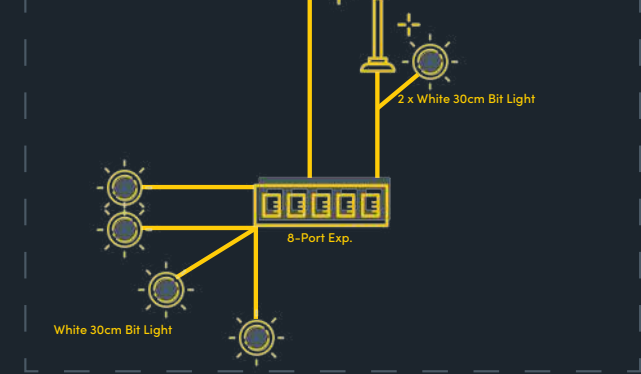
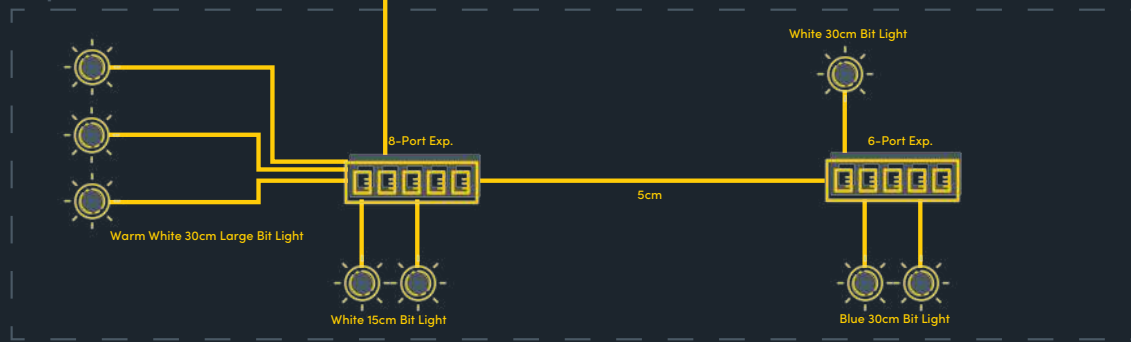





## INSTRUCTIONS

To ensure a smooth installation of your light kit, please read and follow each step carefully. If you run into any issues, please refer to the online troubleshooting guide.

**1**



**Legend**    → DISCONNECT    → CONNECT / RECONNECT    ↻ TURN / FLIP    → DIRECTIONAL    ↻ TWIST / BRAID    ✨ POWER ON TEST    📝 NOTE ICON

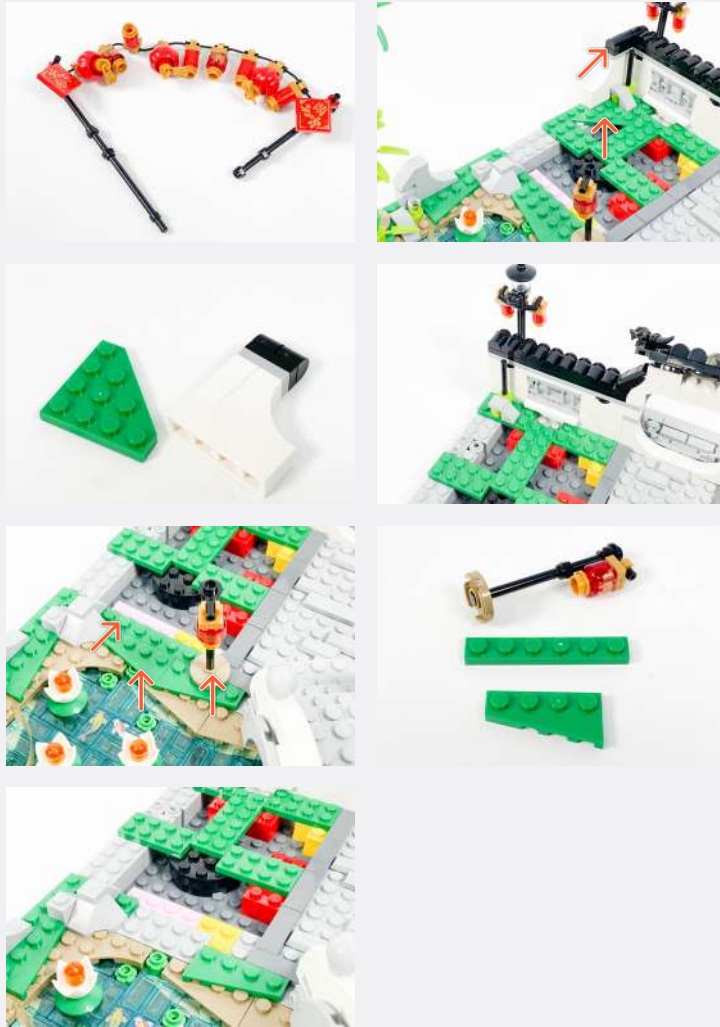

**2**



**Legend** → DISCONNECT → CONNECT / RECONNECT ↻ TURN / FLIP → DIRECTIONAL ↻ TWIST / BRAID \* POWER ON TEST 📄 NOTE ICON

3



**Legend**   DISCONNECT   CONNECT / RECONNECT   TURN / FLIP   DIRECTIONAL   TWIST / BRAID   POWER ON TEST   NOTE ICON

📌 If you experience any issues with the lights not working and suspect an issue with a component, please try a different port on the expansion board to verify where the fault lies (with the light or expansion board). To correct any issues with expansion board ports, please view the section addressing expansion board issues in our troubleshooting section.

4



Warm White 30cm Large Bit Light



3x

5

📌 Wrap the cable around the top of the Lantern twice before reconnecting



Legend

- DISCONNECT
- CONNECT / RECONNECT
- TURN / FLIP
- DIRECTIONAL
- TWIST / BRAID
- POWER ON TEST
- NOTE ICON



# 6

✍ Before twisting the cables together, ensure to group them while keeping the lanterns straight

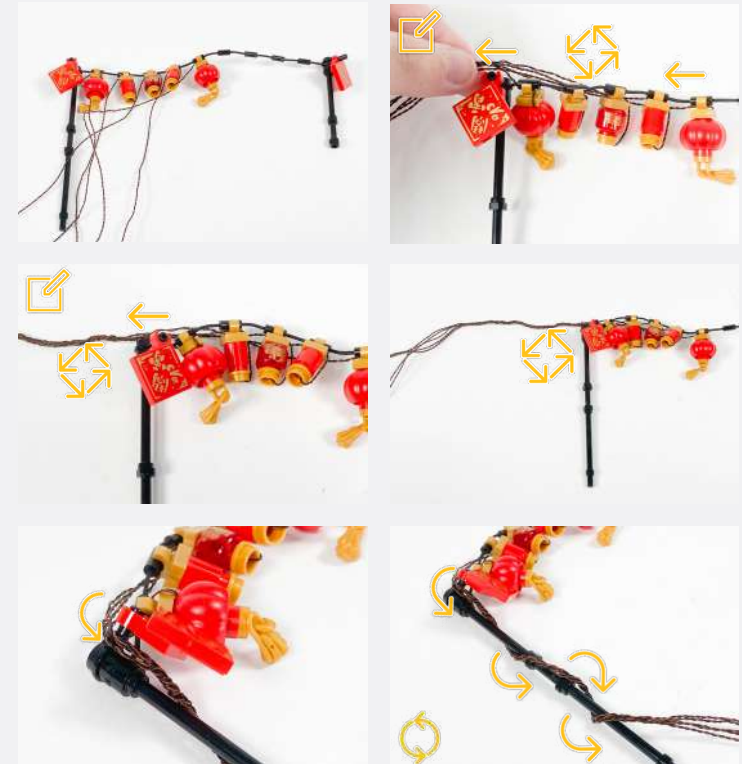

**Legend**    → DISCONNECT    → CONNECT / RECONNECT    ↻ TURN / FLIP    → DIRECTIONAL    ↻ TWIST / BRAID    ✨ POWER ON TEST    ✍ NOTE ICON

7



8

Before twisting the cables together, ensure to group them while keeping the lanterns straight



Legend

- DISCONNECT
- CONNECT / RECONNECT
- TURN / FLIP
- DIRECTIONAL
- TWIST / BRAID
- POWER ON TEST
- NOTE ICON

9



Legend

- DISCONNECT
- CONNECT / RECONNECT
- ↻ TURN / FLIP
- DIRECTIONAL
- ↻↻ TWIST / BRAID
- ✳ POWER ON TEST
- 📝 NOTE ICON



If you experience any issues with the lights not working and suspect an issue with a component, please try a different port on the expansion board to verify where the fault lies (with the light or expansion board). To correct any issues with expansion board ports, please view the section addressing expansion board issues in our troubleshooting section.

# 10

USB Power Cable

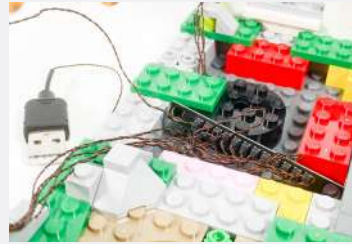

Connect to a USB Power Bank, AA Battery Pack, or USB Wall Adapter (each sold separately)

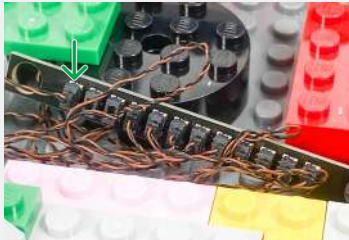

# 11

5cm Connecting Cable

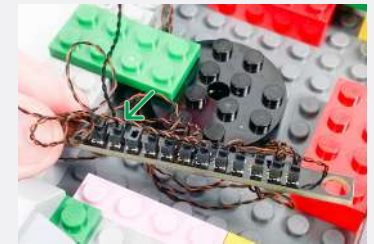

12-Port Expansion Board

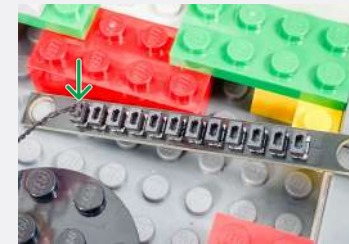
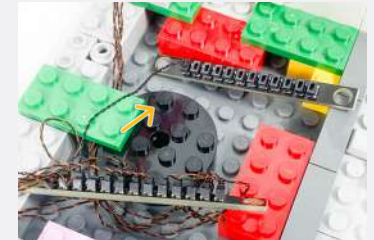



## Legend

- DISCONNECT
- CONNECT / RECONNECT
- TURN / FLIP
- DIRECTIONAL
- TWIST / BRAID
- POWER ON TEST
- NOTE ICON

**12**

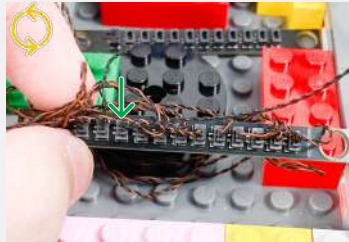
30cm Connecting Cable



 Pull the 30cm Connecting Cable to the right

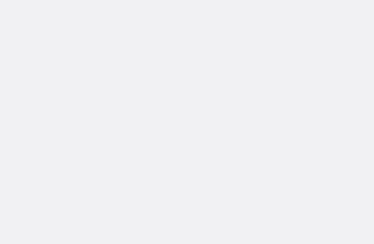
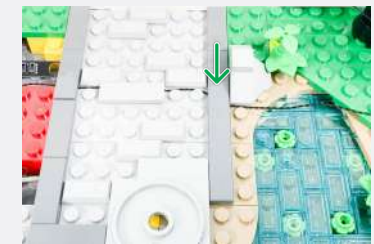
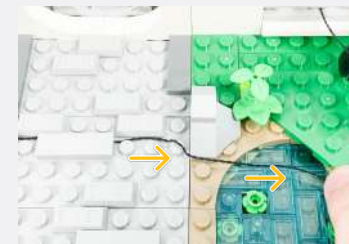
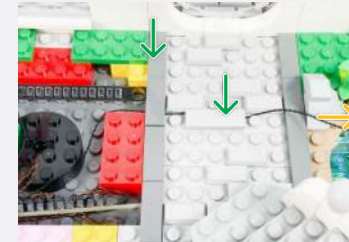
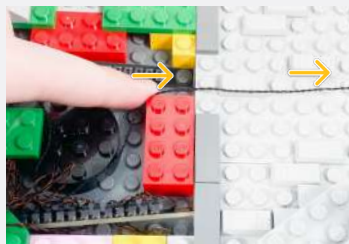
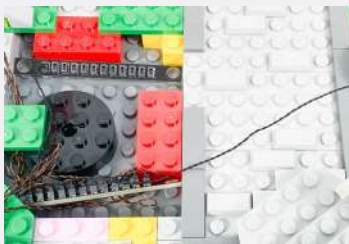
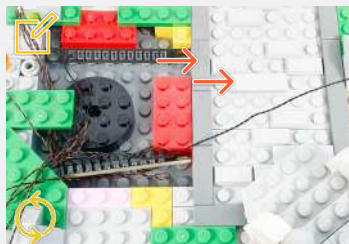

**Legend**

-  DISCONNECT
-  CONNECT / RECONNECT
-  TURN / FLIP
-  DIRECTIONAL
-  TWIST / BRAID
-  POWER ON TEST
-  NOTE ICON

**13**

Blue 30cm Bit Light



 Slightly bend the Blue Bit Light upwards



**14**

Black 1x1 Tile w/ Clip Rounded Edges



Black 1x1 Plate Modified Plate Rounded w/ Handle



Black Round Plate 1x1 w/ Open Stud



Warm White 30cm Large Bit Light



**Legend**

-  DISCONNECT
-  CONNECT / RECONNECT
-  TURN / FLIP
-  DIRECTIONAL
-  TWIST / BRAID
-  POWER ON TEST
-  NOTE ICON



**15**



**Legend** → DISCONNECT → CONNECT / RECONNECT ↻ TURN / FLIP → DIRECTIONAL ↻ TWIST / BRAID \* POWER ON TEST 📄 NOTE ICON



**16**

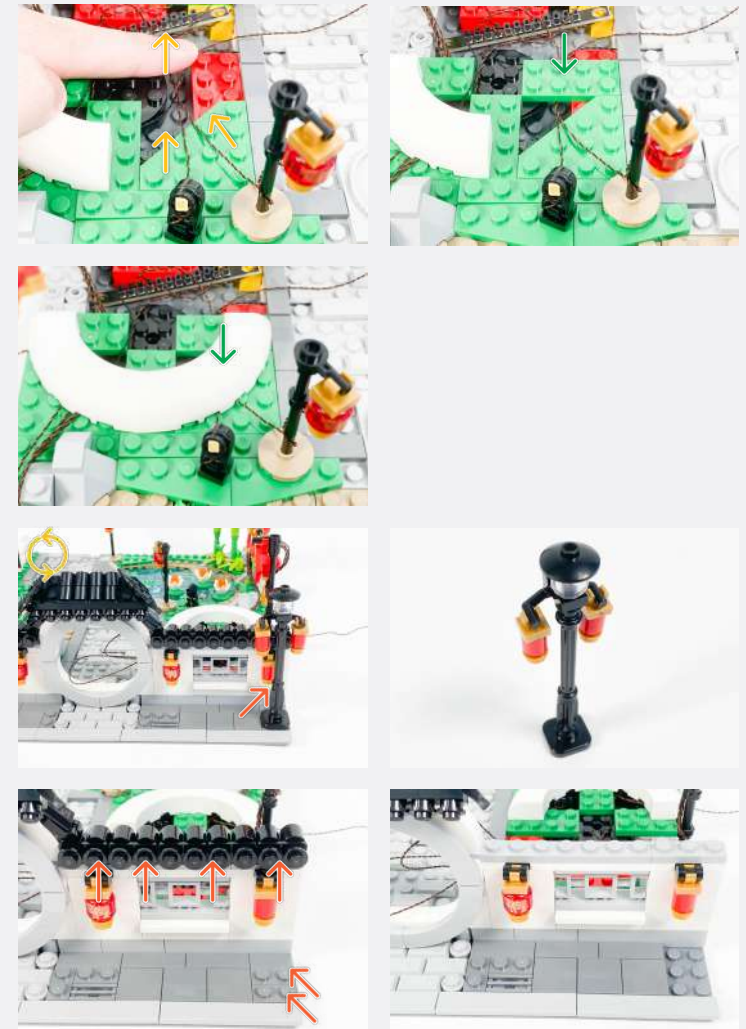

**Legend** → DISCONNECT → CONNECT / RECONNECT ↻ TURN / FLIP → DIRECTIONAL ↻ TWIST / BRAID ✨ POWER ON TEST 📝 NOTE ICON

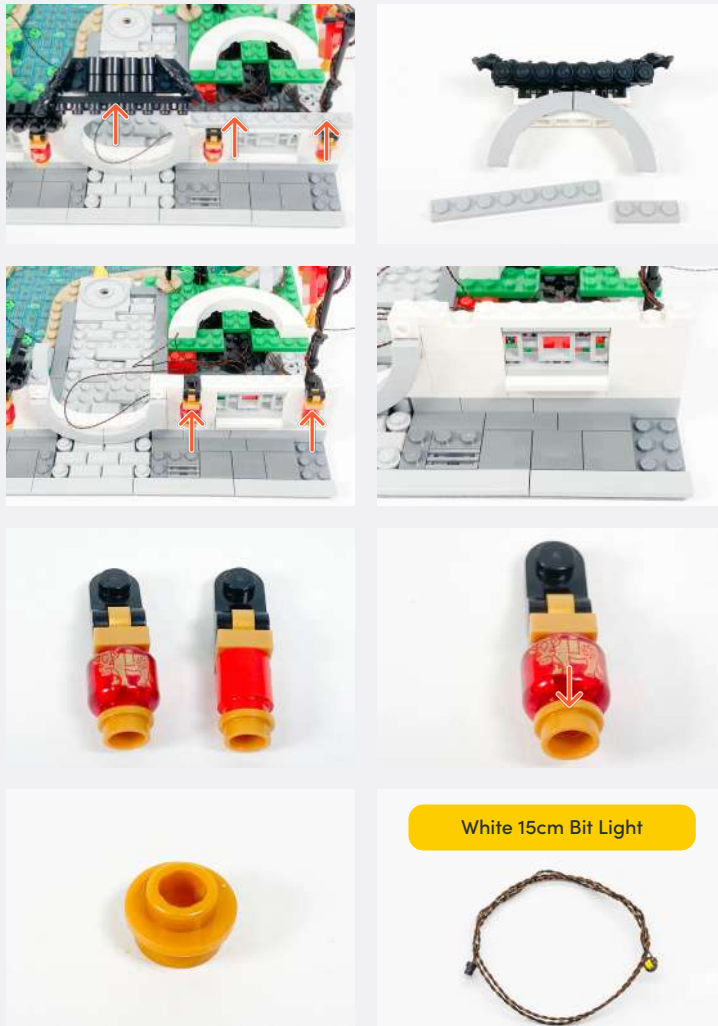

**Legend**   → DISCONNECT   → CONNECT / RECONNECT   ↻ TURN / FLIP   → DIRECTIONAL   ↻ TWIST / BRAID   ✨ POWER ON TEST   📝 NOTE ICON

**17**

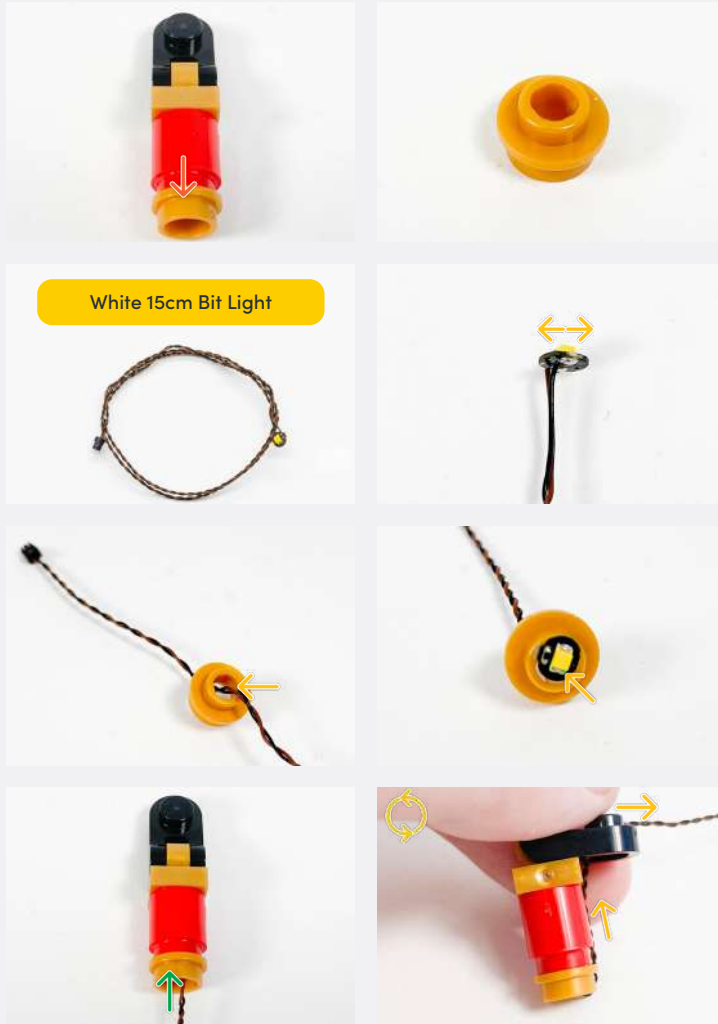

**18**



**Legend**

- DISCONNECT
- CONNECT / RECONNECT
- ↻ TURN / FLIP
- DIRECTIONAL
- ↻↻ TWIST / BRAID
- ✳ POWER ON TEST
- 📝 NOTE ICON

Pull the Bit Light from the Black Lamp Post outwards of ~3cm

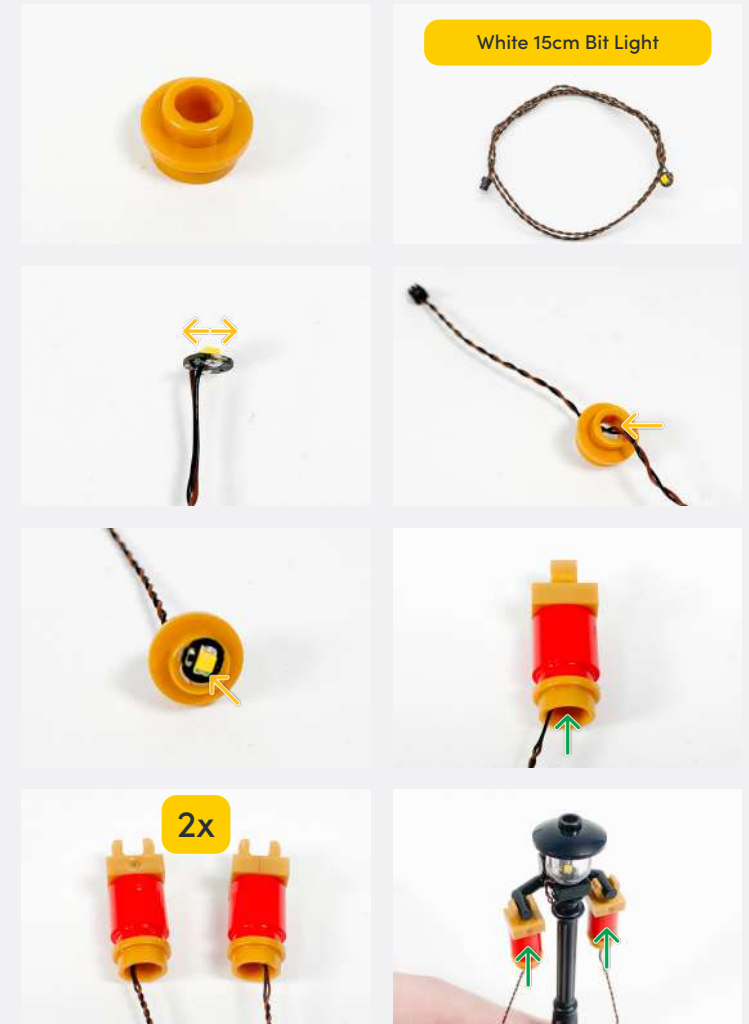

**Legend** DISCONNECT CONNECT / RECONNECT TURN / FLIP DIRECTIONAL TWIST / BRAID POWER ON TEST NOTE ICON



19

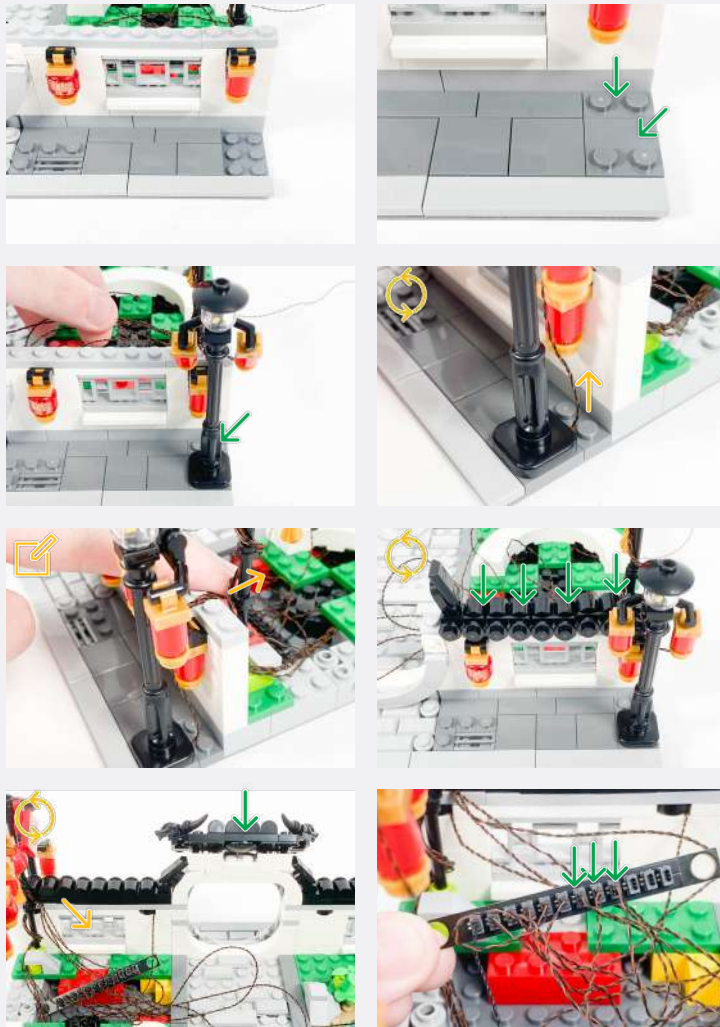

Lay all three Bit Light Cables from the Lamp over the Grey Plate 1x3.

20

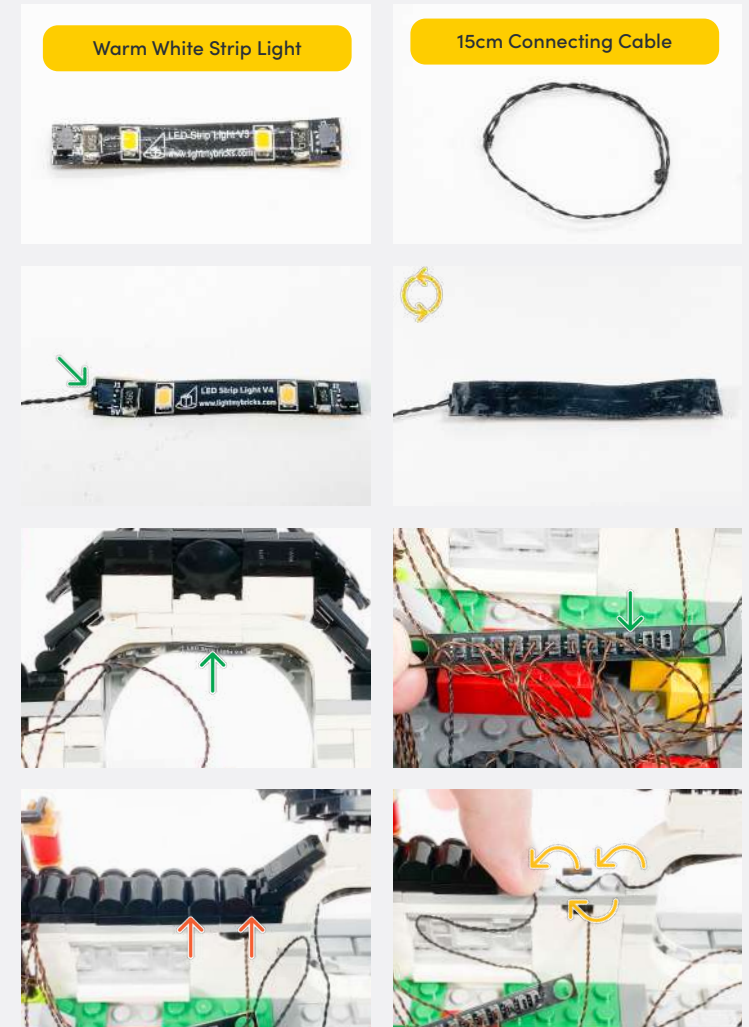

Legend

- DISCONNECT
- CONNECT / RECONNECT
- TURN / FLIP
- DIRECTIONAL
- TWIST / BRAID
- POWER ON TEST
- NOTE ICON

21

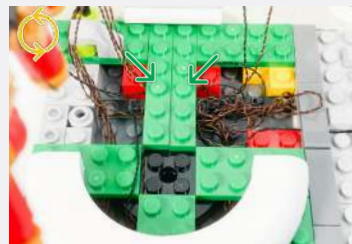
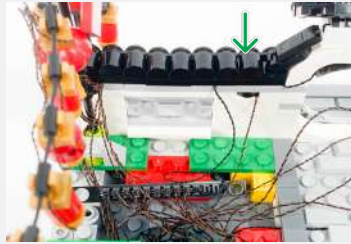

Ensure to position the Expansion Board with the open ports on the right hand side

Pull the 50cm Connecting Cable to the left

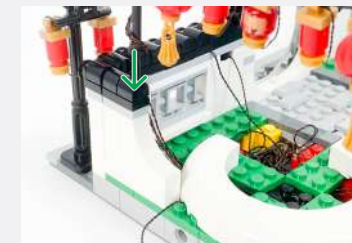
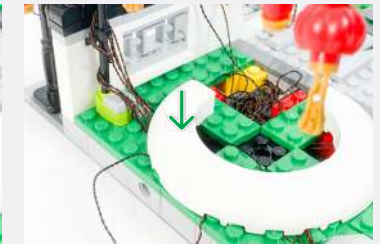
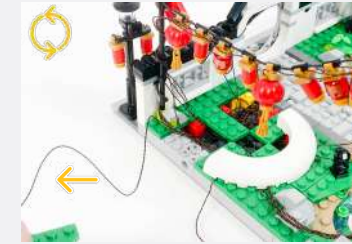

Legend

- DISCONNECT
- CONNECT / RECONNECT
- TURN / FLIP
- DIRECTIONAL
- TWIST / BRAID
- POWER ON TEST
- NOTE ICON

22



Warm White 30cm Large Bit Light

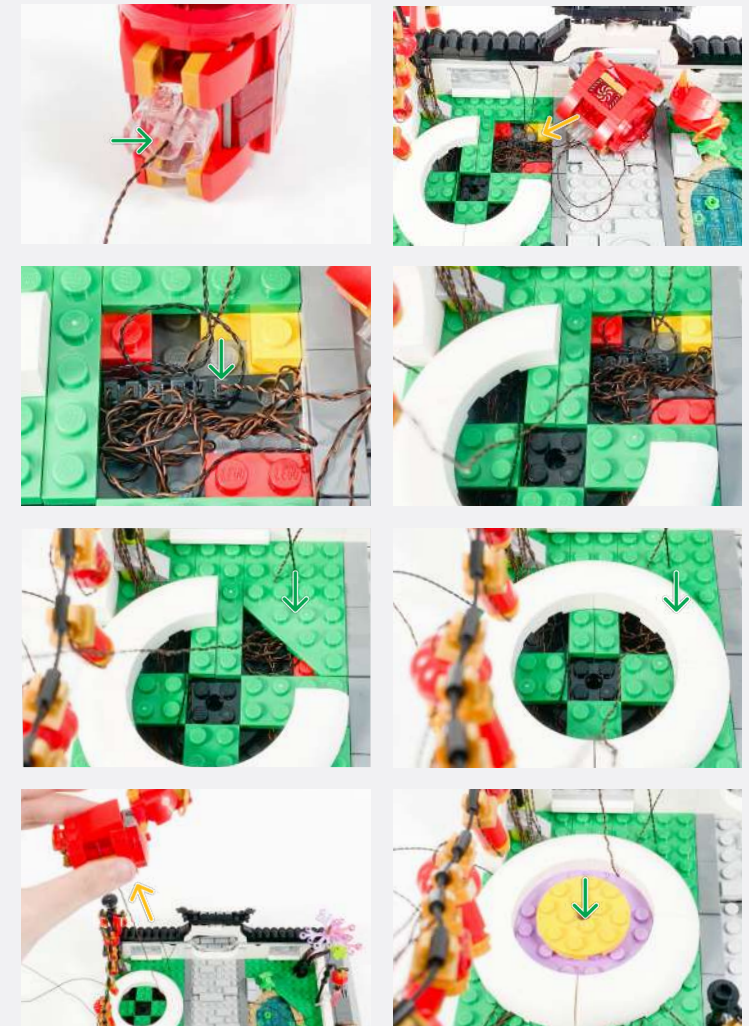

Legend

- DISCONNECT
- CONNECT / RECONNECT
- TURN / FLIP
- DIRECTIONAL
- TWIST / BRAID
- POWER ON TEST
- NOTE ICON

If you experience any issues with the lights not working and suspect an issue with a component, please try a different port on the expansion board to verify where the fault lies (with the light or expansion board). To correct any issues with expansion board ports, please view the section addressing expansion board issues in our troubleshooting section.

Wrap the Large Bit Light around the Yellow Plate but leave ~10cm of excess slack.



# 23



**Legend** DISCONNECT CONNECT / RECONNECT TURN / FLIP DIRECTIONAL TWIST / BRAID POWER ON TEST NOTE ICON

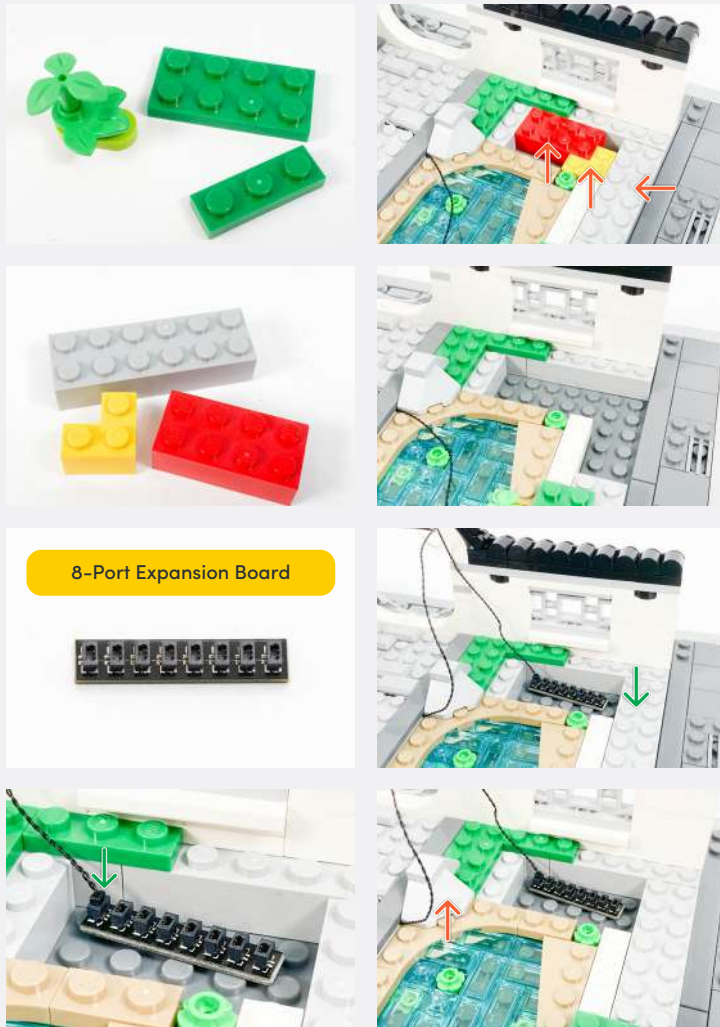

24

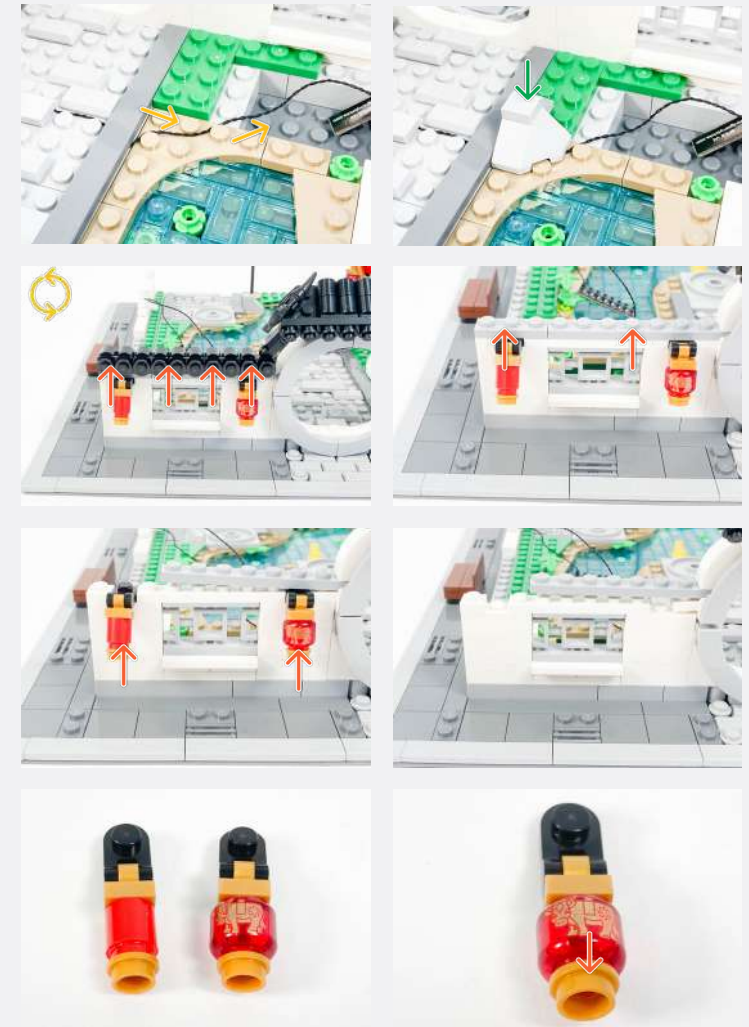

Legend → DISCONNECT → CONNECT / RECONNECT ↻ TURN / FLIP → DIRECTIONAL ↻ TWIST / BRAID \* POWER ON TEST 📝 NOTE ICON



**25**

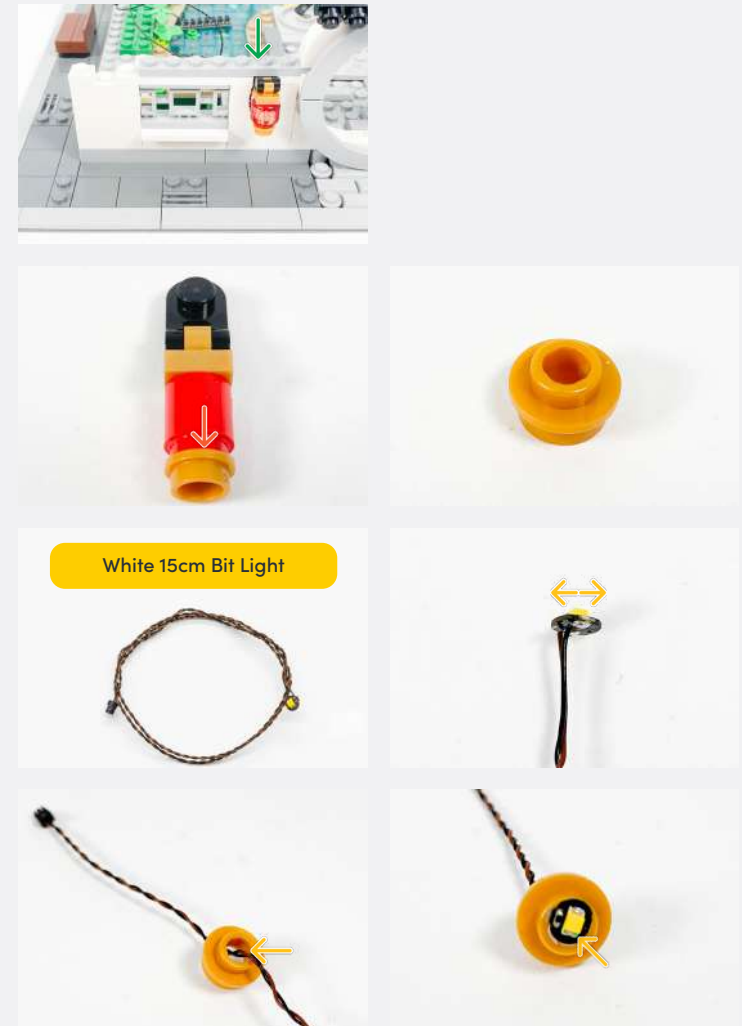

**Legend** → DISCONNECT → CONNECT / RECONNECT ↻ TURN / FLIP → DIRECTIONAL ↻ TWIST / BRAID \* POWER ON TEST 📝 NOTE ICON

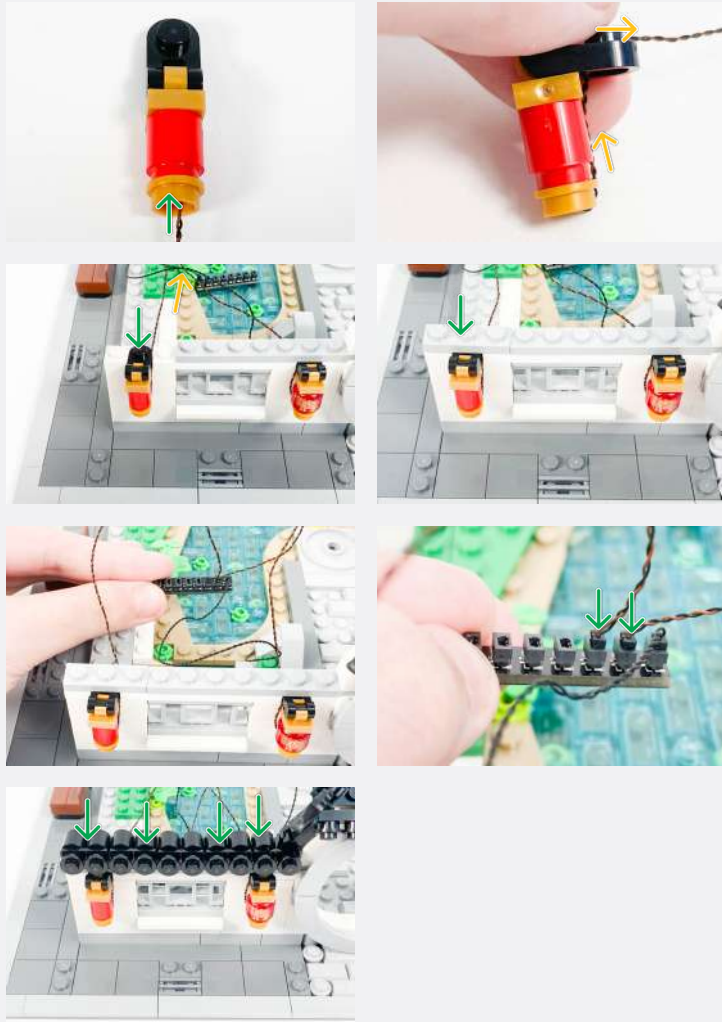

**26**

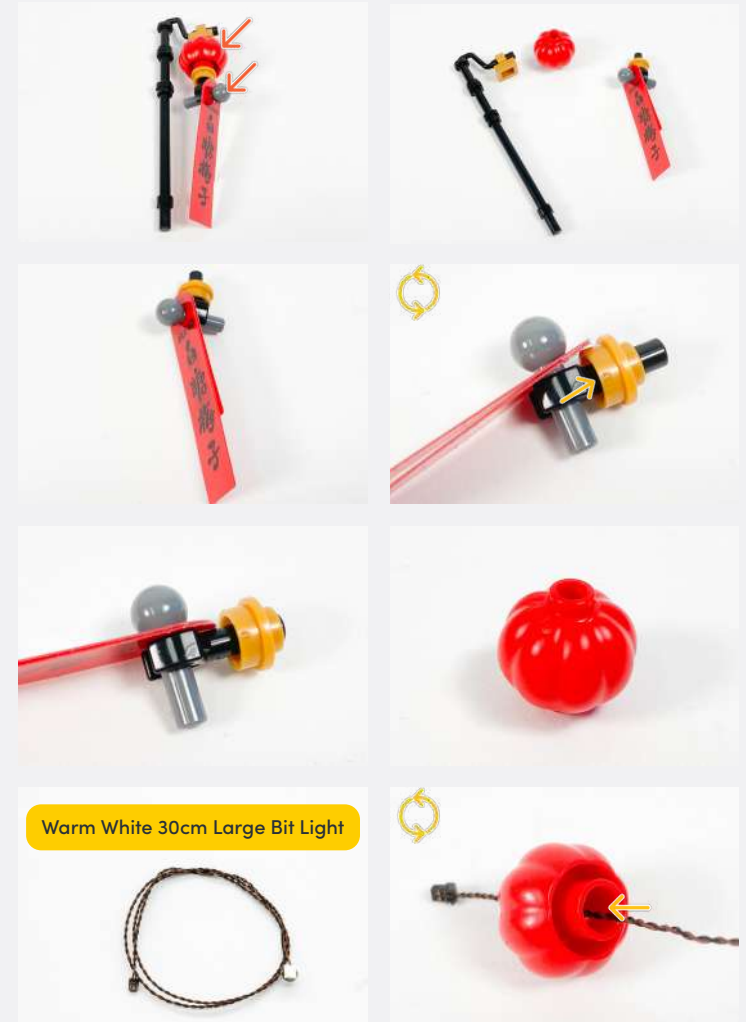

Warm White 30cm Large Bit Light

**Legend** → DISCONNECT → CONNECT / RECONNECT ↻ TURN / FLIP → DIRECTIONAL ↻ TWIST / BRAID \* POWER ON TEST 📝 NOTE ICON

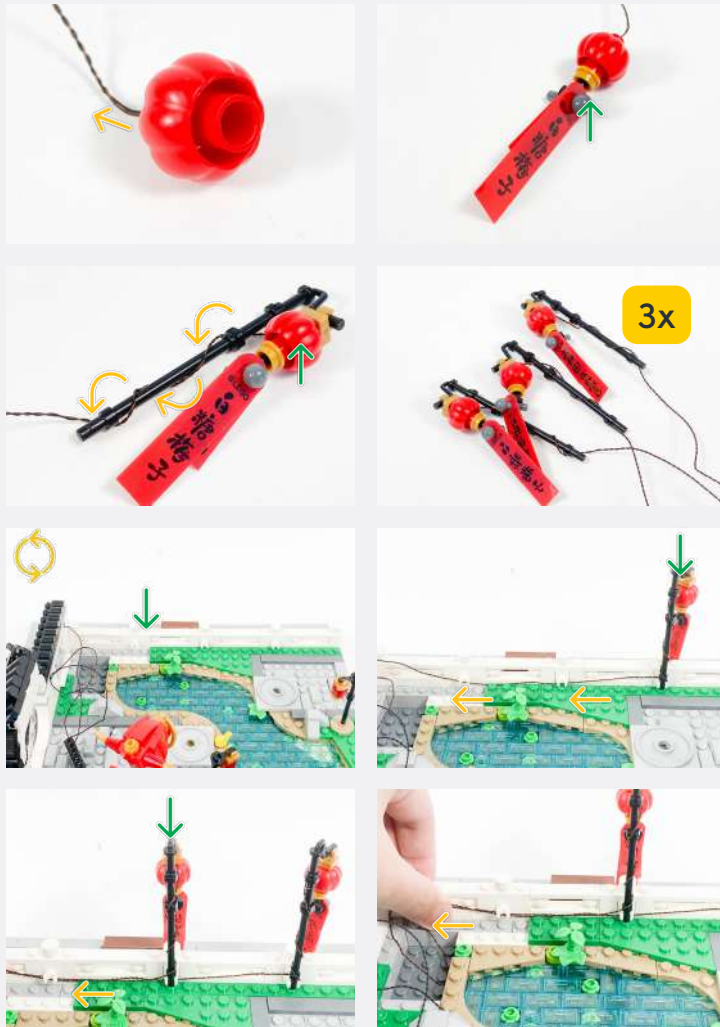

Lift the lantern poles slightly so you are able to lay the cables between the wall and the poles before pushing them back down

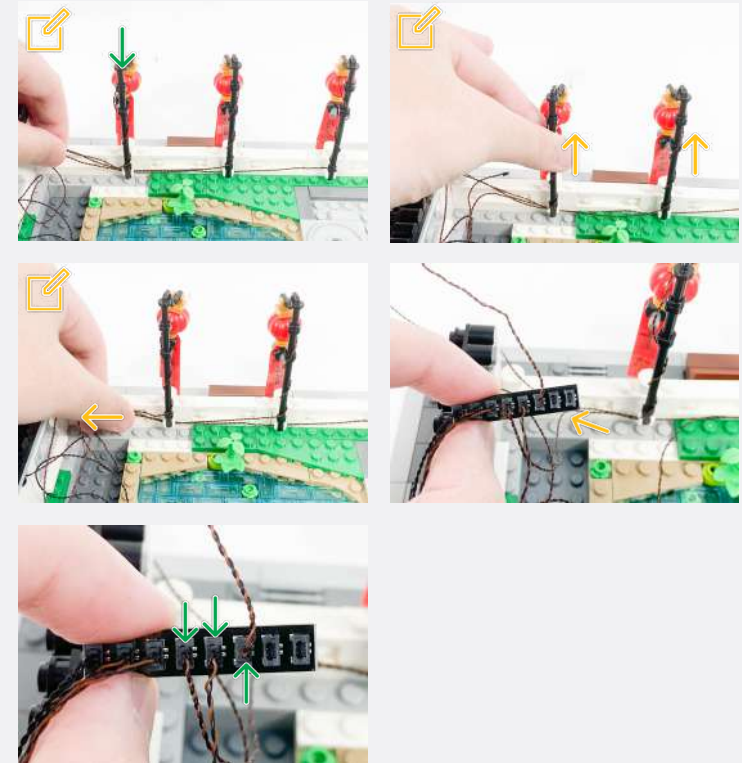

**Legend**   DISCONNECT   CONNECT / RECONNECT   TURN / FLIP   DIRECTIONAL   TWIST / BRAID   POWER ON TEST   NOTE ICON



27

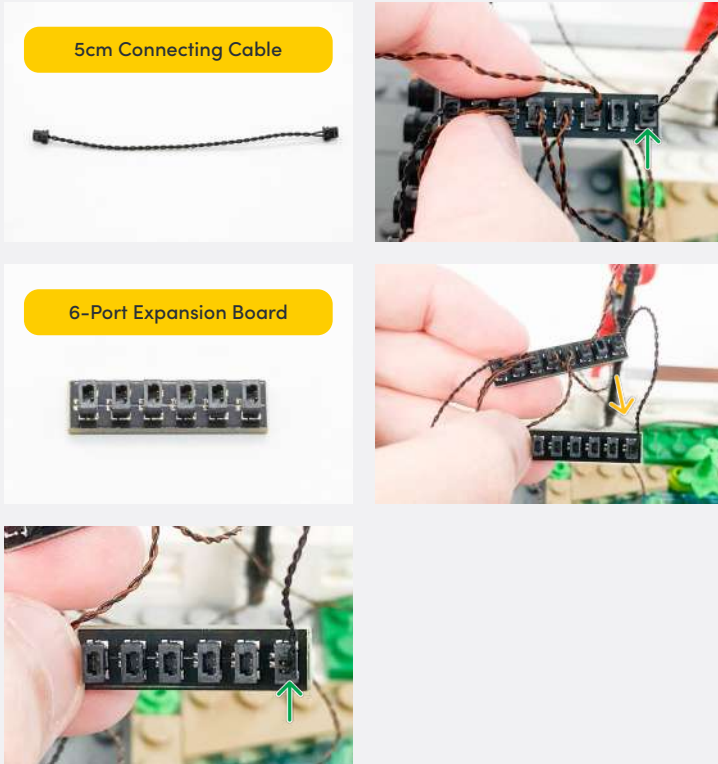

28

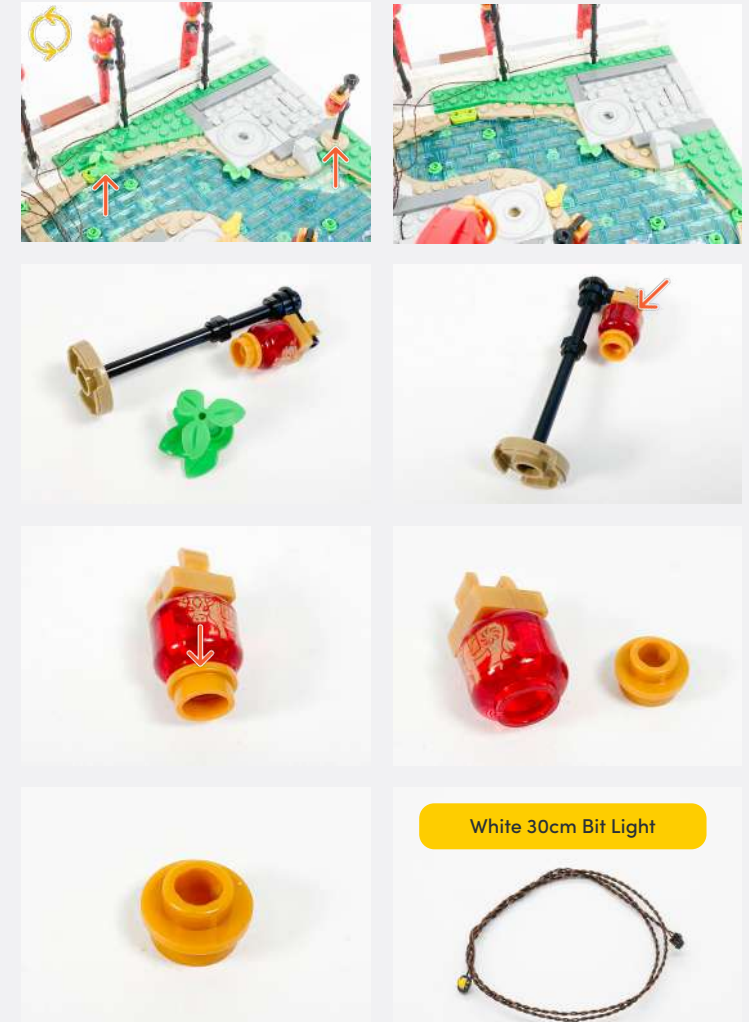

Legend

- DISCONNECT
- CONNECT / RECONNECT
- TURN / FLIP
- DIRECTIONAL
- TWIST / BRAID
- POWER ON TEST
- NOTE ICON



**29**

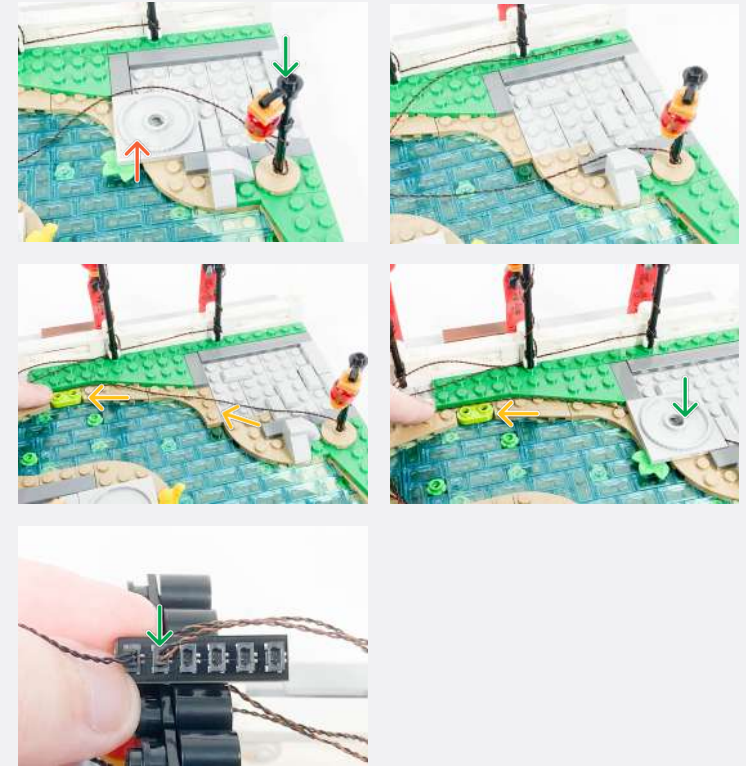

**Legend** → DISCONNECT → CONNECT / RECONNECT ↻ TURN / FLIP → DIRECTIONAL ↻ TWIST / BRAID ✨ POWER ON TEST 📝 NOTE ICON

30

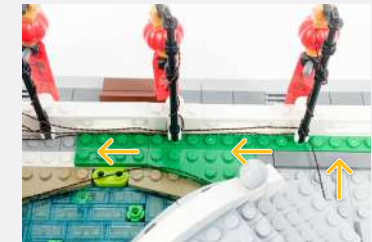
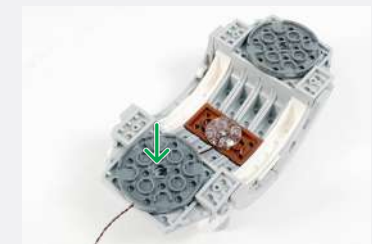
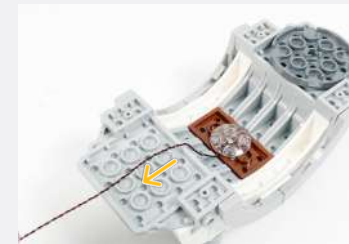
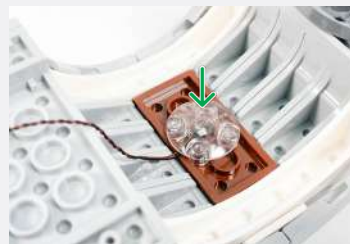

Blue 30cm Bit Light

 Trans Clear Round Plate  
2x2 w/ Rounded Bottom

Slightly lift the Lantern Poles to lay the cable between the wall and poles before pushing the them back down



## Legend

- DISCONNECT
- CONNECT / RECONNECT
- TURN / FLIP
- DIRECTIONAL
- TWIST / BRAID
- POWER ON TEST
- NOTE ICON

31



Blue 30cm Bit Light

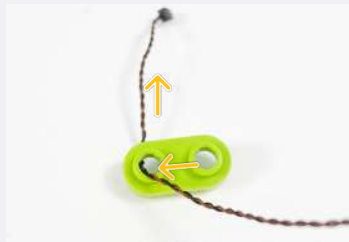
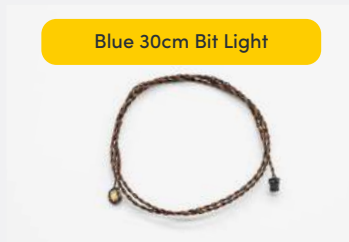

Lay the Blue 30cm Bit Light AND White 30cm Bit Light from step 28 in between the studs as shown

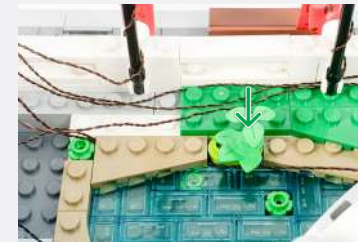
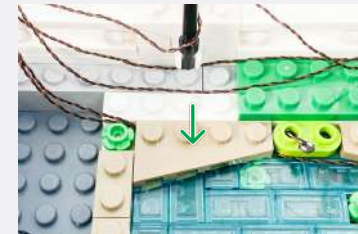

Legend

- DISCONNECT
- CONNECT / RECONNECT
- TURN / FLIP
- DIRECTIONAL
- TWIST / BRAID
- POWER ON TEST
- NOTE ICON

📌 If you experience any issues with the lights not working and suspect an issue with a component, please try a different port on the expansion board to verify where the fault lies (with the light or expansion board). To correct any issues with expansion board ports, please view the section addressing expansion board issues in our troubleshooting section.

32

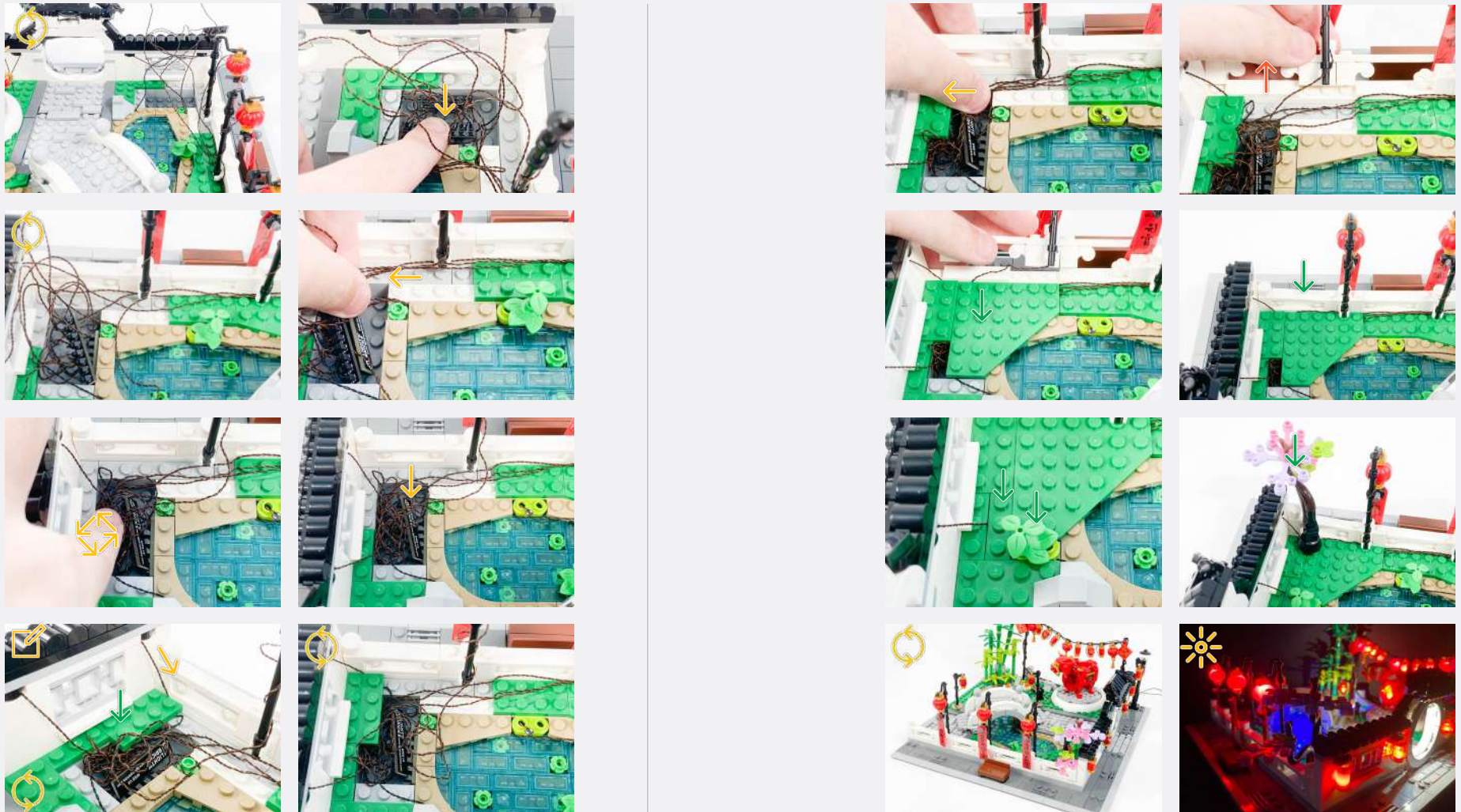

## Legend

- DISCONNECT
- CONNECT / RECONNECT
- ↻ TURN / FLIP
- DIRECTIONAL
- ↻ TWIST / BRAID
- ✳ POWER ON TEST
- 📌 NOTE ICON

 If you experience any issues with the lights not working and suspect an issue with a component, please try a different port on the expansion board to verify where the fault lies (with the light or expansion board). To correct any issues with expansion board ports, please view the section addressing expansion board issues in our troubleshooting section.

**33**

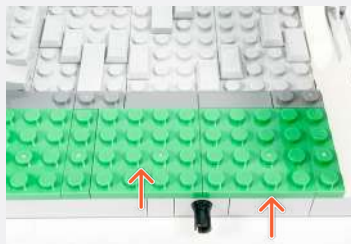
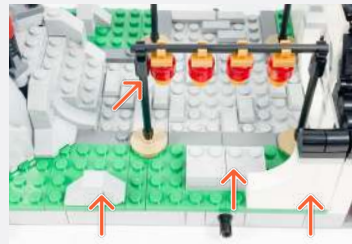

**34**

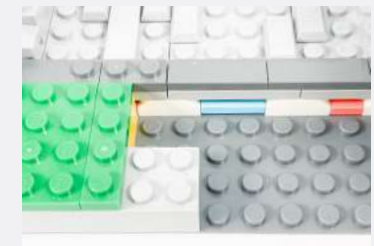
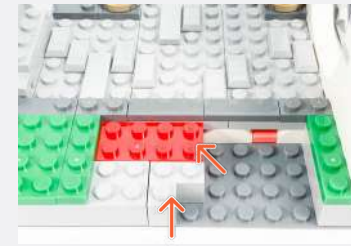

**Legend**

-  DISCONNECT
-  CONNECT / RECONNECT
-  TURN / FLIP
-  DIRECTIONAL
-  TWIST / BRAID
-  POWER ON TEST
-  NOTE ICON

If you experience any issues with the lights not working and suspect an issue with a component, please try a different port on the expansion board to verify where the fault lies (with the light or expansion board). To correct any issues with expansion board ports, please view the section addressing expansion board issues in our troubleshooting section.

35

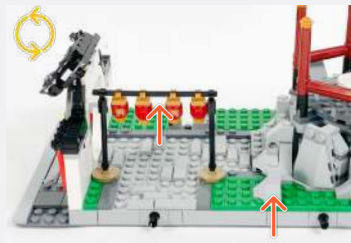

Note content goes here lorem ipsum dolor sit amet lorem ipsum dolor sit amet lorem ipsum dolor.

36

2 x Black Brick 1x2

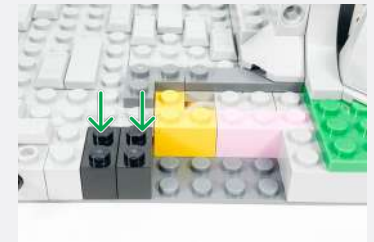

Black Lamp Post



Pull the Bit Light from the Black Lamp Post outwards of ~3cm

Legend

- DISCONNECT
- CONNECT / RECONNECT
- TURN / FLIP
- DIRECTIONAL
- TWIST / BRAID
- POWER ON TEST
- NOTE ICON

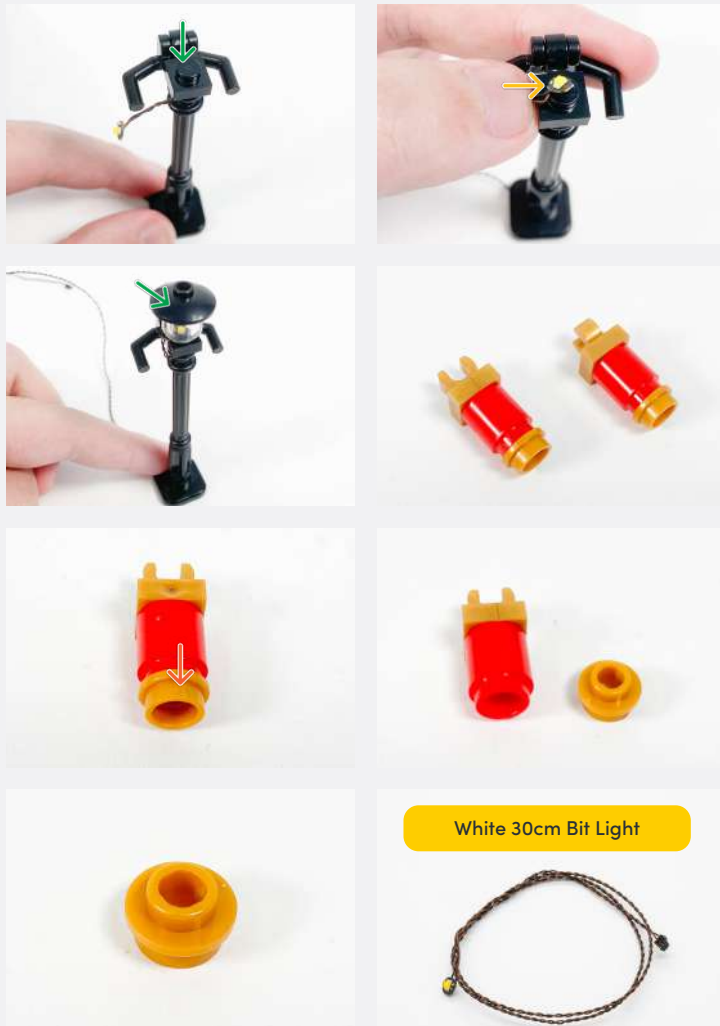

**Legend**   DISCONNECT   CONNECT / RECONNECT   TURN / FLIP   DIRECTIONAL   TWIST / BRAID   POWER ON TEST   NOTE ICON



37

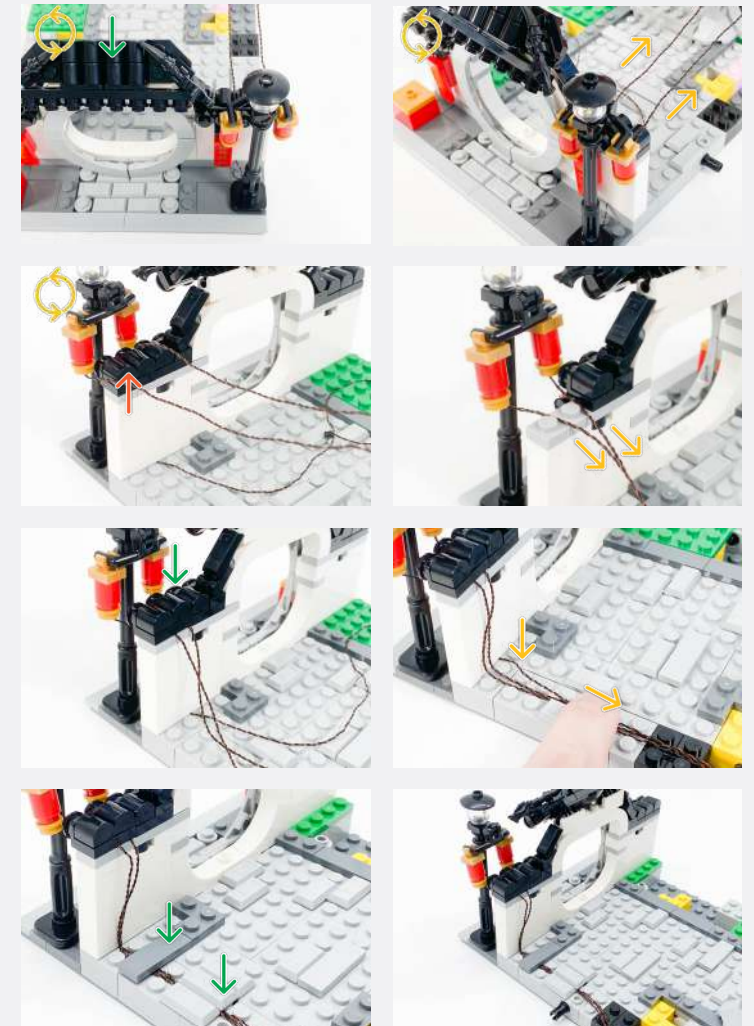

**Legend** → DISCONNECT → CONNECT / RECONNECT ↻ TURN / FLIP → DIRECTIONAL ↻ TWIST / BRAID \* POWER ON TEST 📌 NOTE ICON

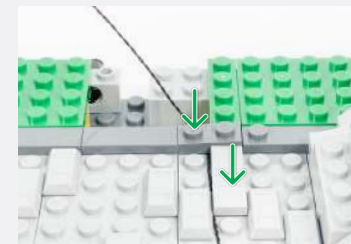
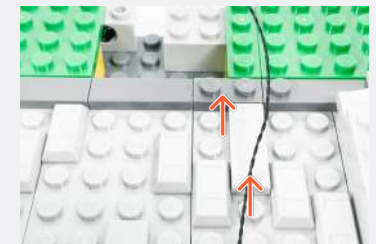
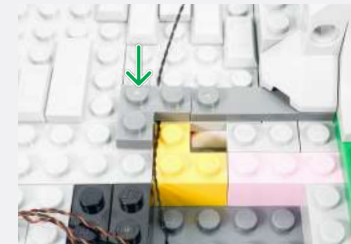
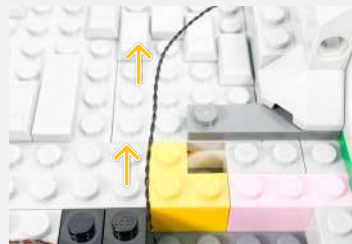
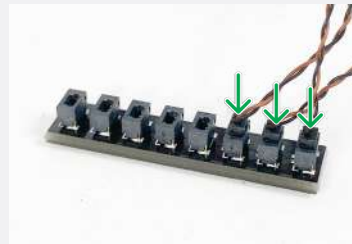
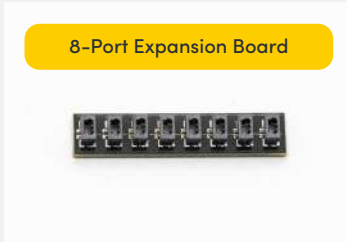

38

Legend

- DISCONNECT
- CONNECT / RECONNECT
- TURN / FLIP
- DIRECTIONAL
- TWIST / BRAID
- POWER ON TEST
- NOTE ICON

39



Slightly twist the cables before wrapping them around the pole.

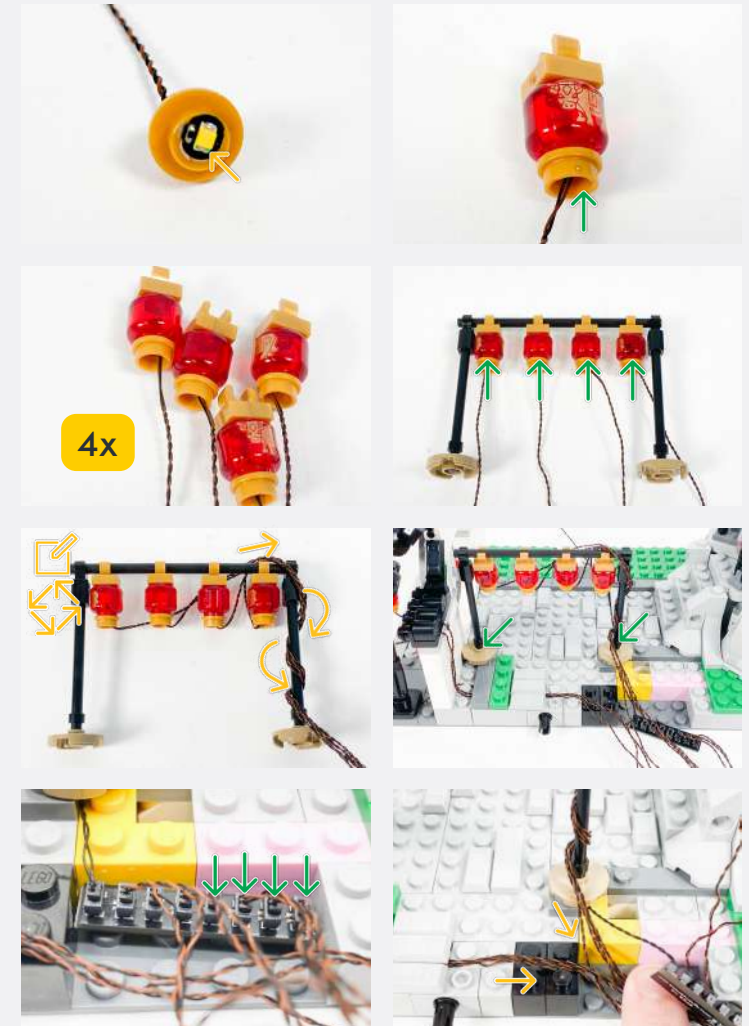

**Legend** DISCONNECT CONNECT / RECONNECT TURN / FLIP DIRECTIONAL TWIST / BRAID POWER ON TEST NOTE ICON

Slightly lift the pole so it is possible to reconnect the Green Plate 1x4.



Allow for cable slack from the lanterns so that the Grey 1x4 Tile can be reconnected.



Having the cables too tight will not allow the reconnection of the tile.

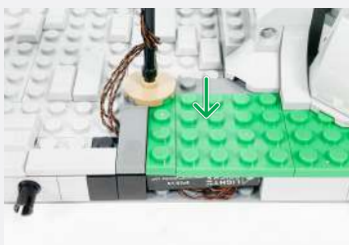

40



8-Port Expansion Board

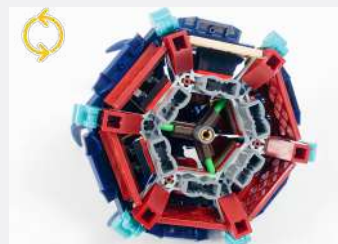

Warm White Strip Light



30cm Connecting Cable



Legend

- DISCONNECT
- CONNECT / RECONNECT
- TURN / FLIP
- DIRECTIONAL
- TWIST / BRAID
- POWER ON TEST
- NOTE ICON

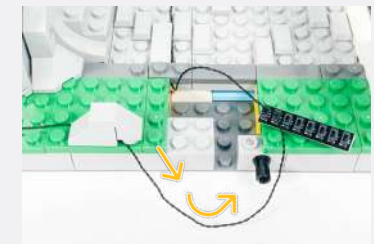
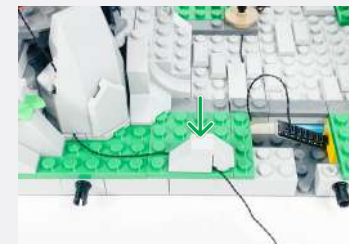
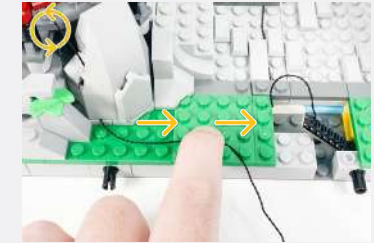
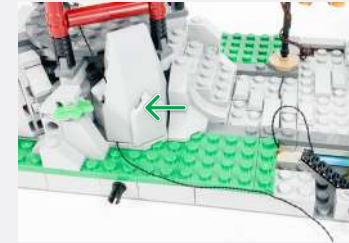
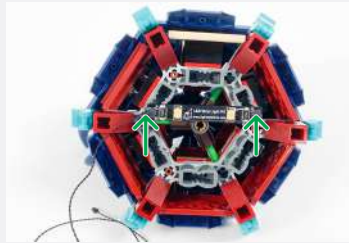

Note content goes here lorem ipsum dolor sit amet lorem ipsum dolor sit amet lorem ipsum dolor.

41

Legend → DISCONNECT → CONNECT / RECONNECT ↻ TURN / FLIP → DIRECTIONAL ↻ TWIST / BRAID \* POWER ON TEST 📝 NOTE ICON

42



15cm Connecting Cable

43



**Legend** → DISCONNECT → CONNECT / RECONNECT ↻ TURN / FLIP → DIRECTIONAL ↻ TWIST / BRAID \* POWER ON TEST 📝 NOTE ICON



White 30cm Bit Light

Slightly twist the cables before wrapping them around the pole.

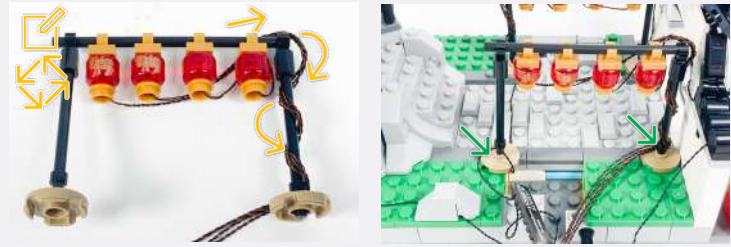

44

Pull the 50cm Connecting Cable from the other half of the set, underneath the Spring Lantern Festival.



Legend DISCONNECT CONNECT / RECONNECT TURN / FLIP DIRECTIONAL TWIST / BRAID POWER ON TEST NOTE ICON

If you experience any issues with the lights not working and suspect an issue with a component, please try a different port on the expansion board to verify where the fault lies (with the light or expansion board). To correct any issues with expansion board ports, please view the section addressing expansion board issues in our troubleshooting section.

Continue to pull the 50cm Connecting Cable below the set before connecting it to the remaining 8-Port Expansion Board

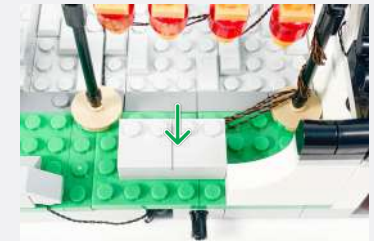
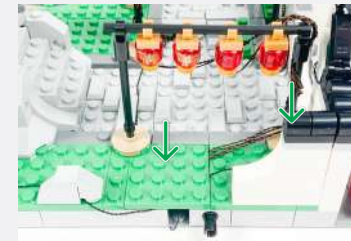
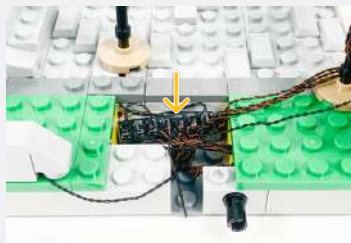
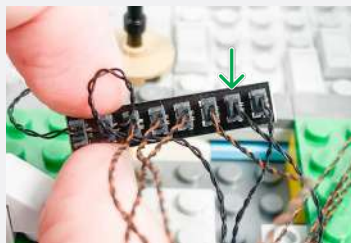
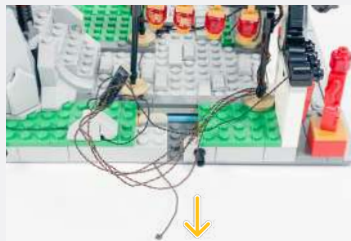
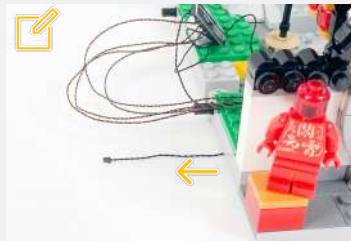

**Legend** DISCONNECT CONNECT / RECONNECT TURN / FLIP DIRECTIONAL TWIST / BRAID POWER ON TEST NOTE ICON



## FINAL PRODUCT

This finally completes installation of the Light My Bricks Spring Lantern Festival 80107 Light Kit.





## TROUBLESHOOTING

Light My Bricks lighting kits contain individual components that are very small and can be easily damaged if not handled correctly.

To prevent unnecessary damage to components, we highly recommend that the User Guide section, **“Important things to note”** is read carefully. Follow the handling procedures in the User Guide to help prevent faults and damages to your Light My Bricks components.

If you are experiencing issues with your Light My Bricks set, watch our troubleshooting video [here](#) or read on for a list of common causes to help you troubleshoot.

## Troubleshooting

**Firstly, ensure that the batteries have power using a battery charge gauge.**

**If the batteries have no power, replace the batteries.**

**If the batteries still have power, check to see if the batteries have been inserted correctly into the battery pack.**

### Check For CR2032 Batteries Using The Flat Battery Pack

Inside the battery pack is a symbol indicating which side the (round) CR2032 battery should be inserted. Check that the “+” side of the battery pack has the battery with the “+” symbol facing downwards.

On the opposite side, the “-” side of the battery pack should have the battery flipped upside down, that is the “+” symbol facing upwards.

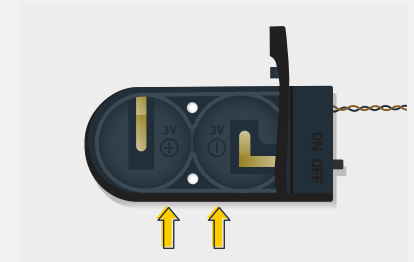

## Troubleshooting

### Check For Cr2032 Batteries Using The Round Battery Pack

Inside the battery pack is a symbol indicating which side the (round) CR2032 battery should be inserted. In this case, for the stacked battery pack, ensure that BOTH batteries have the “+” symbol facing upwards.

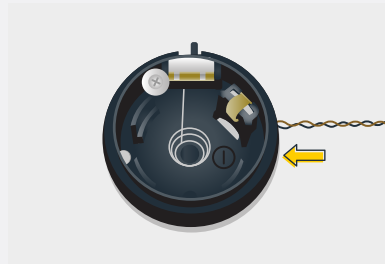

### Check for AA batteries using the AA battery pack

Inside the battery pack are symbols indicating which direction the AA battery should be inserted. The flat side of the battery should be paired with the spring side of the battery pack.

If the batteries have been installed correctly and your kit still isn't operating correctly, the next step is to check the wiring.

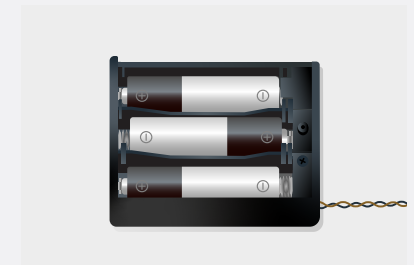
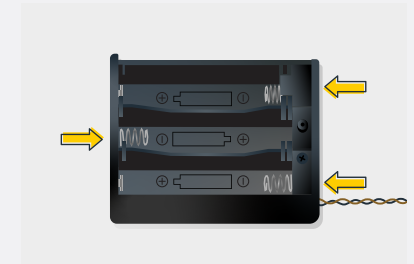

## Troubleshooting

### Check Your Wires

In order for Light My Bricks components to fit in between and underneath LEGO® bricks, the components need to be very small. Due to this nature, Light My Bricks components can be easily damaged when not handled correctly.

Be careful when removing unpacked components out of the packaging and ensure not to forcibly pull at the wires as this can damage the soldering that attach the wires to the LEDs.

If the wiring is detached from the LED itself, the light will not operate.

When connecting lights to your LEGO set, check that there are no pinched wires underneath or in between bricks and plates. When the wires are pinched and the exposed wires are touching each other, this can cause a crosswire and the lights to not function correctly.

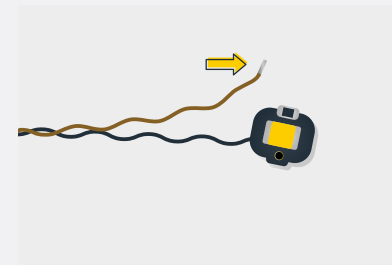
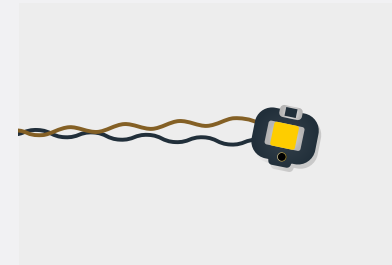

## Troubleshooting

### Check Your Expansion Board Ports/ Strip Light Ports / Effects Board Ports

It is important to note that connectors can only be inserted to the expansion board, strip light, or effects board ports in one direction.

Forcibly inserting connectors in the incorrect direction will result in damaging the pins inside each of the ports on your component board.

Not only will a light connected to the damaged port not work, but if the pins inside the port are bent to a point they are touching each other, this can result in all other lights in the system to stop working. This is a short circuit.

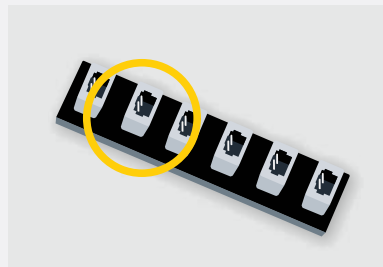

A short circuit can also result in overheating of the board, cable or batteries. If you suspect a short circuit, **DISCONNECT POWER IMMEDIATELY**. Batteries can fail, catch fire, or even explode if left connected to a short circuit for too long.

If you suspect you have a faulty component due to a bent pin, try the following steps:

If you look carefully inside each of the ports, each port contains 2 small pins that should be straight. You will be able to identify a faulty port if it has any bent pins.

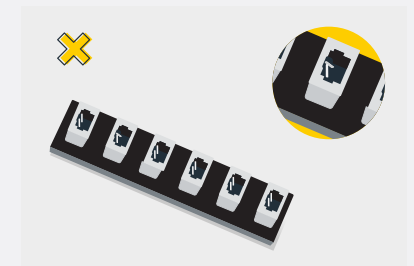
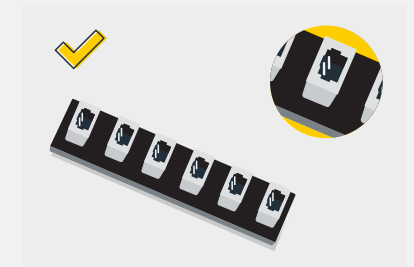
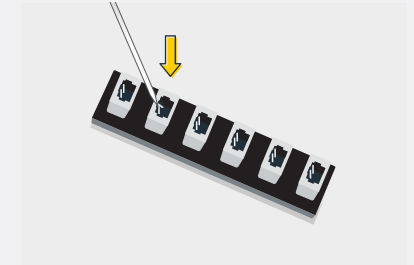



## CONTACT US

If you have an enquiry regarding the online shop, our products or a general enquiry please refer to our Frequently Asked Questions webpage here.

Alternatively, you can contact our Customer Services team by visiting our online support portal here.

[support.lightmybricks.com](https://support.lightmybricks.com)

We thank you for purchasing this product and hope you enjoy!



[lightmybricks.com](http://lightmybricks.com)